









LEGEND:

-  PERMANENT WETLAND IMPACT
-  WETLAND
-  ZONE 2 BUFFER IMPACT (ROAD)
-  ZONE 1 BUFFER IMPACT (ROAD)
-  PERMANENT - NO LOSS STREAM IMPACT
-  PERMANENT - STREAM IMPACT
-  TEMPORARY STREAM IMPACT
-  STREAM
-  NEW STREAM

BUFFER IMPACTS	
BUFFER IMPACT ID	TOTAL
B1	19,128 SF
B2	22,058 SF

WETLAND IMPACTS	
WETLAND IMPACT ID	TOTAL
W1	836 SF

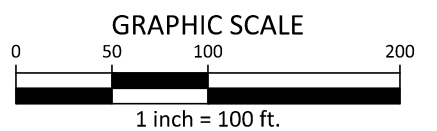

M:\Projects\WBP\WBP22002\04-Production\Engineering\Exhibits\Buffer Impacts\WBP22002-BI1.dwg, 11/9/2022 12:14:04 PM, Linda Vasil



The John R. McAdams Company, Inc.
621 Hillsborough Street
Suite 500
Raleigh, NC 27603

phone 919. 361. 5000
fax 919. 361. 2269
license number: C-0293, C-187

www.mcadamsco.com

SUMNER BLVD EXTENSION
OVERALL IMPACT MAP
2300 SUMNER BOULEVARD
RALEIGH, NC 27616

FIGURE 15

PLAN INFORMATION

PROJECT NO.	WBP22002
FILENAME	WBP22002-BI1
CHECKED BY	LJV
DRAWN BY	LJV
SCALE	1"=200'
DATE	11.07.2022

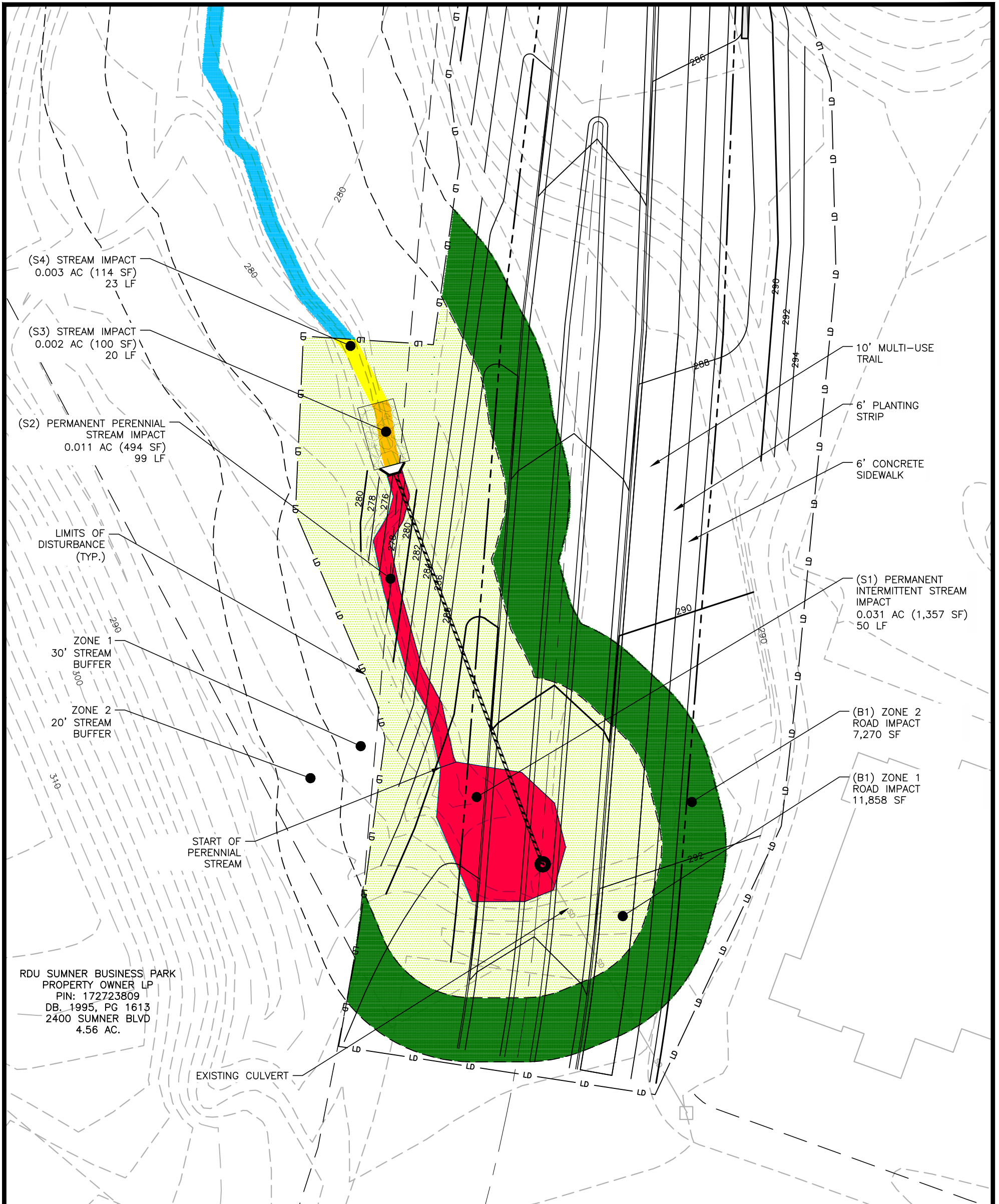

LEGEND:

- PERMANENT WETLAND IMPACT
- WETLAND
- ZONE 2 BUFFER IMPACT (ROAD)
- ZONE 1 BUFFER IMPACT (ROAD)
- PERMANENT - NO LOSS STREAM IMPACT
- PERMANENT- STREAM IMPACT

- TEMPORARY STREAM IMPACT
- STREAM
- NEW STREAM

BUFFER IMPACTS	
BUFFER IMPACT ID	TOTAL
B1	19,128 SF

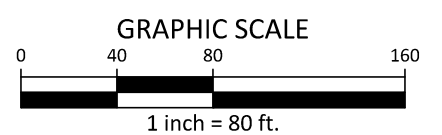
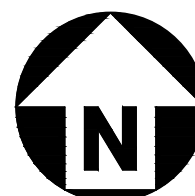

M:\Projects\WBP\WBP22002\04-Production\Engineering\Exhibits\Buffer Impacts\WBP22002-BI1.dwg, 11/9/2022 12:14:34 PM, Linda Vasil



The John R. McAdams Company, Inc.
 621 Hillsborough Street
 Suite 500
 Raleigh, NC 27603
 phone 919. 361. 5000
 fax 919. 361. 2269
 license number: C-0293, C-187
 www.mcadamsco.com

SUMNER BLVD EXTENSION
 IMPACT AREA #1
 2300 SUMNER BOULEVARD
 RALEIGH, NC 27616
 FIGURE 16

PLAN INFORMATION
 PROJECT NO. WBP22002
 FILENAME WBP22002-BI1
 CHECKED BY LJV
 DRAWN BY LJV
 SCALE 1"=30'
 DATE 11.07.2022

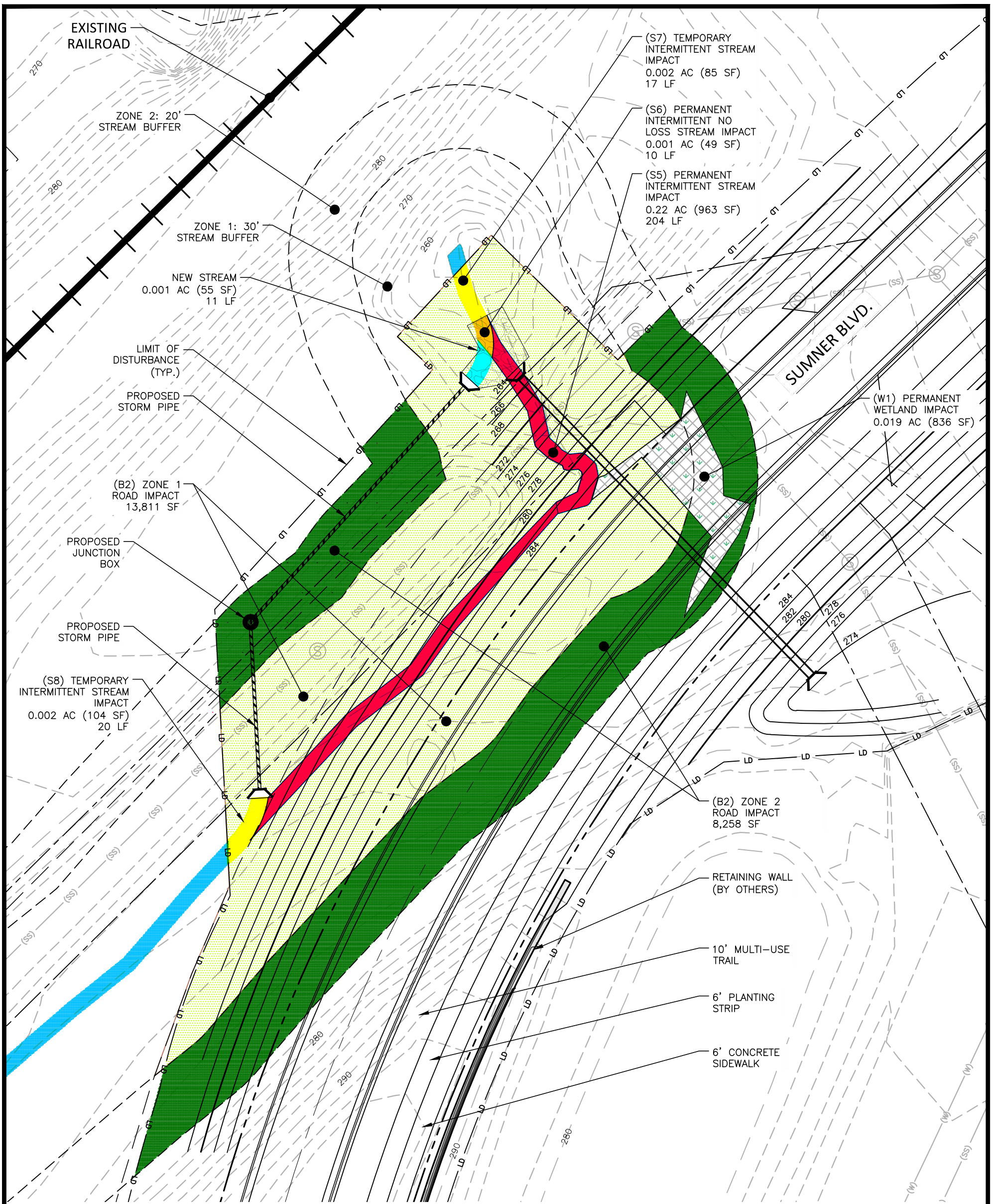

(S7) TEMPORARY
INTERMITTENT STREAM
IMPACT
0.002 AC (85 SF)
17 LF

(S6) PERMANENT
INTERMITTENT NO
LOSS STREAM IMPACT
0.001 AC (49 SF)
10 LF

(S5) PERMANENT
INTERMITTENT STREAM
IMPACT
0.22 AC (963 SF)
204 LF

(W1) PERMANENT
WETLAND IMPACT
0.019 AC (836 SF)

ZONE 1: 30'
STREAM BUFFER

ZONE 2: 20'
STREAM BUFFER

NEW STREAM
0.001 AC (55 SF)
11 LF

LIMIT OF
DISTURBANCE
(TYP.)

PROPOSED
STORM PIPE

(B2) ZONE 1
ROAD IMPACT
13,811 SF

PROPOSED
JUNCTION
BOX

PROPOSED
STORM PIPE

(S8) TEMPORARY
INTERMITTENT STREAM
IMPACT
0.002 AC (104 SF)
20 LF

(B2) ZONE 2
ROAD IMPACT
8,258 SF

RETAINING WALL
(BY OTHERS)

10' MULTI-USE
TRAIL

6' PLANTING
STRIP

6' CONCRETE
SIDEWALK

LEGEND:

- PERMANENT WETLAND IMPACT
- WETLAND
- ZONE 2 BUFFER IMPACT (ROAD)
- ZONE 1 BUFFER IMPACT (ROAD)
- PERMANENT - NO LOSS STREAM IMPACT
- PERMANENT - STREAM IMPACT

- TEMPORARY STREAM IMPACT
- STREAM
- NEW STREAM

BUFFER IMPACTS	
BUFFER IMPACT ID	TOTAL
B2	22,058 SF

WETLAND IMPACTS	
WETLAND IMPACT ID	TOTAL
W1	836 SF

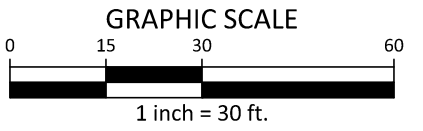
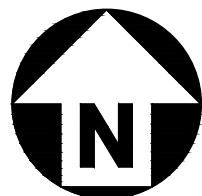

M:\Projects\WBP\WBP22002\04-Production\Engineering\Exhibits\Buffer Impacts\WBP22002-BI1.dwg, 11/9/2022 12:15:15 PM, Linda Vasil



The John R. McAdams Company, Inc.
621 Hillsborough Street
Suite 500
Raleigh, NC 27603

phone 919. 361. 5000
fax 919. 361. 2269
license number: C-0293, C-187

www.mcadamsco.com

SUMNER BLVD EXTENSION
IMPACT AREA #2
2300 SUMNER BOULEVARD
RALEIGH, NC 27616

FIGURE 17

PLAN INFORMATION

PROJECT NO.	WBP22002
FILENAME	WBP22002-BI1
CHECKED BY	LJV
DRAWN BY	LJV
SCALE	1"=30'
DATE	11.07.2022