

FIGURE NO.

1

WEPG

Wetlands and Environmental Planning Group
Leonard S. Rindner, PLLC.

len.rindner@wetlands-epg.com
(704) 904-2277
www.wetlands-epg.com

REA FARMS – EXISTING GOLF COURSE
Mecklenburg Co., NC

VICINITY MAP

Drawn By:
HAC

Reviewed By:
LSR

DATE:
1/15/2015



**PIN# 22917101, OWNER ELM GOLF LLC
 OWNER ADDR PO BOX 158 PINEVILLE NC 28277
 ACREAGE 187.5 PARCEL 11112 GOLF LINKS DR,
 CHARLOTTE, NC 28277**



FIGURE NO. 2	 Wetlands and Environmental Planning Group Leonard S. Rindner, PLLC. len.rindner@wetlands-epg.com (704) 904-2277 www.wetlands-epg.com	REA FARMS Mecklenburg Co., NC	Drawn By: HAC	Reviewed By: LSR
		Mecklenburg County Parcel Maps POLARIS 3G http://polaris3g.mecklenburgcountync.gov/	DATE: 1/15/15	



FIGURE NO.
4

WEPG

Wetlands and Environmental Planning Group
 Leonard S. Rindner, PLLC.

len.rindner@wetlands-epg.com
 (704) 904-2277
 www.wetlands-epg.com

REA FARMS
 Mecklenburg Co., NC

USGS MAP

Drawn By:
HAC

Reviewed By:
LSR

DATE:

2/18/15

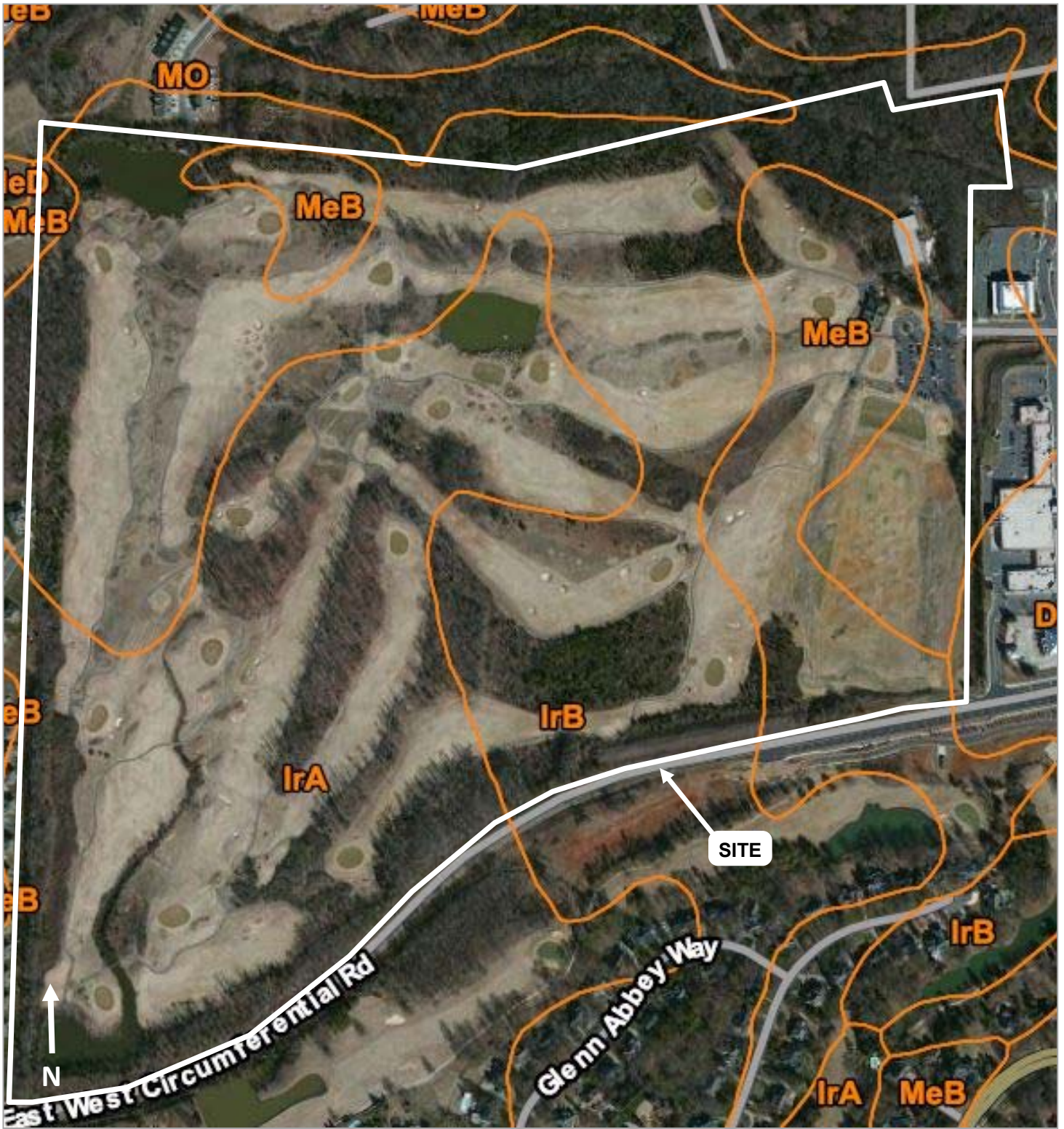

FIGURE NO.
5

WEPG

Wetlands and Environmental Planning Group
Leonard S. Rindner, PLLC.

len.rindner@wetlands-epg.com
(704) 904-2277
www.wetlands-epg.com

REA FARMS
Mecklenburg Co., NC

NRCS SOIL MAP

Drawn By:
HAC

Reviewed By:
LSR

DATE:
1/15/2015

Map Unit Legend

Mecklenburg County, North Carolina (NC119)			
Map Unit Symbol	Map Unit Name	Acres in AOI	Percent of AOI
DaB	Davidson sandy clay loam, 2 to 8 percent slopes	27.9	7.5%
DaD	Davidson sandy clay loam, 8 to 15 percent slopes	1.5	0.4%
IrA	Iredell fine sandy loam, 0 to 1 percent slopes	104.6	28.0%
IrB	Iredell fine sandy loam, 1 to 8 percent slopes	153.5	41.1%
MeB	Mecklenburg fine sandy loam, 2 to 8 percent slopes	60.5	16.2%
MeD	Mecklenburg fine sandy loam, 8 to 15 percent slopes	9.6	2.6%
MO	Monacan loam, 0 to 2 percent slopes, frequently flooded	15.6	4.2%
Totals for Area of Interest		373.3	100.0%

FIGURE NO.
6

WEPG

Wetlands and Environmental Planning Group
Leonard S. Rindner, PLLC.

len.rindner@wetlands-epg.com
(704) 904-2277
www.wetlands-epg.com

REA FARMS
Mecklenburg Co., NC

Drawn By:
LRG

Reviewed By:
LSR

NRCS SOIL MAP 2

DATE:
1/15/2015

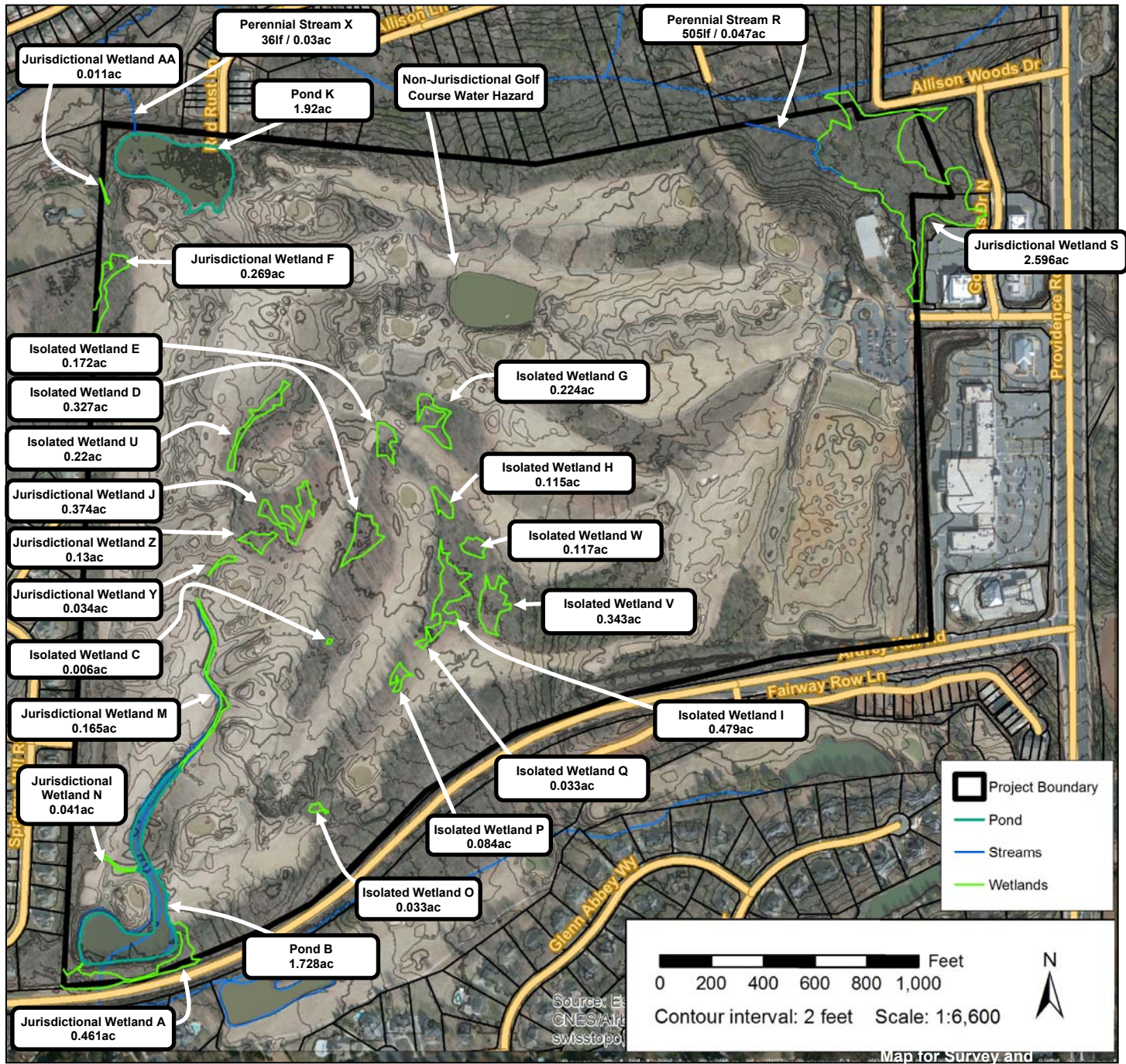

FIGURE NO. <p style="text-align: center;">9</p> <p style="font-size: 2em; font-weight: bold; margin: 0;">WEPG</p> <p style="margin: 0;">Wetlands and Environmental Planning Group Leonard S. Rindner, PLLC.</p> <p style="margin: 0;">len.rindner@wetlands-epg.com (704) 904-2277 www.wetlands-epg.com</p>	REA FARMS Mecklenburg Co., NC		Drawn By: HAC	Reviewed By: LSR
	DELINEATION MAP – WATERS OF THE U.S. <div style="border: 1px solid black; padding: 5px; display: inline-block; background-color: yellow;"> Site Verified By USACE 2-6-15 </div>		DATE: 4/1/15	

Flow Path: There are two flow pathways located on the site. Jurisdictional features on the site flow into either 1) unnamed tributaries to Flat Branch to Sixmile Creek then to Twelvemile Creek (TNW) or 2) through unnamed tributaries to Sixmile Creek then to Twelvemile Creek (TNW).

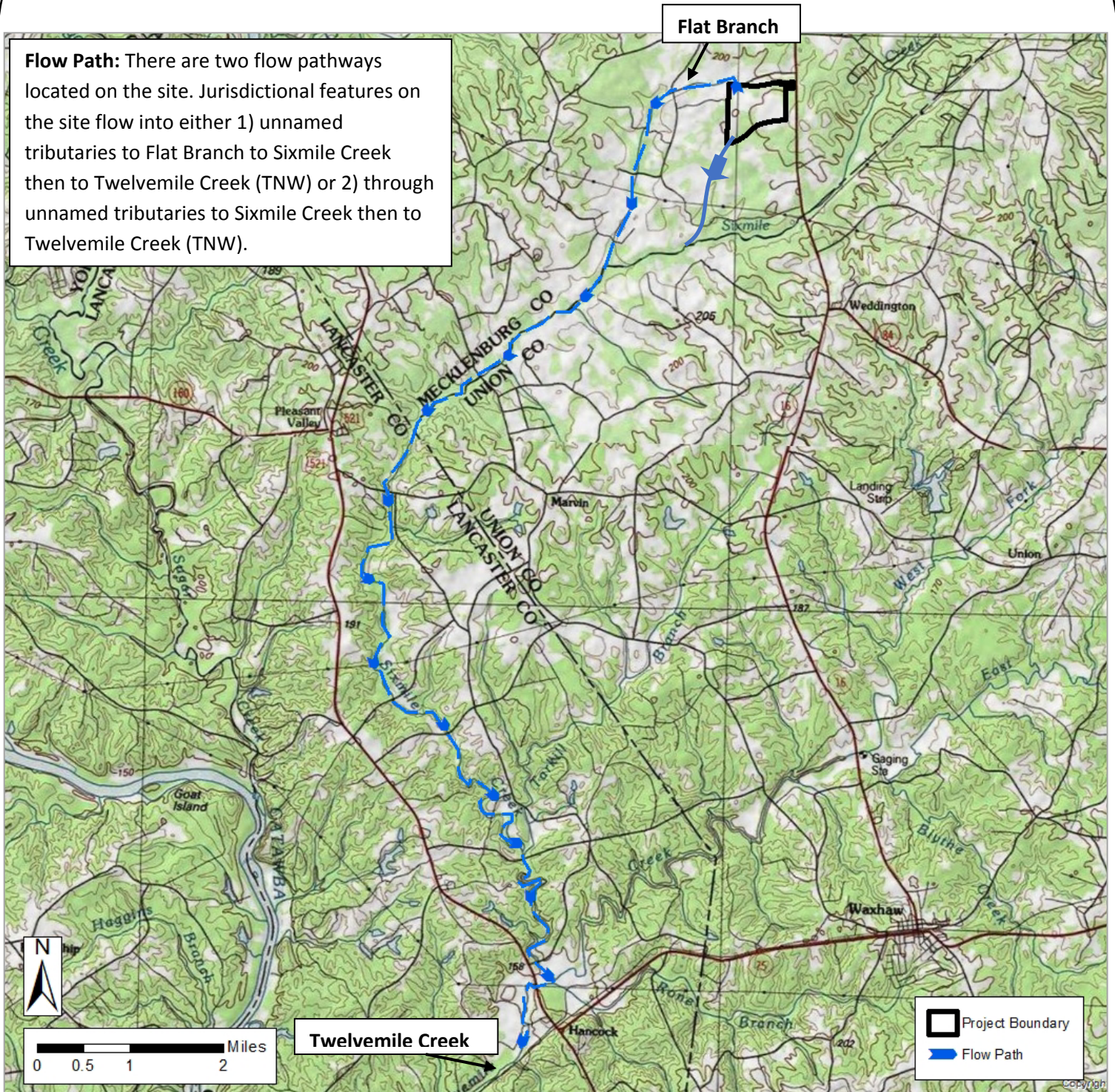

FIGURE NO.
11

WEPG

Wetlands and Environmental Planning Group
Leonard S. Rindner, PLLC.

len.rindner@wetlands-epg.com
(704) 904-2277
www.wetlands-epg.com

REA FARMS
Mecklenburg Co., NC

Drawn By:
HAC



Reviewed By:
LSR

Navigation Pathway Map
*Approximate boundary

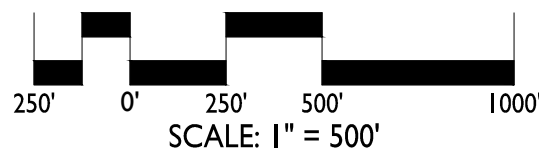
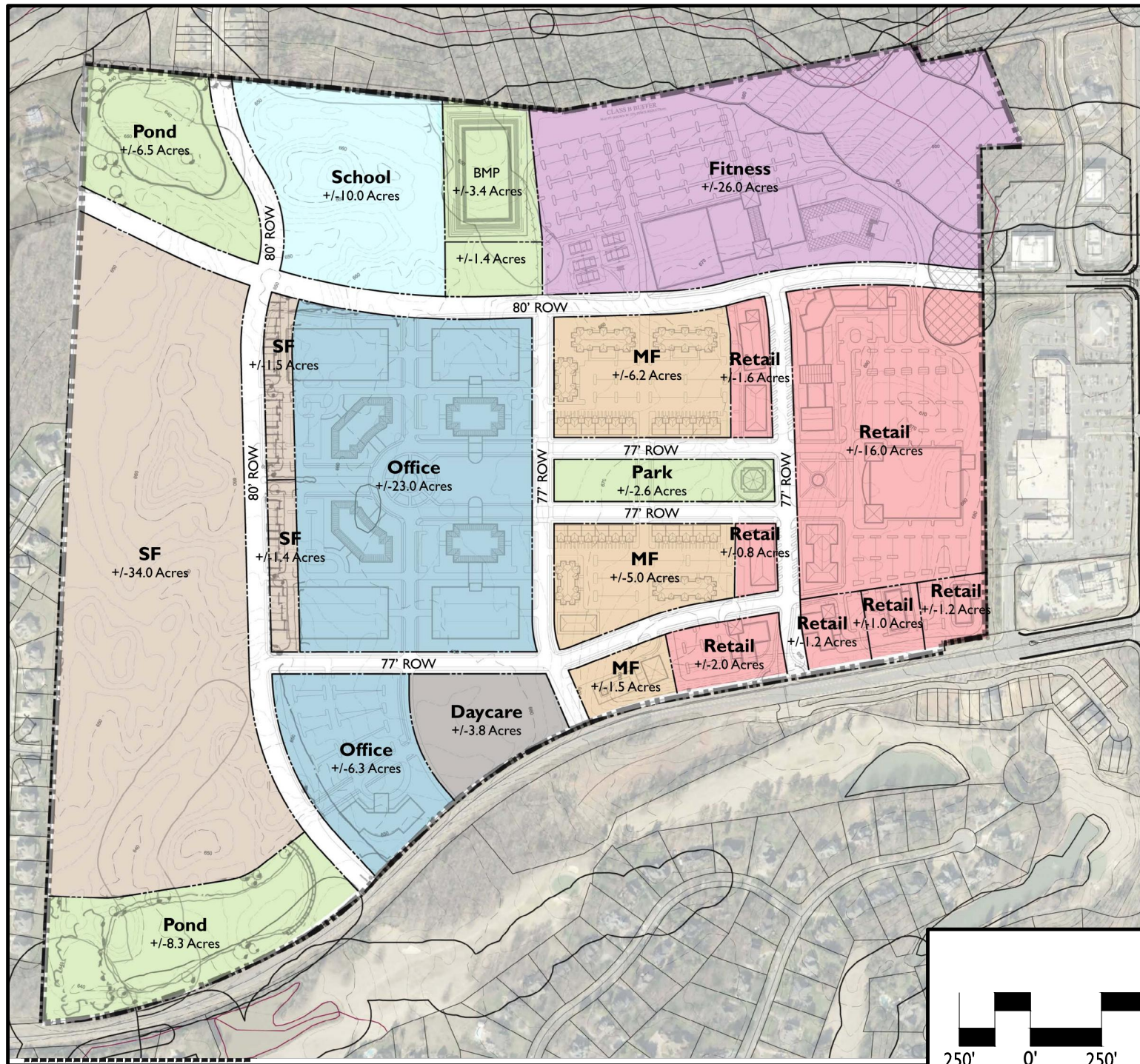
DATE:
1/28/15

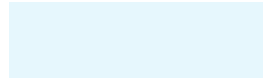
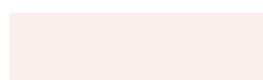
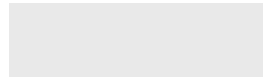

Site Information

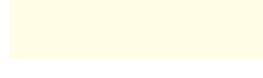
- Disturbed Wetlands 
- Undisturbed Wetlands 
- Retail 
- Office/Civic 
- Multi-family Res. 
- Single-family Res. 





Rea Farms

Charlotte, NC
Wetlands Exhibit - Master Plan 05.06.2015 | LDI#1014048

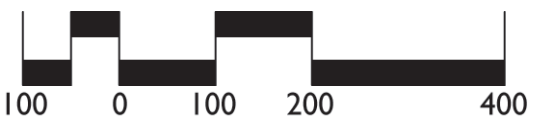
LandDesign

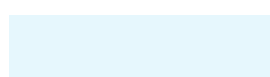
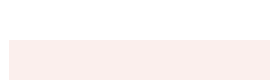

Site Information

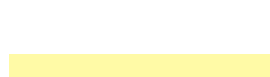
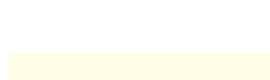
- Disturbed Wetlands 
- Undisturbed Wetlands 
- Retail 
- Office/Civic 
- Multi-family Res. 
- Single-family Res. 



Rea Farms

Charlotte, NC
Wetlands Exhibit - Option I with Master Plan 05.06.2015 |

LandDesign

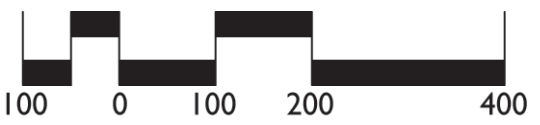

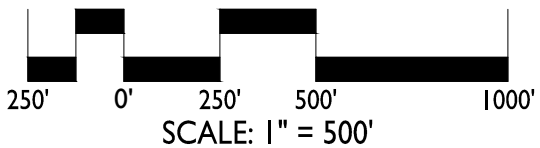
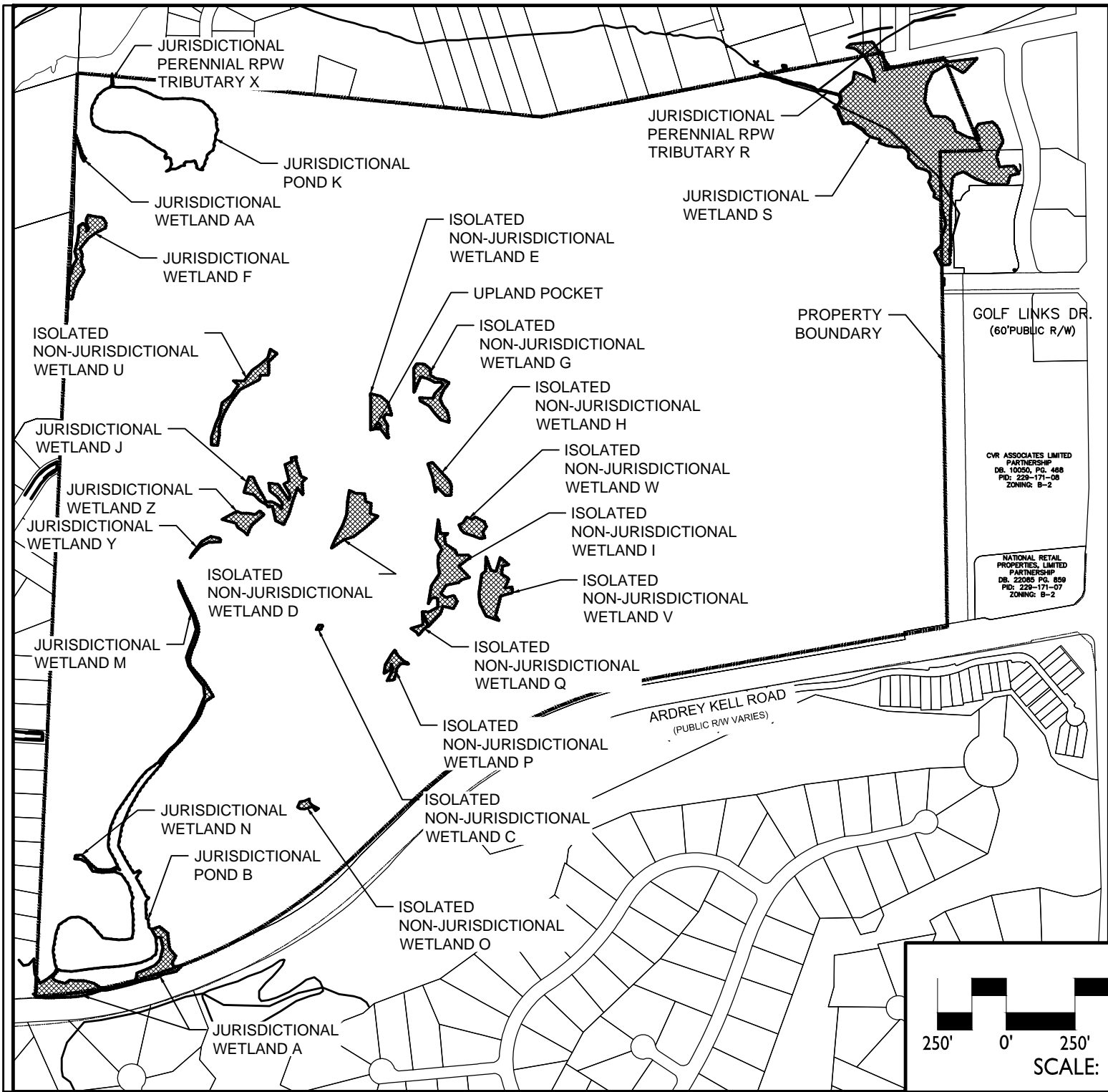

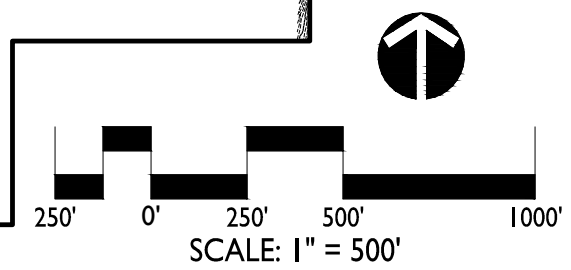
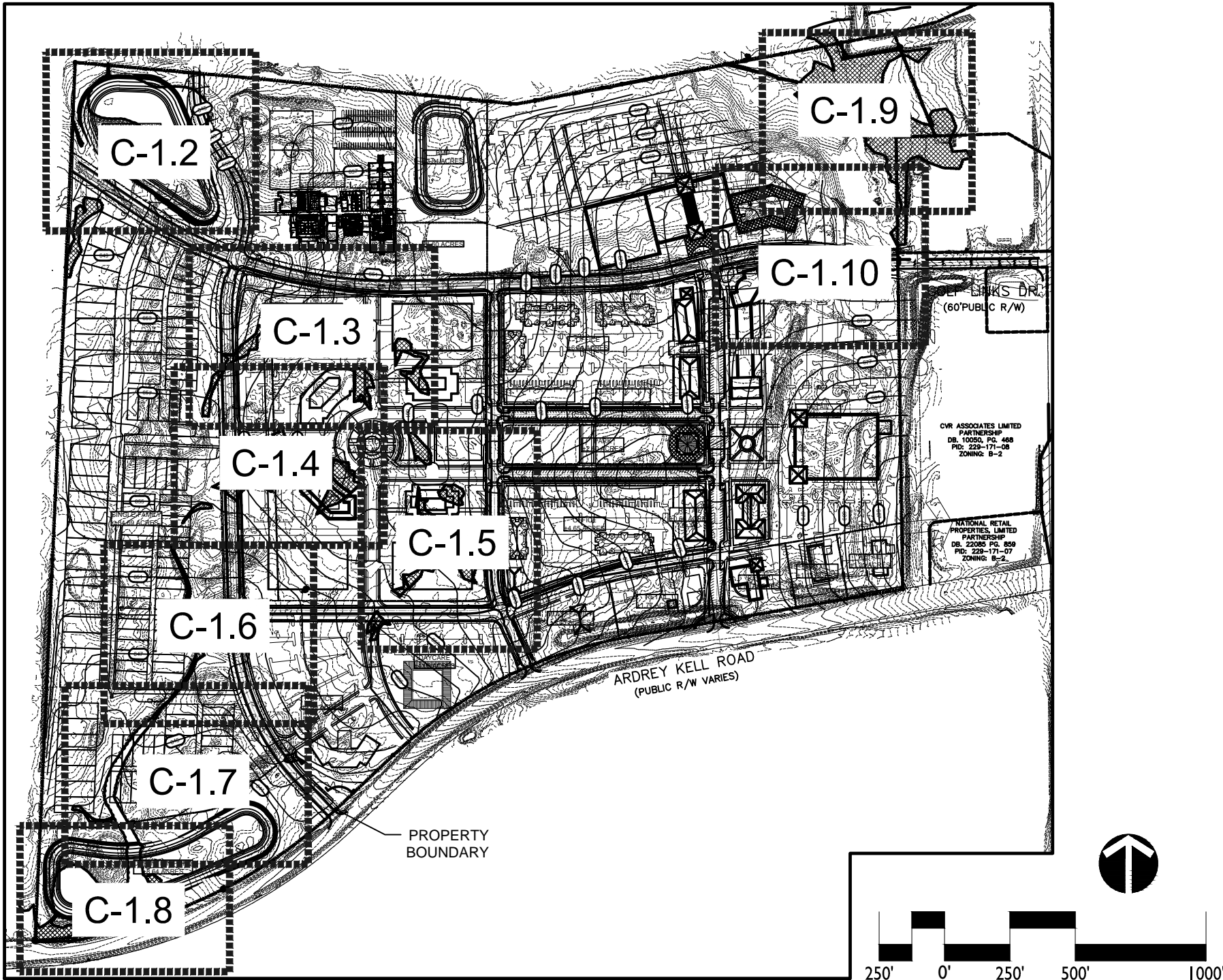

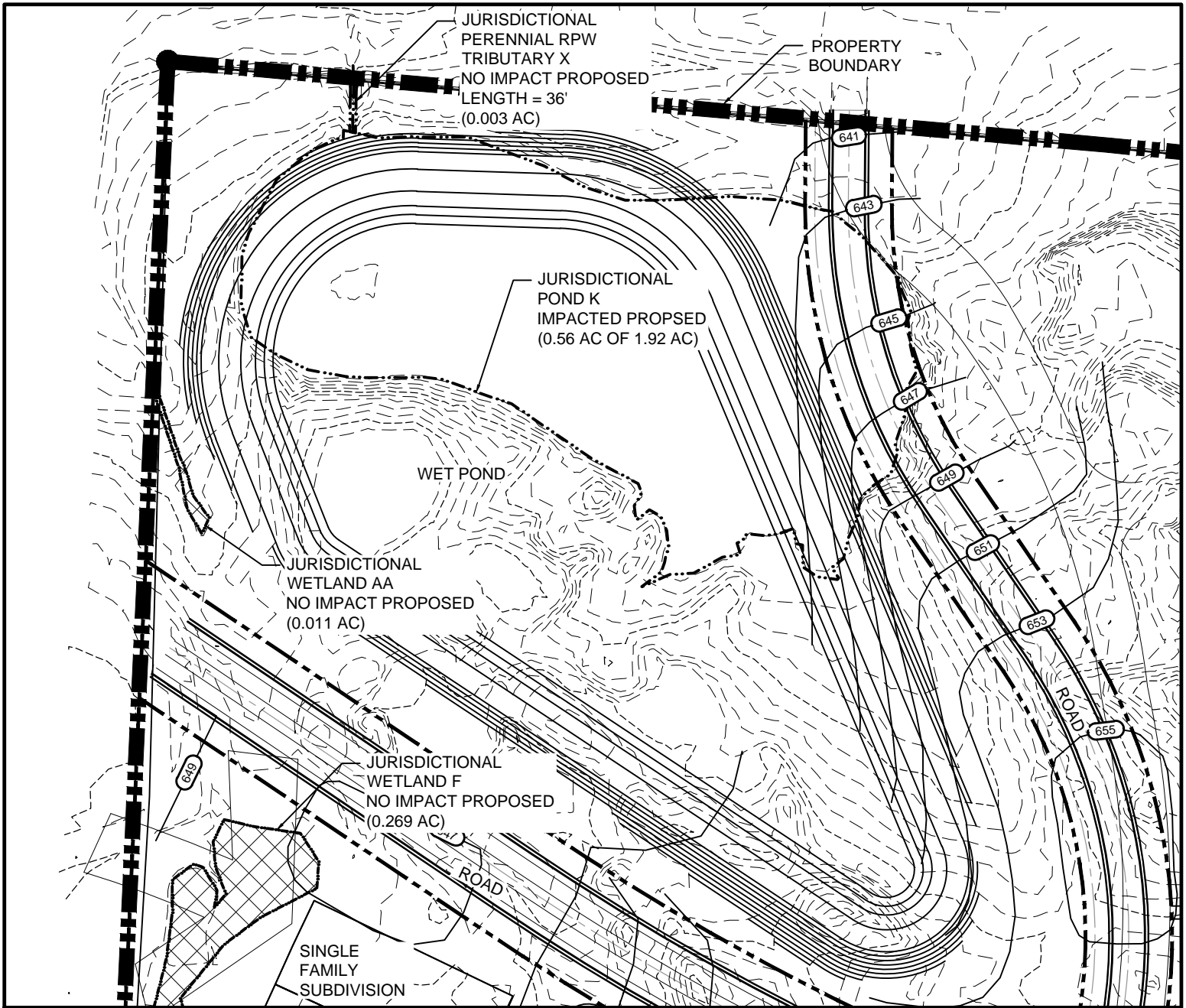

FOR USACOE PERMITTING ONLY.
 DESIGN EVALUATION BASED ON PHYSICAL
 DATA AND LIDAR TOPOGRAPHY

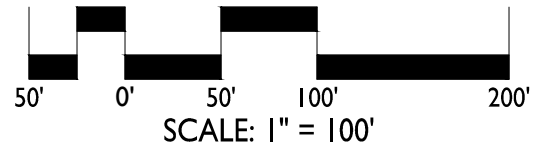

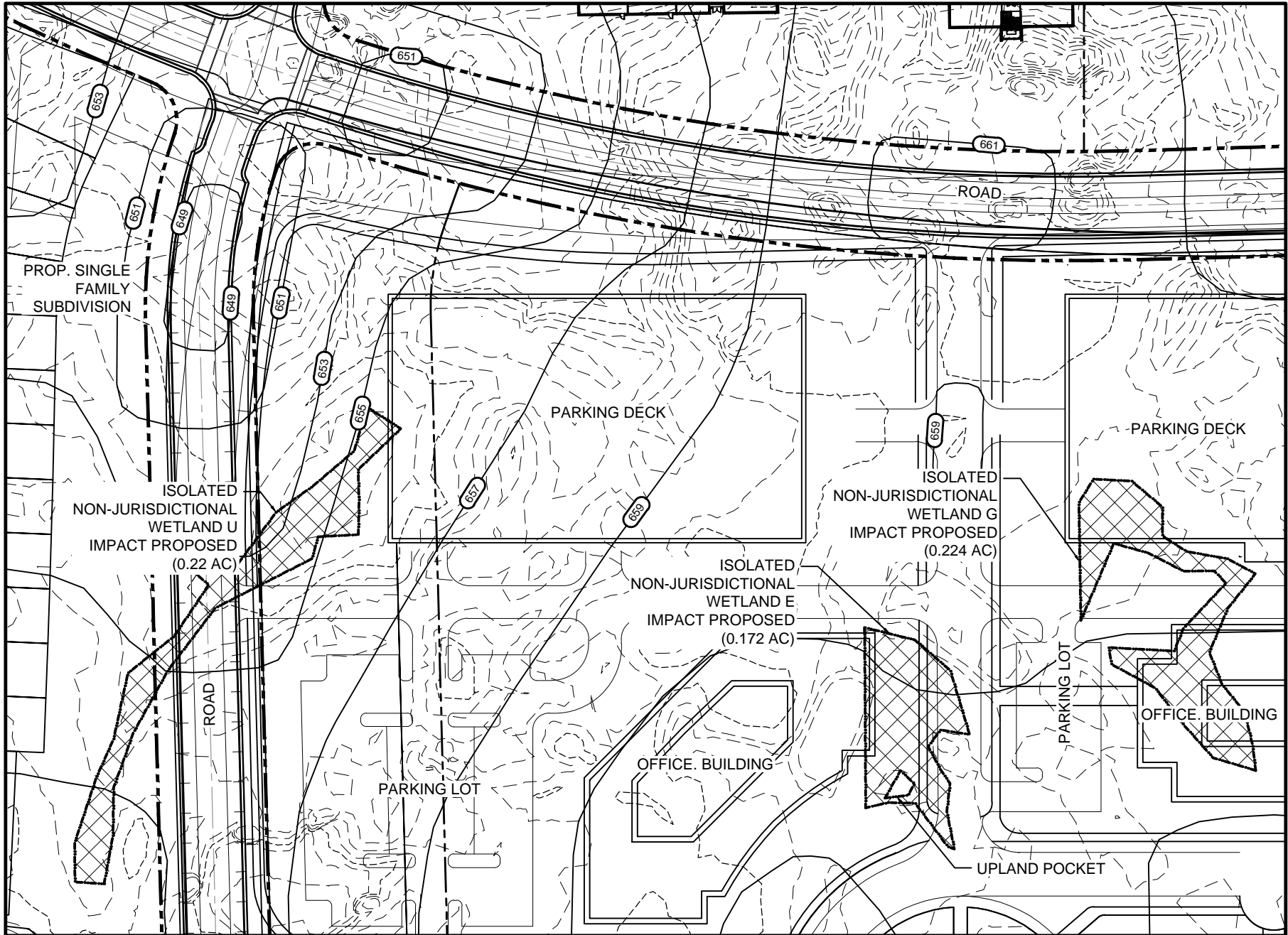

FOR USACOE PERMITTING ONLY.
 DESIGN EVALUATION BASED ON PHYSICAL
 DATA AND LIDAR TOPOGRAPHY

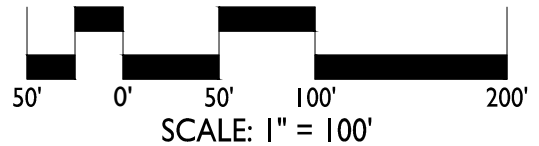

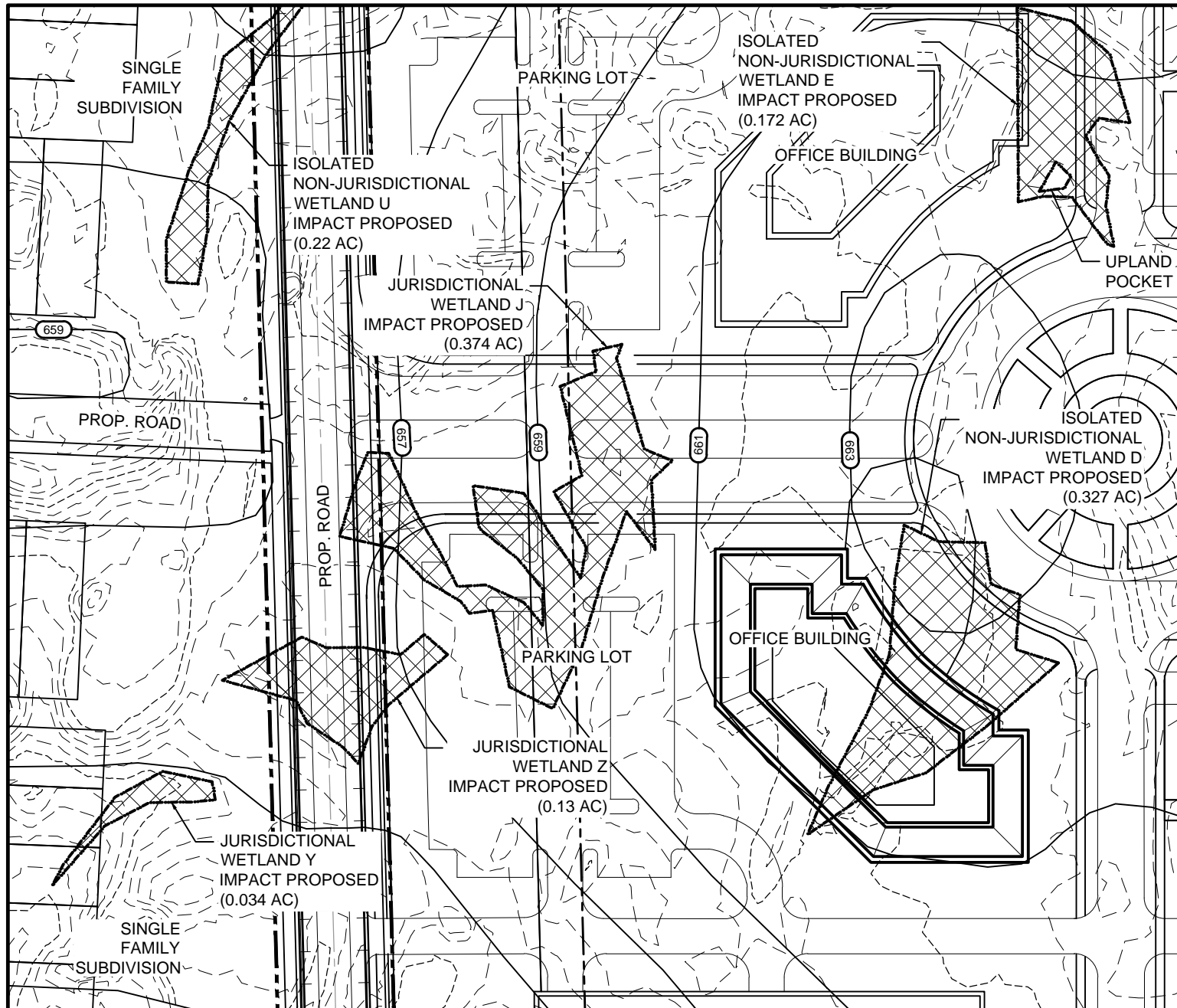

FOR USACOE PERMITTING ONLY.
 DESIGN EVALUATION BASED ON PHYSICAL
 DATA AND LIDAR TOPOGRAPHY

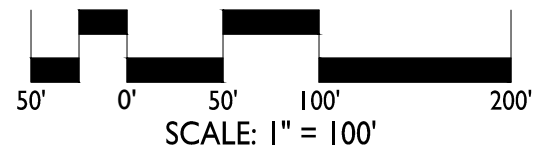

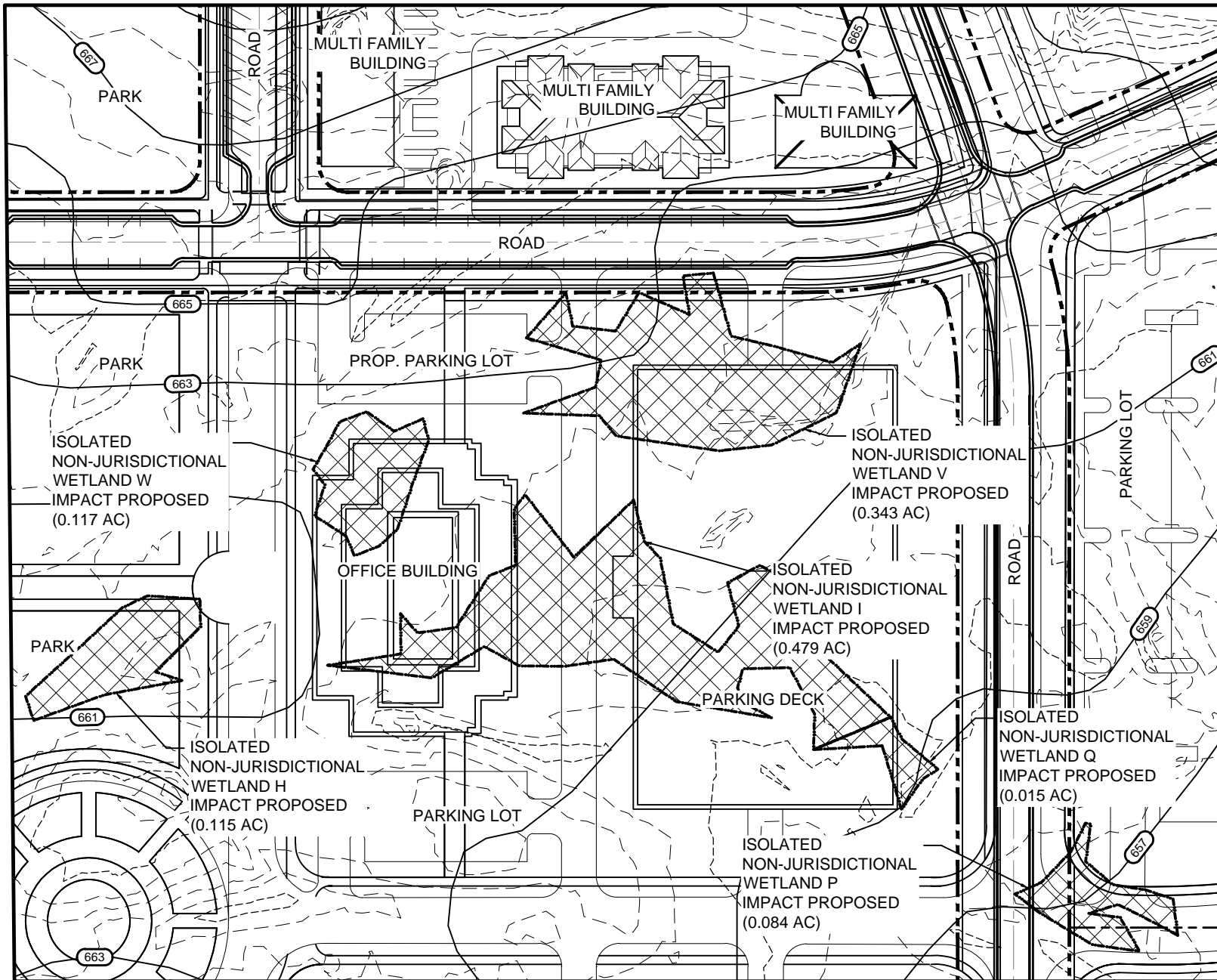

FOR USACOE PERMITTING ONLY.
 DESIGN EVALUATION BASED ON PHYSICAL
 DATA AND LIDAR TOPOGRAPHY

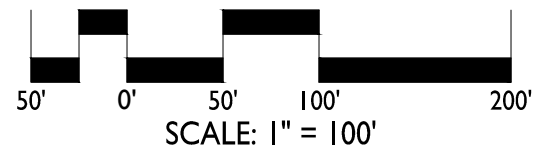

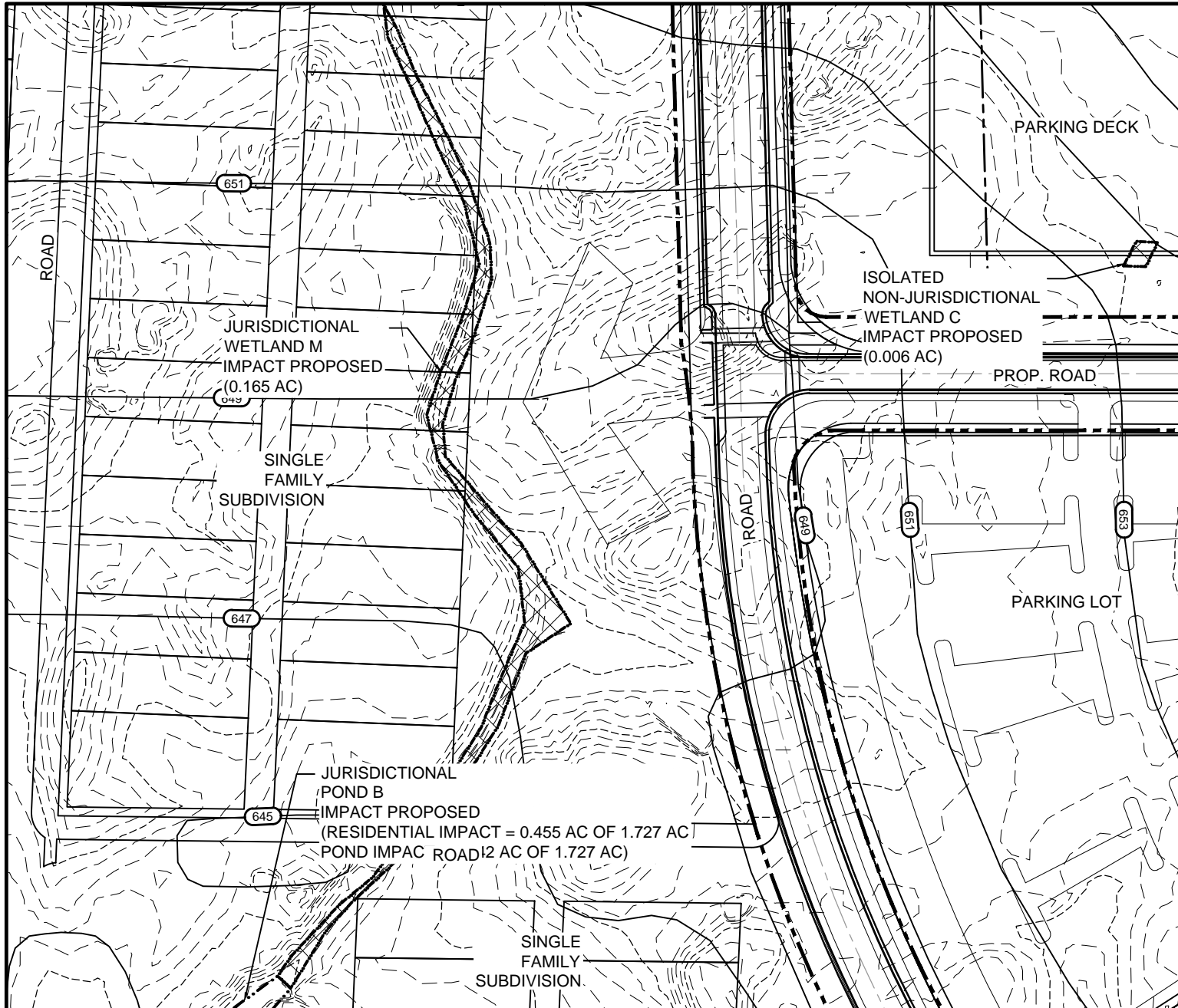

FOR USACOE PERMITTING ONLY.
 DESIGN EVALUATION BASED ON PHYSICAL
 DATA AND LIDAR TOPOGRAPHY

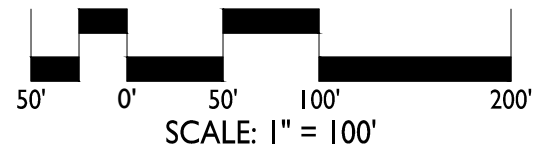

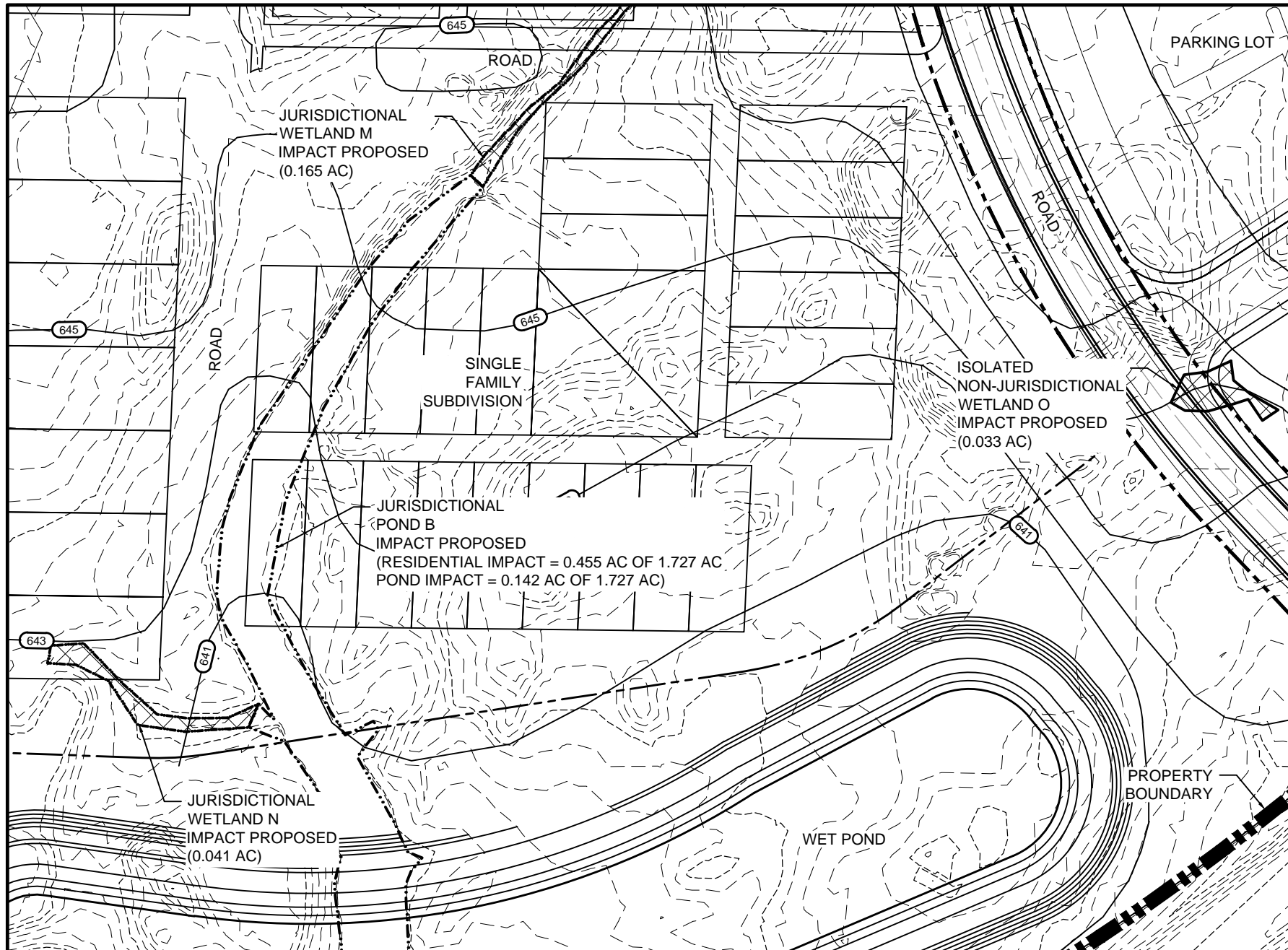

FOR USACOE PERMITTING ONLY.
 DESIGN EVALUATION BASED ON PHYSICAL
 DATA AND LIDAR TOPOGRAPHY

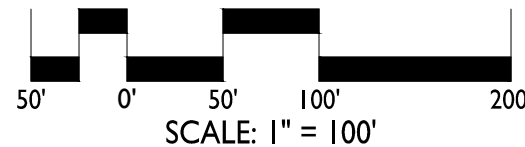

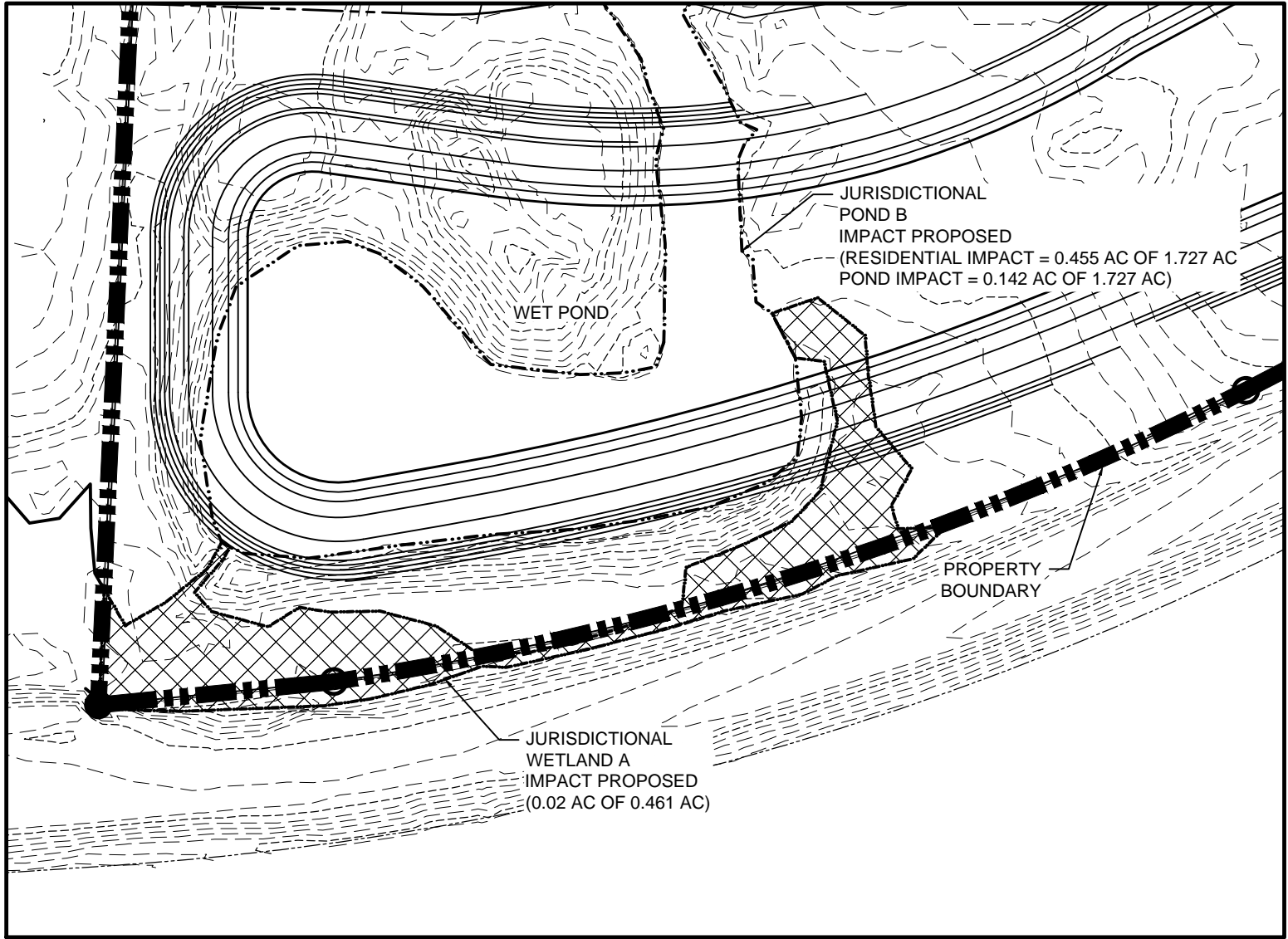

FOR USACOE PERMITTING ONLY.
 DESIGN EVALUATION BASED ON PHYSICAL
 DATA AND LIDAR TOPOGRAPHY

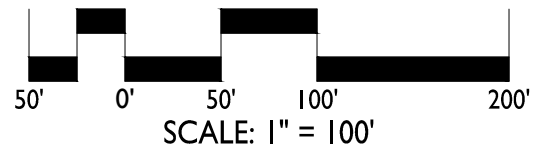

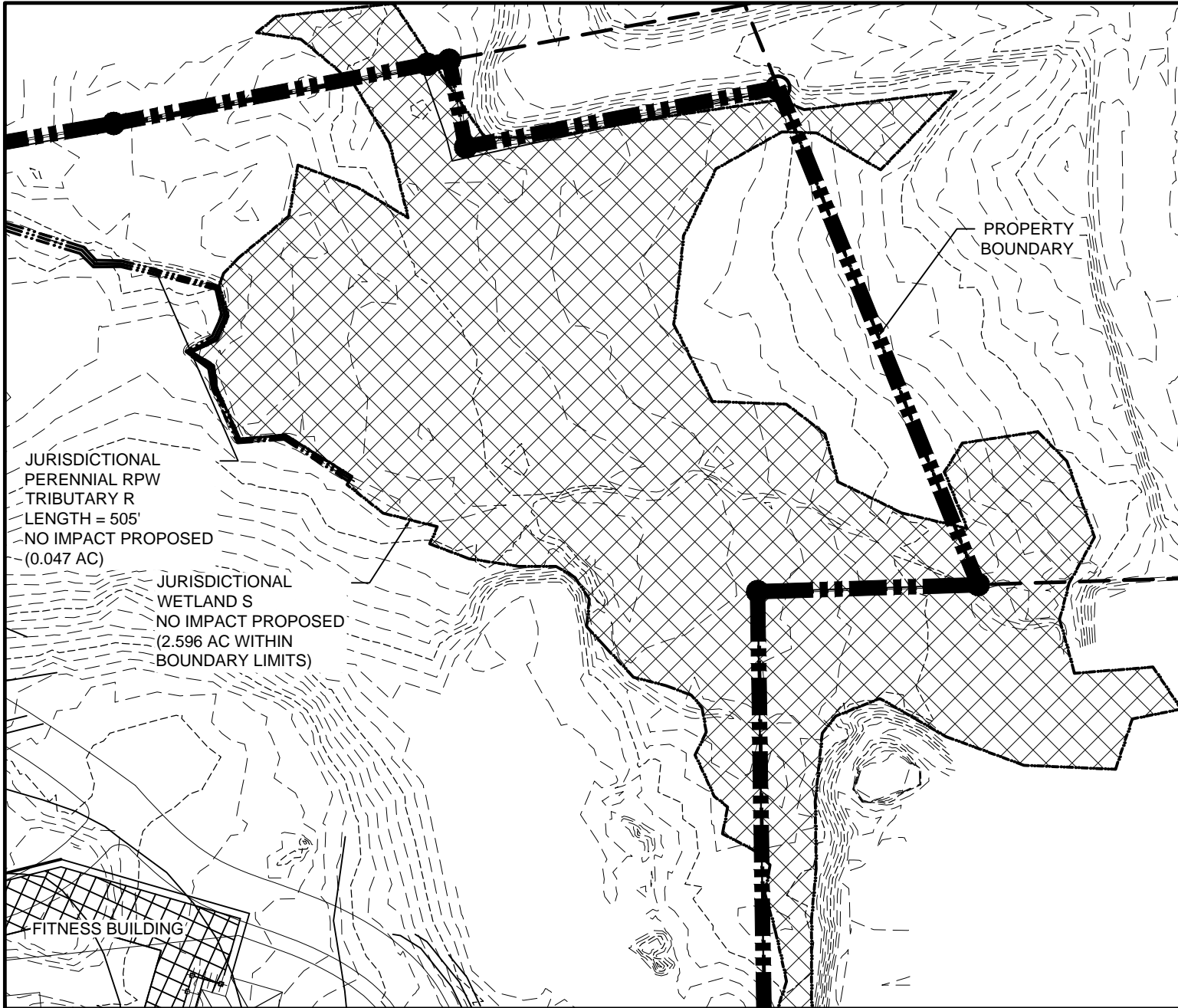

JURISDICTIONAL
PERENNIAL RPW
TRIBUTARY R
LENGTH = 505'
NO IMPACT PROPOSED
(0.047 AC)

JURISDICTIONAL
WETLAND S
NO IMPACT PROPOSED
(2.596 AC WITHIN
BOUNDARY LIMITS)

PROPERTY
BOUNDARY

FITNESS BUILDING

FOR USACOE PERMITTING ONLY.
DESIGN EVALUATION BASED ON PHYSICAL
DATA AND LIDAR TOPOGRAPHY

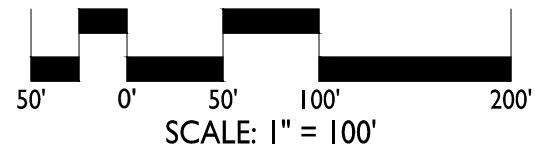

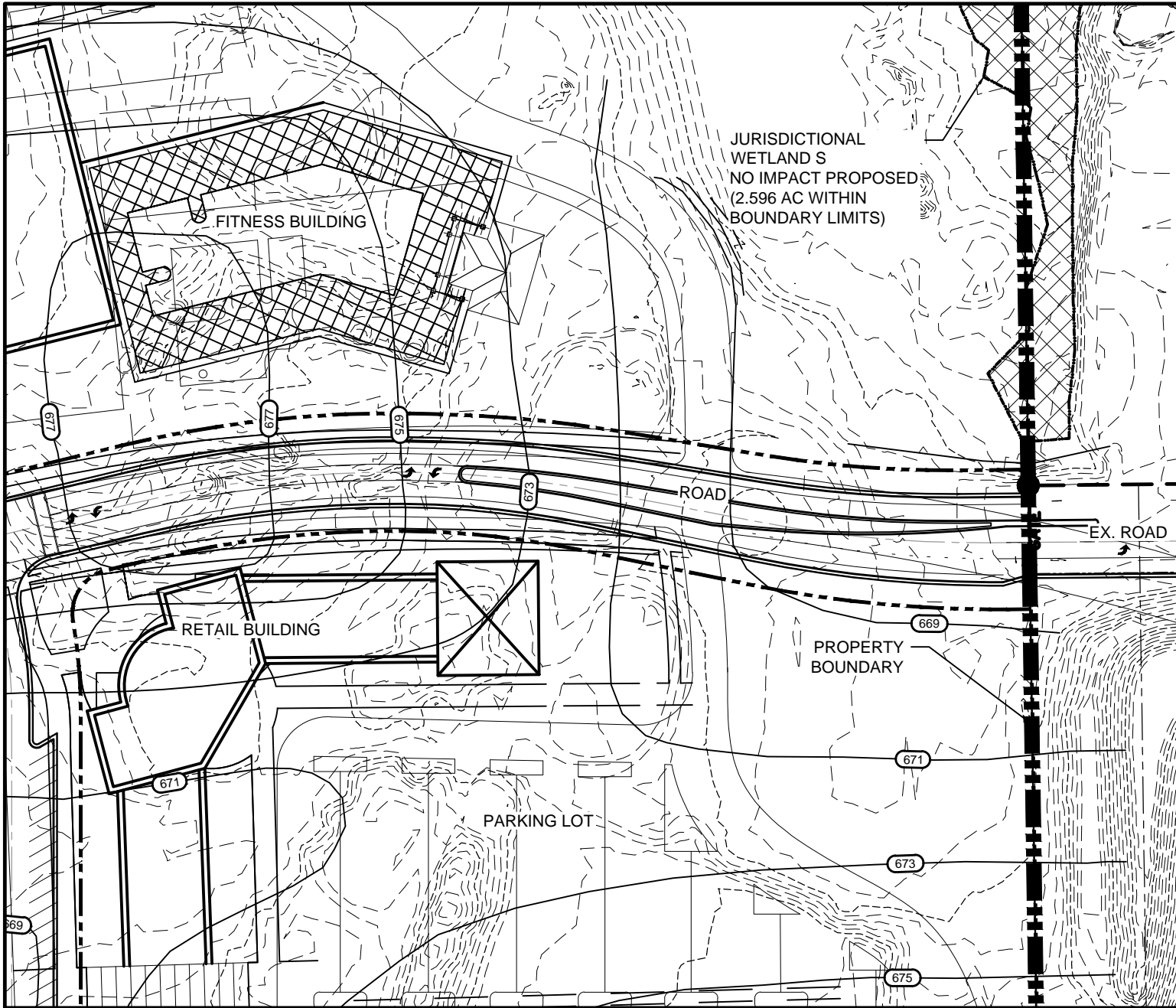

JURISDICTIONAL
WETLANDS
NO IMPACT PROPOSED
(2.596 AC WITHIN
BOUNDARY LIMITS)

FOR USACOE PERMITTING ONLY.
DESIGN EVALUATION BASED ON PHYSICAL
DATA AND LIDAR TOPOGRAPHY

