

09/08/09

See Sheet 1-A For Index of Sheets (Not Included in R/W Plans)

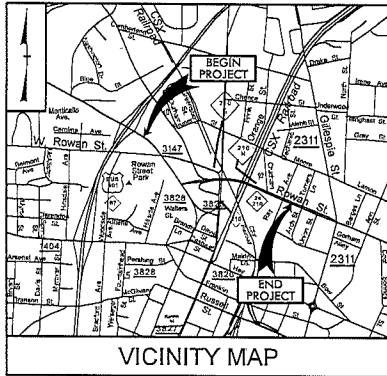

NOT TO SCALE

ROW PLANS

STATE OF NORTH CAROLINA
DIVISION OF HIGHWAYS
CUMBERLAND COUNTY

LOCATION: BRIDGE NO. 116 OVER CSX RR, NORFOLK SOUTHERN RR,
AND HILLSBORO STREET ON NC 24210
TYPE OF WORK: GRADING, PAVING, DRAINAGE, RETAINING WALL, AND STRUCTURE

WETLAND AND SURFACE WATER IMPACTS PERMIT

STATE	STATE PROJECT REFERENCE NO.	PROJECT NO.	TOTAL SHEETS
N.C.	B-4490	1	
STATE PROJECT	S.A. NUMBER	DESCRIPTION	
33727.1.1	BRNHS-0024(24)	P.E.	
33727.2.FST	BRNHS-0024(24)	RW	
33727.2.FSU1	BRNHS-0024(24)	UTILITIES	

TIP PROJECT: B-4490

CONTRACT:

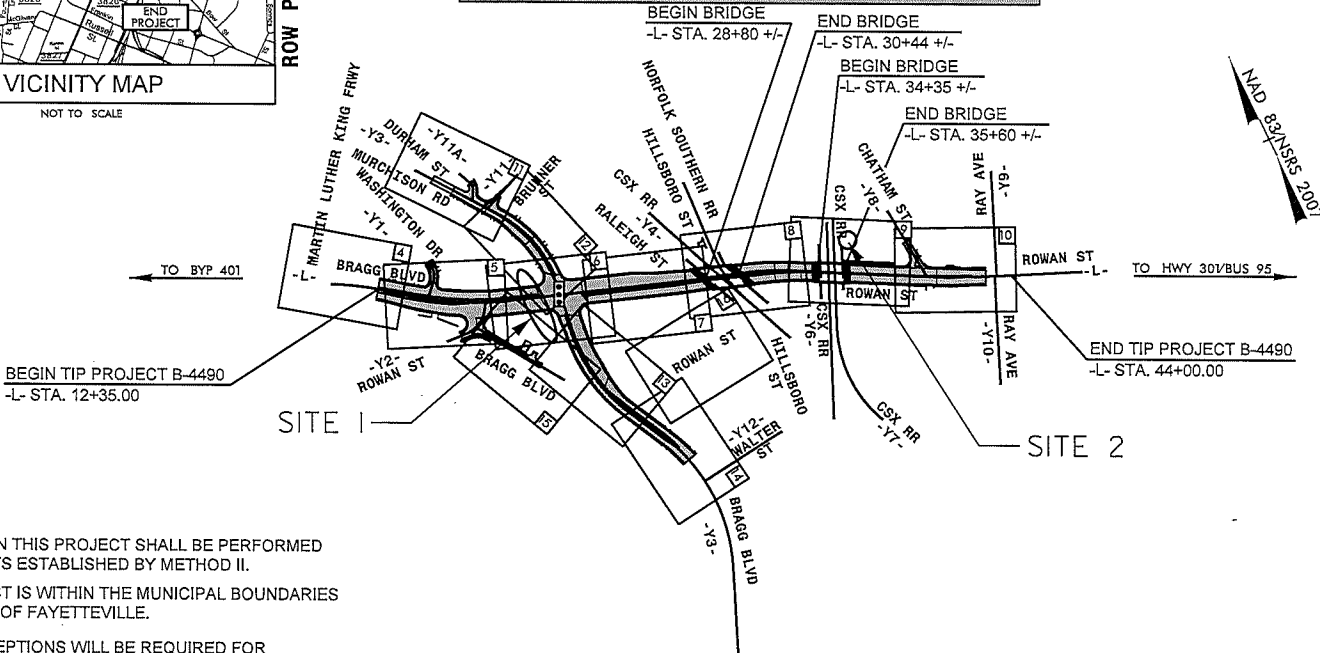

CLEARING ON THIS PROJECT SHALL BE PERFORMED TO THE LIMITS ESTABLISHED BY METHOD II.
THIS PROJECT IS WITHIN THE MUNICIPAL BOUNDARIES OF THE CITY OF FAYETTEVILLE.
DESIGN EXCEPTIONS WILL BE REQUIRED FOR EXCEEDING MAXIMUM GRADE ON -L- AND THE SUPERELEVATION ALONG -L- THROUGH THE INTERSECTION WITH -Y3-

PERMIT DRAWING SHEET 1 OF 14
PRELIMINARY PLANS DO NOT USE FOR CONSTRUCTION

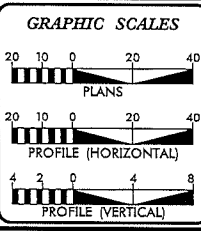

DESIGN DATA

ADT 2015 =	34,813
ADT 2035 =	47,596
DHV =	10 %
D =	55 %
T =	3 % *
V =	40 MPH
(* TTST 1% + DUAL 2%)	
FUNC CLASS =	URBAN PRINCIPAL ARTERIAL REGIONAL TIER

PROJECT LENGTH

LENGTH ROADWAY TIP PROJECT B-4490 =	0.544 MILES
LENGTH STRUCTURE TIP PROJECT B-4490 =	0.055 MILES
TOTAL LENGTH TIP PROJECT B-4490 =	0.599 MILES

PLANS PREPARED BY: PARSONS BRINCKERHOFF 311 EAST WILKIE STREET RICHMOND, VA 23219 NORTH CAROLINA DIVISION	PLANS PREPARED FOR: DIVISION OF HIGHWAYS 1000 Birch Ridge Dr. Raleigh, NC, 27610
RIGHT OF WAY DATE: DECEMBER 31, 2013	TIM HAYES, PE PROJECT ENGINEER
LETTING DATE: DECEMBER 15, 2015	DAVIN WALLACE, PE PROJECT DESIGN ENGINEER
NCDOT CONTACT:	BRENDA MOORE, PE, CPM

HYDRAULICS ENGINEER

SIGNATURE: _____ P.E.

ROADWAY DESIGN ENGINEER

SIGNATURE: _____ P.E.



11/09/2014 slykes R:\Hydraulics\PERMITS_Environment\Drawings\B-4490_rdy_tsh.dgn

8/17/95



DENOTES TEMPORARY IMPACTS IN SURFACE WATER



DENOTES IMPACTS IN SURFACE WATER

40' 0' 40'

GRAPHIC SCALE

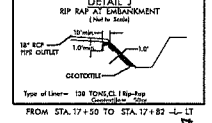

FROM STA. 17+50 TO STA. 17+83 -L- LT

MATCH LINE SEE SHEET 4
-L- STA. 13+40.00

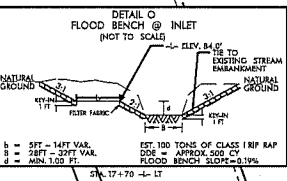

-Y1- PC Sta. 11+42.00

MATCH LINE
-Y1- STA. 11+80.00

BEGIN CONSTRUCTION
-Y1- POC Sta. 11+50.00

-Y2- POT Sta. 13+00.00

END CONSTRUCTION
-Y2- POT Sta. 12+34.00

-Y2- PT Sta. 11+96.43

PROJECT REFERENCE NO. B-4490		SHEET NO. 5	
ROADWAY DESIGN ENGINEER		HYDRAULICS ENGINEER	
PRELIMINARY PLANS DO NOT USE FOR CONSTRUCTION			

PLANS PREPARED BY:

MATCH LINE SEE SHEET 12
INSET A

Site 1

-Y1- POC Sta. 11+75.00 =
-Y2- POT Sta. 10+00.00

-Y2- PC Sta. 10+33.95

-Y2- POT Sta. 11+36.74 =
-Y2- POT Sta. 10+00.00

MATCH LINE SEE SHEET 6
-L- STA. 18+50.00

MATCH LINE SEE SHEET 15
-DRI- STA. 10+80.00

PERMIT DRAWING
SHEET 2 OF 14

11/24/2014
cafreeman2
R:\Hydraulics\PERMITS_Environmental\Drawings\B4490_Hyd_prm_wet_2.dgn

8/17/95



DENOTES TEMPORARY IMPACTS IN SURFACE WATER

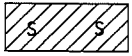

DENOTES IMPACTS IN SURFACE WATER

40' 0' 40'

GRAPHIC SCALE

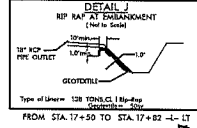

FROM STA. 17+50 TO STA. 17+82 -L- LT

MATCH LINE SEE SHEET 4
-L- STA. 13+40.00

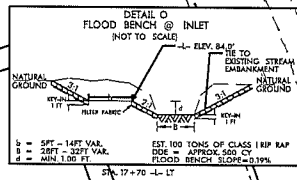

EST. 100 TONS OF CLASS 1 RIP RAP
DISE = APPROX. 500 CY
FLOOD BENCH 3.00M x 0.30M

MATCH LINE SEE
INSET IN THIS SHEET
-Y1- STA. 11+80.00

PLANS PREPARED BY:

PROJECT REFERENCE NO. B-490	SHEET NO. 5
RDW SHEET NO.	HYDRAULICS ENGINEER
ROADWAY DESIGN ENGINEER	HYDRAULICS ENGINEER
PRELIMINARY PLANS DO NOT USE FOR CONSTRUCTION	

Site 1

NAD 82/NSRS 2001

MATCH LINE SEE SHEET 6
-L- STA. 18+50.00

MATCH LINE SEE SHEET 15
-DR1- STA. 10+80.00

PERMIT DRAWING
SHEET 3 OF 14

11/24/2014
c:\freeman2
R:\Hydraulics\PERMITS_Environmental\Drawings\B4490_Hyd_prm_wet_3.con.dgn

8/17/14

PROJECT REFERENCE NO. B-4490	SHEET NO. 6
ROW SHEET NO.	HYDRAULICS ENGINEER
ROADWAY DESIGN ENGINEER	
PRELIMINARY PLANS DO NOT USE FOR CONSTRUCTION	

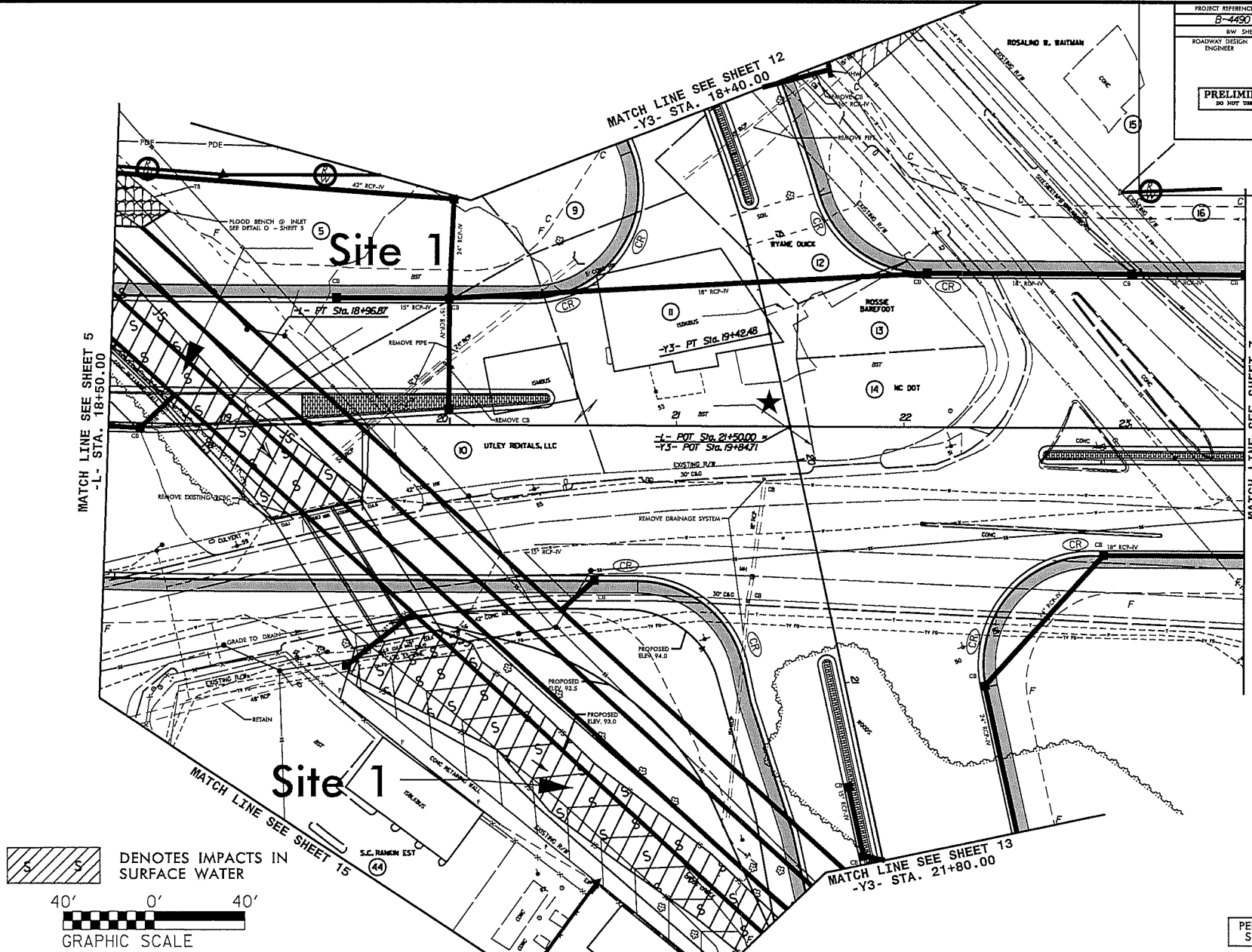

DENOTES IMPACTS IN SURFACE WATER

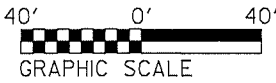

NAD DATUM 2011

MATCH LINE SEE SHEET 7
-L- STA. 23+50.00

MATCH LINE SEE SHEET 13
-Y3- STA. 21+80.00

MATCH LINE SEE SHEET 5
-L- STA. 18+50.00

MATCH LINE SEE SHEET 12
-Y3- STA. 18+40.00

Site 1

Site 1

11/19/2014
sjsykes
R:\Hydraulics\PERMITS_Environmental\Drawings\B4490_Hyd_prm_wet_4.dgn

PERMIT DRAWING
SHEET 4 OF 14

8/17/09

PROJECT REFERENCE NO. B-4490	SHEET NO. 6
RDW SHEET NO.	HYDRAULICS ENGINEER
ROADWAY DESIGN ENGINEER	
PRELIMINARY PLANS DO NOT USE FOR CONSTRUCTION	

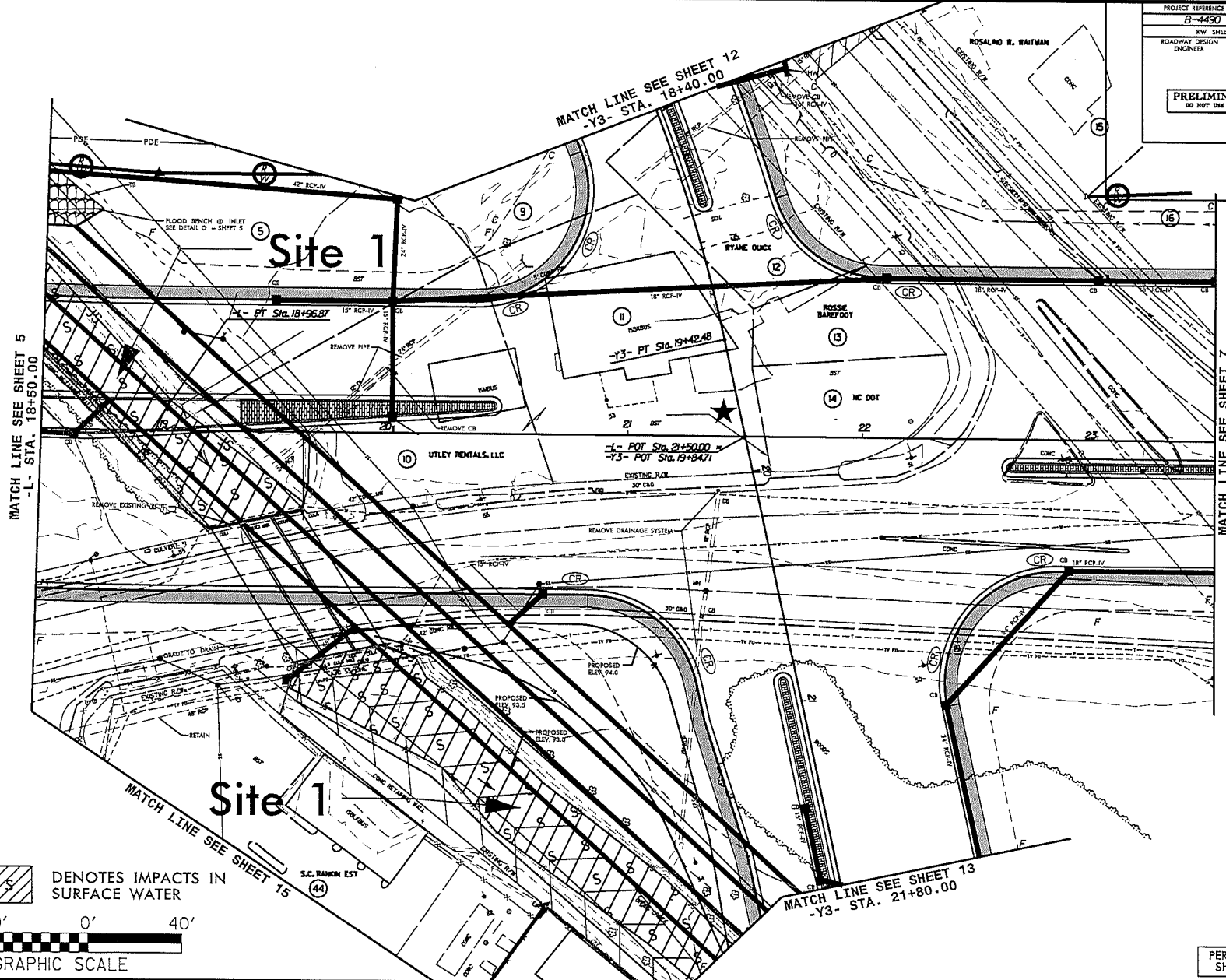

DENOTES IMPACTS IN SURFACE WATER

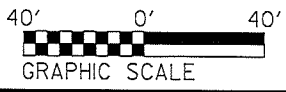

PERMIT DRAWING
SHEET 5 OF 14

1/19/2014
sisykes
R:\Hydraulics\PERMITS_Environmental\Drawings\B4490_Hyd_prm_wet_5con.dgn

11/9/2014
sjsykes
R:\Hydraulics\PERMITS\Environmental\Drawings\B4490_Hyd_prm_wet_6.dgn

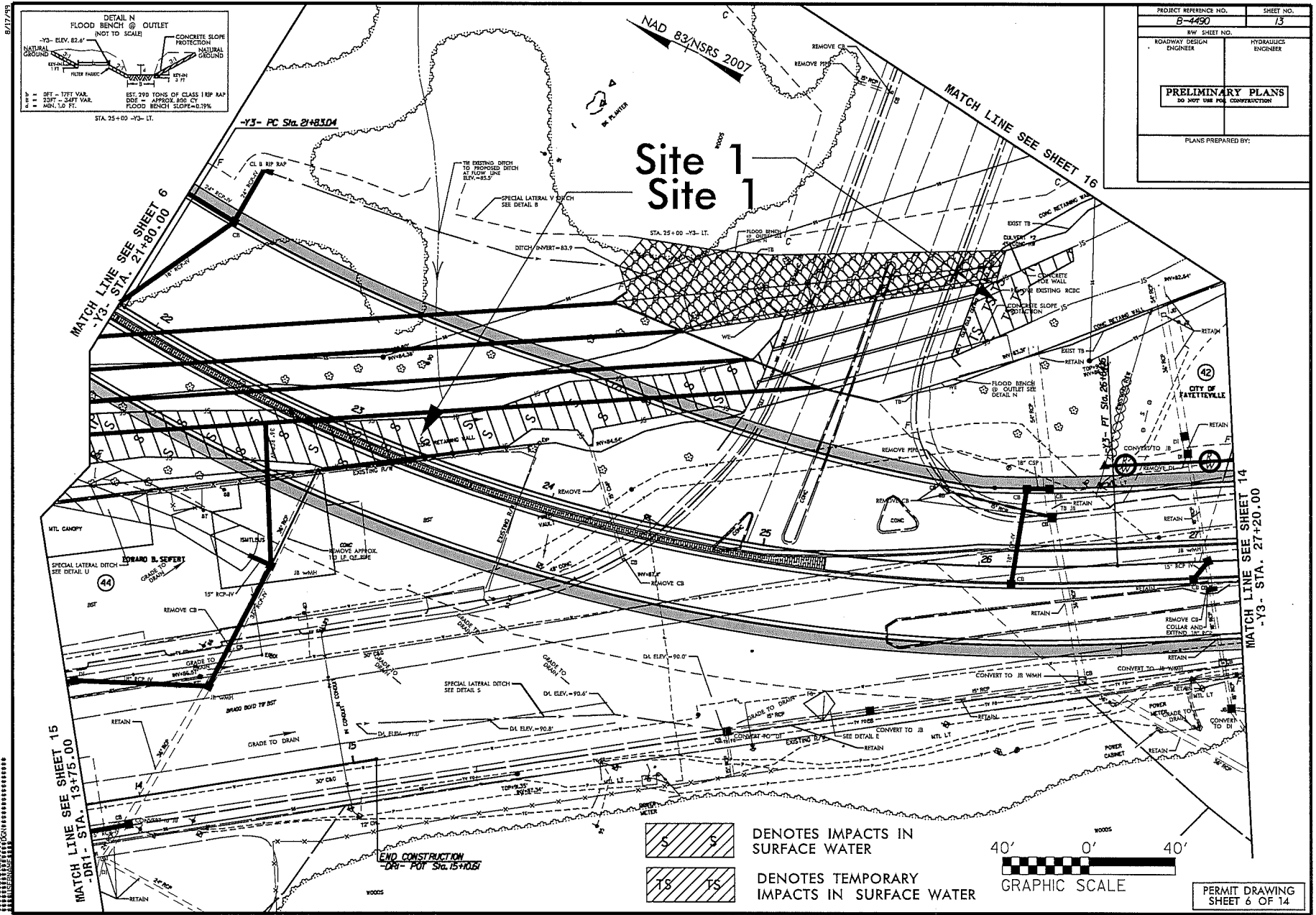

PROJECT REFERENCE NO. B-4490	SHEET NO. 13
ROW SHEET NO.	
ROADWAY DESIGN ENGINEER	HYDRAULICS ENGINEER
PRELIMINARY PLANS <small>DO NOT USE FOR CONSTRUCTION</small>	
PLANS PREPARED BY:	

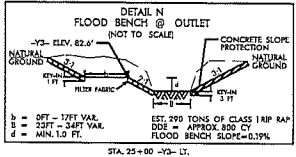
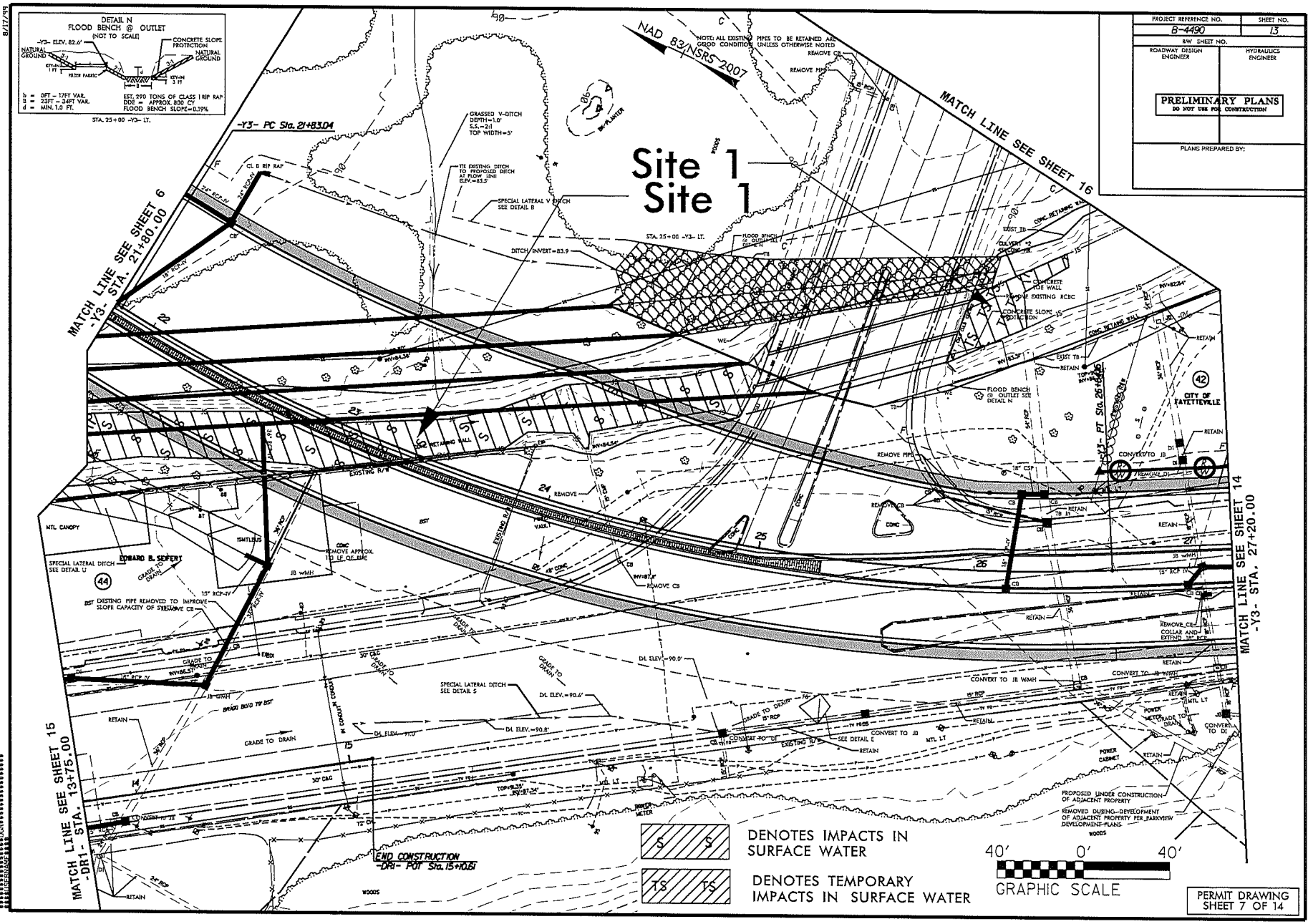

PERMIT DRAWING
SHEET 6 OF 14

11/19/2014
 sjsykes
 R:\Hydraulics\PERMITS_Environmental\Drawings\B44490_Hyd_prm_wet_7_con.dgn



PROJECT REFERENCE NO. B-4490	SHEET NO. 13
ROADWAY DESIGN ENGINEER	HYDRAULICS ENGINEER
PRELIMINARY PLANS DO NOT USE FOR CONSTRUCTION	
PLANS PREPARED BY:	

Site 1
 Site 1

 DENOTES IMPACTS IN SURFACE WATER
 DENOTES TEMPORARY IMPACTS IN SURFACE WATER

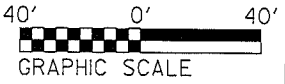

PERMIT DRAWING SHEET 7 OF 14

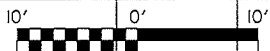

VERTICAL SCALE

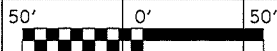

HORIZONTAL SCALE

Backfill Proposed Culvert with Native Material. Native Material consists of material that is excavated from the stream bed or floodplain at the project site during culvert construction. Only material that is excavated from the stream bed may be used to line the low flow culvert barrel. Rip rap may be used to supplement the Native Material in the high flow culvert barrel(s). If rip rap is used to line the high flow culvert barrel(s), Native Material should be placed on top to fill voids and provide a flat surface for animal passage. Native Material is subject to approval by the engineer and may be subject to permit conditions.

PROFILE

110

100

90

80

70

100 YR WSE=101.40'
50 YR WSE=100.3'

CL STA. -L- 19+26.42
G.P. EL=94.64'
3 @ 14'X9' RCBC
SKEW=42.2°

EXIST. 3@12'X9' RCBC
TO BE REMOVED

TB LT TB RT

PROP. ROADWAY

OHW 85.0'
(DATE 03-2012)

EXISTING BED

CL INV=81.8
S=0.19%

100

50

0

50

100

MATCHLINE A

FLOOD BENCH @ INLET
(NOT TO SCALE)

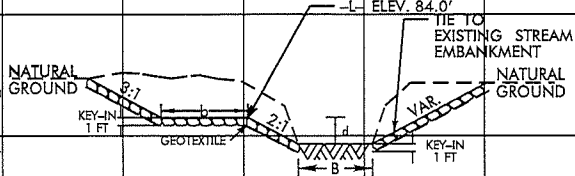

b = 5FT - 14FT VAR.
B = 28FT - 32FT VAR.
d = MIN. 1.00 FT.

EST. 100 TONS OF CLASS 1 RIP RAP
DDE = APPROX. 500 CY
FLOOD BENCH SLOPE=0.86%

CULVERT SILL INLET/OUTLET
(NOT TO SCALE)

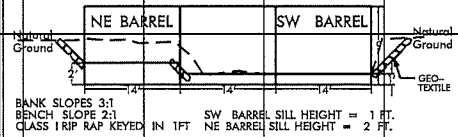

BANK SLOPES 3:1
BENCH SLOPE 2:1
CLASS 1 RIP RAP KEYED IN 1 FT
SW BARREL SILL HEIGHT = 1 FT.
NE BARREL SILL HEIGHT = 2 FT.

NCDOT

DIVISION OF HIGHWAYS
CUMBERLAND COUNTY

PROJECT: 33727.1.1 (B-4490)

BRIDGE NO. 116 OVER CSX RR,
NORFOLK SOUTHERN RR AND
HILLSBORO STREET ON NC 24/210

SHEET 8 OF 14

6/15/15

6/15/2015
cafreeman2
R:\Hydraulics\PERMITS Environmental\Drawings\B-4490_Hyd_csr_profile_8and9.dgn

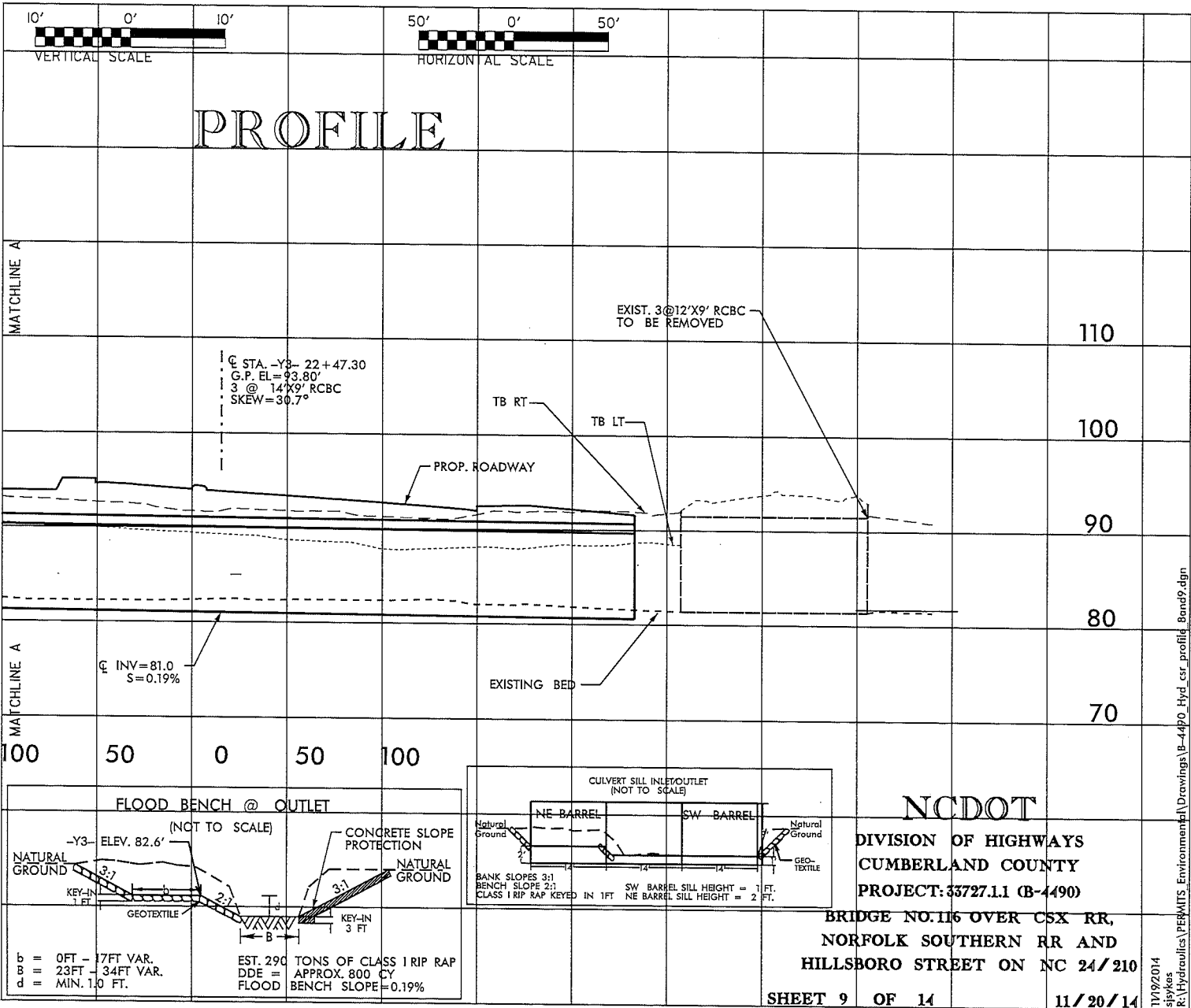

11/19/2014
 spsykes
 R:\Hydraulics\PERMITS\Environmental\Drawings\B4490_Hyd_prm_wet_10.dgn

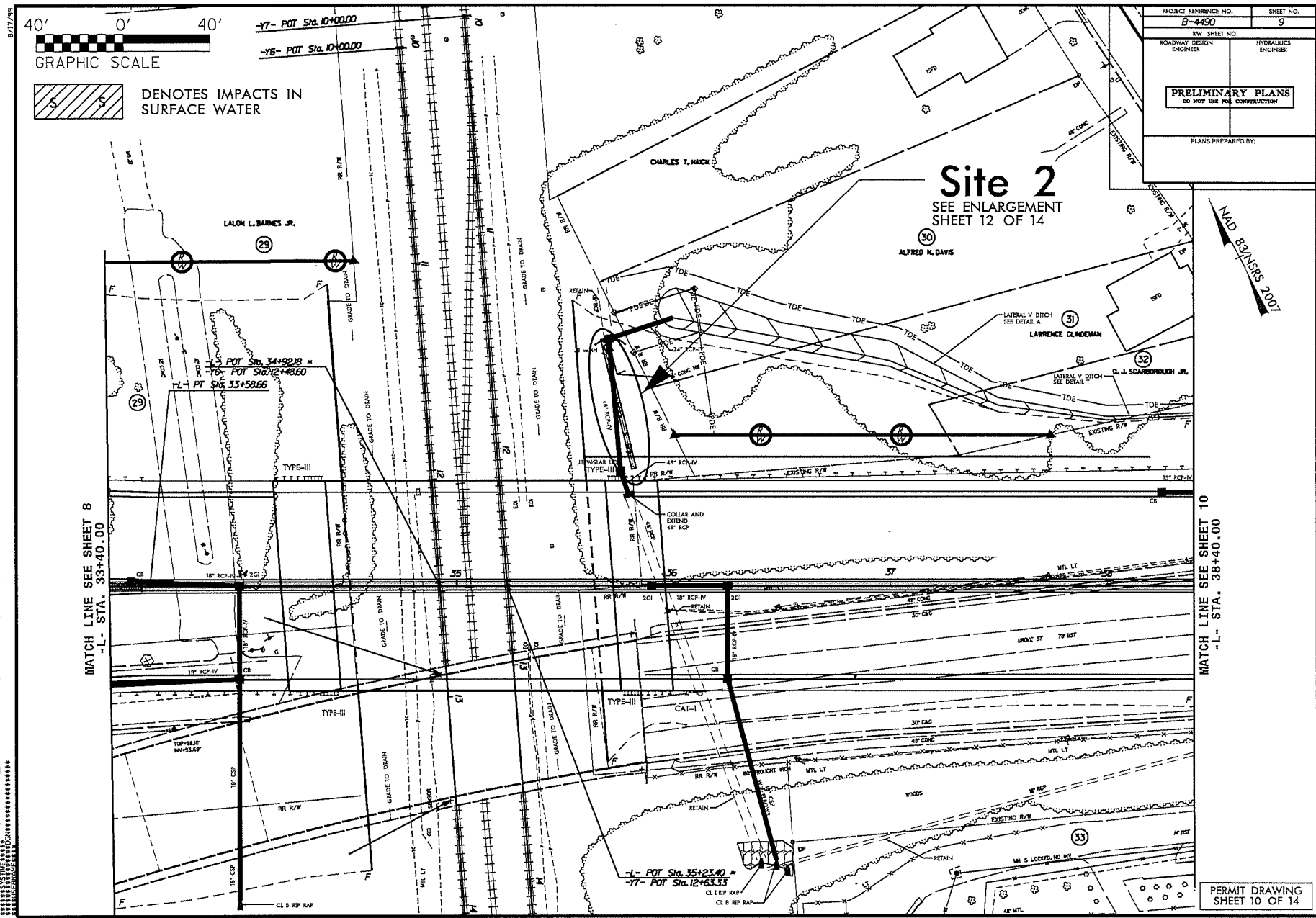

PROJECT REFERENCE NO. B-4490	SHEET NO. 9
RDW SHEET NO.	HYDRAULICS ENGINEER
ROADWAY DESIGN ENGINEER	
PRELIMINARY PLANS DO NOT USE FOR CONSTRUCTION	
PLANS PREPARED BY:	

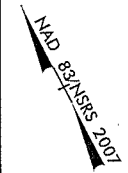

PERMIT DRAWING
 SHEET 10 OF 14

11/19/2014
 sisykes
 R:\Hydraulics\PERMITS_Environmental\Drawings\B4490_Hyd_prm_wef_11con.dgn

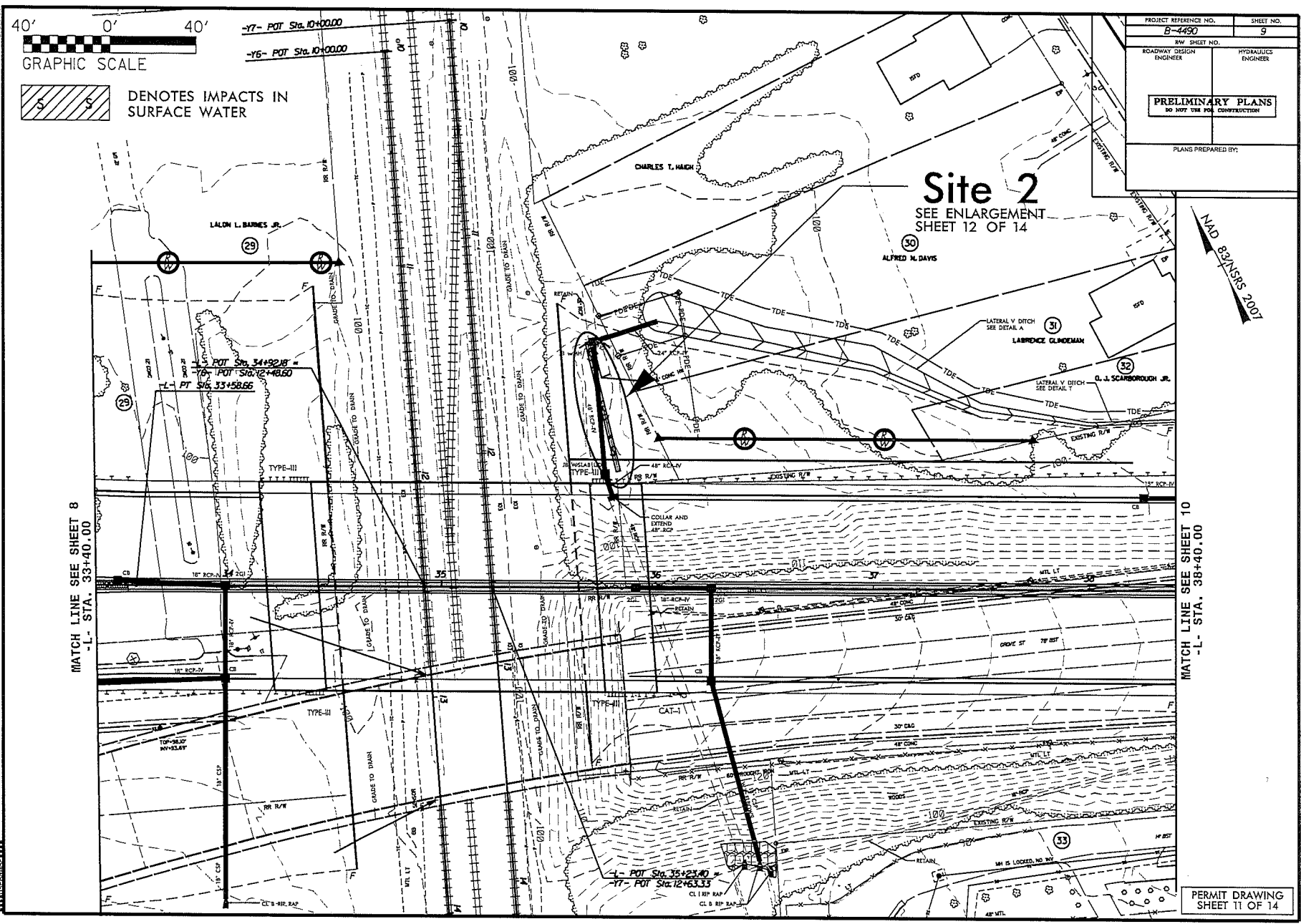

PERMIT DRAWING
 SHEET 11 OF 14

R:\Hydraulics\PERMITS Environmental\Drawings\B4490 Hyd prm wet 12 Enlargement.dgn
 slykes
 11/9/2014

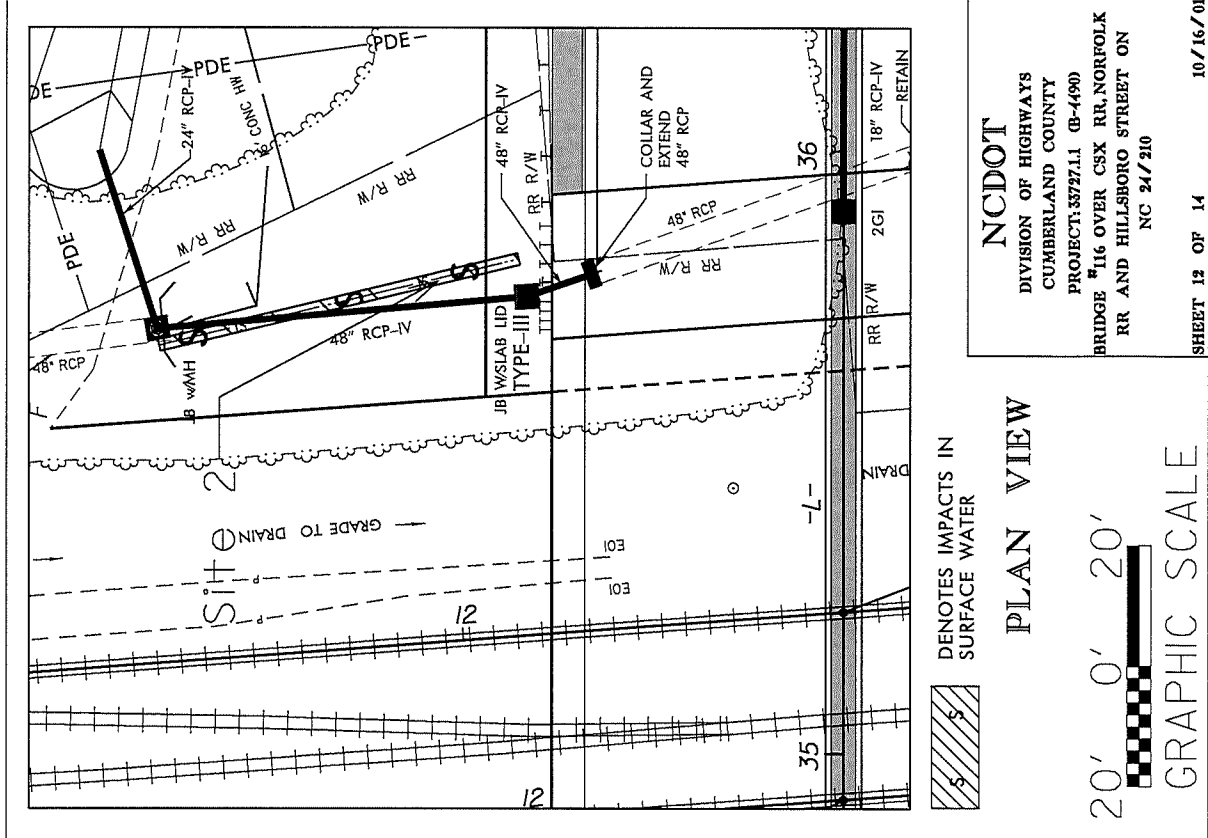

DENOTES IMPACTS IN
 SURFACE WATER



PLAN VIEW



GRAPHIC SCALE

NCDOT
 DIVISION OF HIGHWAYS
 CUMBERLAND COUNTY
 PROJECT 337211 (B-4490)
 BRIDGE #16 OVER CSX RR, NORFOLK
 RR AND HILLSBORO STREET ON
 NC 24/210

SHEET 12 OF 14 10/16/01

R:\Hydraulics\PERMITS Environmental\Drawings\B4490 Hyd prm wet 13 Enlargement con.c.
 slykes
 11/9/2014

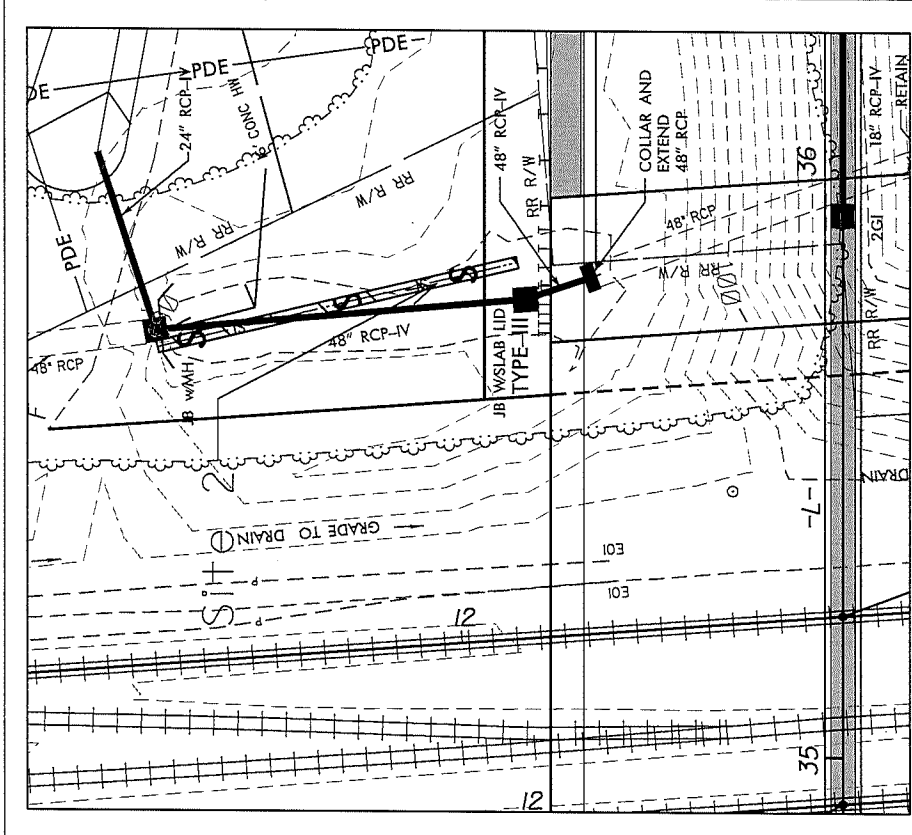

DENOTES IMPACTS IN SURFACE WATER

PLAN VIEW

20' 0' 20'



GRAPHIC SCALE

NCDOT

DIVISION OF HIGHWAYS
 CUMBERLAND COUNTY

PROJECT 3372.11 (B-4490)

BRIDGE #16 OVER CSX RR, NORFOLK
 RR AND HILLSBORO STREET ON
 NC 247210

SHEET 13 OF 14

10/16/01

8/10/2013

TIP PROJECT: B-4490

CONTRACT: C203659

See Sheet 1-A For Index of Sheets
See Sheet 1-B For Symbology Sheet

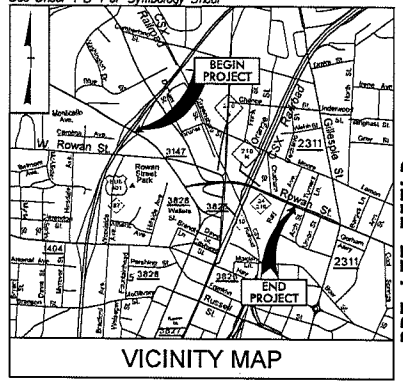

PRE-LET FIELD INSPECTION PLANS

STATE OF NORTH CAROLINA DIVISION OF HIGHWAYS

CUMBERLAND COUNTY

LOCATION: BRIDGE NO. 116 OVER CSX RR, NORFOLK SOUTHERN RR,
AND HILLSBORO STREET ON NC/24-210

TYPE OF WORK: GRADING, PAVING, DRAINAGE AND STRUCTURES

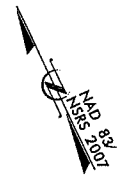
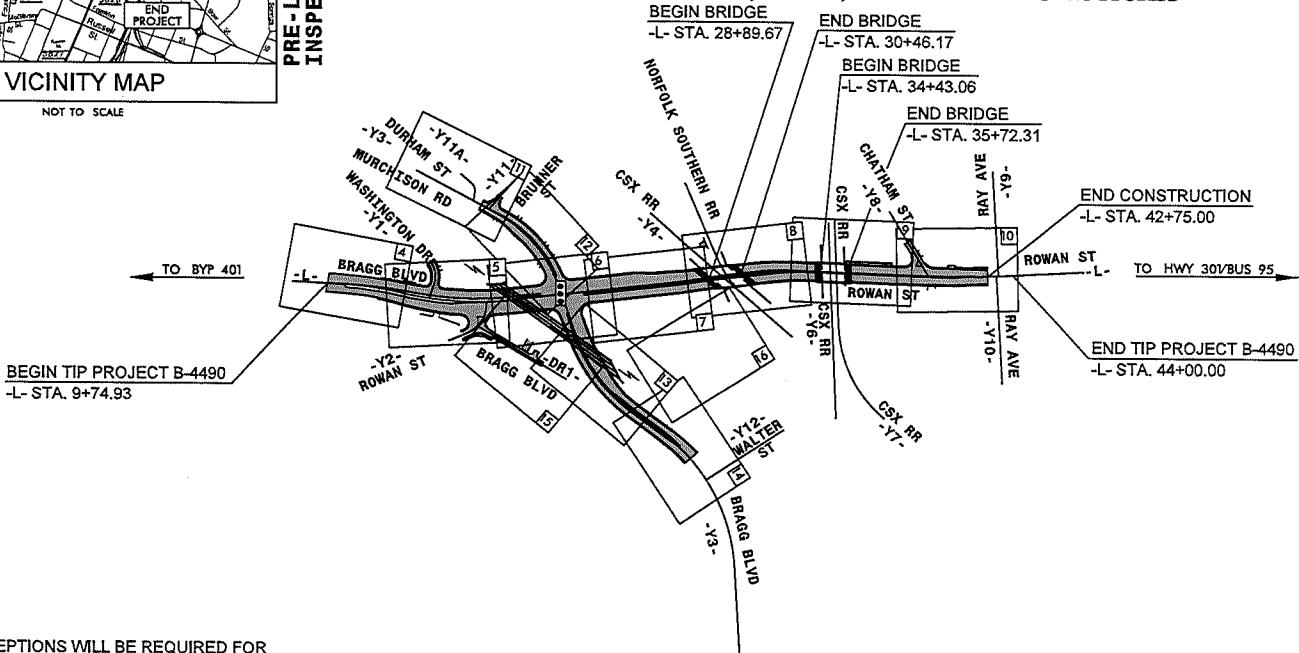

DESIGN EXCEPTIONS WILL BE REQUIRED FOR EXCEEDING MAXIMUM GRADE ON -L- AND THE SUPERELEVATION ALONG -L- THROUGH THE INTERSECTION WITH -Y3-

PRELIMINARY PLANS
DO NOT USE FOR CONSTRUCTION

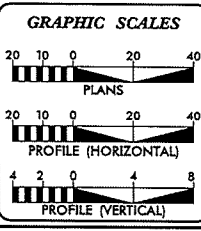

DESIGN DATA

ADT 2015 =	34,813
ADT 2035 =	47,596
DHV =	10 %
D =	55 %
T =	3 %
V =	40 MPH
(* TTST 1% + DUAL 2%)	
FUNC CLASS =	URBAN
PRINCIPAL ARTERIAL	
REGIONAL TIER	

PROJECT LENGTH

LENGTH ROADWAY TIP PROJECT B-4490 =	0.595 MILES
LENGTH STRUCTURE TIP PROJECT B-4490 =	0.054 MILES
TOTAL LENGTH TIP PROJECT B-4490 =	0.649 MILES

PLANS PREPARED BY: PARSONS BRINCKERHOFF 314 DAVENPORT STREET Raleigh, NC 27601 TEL: 919.977.1000	PLANS PREPARED FOR: DIVISION OF HIGHWAYS 1000 Birch Ridge Dr. Raleigh, NC, 27610
3RD STANDARD SPECIFICATIONS	
RIGHT OF WAY DATE: DECEMBER 31, 2013	TIM HAYES, PE PROJECT ENGINEER
LETTING DATE: DECEMBER 15, 2015	ERIC MISAK PROJECT DESIGN ENGINEER
NCDOT CONTACT:	BRENDA MOORE, PE, CPM

HYDRAULICS ENGINEER	_____ P.E.
ROADWAY DESIGN ENGINEER	_____ P.E.



2:53:03 PM B-4490-D-4490-Roadway-Prj\B4490-rdy-tsh.dgn 8/10/2015

8/2/82/15

Note: Not to Scale

*S.U.E. = Subsurface Utility Engineering

STATE OF NORTH CAROLINA
DIVISION OF HIGHWAYS

PROJECT REFERENCE NO.
B-4490

SHEET NO.
7-B

CONVENTIONAL PLAN SHEET SYMBOLS

BOUNDARIES AND PROPERTY:

State Line	_____
County Line	_____
Township Line	_____
City Line	_____
Reservation Line	_____
Property Line	_____
Existing Iron Pin	⊙
Property Corner	⊙
Property Monument	⊙
Parcel/Sequence Number	Ⓢ
Existing Fence Line	—x—x—x—
Proposed Woven Wire Fence	—o—o—o—
Proposed Chain Link Fence	—o—o—o—
Proposed Barbed Wire Fence	—o—o—o—
Existing Wetland Boundary	—w—w—w—
Proposed Wetland Boundary	—w—w—w—
Existing Endangered Animal Boundary	—a—
Existing Endangered Plant Boundary	—p—
Existing Historic Property Boundary	—h—
Known Soil Contamination: Area or Site	⊗
Potential Soil Contamination: Area or Site	⊗

BUILDINGS AND OTHER CULTURE:

Gas Pump Vent or UG Tank Cap	⊙
Sign	⊙
Well	⊙
Small Mine	⊙
Foundation	⊙
Area Outline	⊙
Cemetery	⊙
Building	⊙
School	⊙
Church	⊙
Dam	⊙

HYDROLOGY:

Stream or Body of Water	_____
Hydro, Pool or Reservoir	_____
Jurisdictional Stream	—js—
Buffer Zone 1	—bz 1—
Buffer Zone 2	—bz 2—
Flow Arrow	→
Disappearing Stream	→
Spring	⊙
Wetland	⊙
Proposed Lateral, Tail, Head Ditch	—d—
False Sump	⊙

RAILROADS:

Standard Gauge	_____
RR Signal Milepost	⊙
Switch	⊙
RR Abandoned	_____
RR Dismantled	_____

RIGHT OF WAY:

Baseline Control Point	◆
Existing Right of Way Marker	△
Proposed Right of Way Line	—
Proposed Right of Way Line with Iron Pin and Cap Marker	⊙
Proposed Right of Way Line with Concrete or Granite RW Marker	⊙
Proposed Control of Access Line with Concrete CA Marker	⊙
Existing Control of Access	⊙
Proposed Control of Access	⊙
Existing Easement Line	—E—
Proposed Temporary Construction Easement	—E—
Proposed Temporary Drainage Easement	—TDE—
Proposed Permanent Drainage Easement	—PDE—
Proposed Permanent Drainage / Utility Easement	—DUE—
Proposed Permanent Utility Easement	—PUE—
Proposed Temporary Utility Easement	—TUE—
Proposed Aerial Utility Easement	—AUE—
Proposed Permanent Easement with Iron Pin and Cap Marker	⊙

ROADS AND RELATED FEATURES:

Existing Edge of Pavement	_____
Existing Curb	_____
Proposed Slope Stakes Cut	—C—
Proposed Slope Stakes Fill	—F—
Proposed Curb Ramp	⊙
Existing Metal Guardrail	—g—
Proposed Guardrail	—g—
Existing Cable Guiderail	—c—
Proposed Cable Guiderail	—c—
Equality Symbol	⊙
Pavement Removal	⊙

VEGETATION:

Single Tree	⊙
Single Shrub	⊙
Hedge	—h—
Woods Line	—w—

Orchard	⊙
Vineyard	⊙

EXISTING STRUCTURES:

MAJOR:	
Bridge, Tunnel or Box Culvert	—C—
Bridge Wing Wall, Head Wall and End Wall	—C—
MINOR:	
Head and End Wall	—C—
Pipe Culvert	—p—
Footbridge	—f—
Drainage Box: Catch Basin, DI or JB	⊙
Paved Ditch Gutter	—g—
Storm Sewer Manhole	⊙
Storm Sewer	—s—

UTILITIES:

POWER:	
Existing Power Pole	⊙
Proposed Power Pole	⊙
Existing Joint Use Pole	⊙
Proposed Joint Use Pole	⊙
Power Manhole	⊙
Power Line Tower	⊙
Power Transformer	⊙
UG Power Cable Hand Hole	⊙
H-Frame Pole	⊙
Recorded UG Power Line	—r—
Designated UG Power Line (S.U.E.*)	—d—

TELEPHONE:

Existing Telephone Pole	⊙
Proposed Telephone Pole	⊙
Telephone Manhole	⊙
Telephone Booth	⊙
Telephone Pedestal	⊙
Telephone Call Tower	⊙
UG Telephone Cable Hand Hole	⊙
Recorded UG Telephone Cable	—r—
Designated UG Telephone Cable (S.U.E.*)	—d—
Recorded UG Telephone Conduit	—r—
Designated UG Telephone Conduit (S.U.E.*)	—d—
Recorded UG Fiber Optics Cable	—r—
Designated UG Fiber Optics Cable (S.U.E.*)	—d—

WATER:

Water Manhole	⊙
Water Meter	⊙
Water Valve	⊙
Water Hydrant	⊙
Recorded UG Water Line	—r—
Designated UG Water Line (S.U.E.*)	—d—
Above Ground Water Line	—a/g Water

TV:

TV Satellite Dish	⊙
TV Pedestal	⊙
TV Tower	⊙
UG TV Cable Hand Hole	⊙
Recorded UG TV Cable	—r—
Designated UG TV Cable (S.U.E.*)	—d—
Recorded UG Fiber Optic Cable	—r—
Designated UG Fiber Optic Cable (S.U.E.*)	—d—

GAS:

Gas Valve	⊙
Gas Meter	⊙
Recorded UG Gas Line	—r—
Designated UG Gas Line (S.U.E.*)	—d—
Above Ground Gas Line	—a/g Gas

SANITARY SEWER:

Sanitary Sewer Manhole	⊙
Sanitary Sewer Cleanout	⊙
UG Sanitary Sewer Line	—s—
Above Ground Sanitary Sewer	—a/g Sanitary Sewer
Recorded SS Forced Main Line	—r—
Designated SS Forced Main Line (S.U.E.*)	—d—

MISCELLANEOUS:

Utility Pole	⊙
Utility Pole with Base	⊙
Utility Located Object	⊙
Utility Traffic Signal Box	⊙
Utility Unknown UG Line	—u—
UG Tank; Water, Gas, Oil	⊙
Underground Storage Tank, Approx. Loc.	⊙
AG Tank; Water, Gas, Oil	⊙
Geoenvironmental Boring	⊙
UG Test Hole (S.U.E.*)	⊙
Abandoned According to Utility Records	AATUR
End of Information	E.O.I.

11/21/2014 PARCEL 1- ADDED A RETAINING WALL AND REVISED THE TCE TO AVOID IMPACTING THE BLOCK BUSINESS BUILDING. REVISED THE DRAINAGE DESIGN TO ELIMINATE THE PDE.

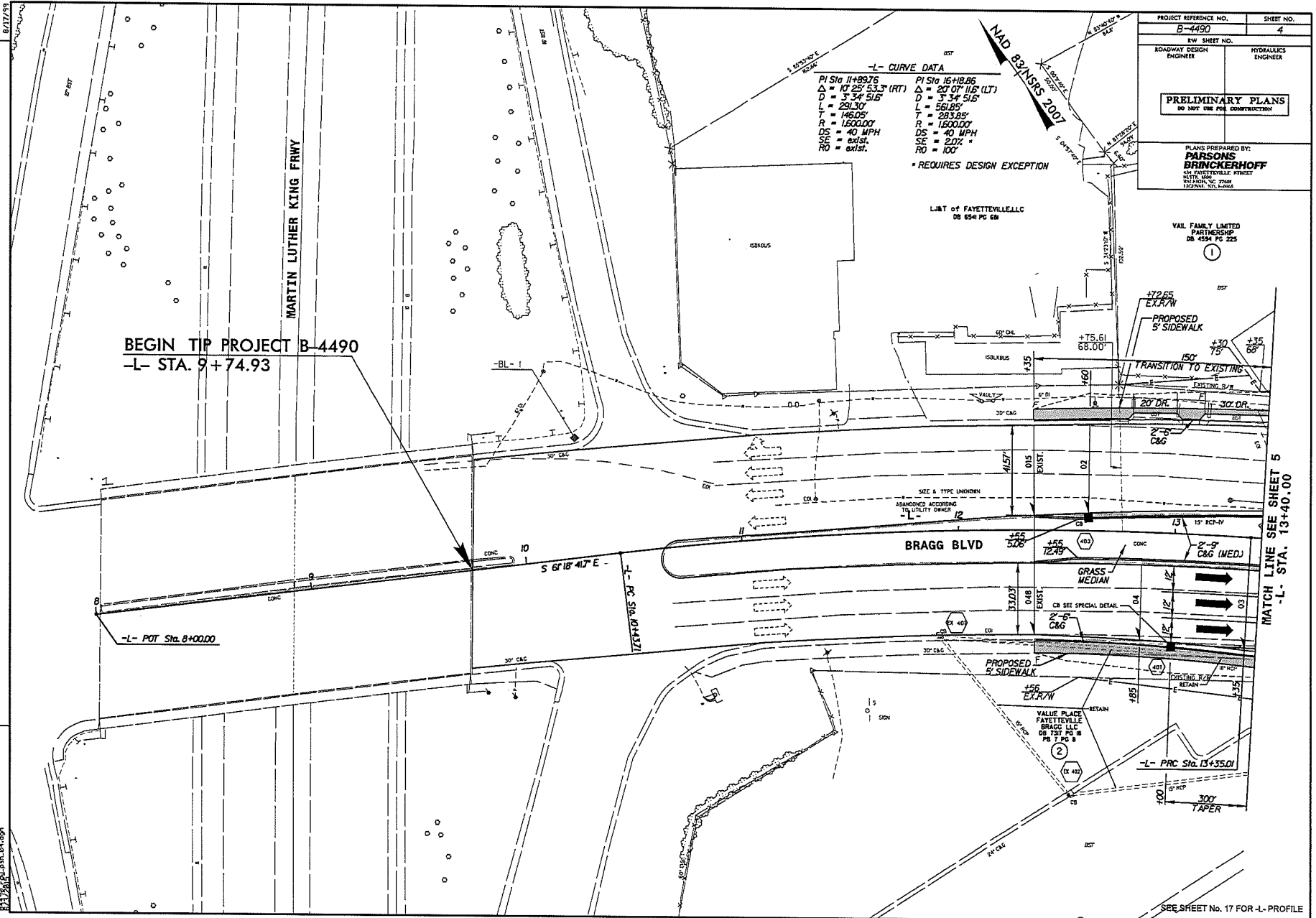

-L- CURVE DATA

PI Sta 11+89.76	PI Sta 16+18.86
$\Delta = 10' 25" 53.3'$ (RT)	$\Delta = 20' 07" 11.6'$ (LT)
D = 3' 34" 51.6"	D = 3' 34" 51.6"
L = 291.30'	L = 561.85'
T = 146.05'	T = 283.95'
R = 1600.00'	R = 1600.00'
DS = 40 MPH	DS = 40 MPH
SE = exist.	SE = 2.0%
RO = exist.	RO = 100'

* REQUIRES DESIGN EXCEPTION

PROJECT REFERENCE NO. B-4490	SHEET NO. 4
R/W SHEET NO.	HYDRAULICS ENGINEER
ROADWAY DESIGN ENGINEER	

PRELIMINARY PLANS
DO NOT USE FOR CONSTRUCTION

PLANS PREPARED BY:
PARSONS BRINCKERHOFF
435 FAYETTEVILLE STREET
SUITE 600
FAYETTEVILLE, NC 27803
1025001100.DWG

BEGIN TIP PROJECT B-4490
-L- STA. 9+74.93

-L- POT Sta. 8+00.00

MATCH LINE SEE SHEET 5
-L- STA. 13+40.00

SEE SHEET No. 17 FOR -L- PROFILE

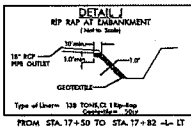
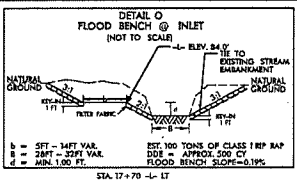

EST. 100 TONS OF CLASS 1 R/R RAP
 DD3 = APPROX. 500 CY
 FLOOD BENCH: 5.0%+0.1%

-L- CURVE DATA
 PI Sta 16+88.66
 Δ = 27° 07' 16.2\"/>

-Y1- CURVE DATA
 PI Sta 12+09.77
 Δ = 62° 27' 15.8\"/>

-Y2- CURVE DATA
 PI Sta 11+24.19
 Δ = 62° 03' 54.7\"/>

-L- POC Sta. 14+87.16 =
-Y1- POT Sta. 13+44.59

-Y2- FC Sta. 11+42.00
-Y1- POC Sta. 11+50.00

-Y2- POT Sta. 13+00.00

NC 24 & W ROWAN ST.
 -L-

22770	404	2570	24935
32944	565	2744	35022

 -Y2-

2974	2015 ADT
3409	2035 ADT

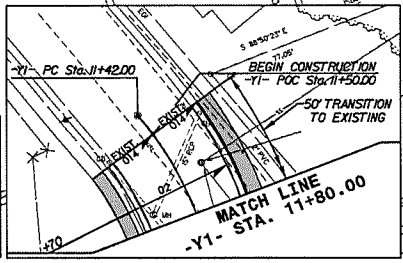

PLANS PREPARED BY:
PARSONS BRINCKERHOFF
 414 FAYETTEVILLE STREET
 RDU, NC 27601, PH: 919.487.2000
 FAX: 919.487.2001

PROJECT REFERENCE NO.	SHEET NO.
B-4430	5
RDWY DESIGN ENGINEER	HYDRAULICS ENGINEER
PRELIMINARY PLANS DO NOT USE FOR CONSTRUCTION	

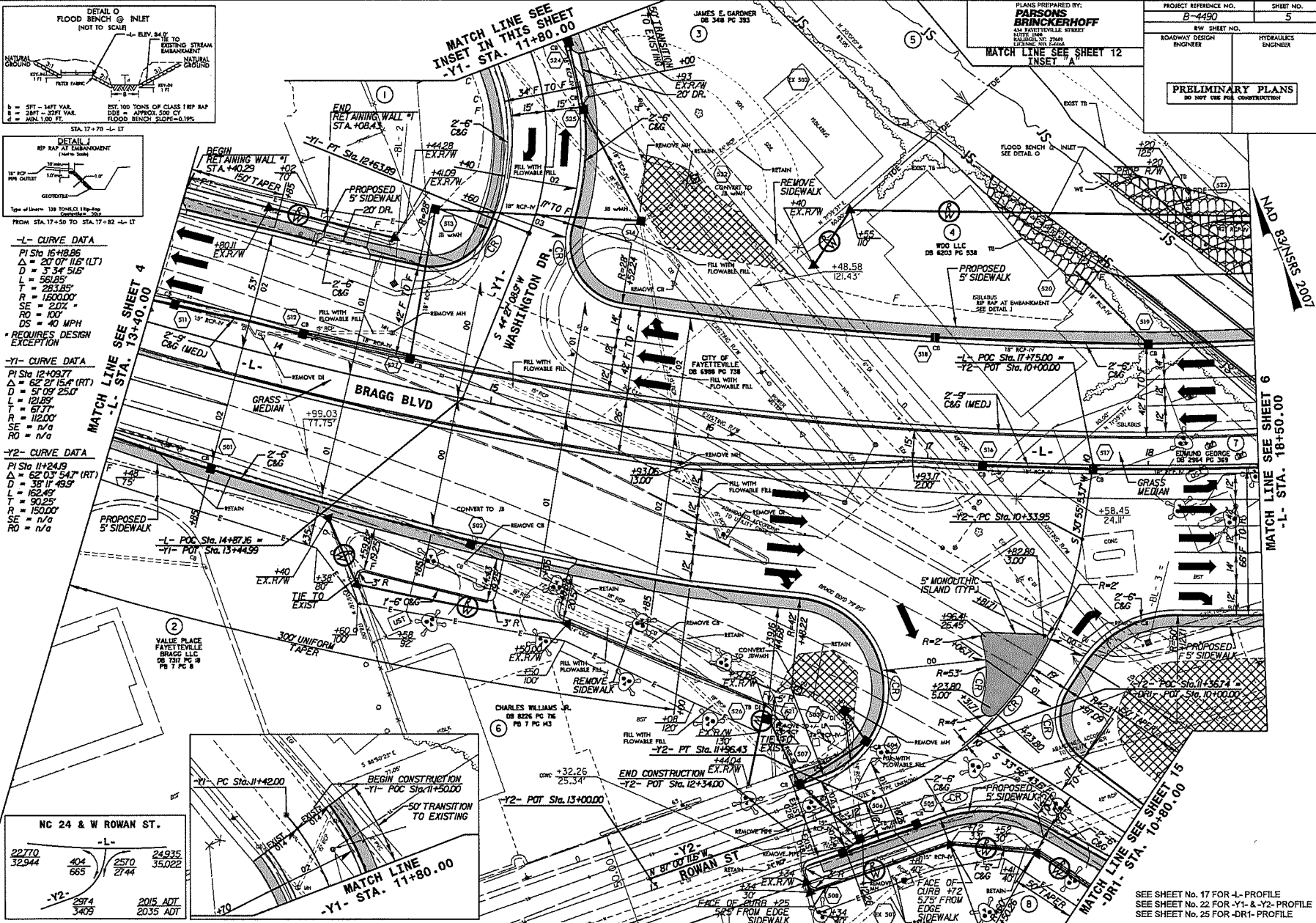

02/23/2015 PARCEL 05- COMBINED PARCELS 5 AND 39 INTO PARCEL 5
 02/11/2015 PARCEL 39- ADDED MARKERS ON THE PERMANENT DRAINAGE EASEMENT
 COMBINED PARCELS 5 AND 39 INTO PARCEL 39.
 11/21/2014 PARCEL 1- ADDED A RETAINING WALL AND REVISED THE TCE TO AVOID IMPACTING THE BLOCK BUSINESS BUILDING.
 REVISED THE DRAINAGE DESIGN TO ELIMINATE THE PDE.

SEE SHEET No. 17 FOR -L- PROFILE
 SEE SHEET No. 22 FOR -Y1- & -Y2- PROFILE
 SEE SHEET No. 25 FOR -DR1- PROFILE

REVISIONS
 02-23-2015 PARCEL 5 - COMBINED PARCELS 5 AND 39 INTO PARCEL 5
 12-30-2014 PARCELS 9 AND 41 - COMBINED PARCELS 9 AND 41 DUE TO TYPOGRAPHICAL ERROR ON PLANS AT THE MATCH-LINE OF SHEETS 6 AND 12.
 08/27/13

-L- CURVE DATA	-Y3- CURVE DATA
PI Sta 16+88.66	PI Sta 17+09.63
$\Delta = 20^{\circ} 07' 11.8"$ (LT)	$\Delta = 43^{\circ} 13' 24.1"$ (RT)
D = 334.515	D = 849.533
L = 561.85	L = 490.35
T = 283.85	T = 257.5
R = 1800.00	R = 650.00
OS = 40 MPH	OS = 40 MPH
SE = 2.0 %	SE = 4.0 %
RO = 100'	RO = 124'

• REQUIRES DESIGN EXCEPTION

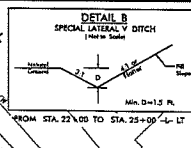
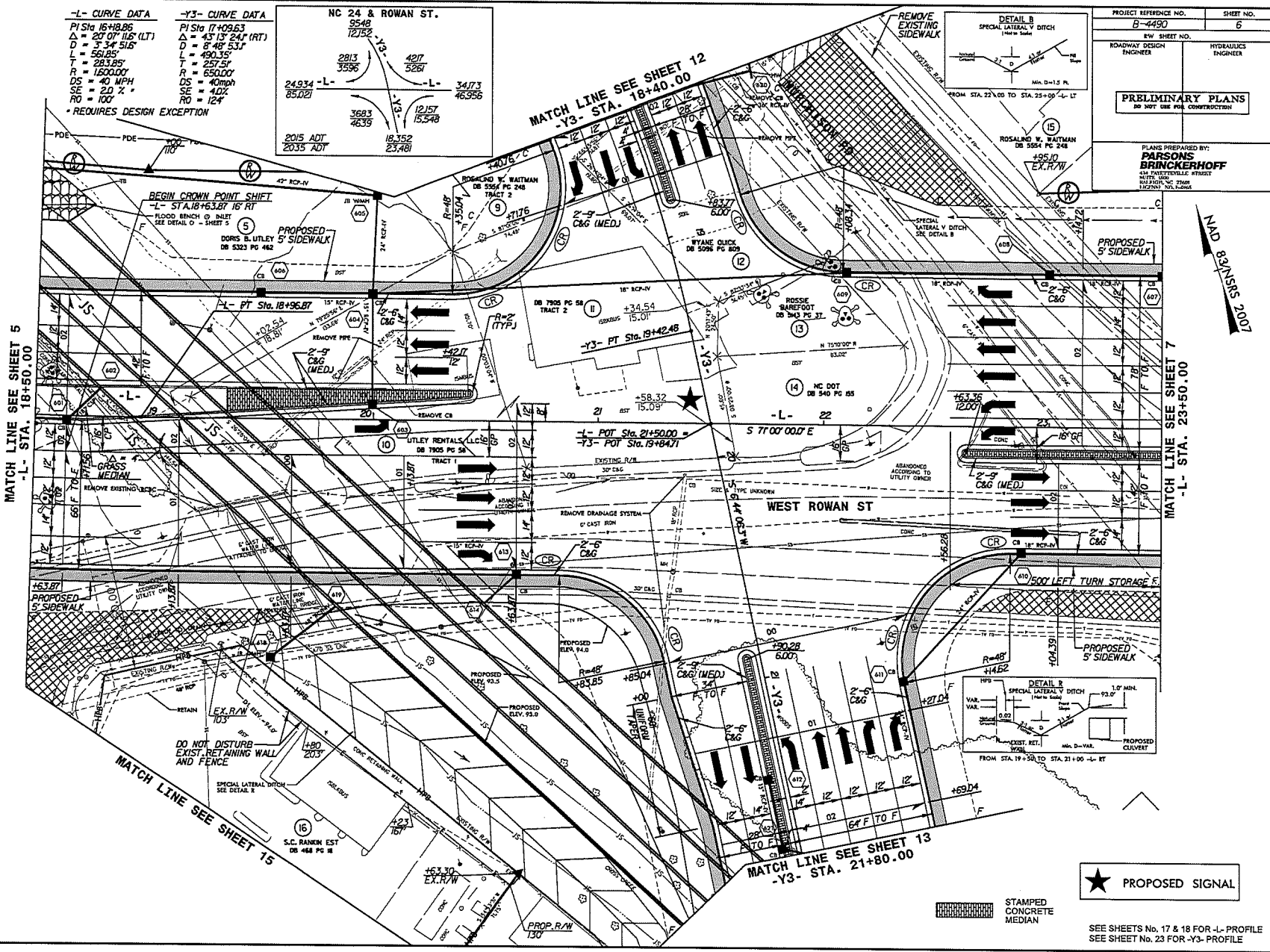
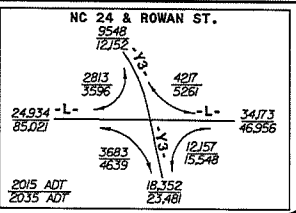

PROJECT REFERENCE NO. B-4490	SHEET NO. 6
R/W SHEET NO.	HYDRAULICS ENGINEER
ROADWAY DESIGN ENGINEER	
PRELIMINARY PLANS DO NOT USE FOR CONSTRUCTION!	
PLANS PREPARED BY: PARSONS BRINCKERHOFF 434 FAYETTEVILLE STREET Raleigh, NC 27601 TEL: 919.286.7000	

NAD BASIS 2011

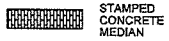
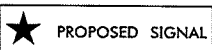

SEE SHEETS No. 17 & 18 FOR -L- PROFILE
SEE SHEET No. 23 FOR -Y3- PROFILE

B-17/19

REVISIONS

- 02-04-2015 - PARCEL 21 - REVISED EXISTING R/W LINE
- 02-11-2015 - PARCELS 19 AND 20 INTO PARCEL 19
- 02-11-2015 - PARCELS 21 AND 22 - COMBINED PARCELS 21 AND 22 INTO PARCEL 21
- 03-27-2014 - REVISED OFFSET LABEL FROM 150 TO 140 AT ROW MONUMENT -L- STA. 27+65.53.
- 03-27-2014 - REVISED ROW MONUMENT LABEL FROM -L- STA. 27+5000 TO 27+5007.

1:58:58 PM pth.bj.dgn

MATCH LINE SEE SHEET 6
-L- STA. 23+50.00

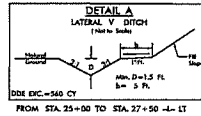
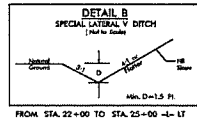
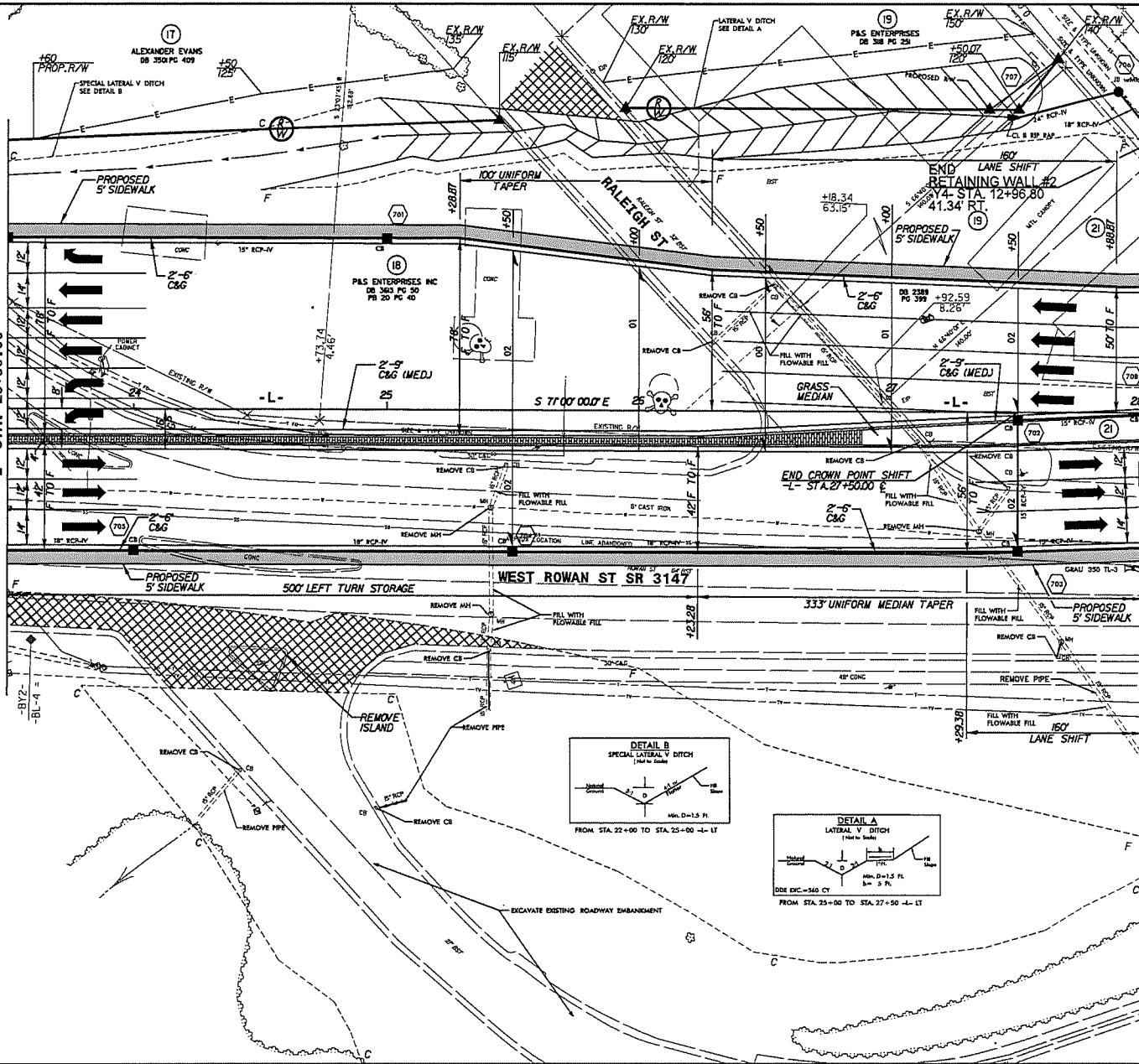

PROJECT REFERENCE NO.	SHEET NO.
B-4490	7
ROADWAY DESIGN ENGINEER	HYDRAULICS ENGINEER
PRELIMINARY PLANS DO NOT USE FOR CONSTRUCTION	

PLANS PREPARED BY:
PARSONS BRINCKERHOFF
34 PARRETTVILLE STREET
Raleigh, NC 27601
TEL: 919.977.1000

MATCH LINE SEE SHEET 8
-L- STA. 28+00.00

NAD 83/ANSI 2011



SEE SHEET No. 18 & 19 FOR -L- PROFILE

8/17/18

REVISIONS
05-04-2015 - PARCEL 21 - REVISED EXISTING RAW LINE
02-11-2015 - PARCEL 23 - ADDED TCE SHIFTED R/W AND ADDED NOTE TO AVOID SIGN
02-11-2015 - PARCELS 21 AND 22 - COMBINED PARCELS 21 AND 22 INTO PARCEL 21

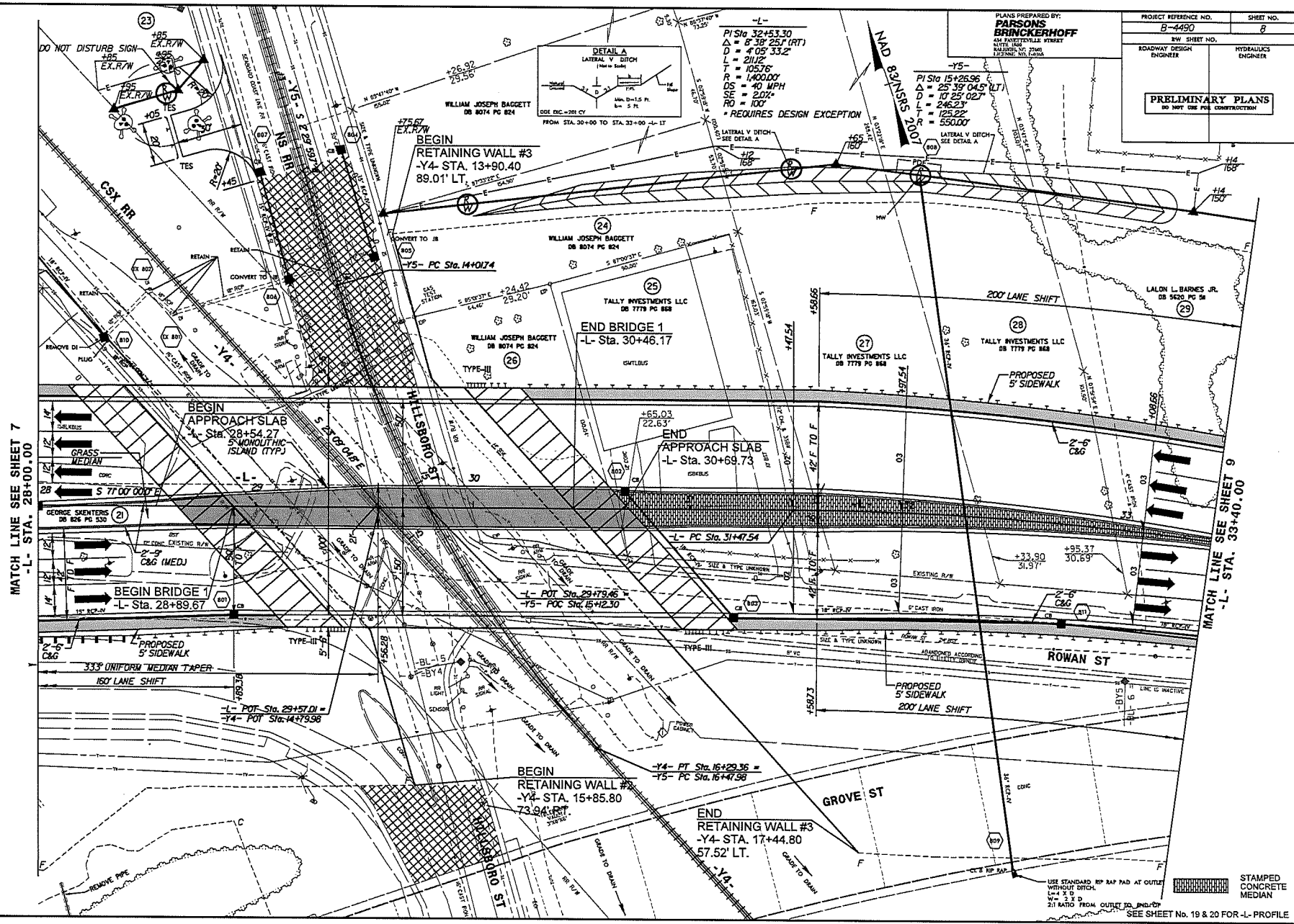

PLANS PREPARED BY:
PARSONS BRINCKERHOFF
400 PARKVIEW STREET
BOSTON, MA 02114
TEL: 617.261.1000
WWW.PARSONSBRINCKERHOFF.COM

PROJECT REFERENCE NO.	B-4490
SHEET NO.	8
ROW SHEET NO.	
ROADWAY DESIGN ENGINEER	HYDRAULICS ENGINEER

PRELIMINARY PLANS
DO NOT USE FOR CONSTRUCTION

MATCH LINE SEE SHEET 7
-L- STA. 28+00.00

MATCH LINE SEE SHEET 9
-L- STA. 33+40.00

STAMPED CONCRETE MEDIAN

SEE SHEET No. 19 & 20 FOR -L- PROFILE

8/17/07

TREES TO BE RETAINED UNDER PHASE II OF THE NCP			
TREE NO.	IDENTIFIC.	EASTING	DIAMETER (IN)
20	474502.8456	2034522.015	30
21	474518.7045	2034526.593	30
22	474478.1409	2034540.617	34
23	474445.8508	2034327.479	30
24	474433.2099	2034534.014	18
25	474499.2433	2034321.233	15
26	474478.8944	2034214.341	34
27	474487.5327	2034502.614	26
28	474487.1758	2033992.231	24
29	474491.2470	2033985.945	24

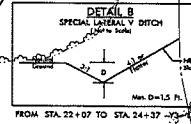

PI Stg 24+31.13
 $\Delta = 34.07' \ 25.8' \ (LT)$
 $D = 7' \ 05.43'$
 $L = 481.2'$
 $T = 248.08'$
 $R = 800.00'$
 $DS = 33 \text{ MPH}$
 $SE = 3.5^\circ$
 $RO = 14'$

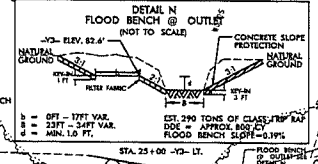

PROJECT REFERENCE NO. B-4490	SHEET NO. 13
RAW SHEET NO.	
ROADWAY DESIGN ENGINEER	HYDRAULICS ENGINEER
PRELIMINARY PLANS DO NOT USE FOR CONSTRUCTION	
PLANS PREPARED BY: PARSONS BRINCKERHOFF 100 EASTWINDLE STREET SUITE 1500 WASHINGTON, DC 20004 PHONE: 202.261.1000	

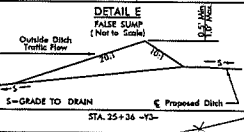
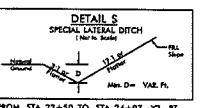
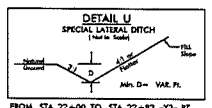
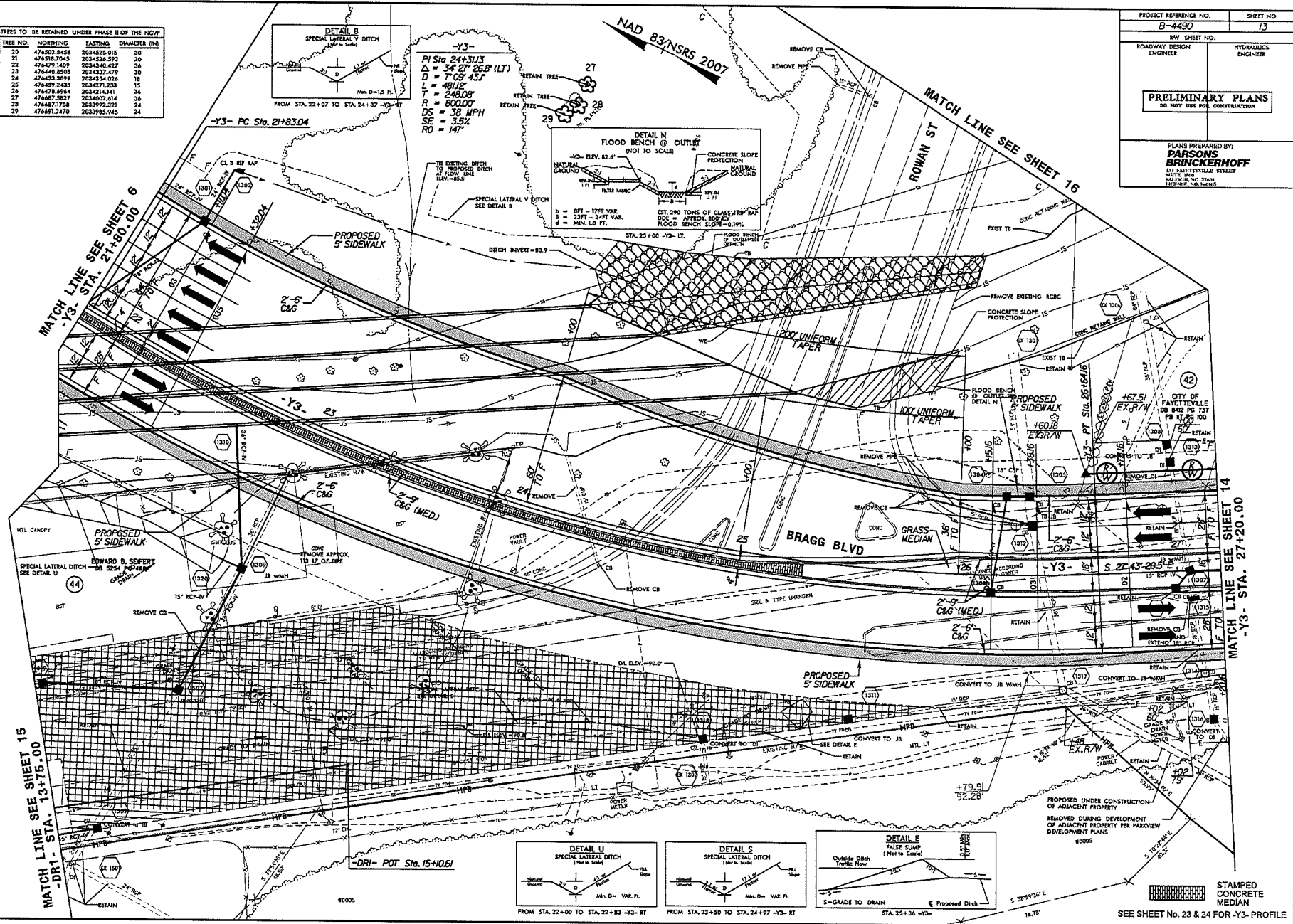

STAMPED CONCRETE MEDIAN
 SEE SHEET No. 23 & 24 FOR -Y3- PROFILE

8/17/07 M
 13.dgn

8/17/14

8:08 PM path.t.dgdn

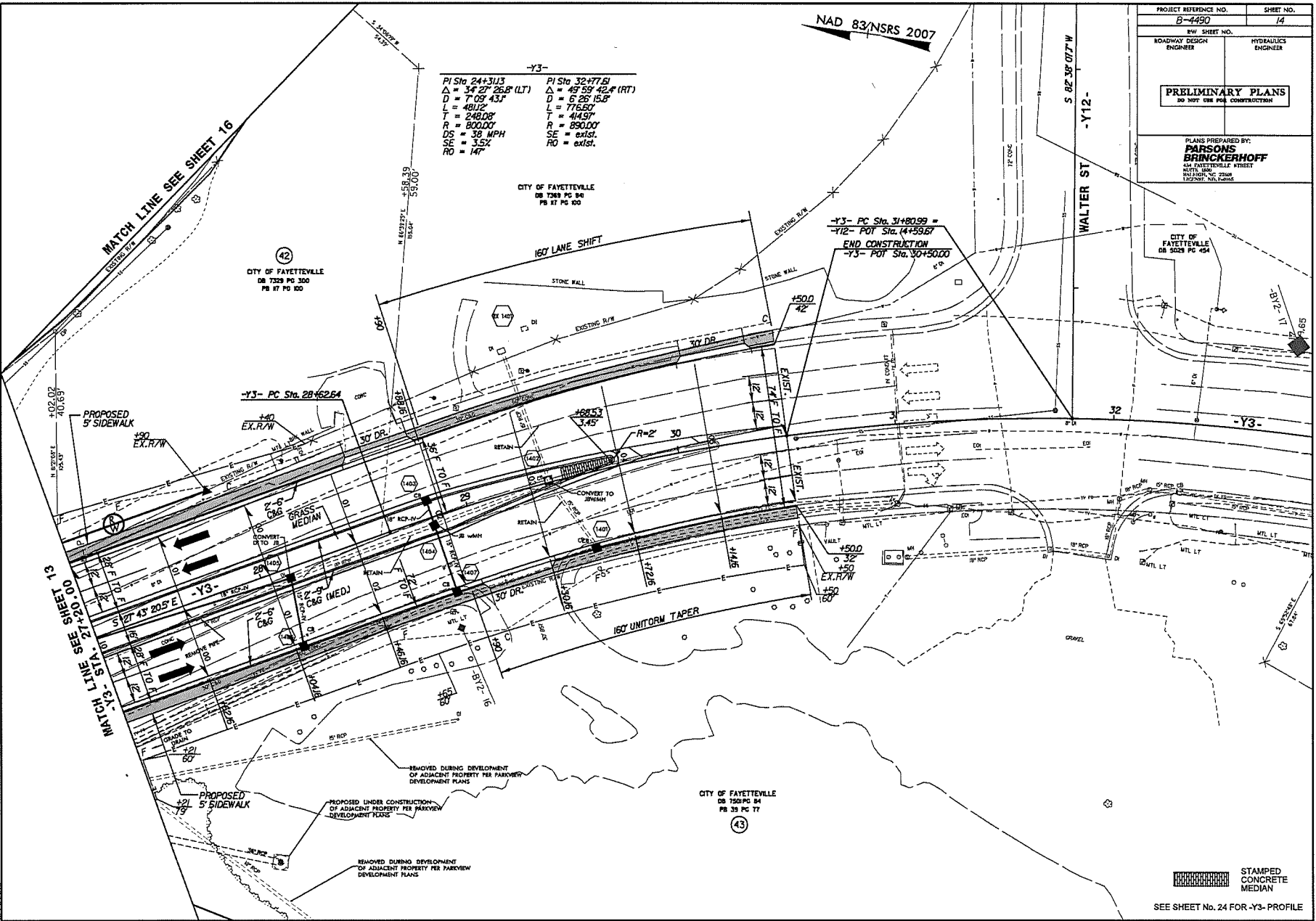

-Y3-

PI Sta 24+311.3	PI Sta 32+77.61
Δ = 14° 27' 28.8" (LT)	Δ = 49° 59' 42.4" (RT)
D = 709.43'	D = 628.15'
L = 481.2'	L = 776.60'
T = 248.08'	T = 414.97'
R = 800.00'	R = 890.00'
DS = 38 MPH	SE = exist.
SE = 3.5%	RO = exist.
RO = 14"	

PROJECT REFERENCE NO. B-4490	SHEET NO. 14
ROADWAY DESIGN ENGINEER	HYDRAULICS ENGINEER
PRELIMINARY PLANS DO NOT USE FOR CONSTRUCTION	
PLANS PREPARED BY: PARSONS BRINCKERHOFF 434 FAYETTEVILLE STREET FAYETTEVILLE, NC 27404 1022001, 1012000	

CITY OF FAYETTEVILLE
DB 1283 PG 34
PB 17 PG 00

CITY OF FAYETTEVILLE
DB 1283 PG 34
PB 17 PG 00

CITY OF FAYETTEVILLE
DB 1283 PG 34
PB 17 PG 00

CITY OF FAYETTEVILLE
DB 1283 PG 34
PB 17 PG 00

CITY OF FAYETTEVILLE
DB 1283 PG 34
PB 17 PG 00

CITY OF FAYETTEVILLE
DB 1283 PG 34
PB 17 PG 00

CITY OF FAYETTEVILLE
DB 1283 PG 34
PB 17 PG 00

SEE SHEET No. 24 FOR -Y3- PROFILE



8/17/09

NAD 83/NRSR 2007

PROJECT REFERENCE NO. B-4490	SHEET NO. 15
ROW SHEET NO.	
ROADWAY DESIGN ENGINEER	HYDRAULICS ENGINEER
PRELIMINARY PLANS DO NOT USE FOR CONSTRUCTION	
PLANS PREPARED BY: PARSONS BRINCKERHOFF 434 INDUSTRIAL STREET FAYETTEVILLE, NC 27408 TEL: 704.336.2766 FAX: 704.336.2888	

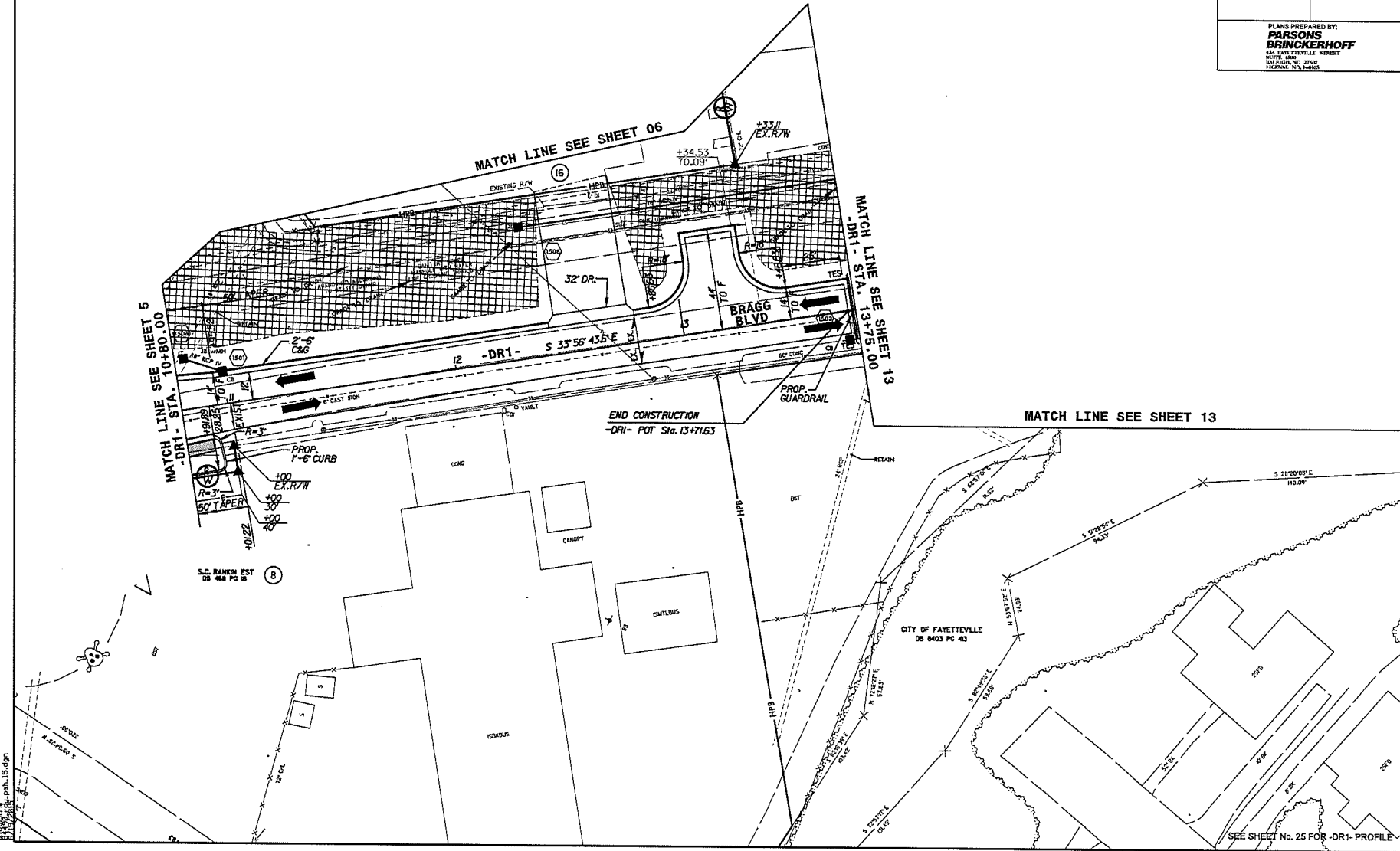

MATCH LINE SEE SHEET 5
-DR1- STA. 10+80.00

MATCH LINE SEE SHEET 06

MATCH LINE SEE SHEET 13
-DR1- STA. 13+75.00

MATCH LINE SEE SHEET 13

END CONSTRUCTION
-DR1- POT Sta. 13+71.63

S.C. RANKIN EST
DB 408 PC 8 (B)

CITY OF FAYETTEVILLE
DB 8403 PC 43

SEE SHEET No. 25 FOR -DR1- PROFILE

8/17/09
p-h-15.dgn

8/22/93

PAVEMENT SCHEDULE	
C1	1.5" TYPE 59.0B
C2	3" TYPE 59.0B
C3	VAR. DEPTH TYPE 59.0B
D1	4" 119.0B
D2	VAR. DEPTH 119.0B
E1	4" TYPE B25.0B
E2	VAR. DEPTH TYPE B25.0B
R1	2'-6" CONCRETE C&G
R2	1'-6" CONCRETE C&G
R3	2'-0" CONCRETE C&G
R4	5" MONO. CONC. ISLAND
S	4" CONCRETE SIDEWALK
T	EARTH MATERIAL
U	EXISTING PAVEMENT
V1	1.5" MILLING ASPHALT PAVEMENT
V2	3" MILLING ASPHALT PAVEMENT
W	WEDGING DETAIL

PROJECT REFERENCE NO. B-4490	SHEET NO. 2A-2
ROADWAY DESIGN ENGINEER	PAVEMENT DESIGN ENGINEER
PRELIMINARY PLANS DO NOT USE FOR CONSTRUCTION	

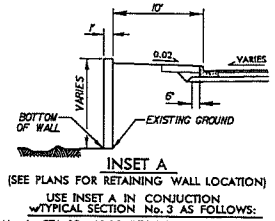
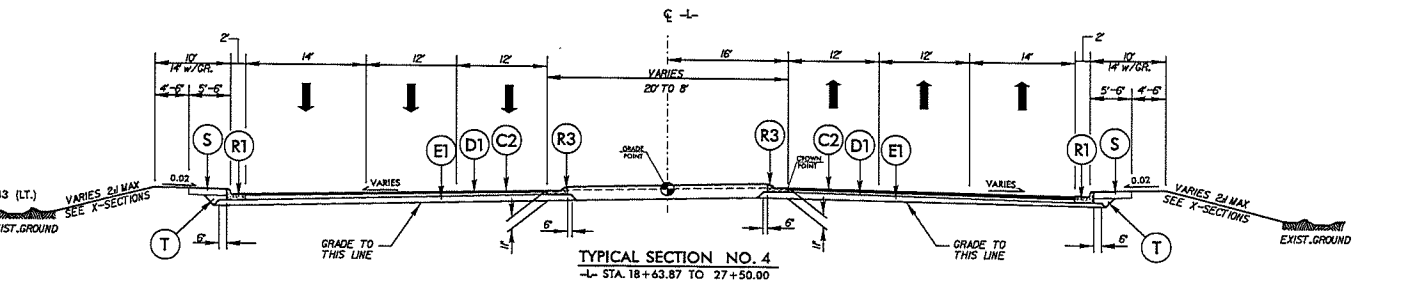
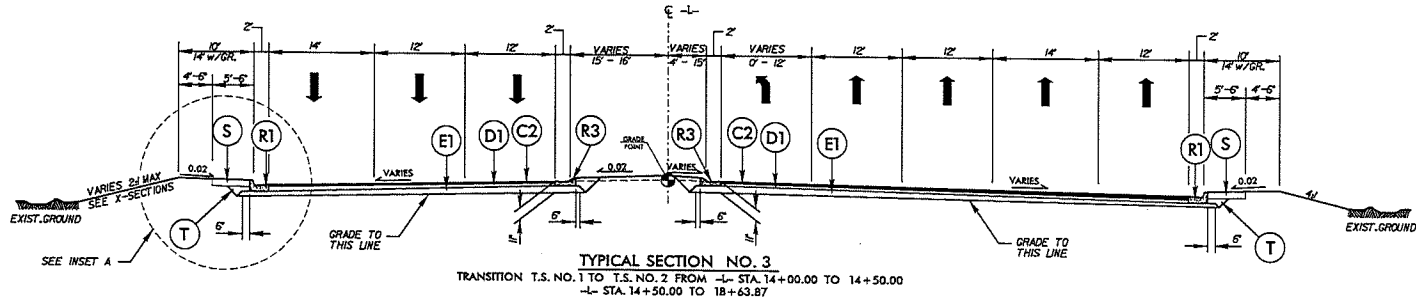
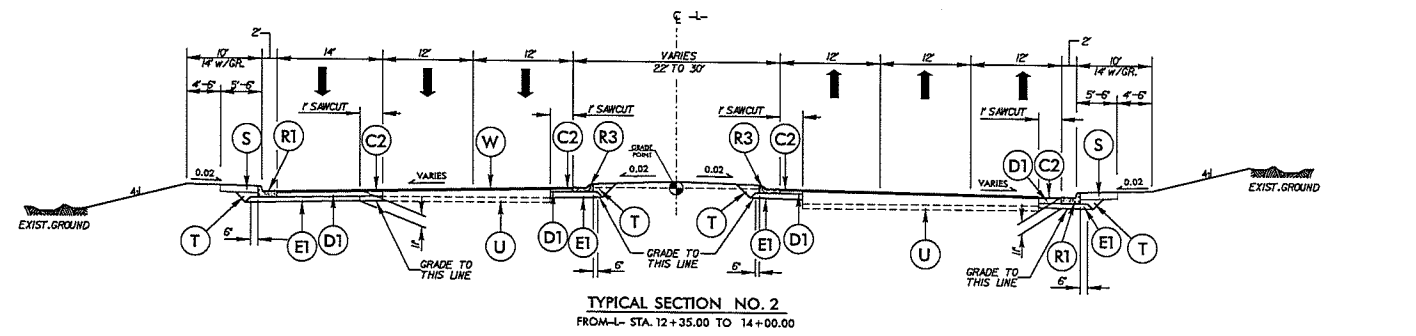
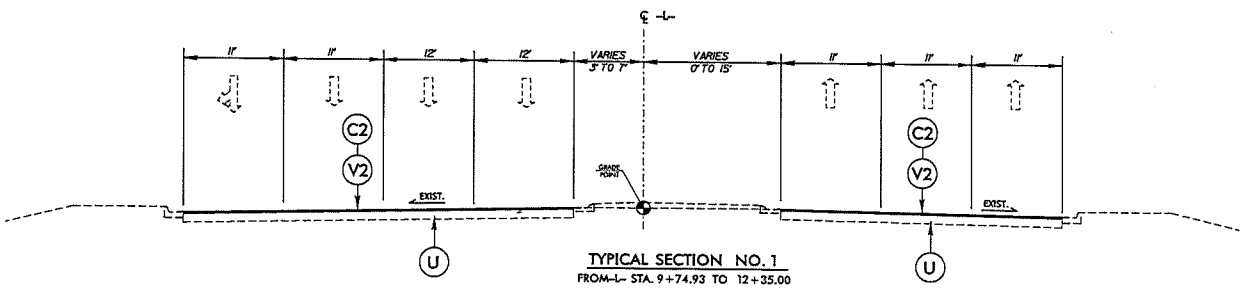

8/22/93

6/27/93

PAVEMENT SCHEDULE	
C1	1.5" TYPE 89.5B
C2	3" TYPE 59.5B
C3	VAR. DEPTH TYPE 89.5B
D1	4" 119.0B
D2	VAR. DEPTH 119.0B
E1	4" TYPE B25.0B
E2	VAR. DEPTH TYPE B25.0B
R1	2'-6" CONCRETE C&G
R2	1'-6" CONCRETE C&G
R3	2'-6" CONCRETE C&G
R4	5" MONO. CONC. ISLAND
S	4" CONCRETE SIDEWALK
T	EARTH MATERIAL
U	EXISTING PAVEMENT
V1	1.5" MILLING ASPHALT PAVEMENT
V2	3" MILLING ASPHALT PAVEMENT
W	WEDGING DETAIL

PROJECT REFERENCE NO. E-4450	SHEET NO. EA-4
ROADWAY DESIGN ENGINEER	PAVEMENT DESIGN ENGINEER
PRELIMINARY PLANS DO NOT USE FOR CONSTRUCTION	

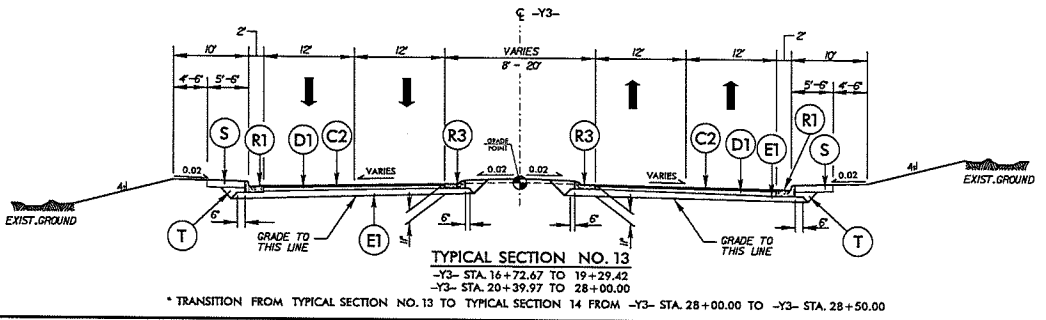
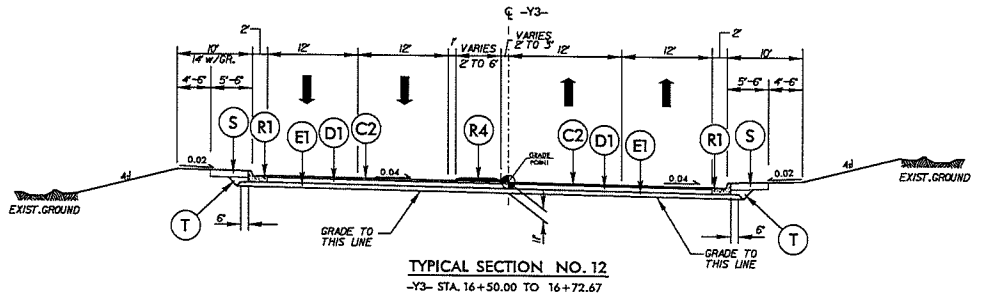
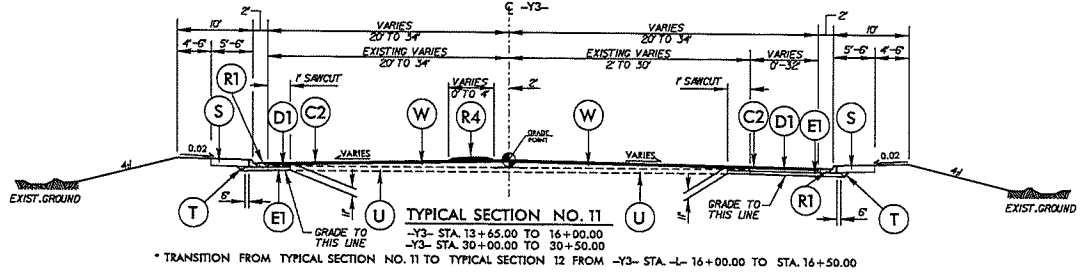
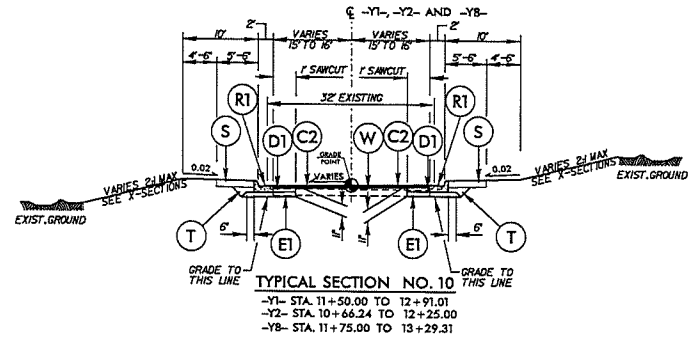

6/27/93 M. J. ...

6/22/99
28-1-Edgn
2/2/2000

DETAIL SHOWING BRIDGE IN RELATION TO PAVEMENT

PROJECT REFERENCE NO.	SHEET NO.
B-4430	28-1

ROADWAY DESIGN ENGINEER

PRELIMINARY PLANS
DO NOT USE FOR CONSTRUCTION

NAD BASIS 2011

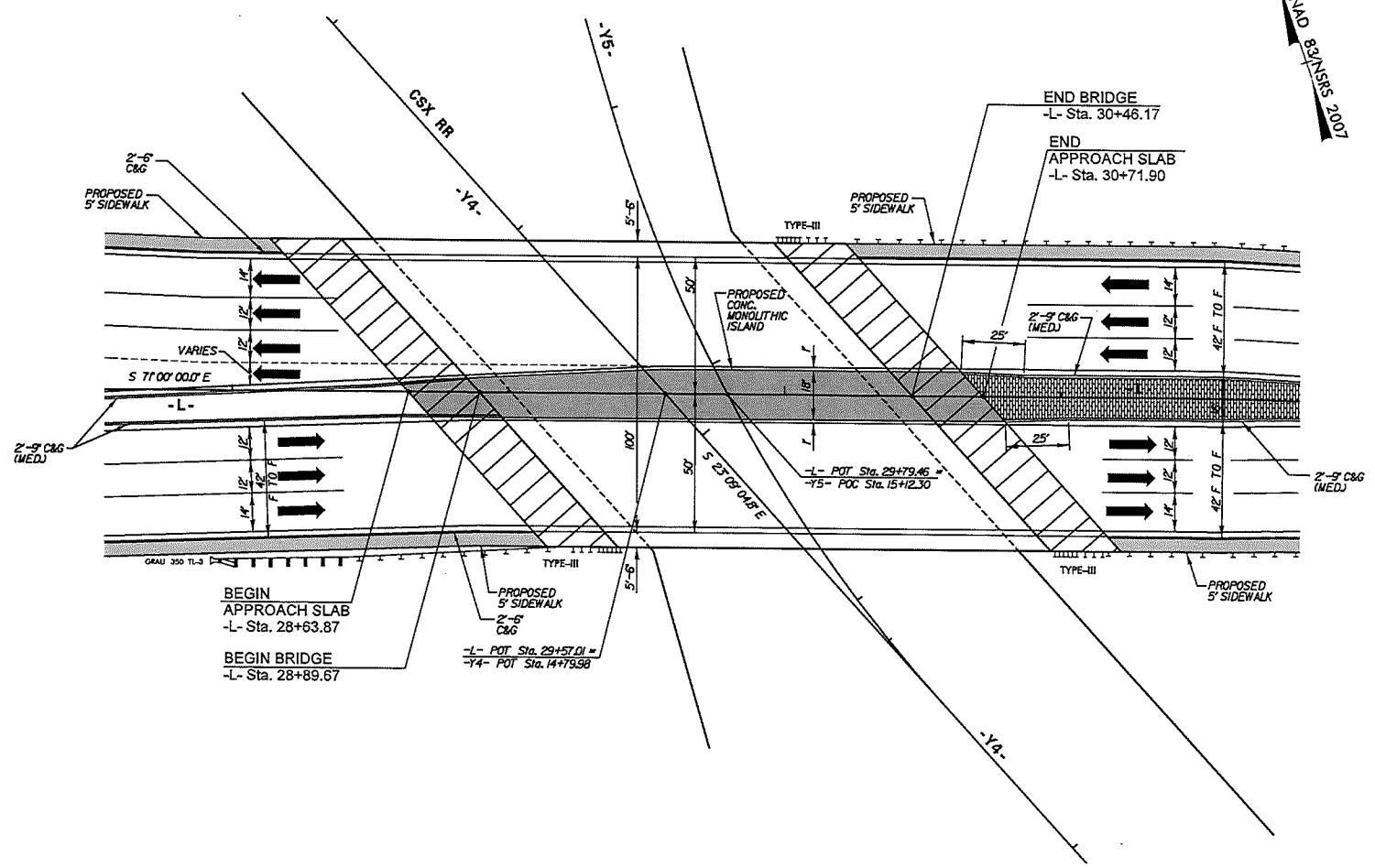

6/2/99

11/15/95 PM 2:29:22.dgn

PROJECT REFERENCE NO. B-4490	SHEET NO. 25-2
ROADWAY DESIGN ENGINEER	

DETAIL SHOWING BRIDGE IN RELATION TO PAVEMENT

PRELIMINARY PLANS
DO NOT USE FOR CONSTRUCTION

NAD 83/NSRS 2001

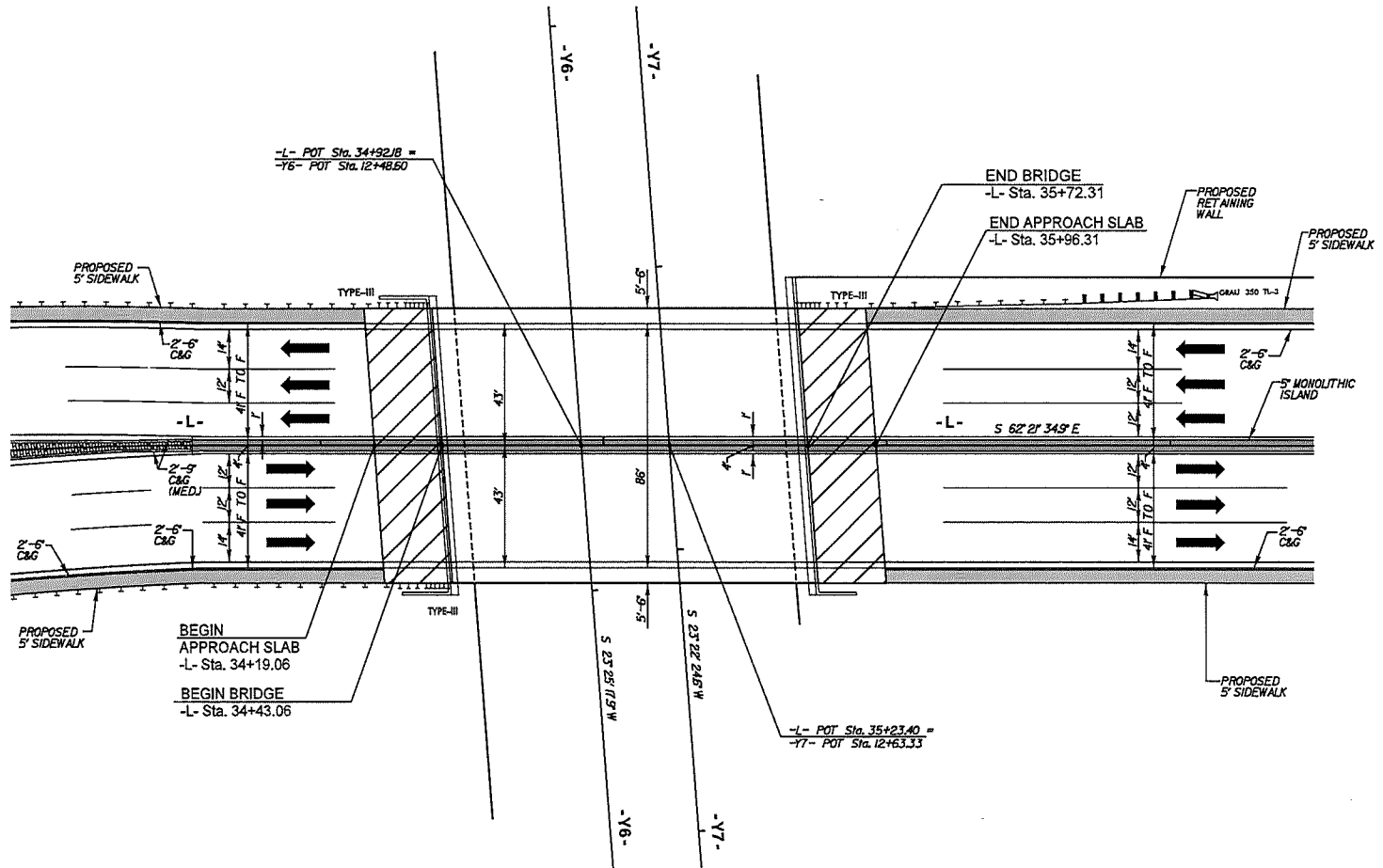

5/28/99

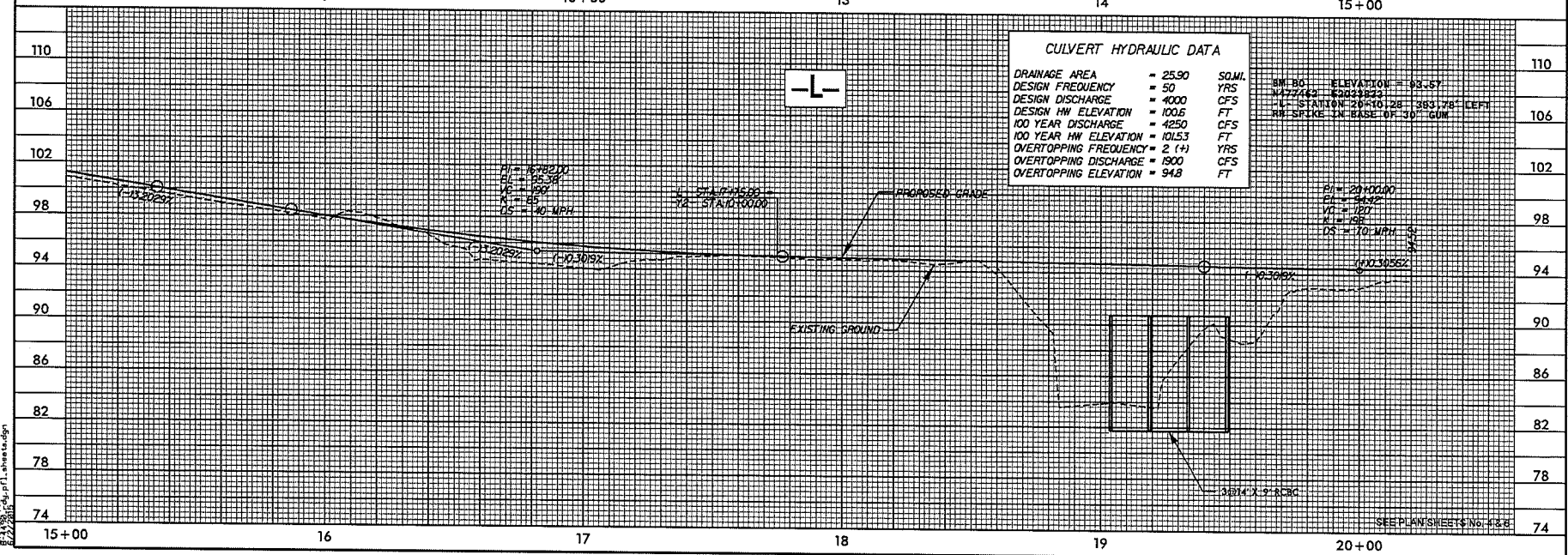
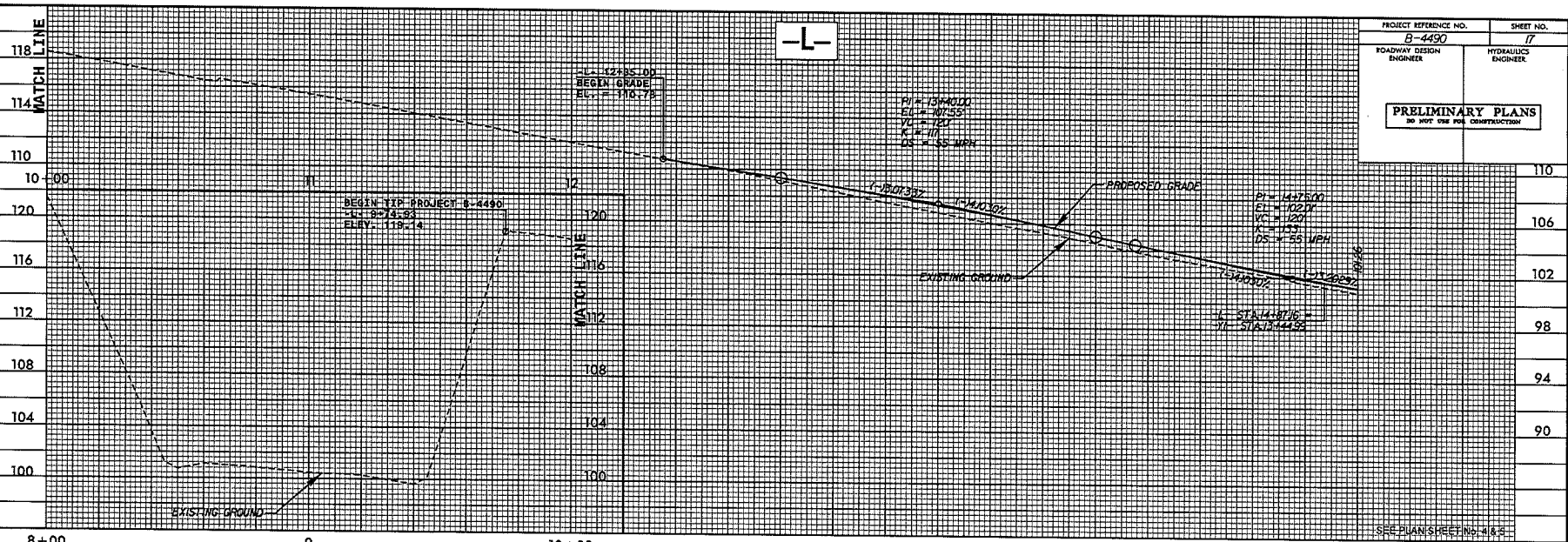

P:\11301\11301.dgn