

**PERMIT DRAWING  
SHEET 16 OF 62**

PROJECT REFERENCE NO. <b>U-2579B</b>	SHEET NO. <b>11</b>
RW SHEET NO.	
ROADWAY DESIGN ENGINEER	HYDRAULICS ENGINEER
<b>PRELIMINARY PLANS</b> DO NOT USE FOR CONSTRUCTION	

AREA U/C  
WINSTON-SALEM/FORSYTH COUNTY BOARD OF EDUCATION

**F F** DENOTES FILL IN  
METLAND

**S S** DENOTES IMPACTS IN  
SURFACE WATER

SECRETARY OF  
VETERANS AFFAIRS

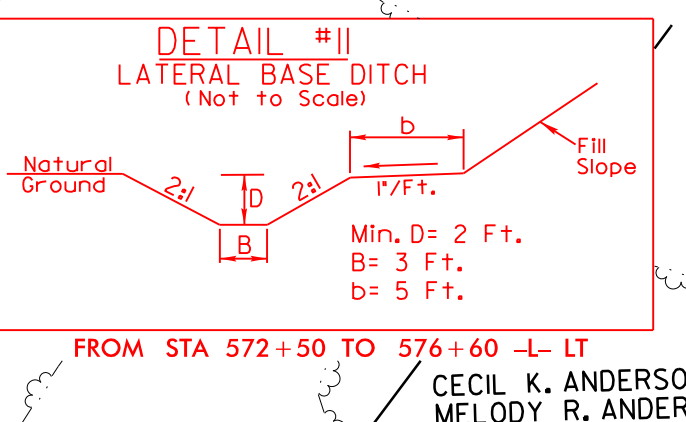
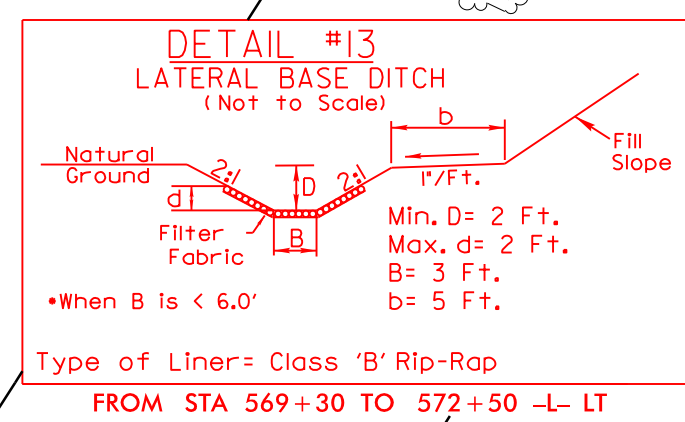
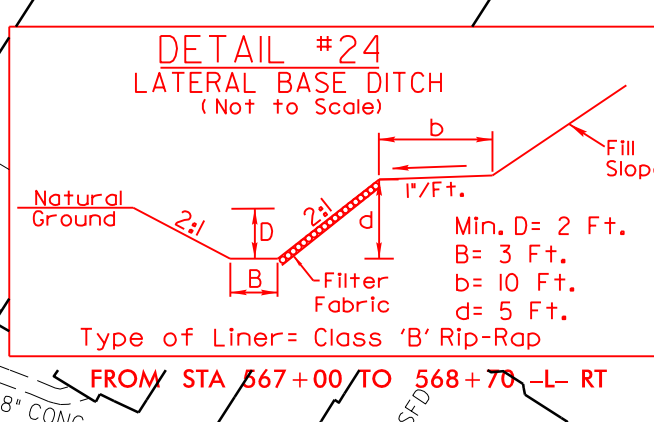
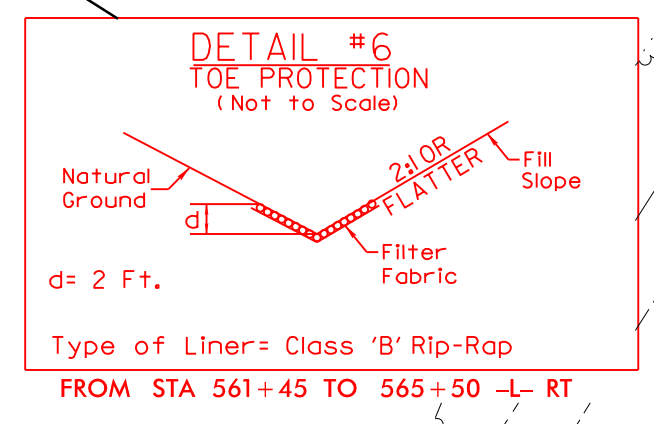
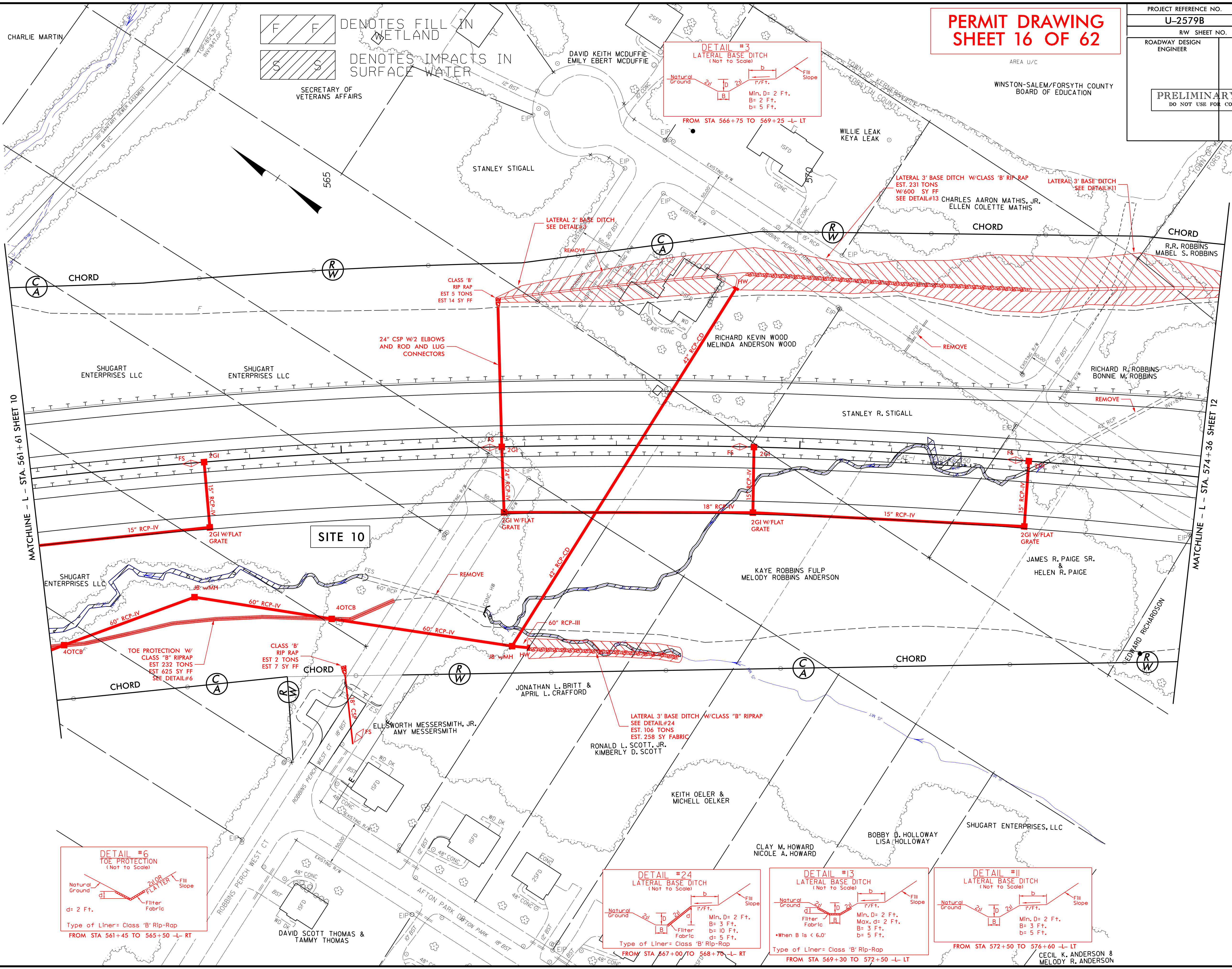
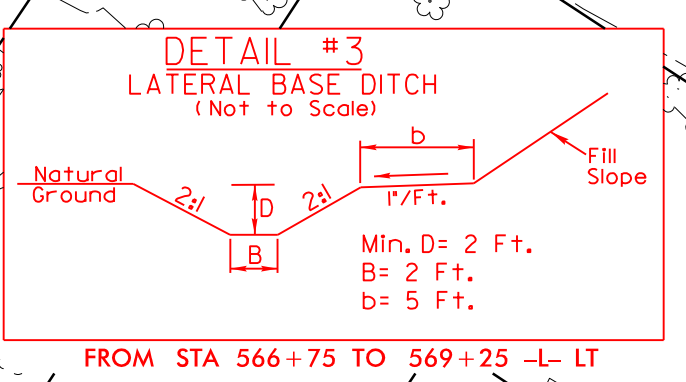

REVISIONS  
 7/2/2015  
 L:\Projects\1042\07043 - U-2579B, Forsyth\Drawings\Hydraulics\PERMITS\Environmental\DRAWINGS\U2579B\_hyd.prm\_wet\_pah11.dgn  
 8/17/99

MATCHLINE - L - STA. 561 + 61 SHEET 10

MATCHLINE - L - STA. 574 + 36 SHEET 12

PROJECT REFERENCE NO.	SHEET NO.
U-2579B	11
RW SHEET NO.	
ROADWAY DESIGN ENGINEER	HYDRAULICS ENGINEER
PRELIMINARY PLANS DO NOT USE FOR CONSTRUCTION	

**PERMIT DRAWING  
SHEET 17 OF 62**

AREA U/C  
WINSTON-SALEM/FORSYTH COUNTY  
BOARD OF EDUCATION

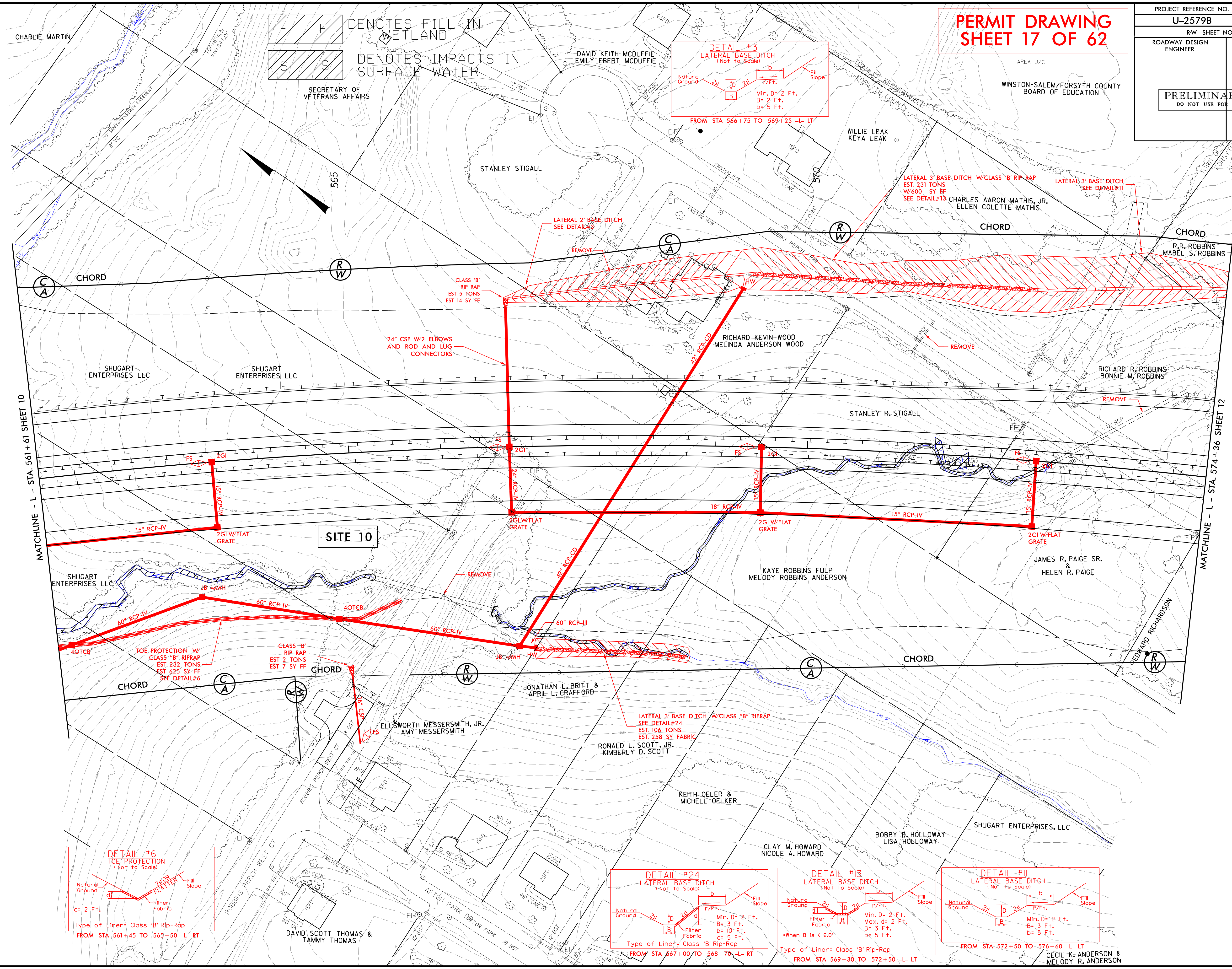

**F F** DENOTES FILL IN  
WETLAND  
**S S** DENOTES IMPACTS IN  
SURFACE WATER

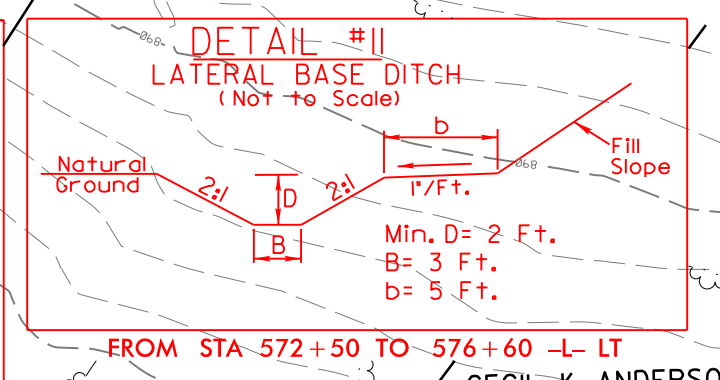
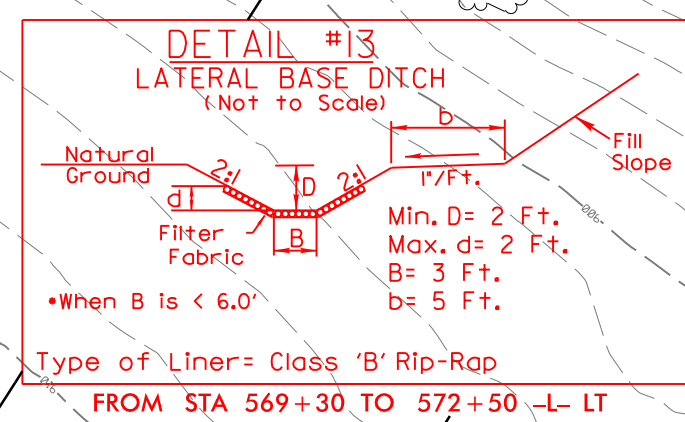
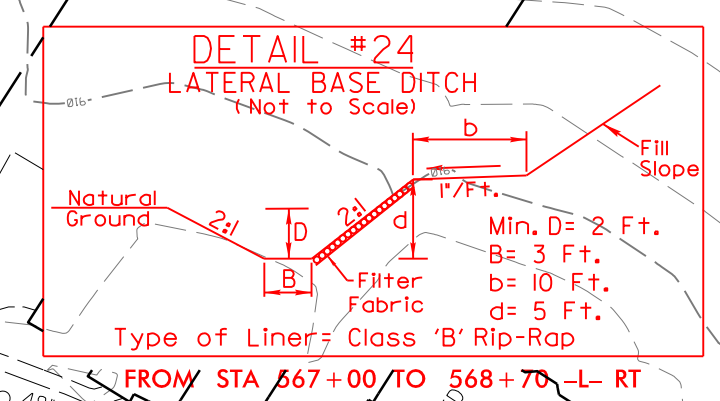
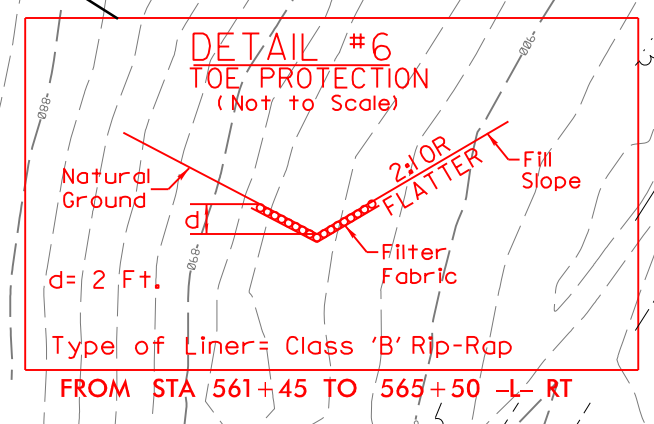
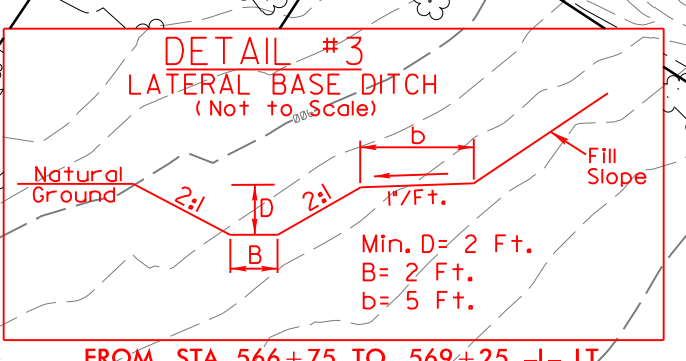

REVISIONS  
 7/2/2015  
 L:\Projects\1042\07043 - U-2579B\_Forsyth\HOW\_Plans\_20130214\U2579B\_Hydraulics\PERMITS\_Environmental\DRAWINGS\U2579B\_hyd\_perm\_wet\_pah11\_con.dgn

8/17/99

MATCHLINE - L - STA. 574 + 36 SHEET 12

MATCHLINE - L - STA. 561 + 61 SHEET 10

CECIL K. ANDERSON &  
MELODY R. ANDERSON

PROJECT REFERENCE NO.		SHEET NO.	
U-2579B		15	
RW SHEET NO.		HYDRAULICS ENGINEER	
ROADWAY DESIGN ENGINEER			
PRELIMINARY PLANS DO NOT USE FOR CONSTRUCTION			

PERMIT DRAWING  
SHEET 18 OF 62

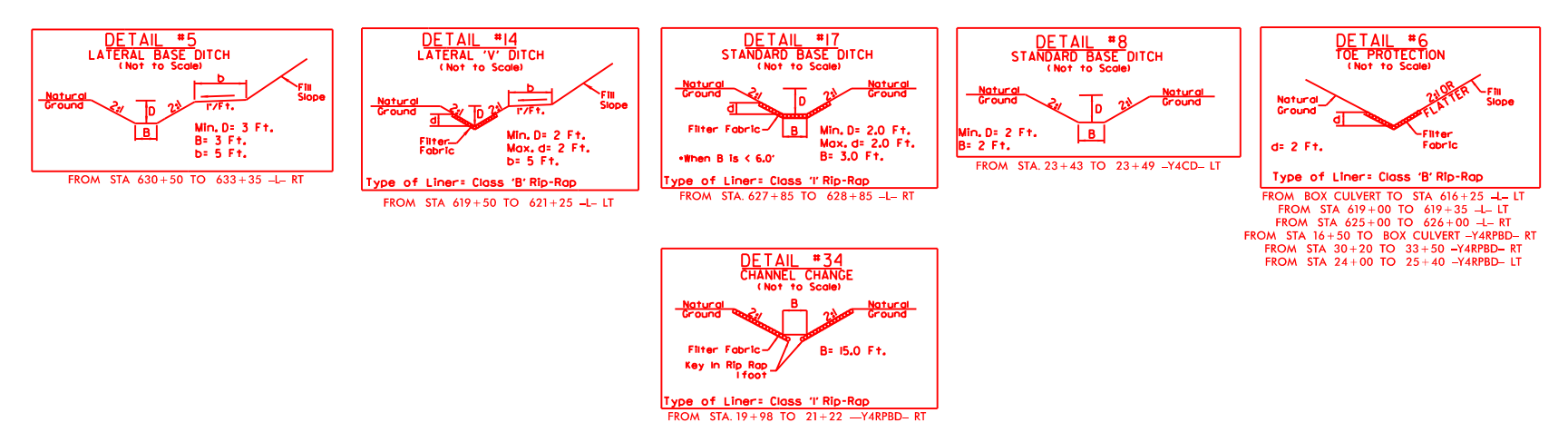
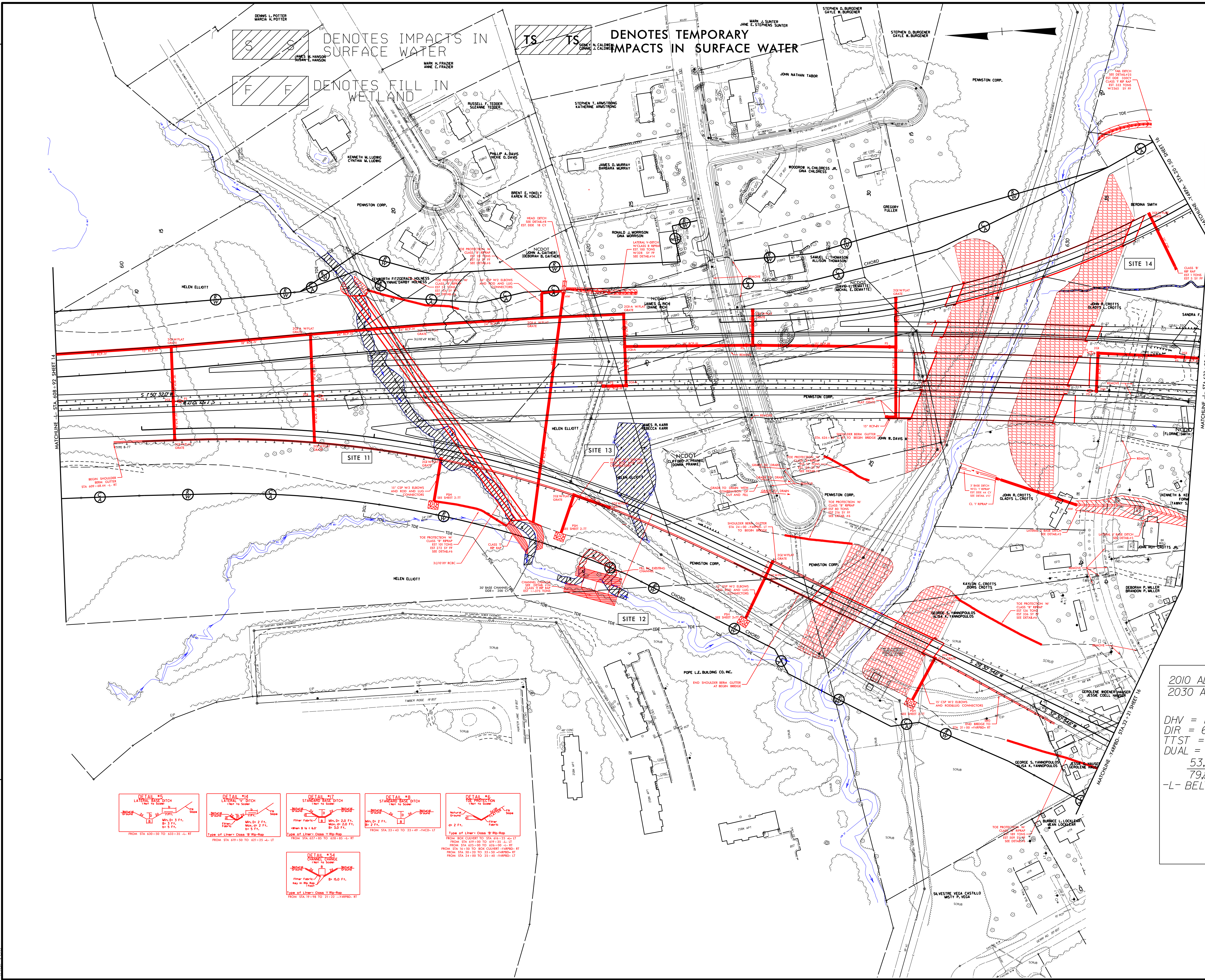

2010 ADT		TRAFFIC DIAGRAM	
2010 ADT		47,720	
2030 ADT		61,160	
DHV = 10%			
DIR = 60%	32,600	5,360	
TTST = 12%	43,800	7,280	
DUAL = 6%			
	53,560		24,660
	79,880		36,980
-L- BELTLINE	6,600	4,940	
	11,800	5,420	
DHV = 10%			
DIR = 60%		21,300	
TTST = 6%		27,300	
DUAL = 5%			
-Y4- (US 421/1-40 BUS.)			

REVISIONS  
 RIGHT OF WAY REVISION 11/5/12 - PARCEL 98 ADJUSTED ON PLANS TO MAKE IT VISIBLE  
 RIGHT OF WAY REVISION 11/5/12 - PARCEL 98A ADDED

7/2/2013  
 L:\ProjectList\1042\07043 - U-2579B Forsyth\Drawings\Hydraulics\PERMITS\_Environmental\Drawings\U2579B\_Hydr\_prm\_wet\_pah15.dgn  
 8/17/99

PROJECT REFERENCE NO.	SHEET NO.
U-2579B	15
RW SHEET NO.	
ROADWAY DESIGN ENGINEER	HYDRAULICS ENGINEER
PRELIMINARY PLANS DO NOT USE FOR CONSTRUCTION	

PERMIT DRAWING  
SHEET 19 OF 62

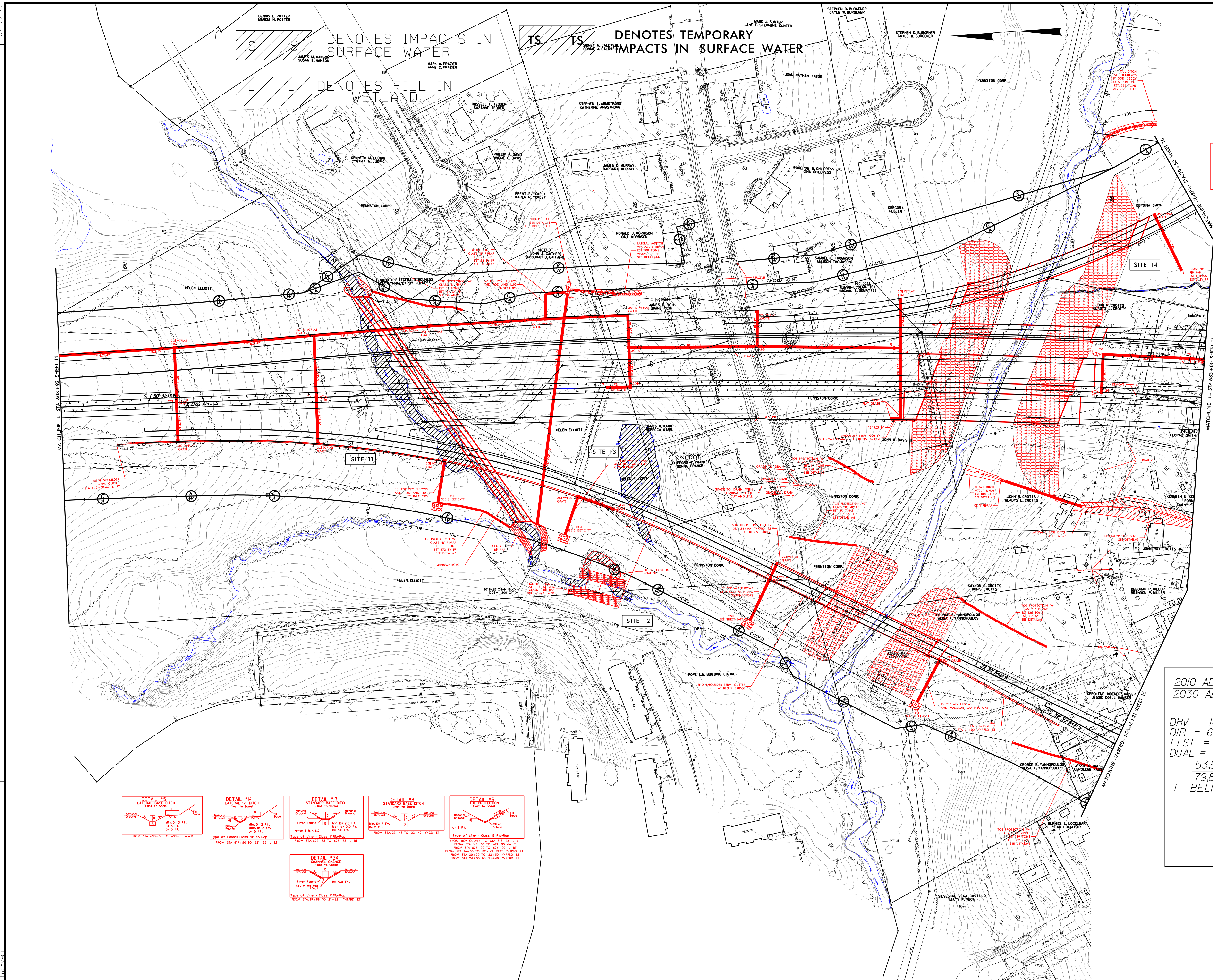

REVISIONS  
 RIGHT OF WAY REVISION II/5/12 - PARCEL 98 ADJUSTED ON PLANS TO MAKE IT VISIBLE  
 RIGHT OF WAY REVISION II/5/12 - PARCEL 98A ADDED

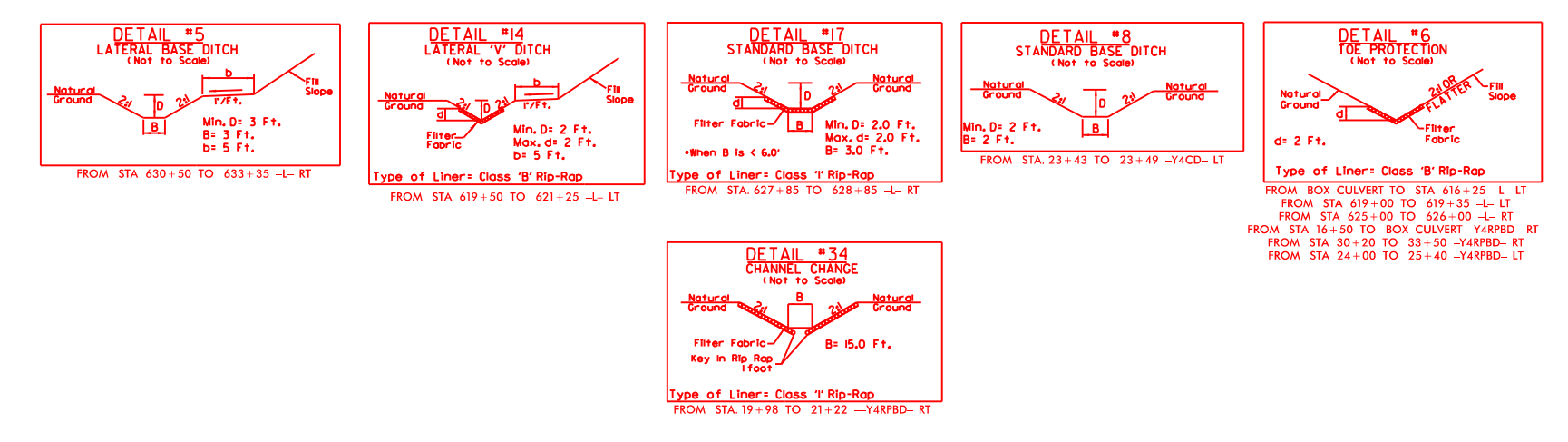

	TRAFFIC DIAGRAM	
2010 ADT	47,720	
2030 ADT	61,600	
DHV = 10%		
DIR = 60%	32,600	5,360
TTST = 12%	43,800	7,280
DUAL = 6%		
	53,560	24,660
	79,880	36,980
-L- BELTLINE	6,600	4,940
	11,800	5,420
DHV = 10%		
DIR = 60%		
TTST = 6%	21,300	
DUAL = 5%	27,300	
-Y4- (US 421/1-40 BUS.)		

PROJECT REFERENCE NO. U-2579B	SHEET NO. 15-1
RW SHEET NO.	
ROADWAY DESIGN ENGINEER	HYDRAULICS ENGINEER
<b>INCOMPLETE PLANS</b> DO NOT USE FOR R/W ACQUISITION <b>PRELIMINARY PLANS</b> DO NOT USE FOR CONSTRUCTION	

PERMIT DRAWING  
SHEET 20 OF 62

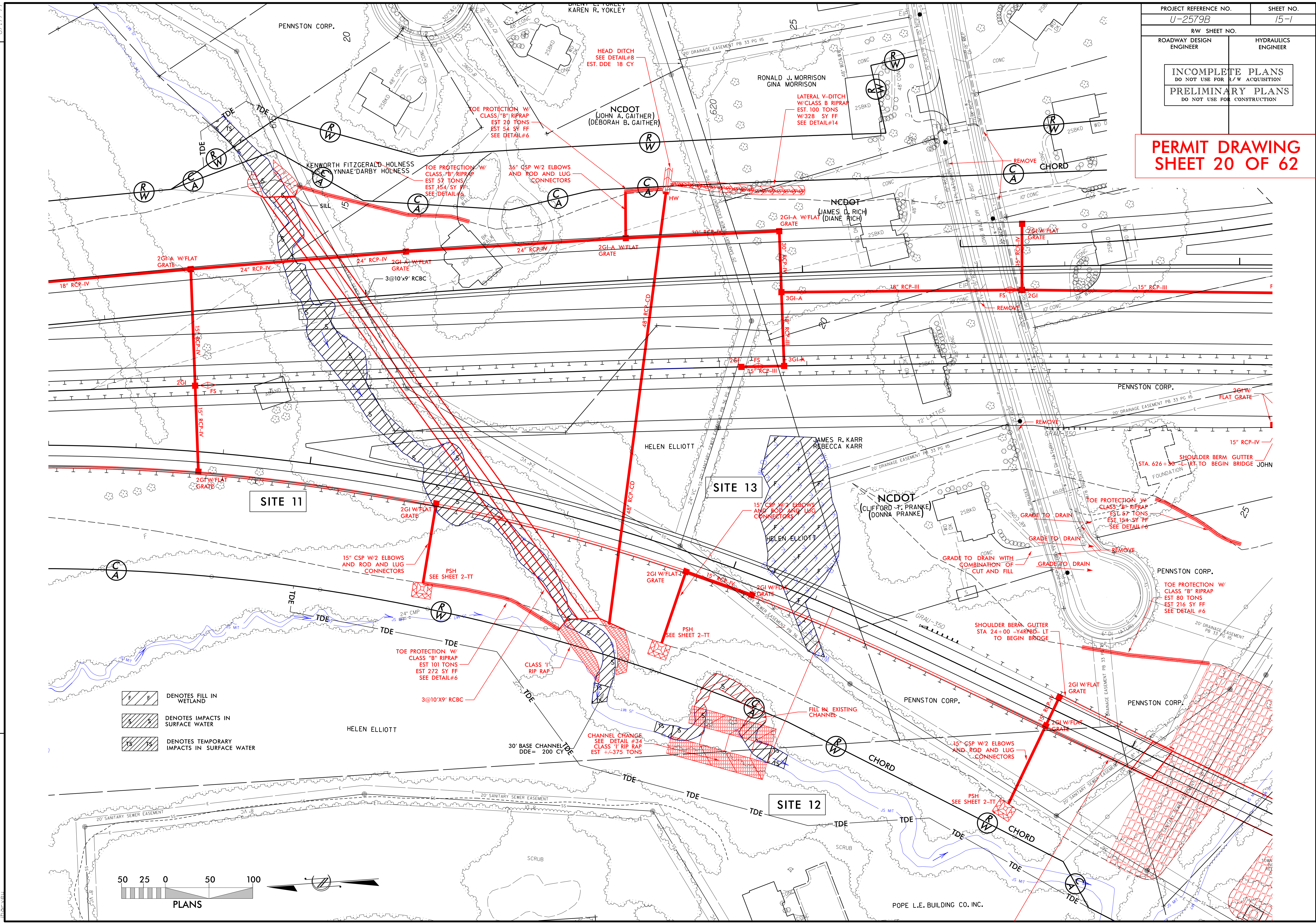

- DENOTES FILL IN WETLAND
- DENOTES IMPACTS IN SURFACE WATER
- DENOTES TEMPORARY IMPACTS IN SURFACE WATER

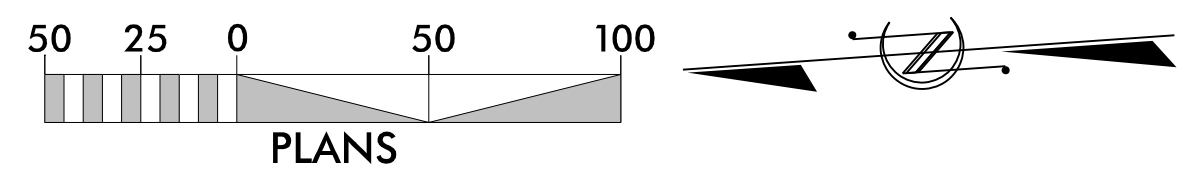

REVISIONS  
 7/2/2015  
 L:\proj\2015\1042\07043 - U-2579B - For\syth\DWG - Plans\_20150214\U2579B\Hydraulics\PERMITS\Environmental\DRAWINGS\U2579B\_hyd\_perm\_wet\_pah15\_SITE11.dgn

8/17/99

PROJECT REFERENCE NO. U-2579B	SHEET NO. 15-2
RW SHEET NO.	
ROADWAY DESIGN ENGINEER	HYDRAULICS ENGINEER
INCOMPLETE PLANS DO NOT USE FOR R/W ACQUISITION	
PRELIMINARY PLANS DO NOT USE FOR CONSTRUCTION	

**PERMIT DRAWING  
SHEET 21 OF 62**

 DENOTES IMPACTS IN SURFACE WATER

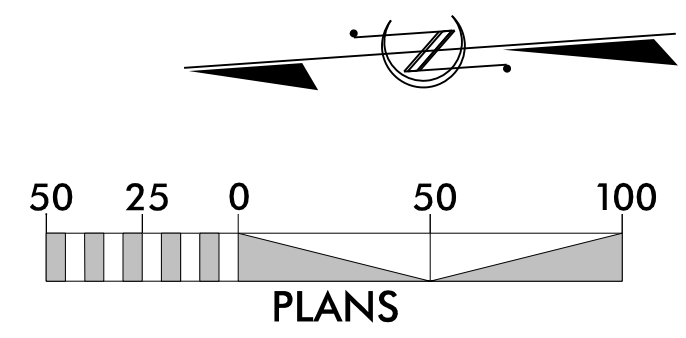

REVISIONS  
 7/2/2015  
 L:\proj\2015\07043 - U-2579B - Forsyth\HOW - Plans\_201507043\Drawings\Hydraulics\PERMITS\_Environmental\DRAWINGS\U2579B\_hyd\_perm\_wet\_pah15\_SITE14.dgn

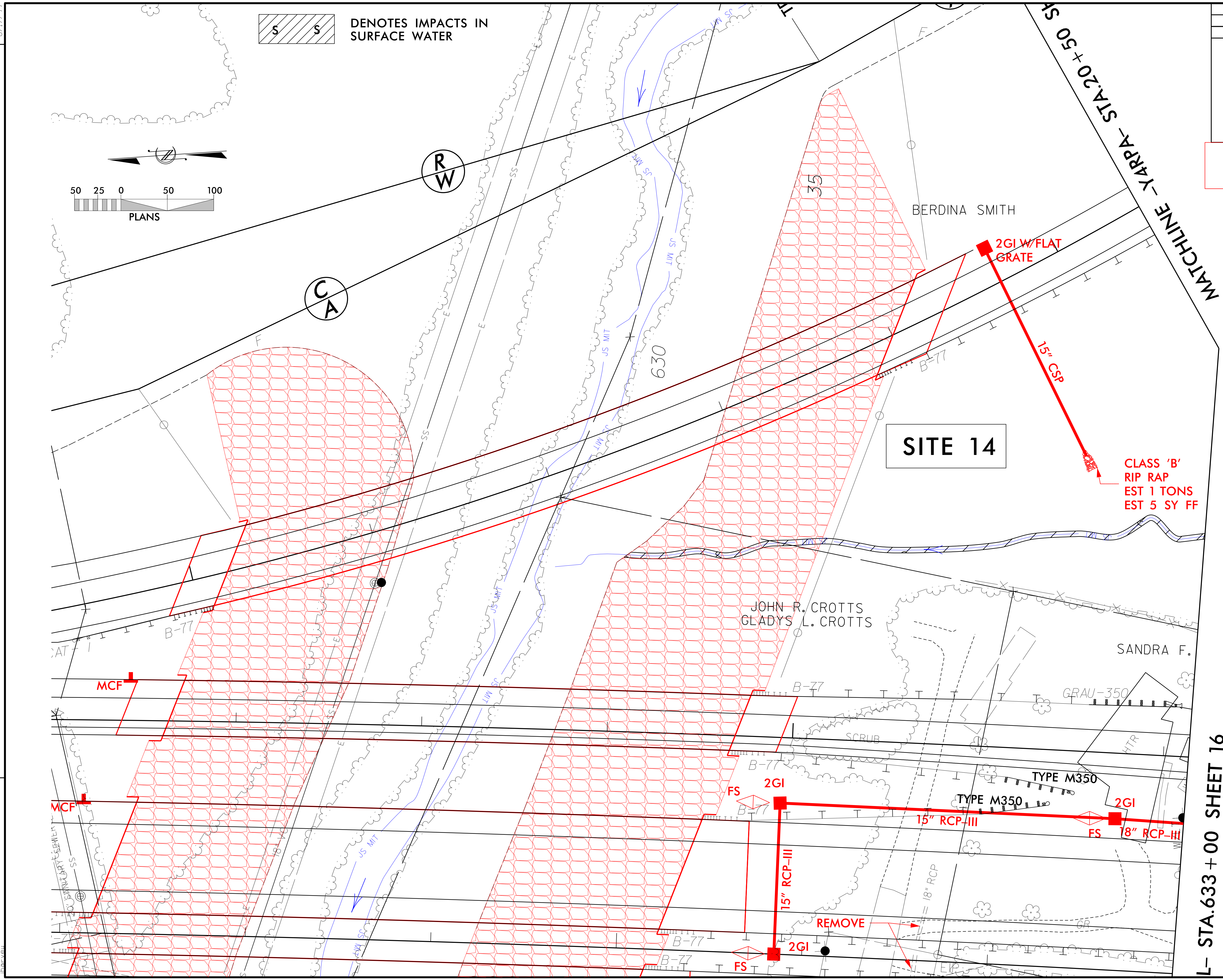

L- STA.633 + 00 SHEET 16

MATCHLINE - YARPA - STA.20 + 50

PROJECT REFERENCE NO.	SHEET NO.
U-2579B	
RW SHEET NO.	
ROADWAY DESIGN ENGINEER	HYDRAULICS ENGINEER
<b>INCOMPLETE PLANS</b> DO NOT USE FOR R/W ACQUISITION	
<b>PRELIMINARY PLANS</b> DO NOT USE FOR CONSTRUCTION	

**PERMIT DRAWING  
SHEET 22 OF 62**

REVISIONS

8/17/99  
7/2/2013  
L:\Projects\1042\1042\07043 - U-2579B\_Forsyth\HDW\_Plans\_20130214\U2579B\Hydraulics\PERMITS\_Environmental\DRAWINGS\U2579b\_hyd\_perm\_wet\_pah15A\_Lst0615.dgn

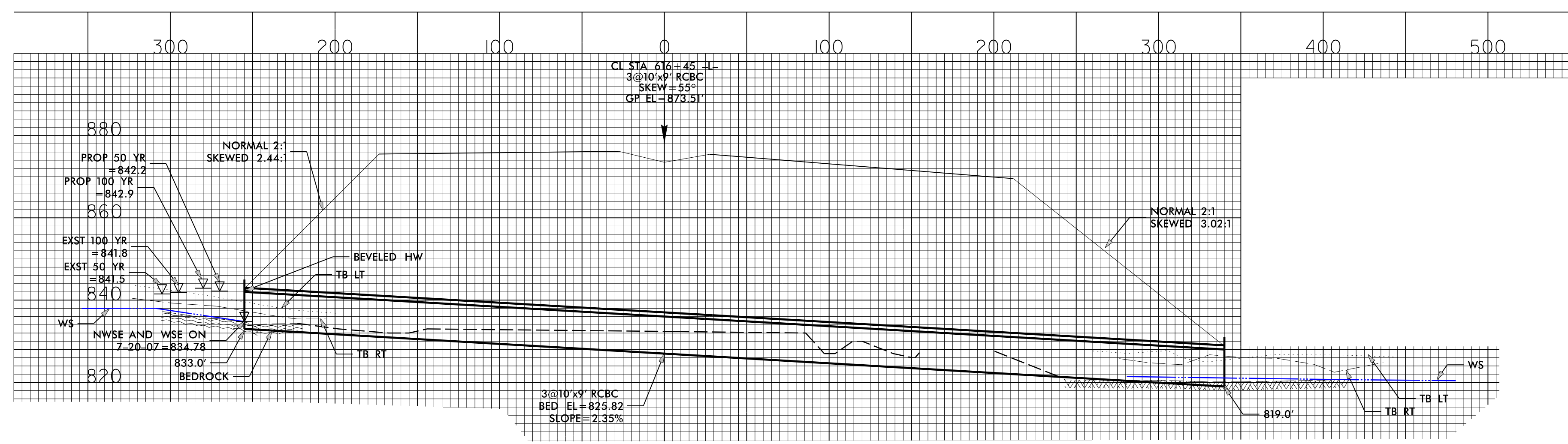

PROJECT REFERENCE NO. <b>U-2579B</b>	SHEET NO. <b>16</b>
RW SHEET NO.	
ROADWAY DESIGN ENGINEER	HYDRAULICS ENGINEER
<b>PRELIMINARY PLANS</b> DO NOT USE FOR CONSTRUCTION	

RIGHT OF WAY REVISION 11/5/12 - PLANS ADJUSTED SO THAT PARCEL 98 IS VISIBLE ON PLANS

7/2/2015 C:\p\list\1042\07043 - U-2579B ForSyth\Drawings\Hydraulics\PERMITS\Environmental\Drawings\U2579b\_hyd.prm\_wet\_pah16.dgn

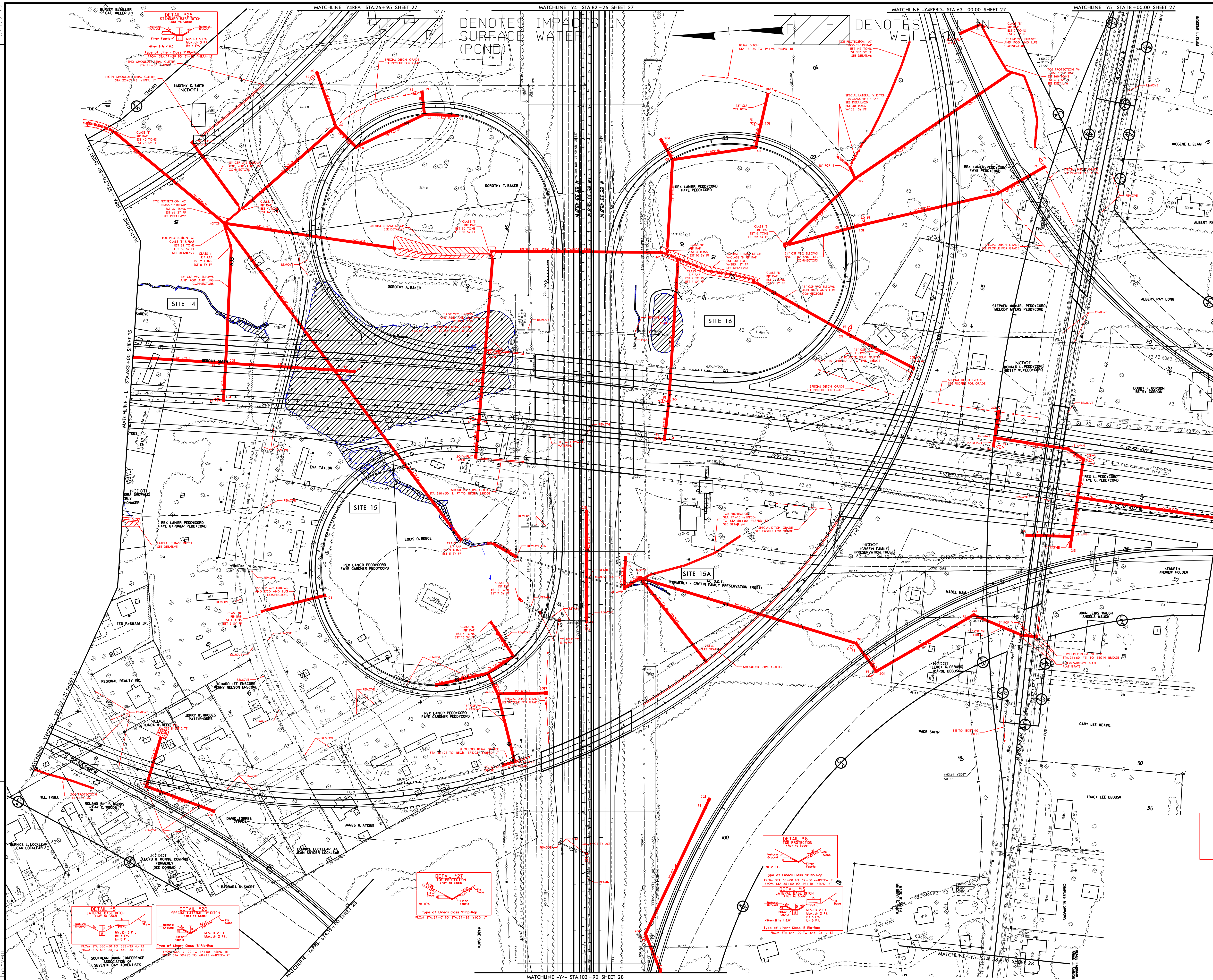

2010 ADT	TRAFFIC DIAGRAM	
2030 ADT	47,720	61,600
DHV = 10%	32,600	5,360
DIR = 60%	43,800	7,280
TTST = 12%		
DUAL = 6%		
53,560		24,660
79,880		36,980
-L- BELTLINE	6,600	4,940
	11,800	5,420
DHV = 10%		
DIR = 60%		
TTST = 6%	21,300	
DUAL = 5%	27,300	
-Y4- (US 42/1-40 BUS.)		

PERMIT DRAWING SHEET 23 OF 62



PROJECT REFERENCE NO.	SHEET NO.
U-2579B	16
RW SHEET NO.	
ROADWAY DESIGN ENGINEER	HYDRAULICS ENGINEER
PRELIMINARY PLANS DO NOT USE FOR CONSTRUCTION	

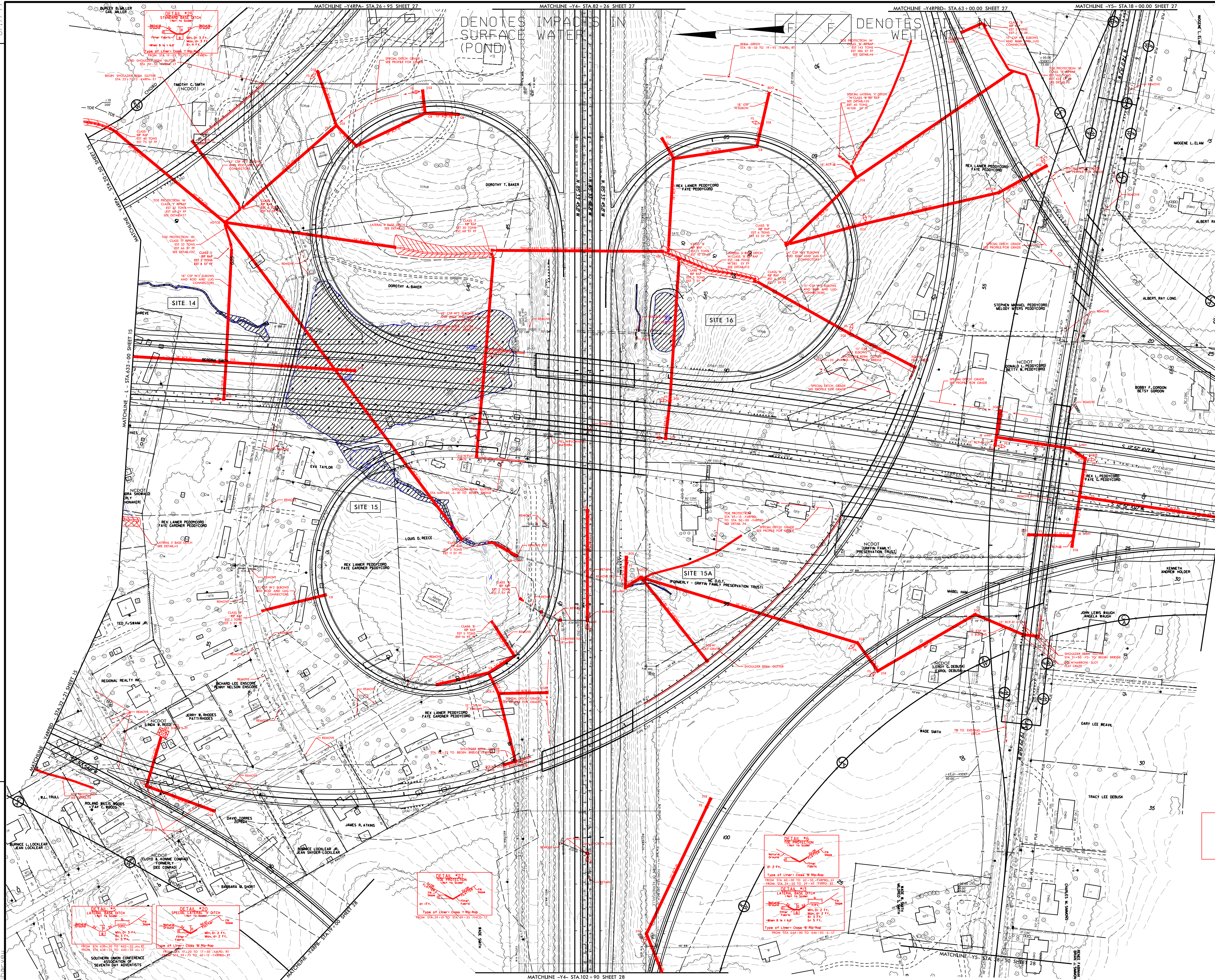

RIGHT OF WAY REVISION 11/5/12 - PLANS ADJUSTED SO THAT PARCEL 98 IS VISIBLE ON PLANS

REVISIONS  
1/2/2015  
L:\proj\2015\1042\07043 - U-2579B\Forsyth\Drawings\Hydraulics\PERMITS\Environmental\Drawings\U2579B\_Hyd.prm.wet\_pah16\_con.dgn

2010 ADT	TRAFFIC DIAGRAM	
2030 ADT	47,720	61,600
DHV = 10%	32,600	5,360
DIR = 60%	43,800	7,280
TTST = 12%		
DUAL = 6%		
53,560		24,660
79,880		36,980
-L- BELTLINE	6,600	4,940
	11,800	5,420
DHV = 10%		
DIR = 60%	21,300	
TTST = 6%	27,300	
DUAL = 5%		
-Y4- (US 42/1-40 BUS.)		

PERMIT DRAWING  
SHEET 24 OF 62

PROJECT REFERENCE NO. U-2579B	SHEET NO. 16-1
RW SHEET NO.	
ROADWAY DESIGN ENGINEER	HYDRAULICS ENGINEER
<b>INCOMPLETE PLANS</b> DO NOT USE FOR R/W ACQUISITION <b>PRELIMINARY PLANS</b> DO NOT USE FOR CONSTRUCTION	

PERMIT DRAWING  
SHEET 25 OF 62

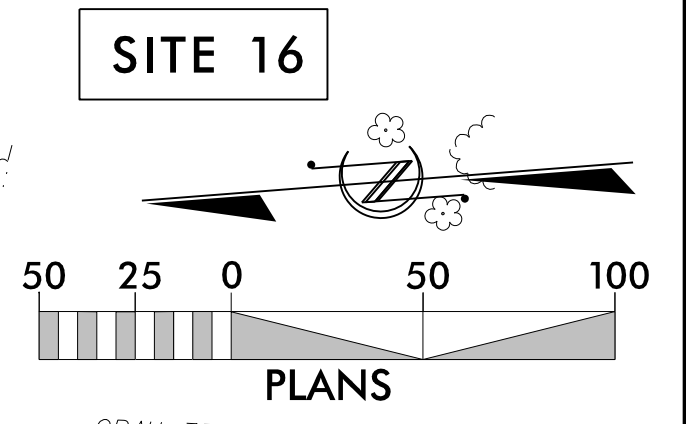

REVISIONS

7/2/2015 1:42:07 PM C:\Users\jrdow\Documents\Drawings\U-2579B\Hydraulics\PERMITS\Environmental\DRAWINGS\U-2579B\hyd.prm\_wet\_pah16\_SITE15.dgn

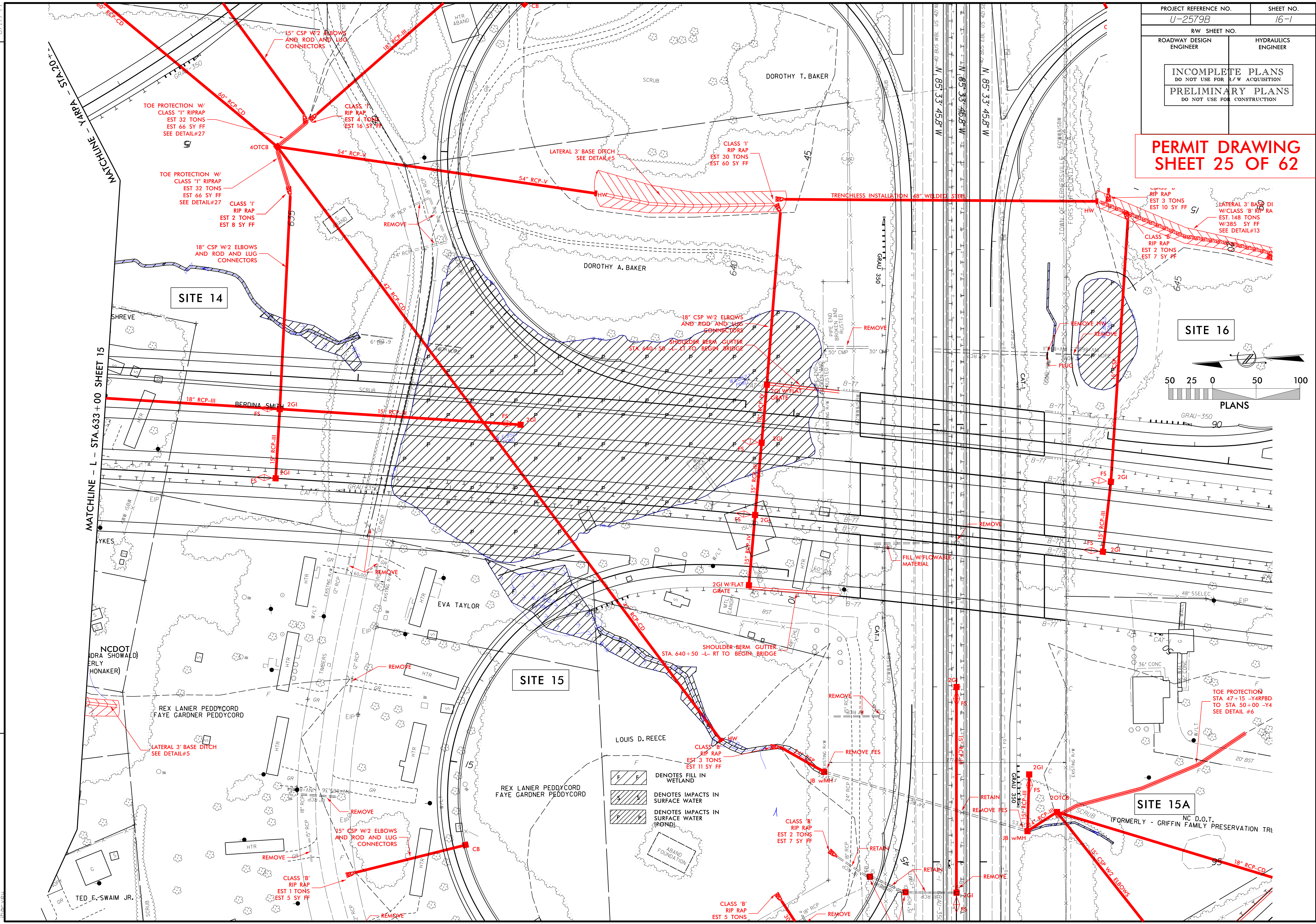

- DENOTES FILL IN WETLAND
- DENOTES IMPACTS IN SURFACE WATER
- DENOTES IMPACTS IN SURFACE WATER (POND)

MATCHLINE - L - STA. 633+00 SHEET 15

MATCHLINE - RARA - STA. 20+00

SITE 15A  
(FORMERLY - GRIFFIN FAMILY PRESERVATION TR)

REX LANIER PEDDYCORD  
FAYE GARDNER PEDDYCORD

REX LANIER PEDDYCORD  
FAYE GARDNER PEDDYCORD

TED E. SWAIM JR.

NC D.O.T.  
(FORMERLY - GRIFFIN FAMILY PRESERVATION TR)

PROJECT REFERENCE NO.	SHEET NO.
U-2579B	17
RW SHEET NO.	
ROADWAY DESIGN ENGINEER	HYDRAULICS ENGINEER
PRELIMINARY PLANS DO NOT USE FOR CONSTRUCTION	

PERMIT DRAWING  
SHEET 26 OF 62

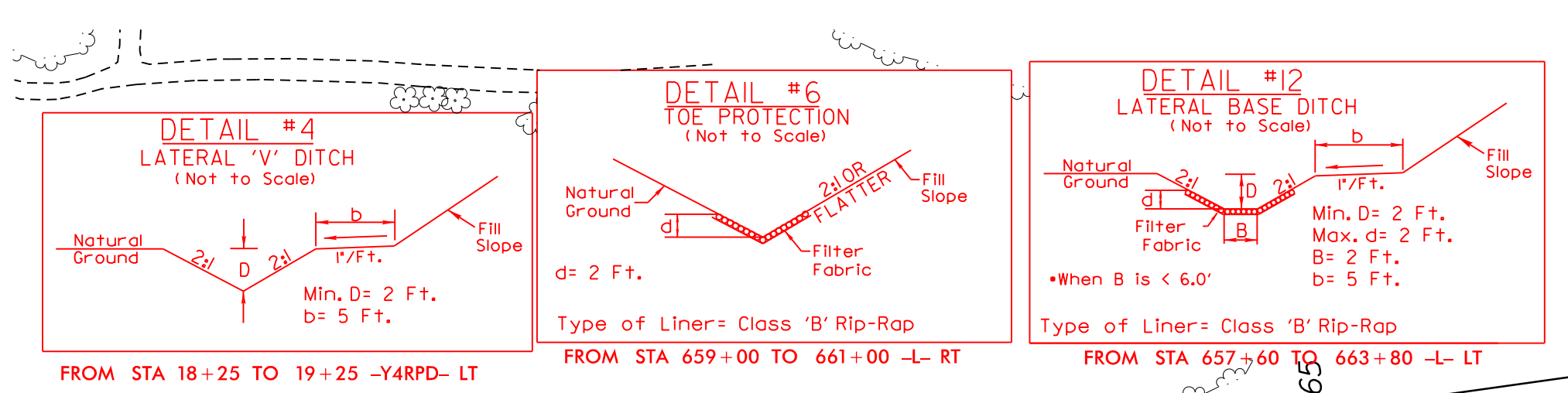

DENOTES FILL IN WETLAND

DENOTES IMPACTS IN SURFACE WATER

DENOTES MECHANIZED CLEARING

REVISIONS  
 7/2/2015  
 L:\proj\2015\1042\07043 - U-2579B\_Forsyth\Drawings\Hydraulics\PERMITS\U2579B\_Hydraulics\U2579B\_hyd.prm\_wet\_pah17.dgn  
 8/17/99

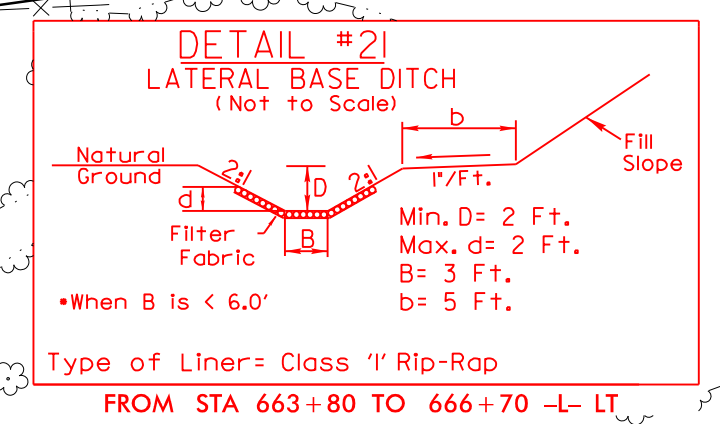
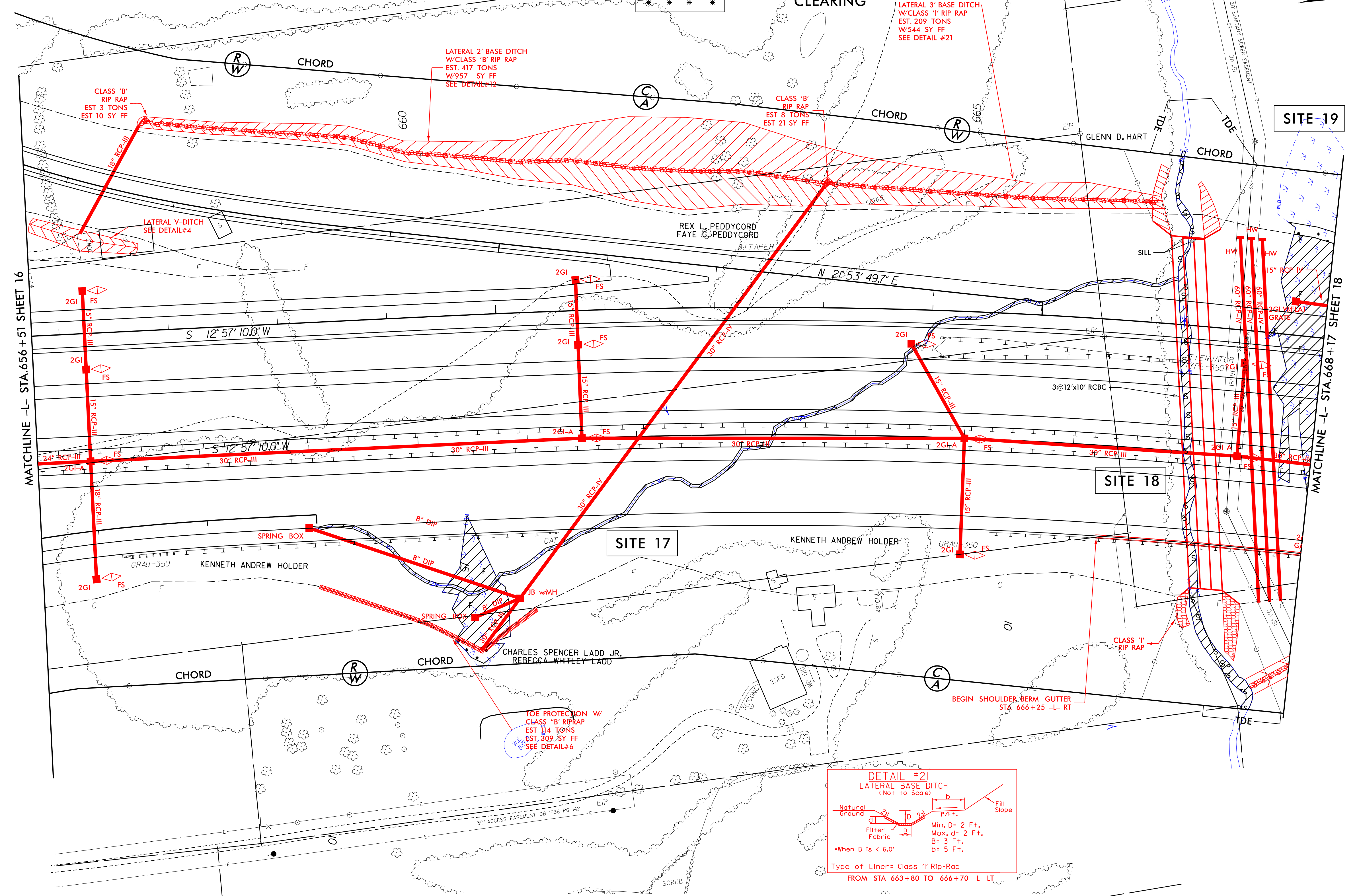

MATCHLINE -L- STA. 656 + 51 SHEET 16

MATCHLINE -L- STA. 668 + 17 SHEET 18

PROJECT REFERENCE NO.	SHEET NO.
U-2579B	17
RW SHEET NO.	
ROADWAY DESIGN ENGINEER	HYDRAULICS ENGINEER
PRELIMINARY PLANS DO NOT USE FOR CONSTRUCTION	

PERMIT DRAWING  
SHEET 27 OF 62

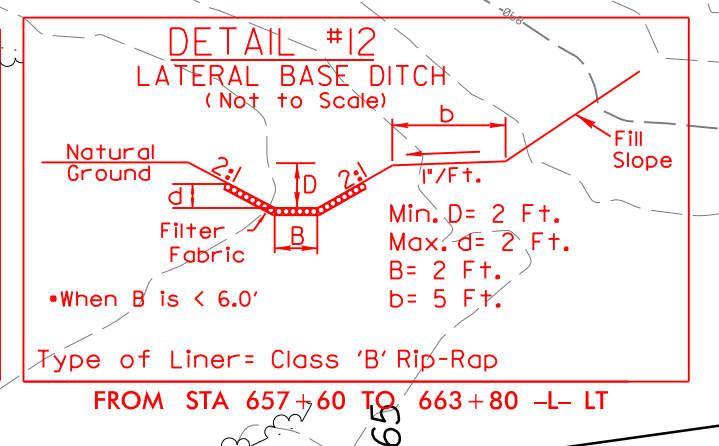
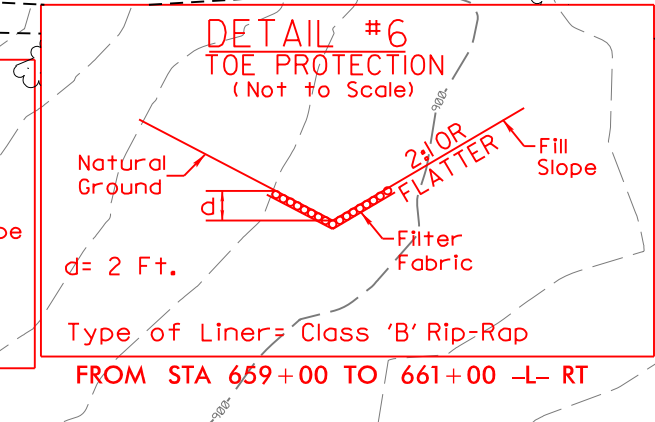
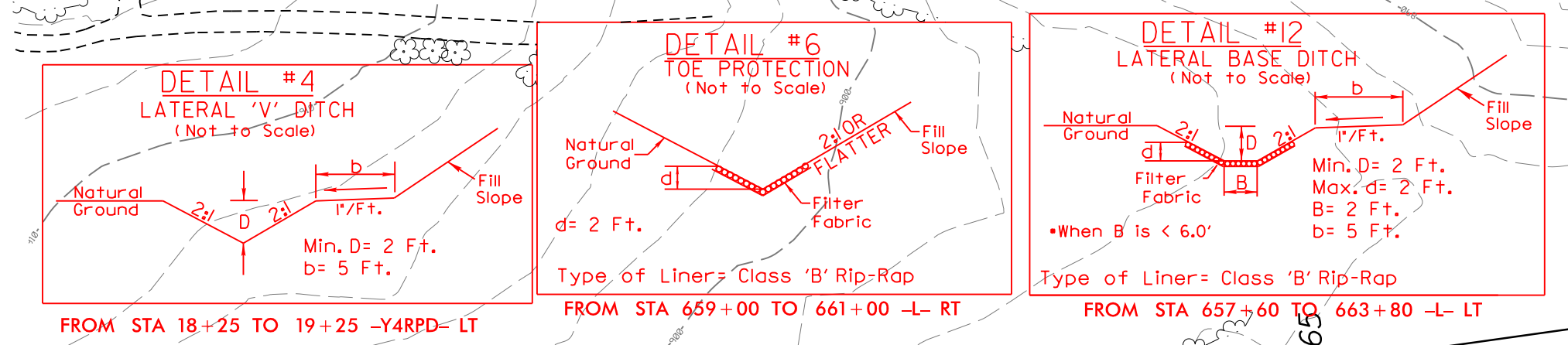

DENOTES FILL IN WETLAND

DENOTES IMPACTS IN SURFACE WATER

DENOTES MECHANIZED CLEARING

LATERAL 3' BASE DITCH  
W/CLASS '1' RIP RAP  
EST. 209 TONS  
W/544 SY FF  
SEE DETAIL #21

LATERAL 2' BASE DITCH  
W/CLASS 'B' RIP RAP  
EST. 417 TONS  
W/957 SY FF  
SEE DETAIL #12

CLASS 'B' RIP RAP  
EST 3 TONS  
EST 10 SY FF

CLASS 'B' RIP RAP  
EST 8 TONS  
EST 21 SY FF

MATCHLINE -L- STA. 656 + 51 SHEET 16

MATCHLINE -L- STA. 668 + 17 SHEET 18

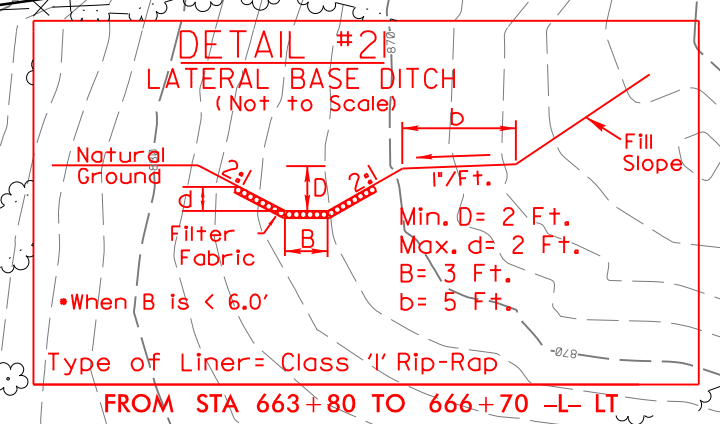
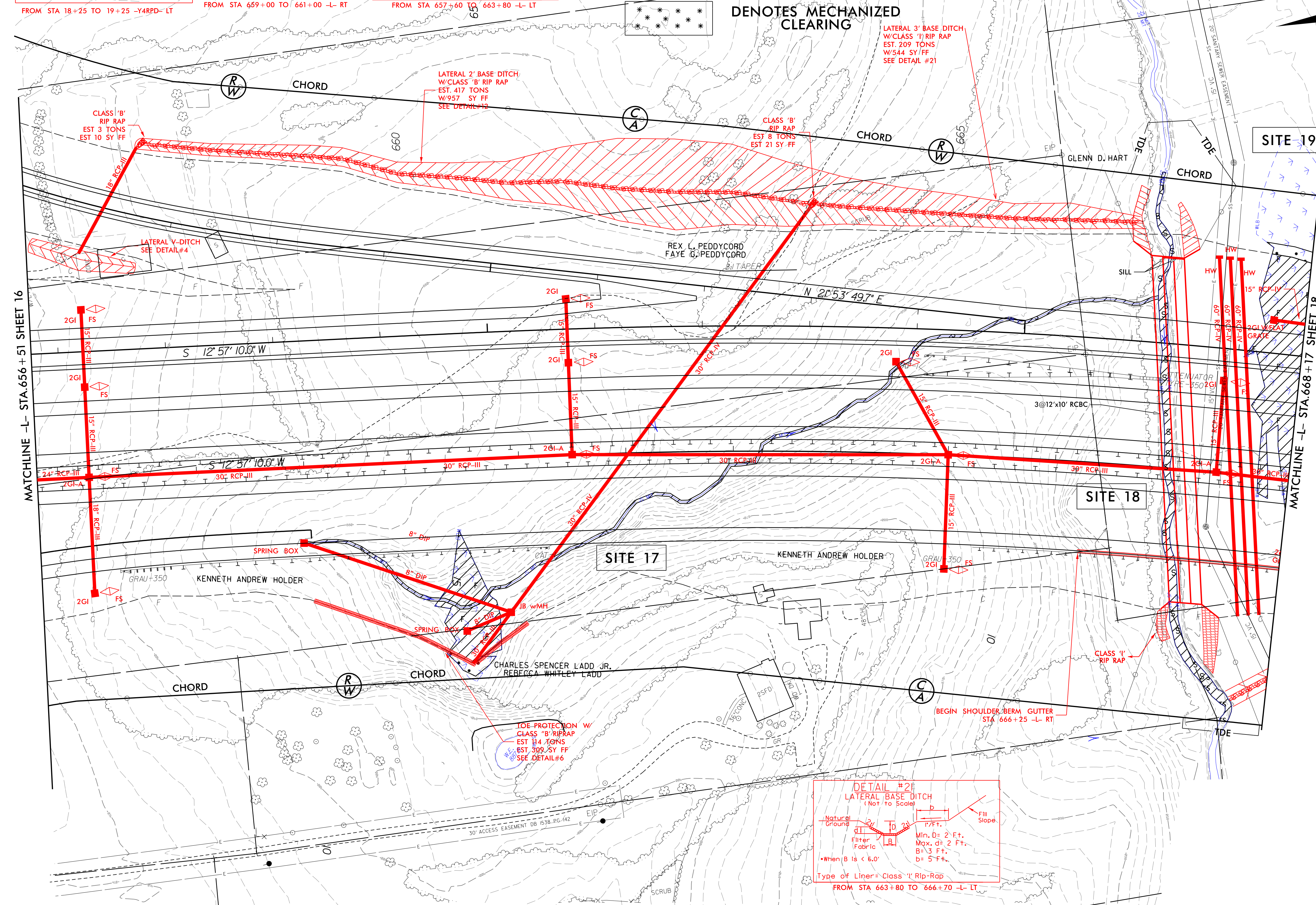

REVISIONS  
 7/2/2015  
 L:\Projects\2015\U-2579B\Hydraulics\PERMITS\Drawings\U-2579B\_Hyd.prm\_wet\_pah17\_con.dgn  
 8/17/99