

MATCH LINE -L- STA 333+50 SEE SHEET 28

MATCH LINE -L- STA 347+00 SEE SHEET 30

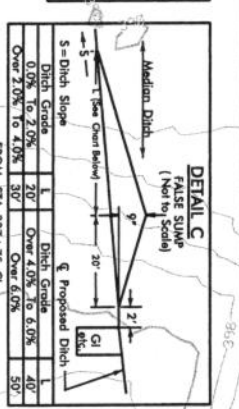
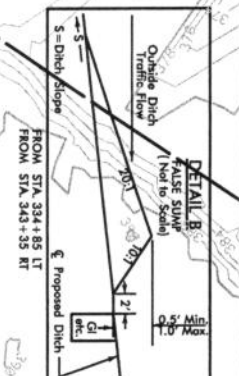
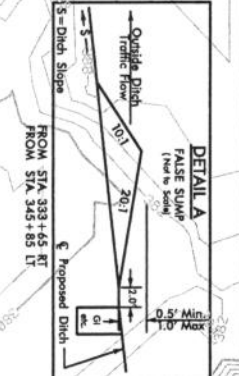
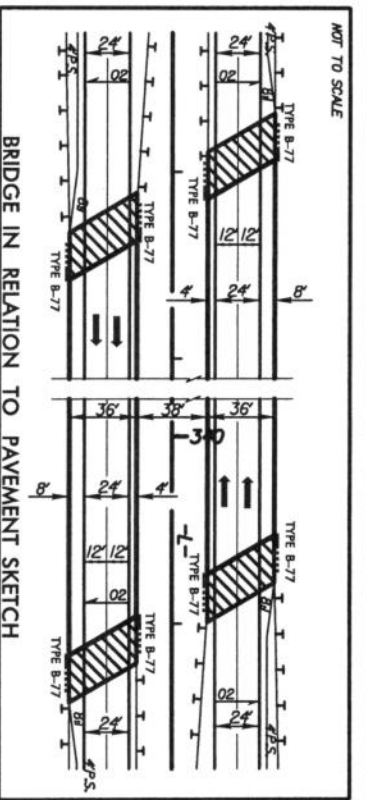

Ditch Grade	Ditch Slope	Ditch Grade
0.0%	5%	4.0%
0.5%	5%	5.0%
1.0%	5%	6.0%
1.5%	5%	7.0%
2.0%	5%	8.0%
2.5%	5%	9.0%

PROJECT REFERENCE NO.	R-0623	SHEET NO.	29
RD SHEET NO.		HYDRAULICS ENGINEER	
ROADWAY DESIGN ENGINEER		CONSTRUCTION	
PRELIMINARY PLANS DO NOT USE FOR CONSTRUCTION			

FOR PROFILE OF LINE -L- SEE SHEET 49

SEE SHEETS 2-H & 2-I FOR DRAINAGE DITCH DETAILS

PERMIT DRAWING
SHEET 29 OF 91

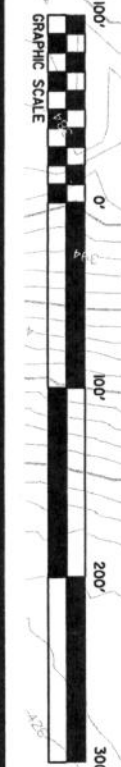
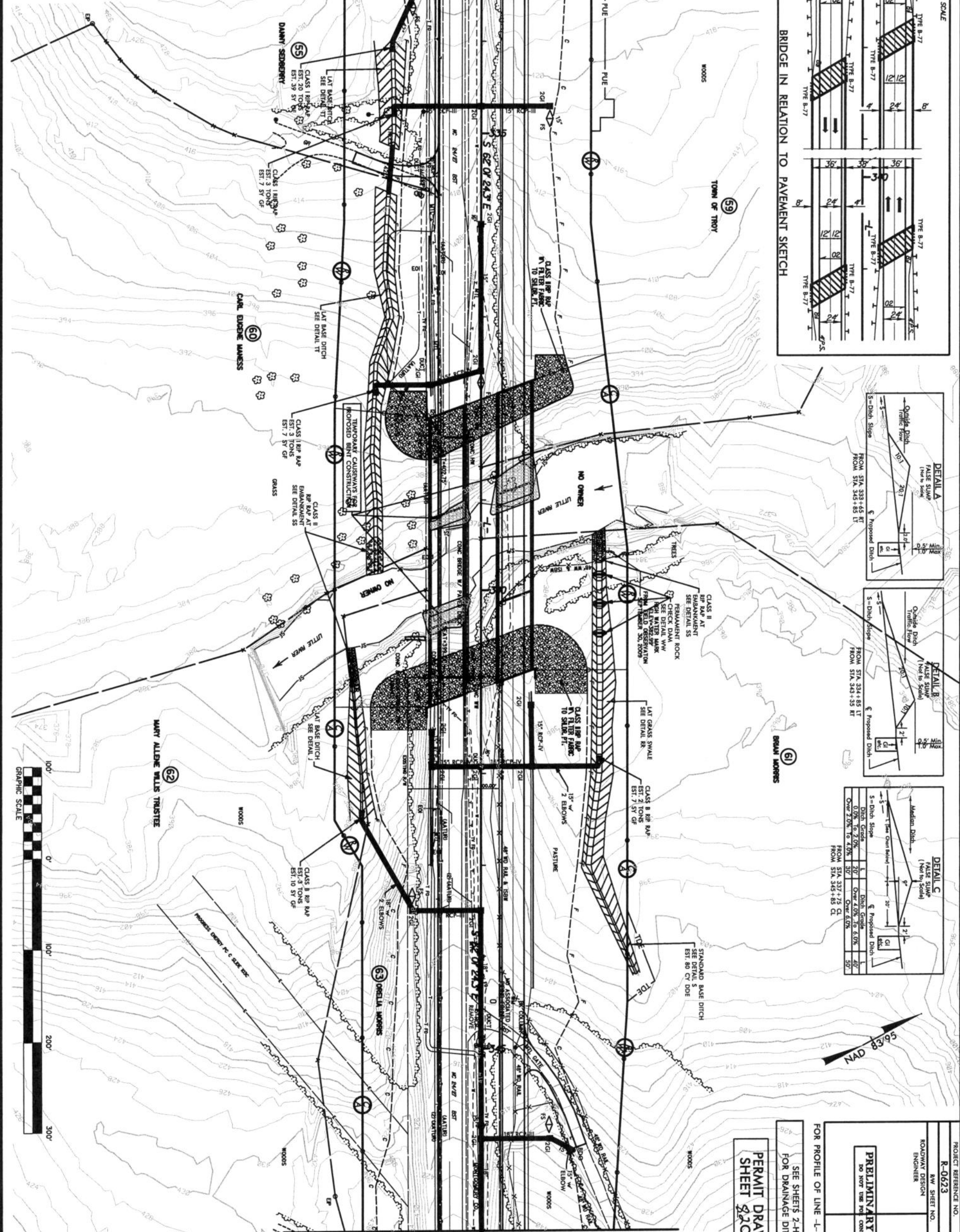

MATCH LINE -L- STA 347+00 SEE SHEET 29

MATCH LINE -L- STA 360+00 SEE SHEET 31

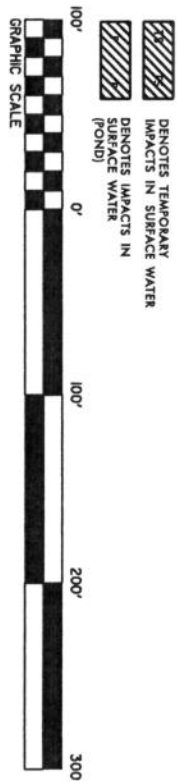
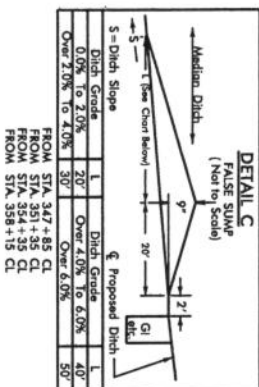
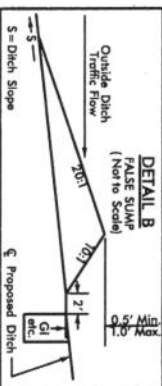
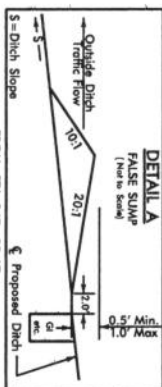
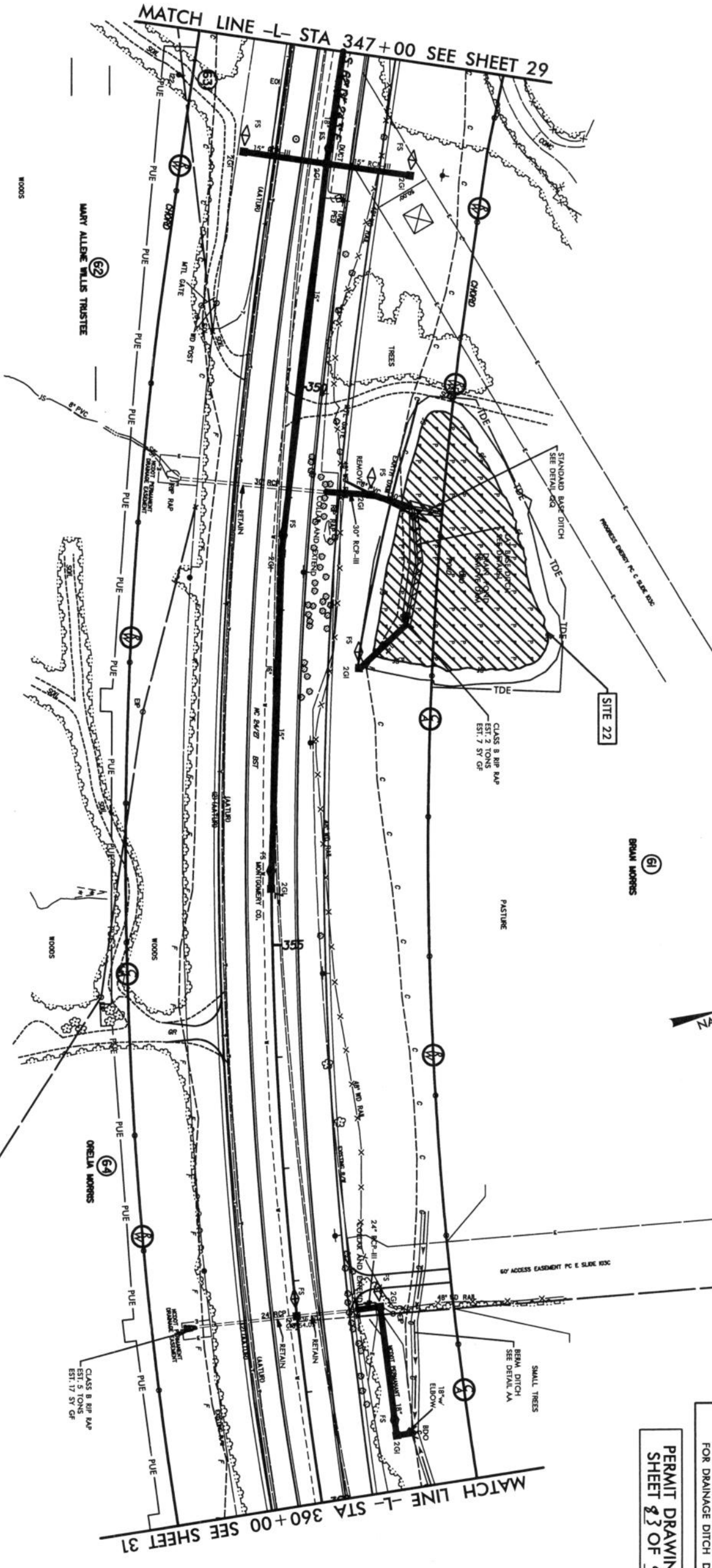

PERMIT DRAWING
SHEET 23 OF 91

PROJECT REFERENCE NO. R-0623	SHEET NO. 30
ROADWAY DESIGN ENGINEER	HYDRAULICS ENGINEER
PRELIMINARY PLANS DO NOT USE FOR CONSTRUCTION	
FOR PROFILE OF LINE -L- SEE SHEETS 49 AND 50	
SEE SHEETS 2-H & 2-I FOR DRAINAGE DITCH DETAILS	

MATCH LINE -L- STA 347+00 SEE SHEET 29

MATCH LINE -L- STA 360+00 SEE SHEET 31

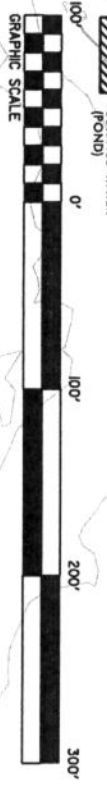
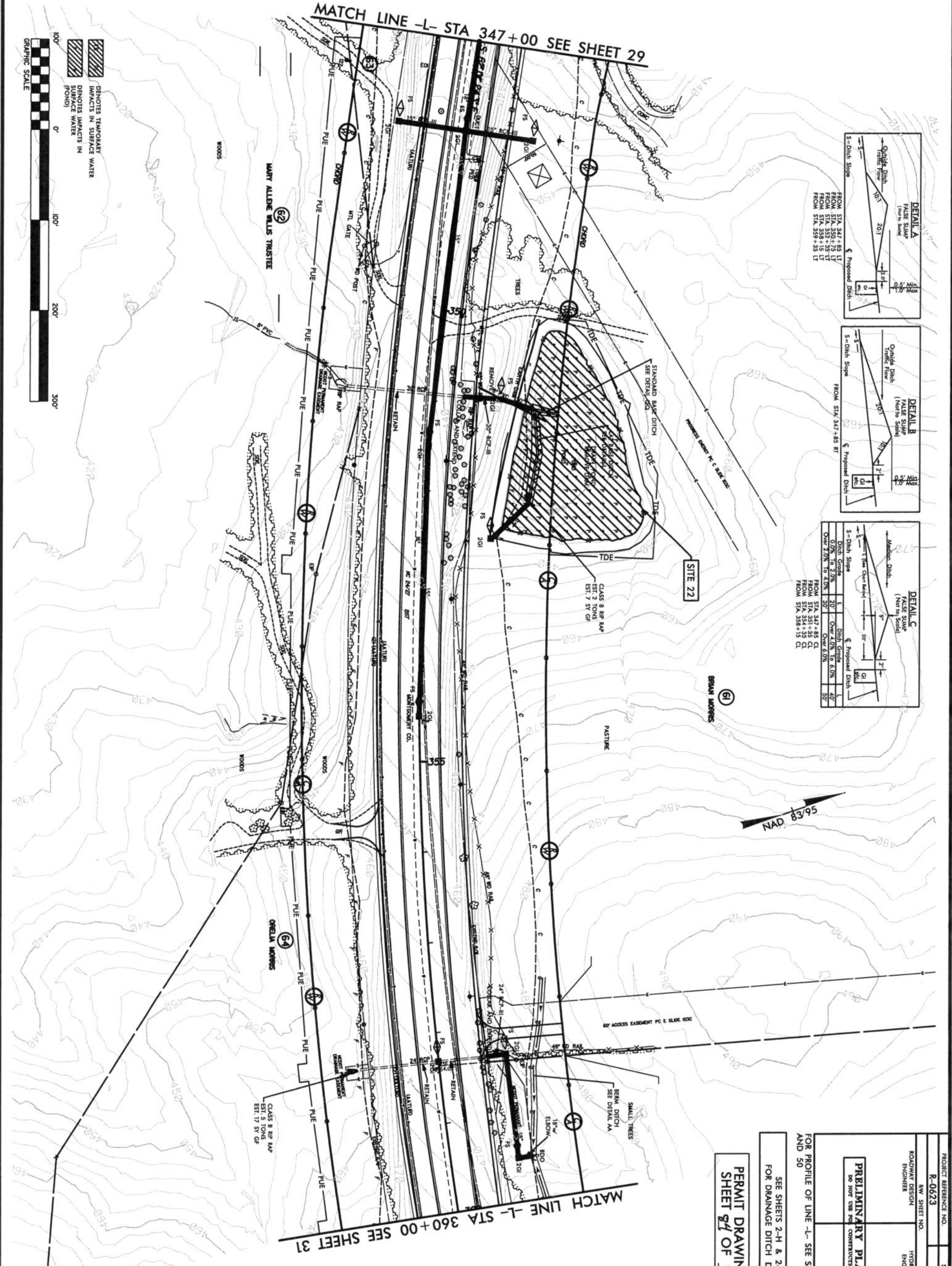
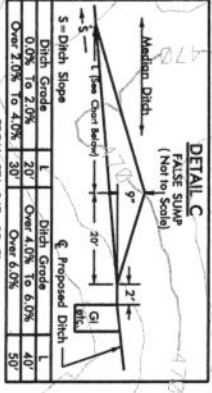
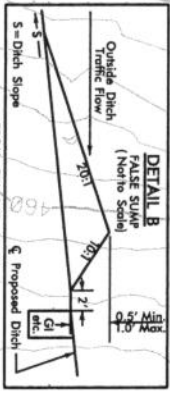
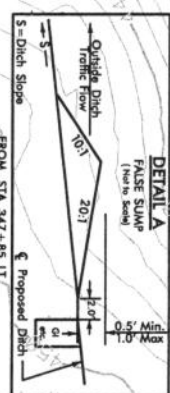

DENOTES TEMPORARY IMPACTS IN SURFACE WATER
 DENOTES IMPACTS IN SURFACE WATER (FOUND)

PROJECT REFERENCE NO. R-0623	SHEET NO. 30
ROADWAY DESIGN ENGINEER	HYDRAULICS ENGINEER
PRELIMINARY PLANS DO NOT USE FOR CONSTRUCTION	
FOR PROFILE OF LINE -L- SEE SHEETS 49 AND 50	
SEE SHEETS 2-H & 2-I FOR DRAINAGE DITCH DETAILS	
PERMIT DRAWING SHEET 30 OF 97	

MATCH LINE -L- STA 360+00 SEE SHEET 30

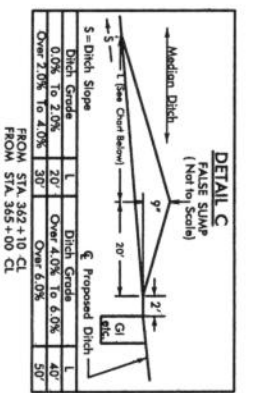
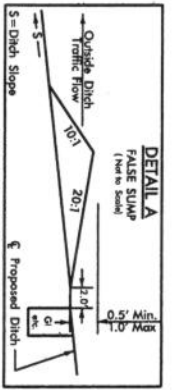

NAD 83/95

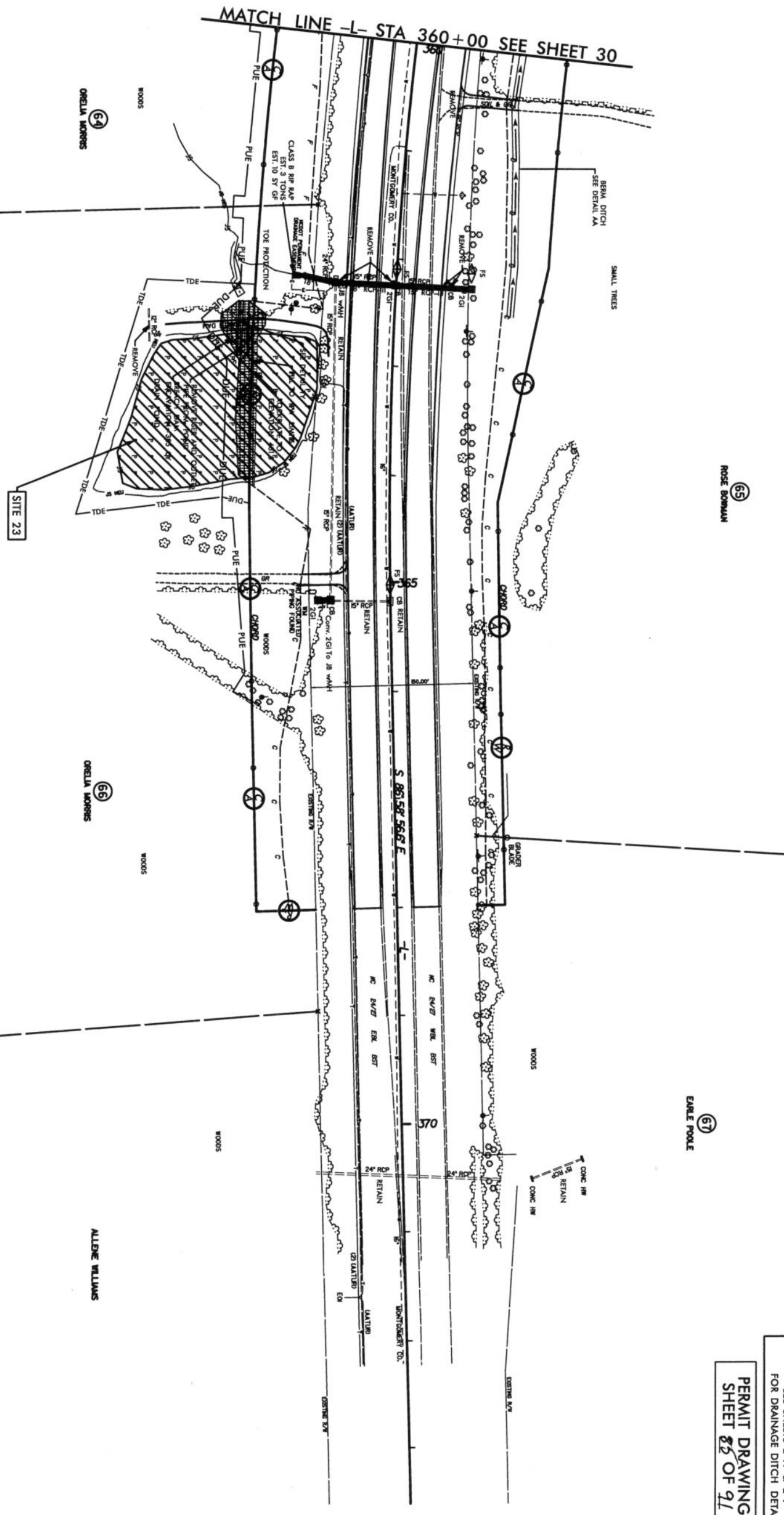

PERMIT DRAWING
SHEET 85 OF 91

PROJECT REFERENCE NO. R-0623	SHEET NO. 31
ROADWAY DESIGN ENGINEER	HYDRAULICS ENGINEER
PRELIMINARY PLANS DO NOT USE FOR CONSTRUCTION	
FOR PROFILE OF LINE -L- SEE SHEET 50	
SEE SHEETS 2-H & 2-I FOR DRAINAGE DITCH DETAILS	

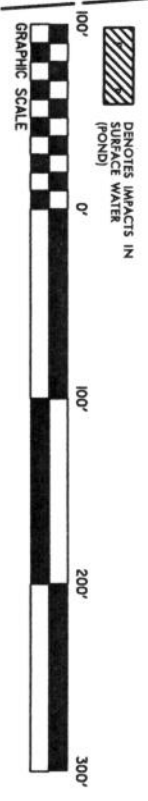

MATCH LINE -L- STA 360+00 SEE SHEET 30

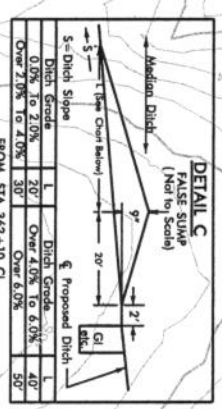
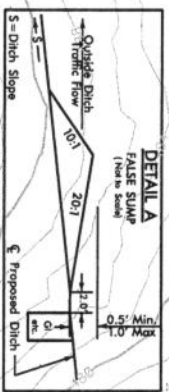
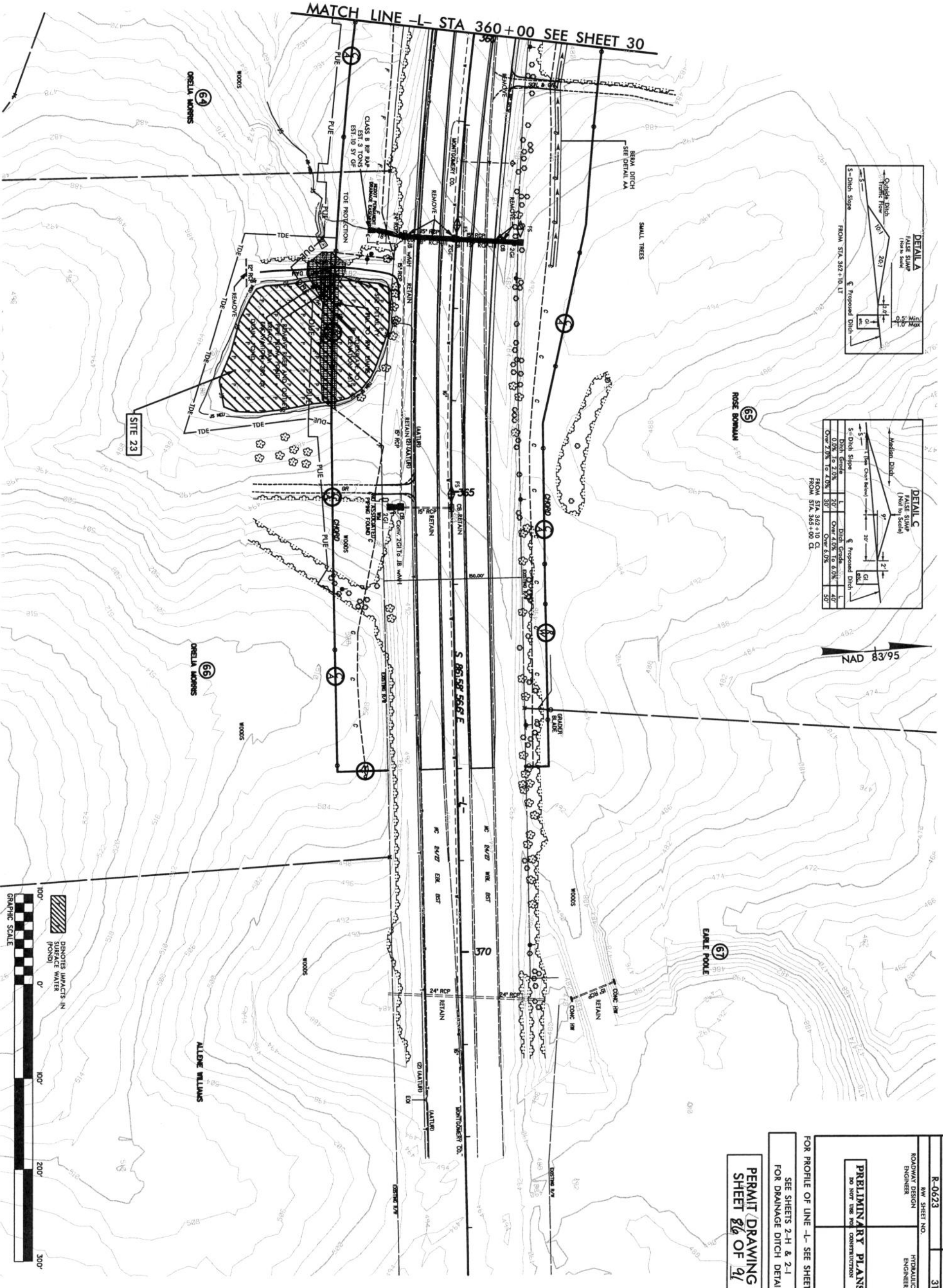

NAD 83/95

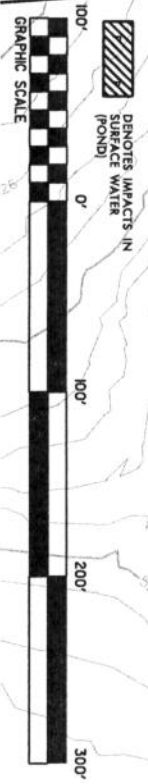

DENOTES IMPACTS IN SURFACE WATER (POND)

PROJECT REFERENCE NO.	R-0623	SHEET NO.	31
ROADWAY DESIGN ENGINEER		HYDRAULICS ENGINEER	
PRELIMINARY PLANS DO NOT USE FOR CONSTRUCTION			
FOR PROFILE OF LINE -L- SEE SHEET 50 SEE SHEETS 2-H & 2-I FOR DRAINAGE DITCH DETAILS			
PERMIT DRAWING SHEET 86 OF 91			

MATCH LINE -Y7- STA 14+50 SEE SHEET 33

NAD 83/95

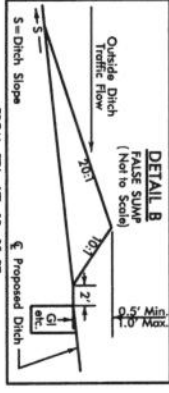
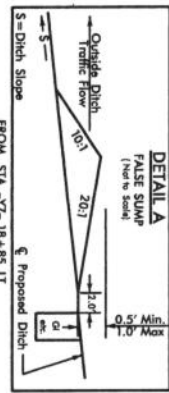
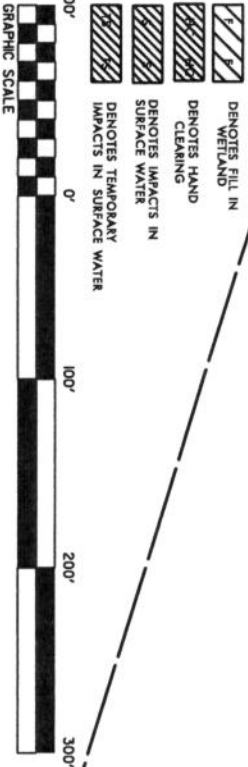
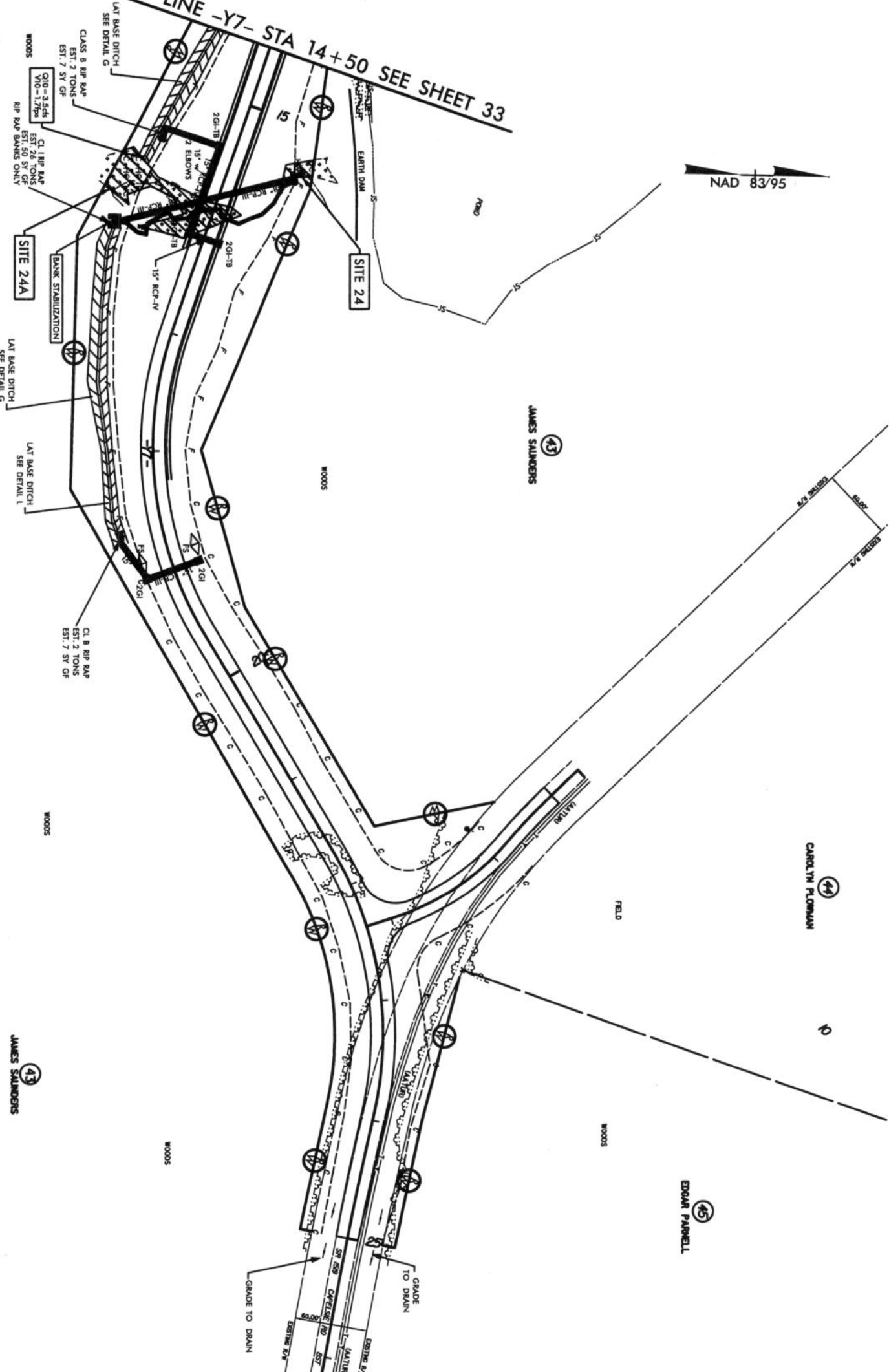

PROJECT REFERENCE NO.	R-0623	SHEET NO.	34
RAW SHEET NO.		HYDRAULICS ENGINEER	
ROADWAY DESIGN ENGINEER		HYDRAULICS ENGINEER	
PRELIMINARY PLANS			
DO NOT USE FOR CONSTRUCTION			
SEE SHEETS 2-H & 2-I FOR DRAINAGE DITCH DETAILS			
PERMIT DRAWING SHEET 27 OF 91			
FOR PROFILE OF LINE -Y7- SEE SHEET 52 FOR PROFILE OF LINE -Y7A- SEE SHEET 55			

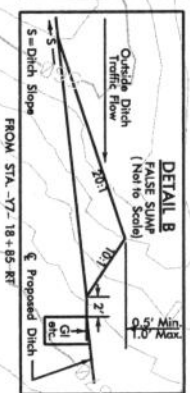
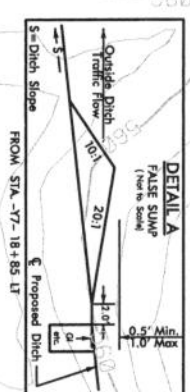
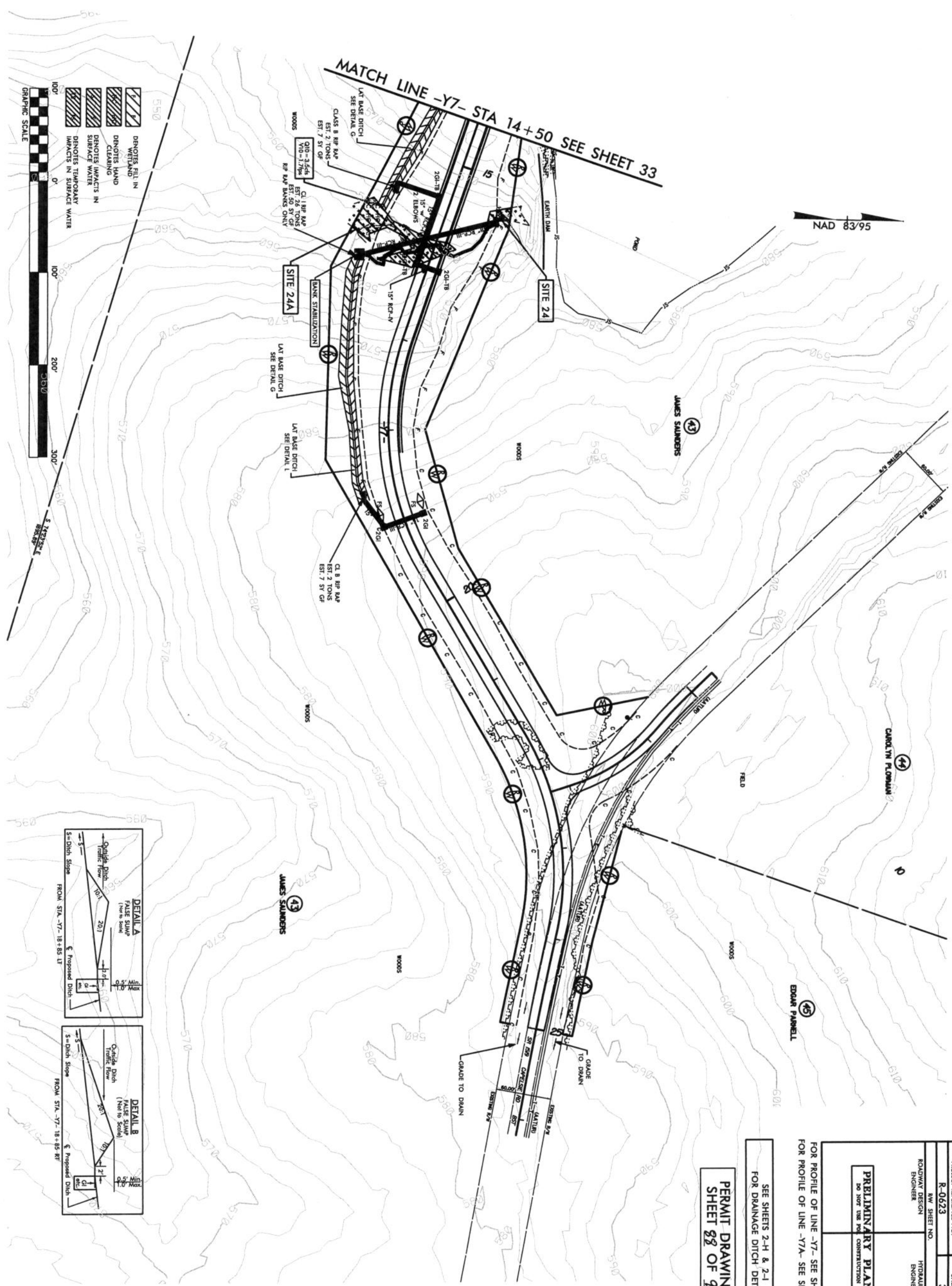

PERMIT DRAWING
SHEET 34 OF 91

SEE SHEETS 2-H & 2-I
FOR DRAINAGE DITCH DETAILS

PROJECT REFERENCE NO.	R-0623	SHEET NO.	34
ROADWAY DESIGN ENGINEER	HYDRAULICS ENGINEER		
PRELIMINARY PLANS DO NOT USE FOR CONSTRUCTION			

FOR PROFILE OF LINE -Y7- SEE SHEET 52
FOR PROFILE OF LINE -Y7A- SEE SHEET 55

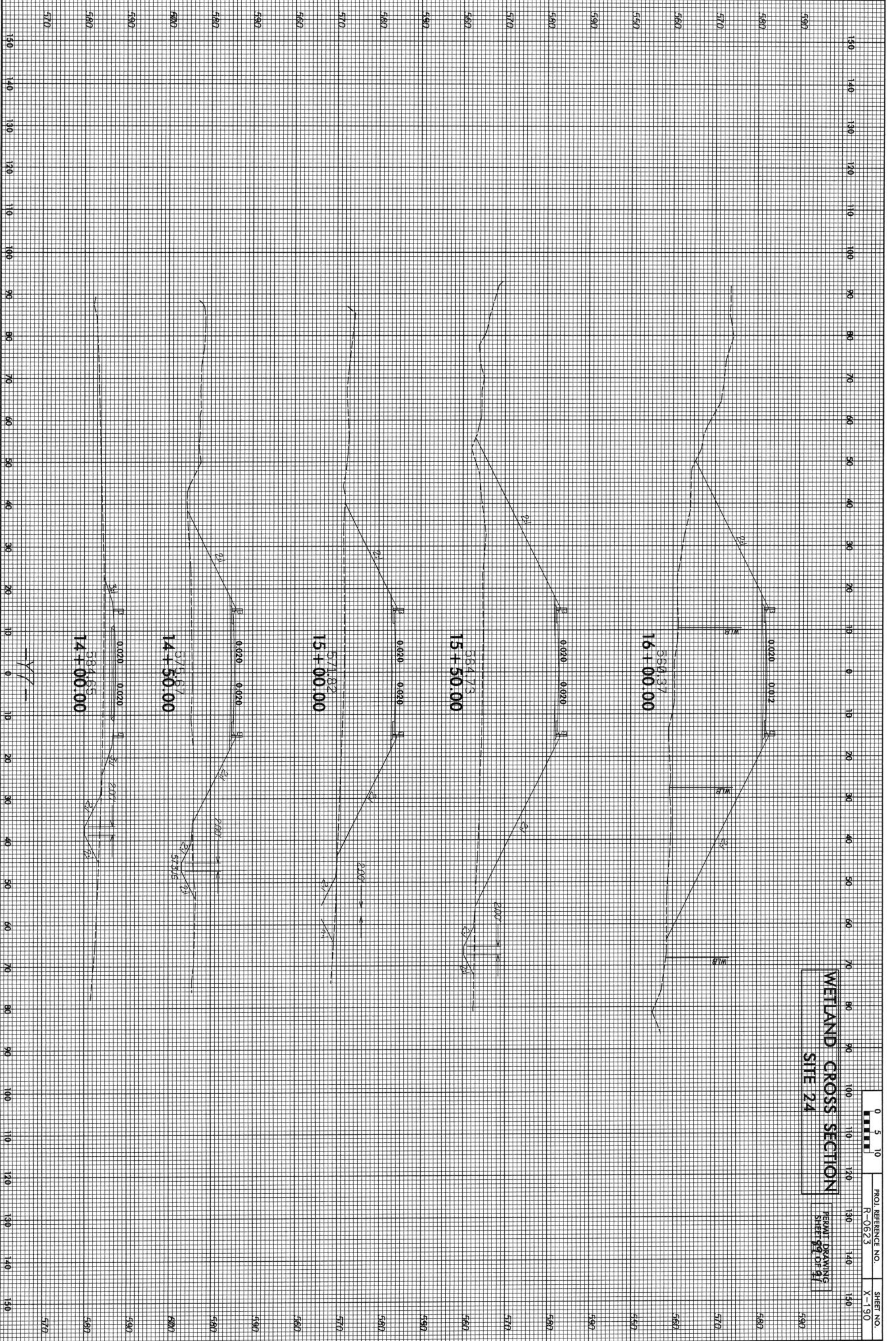

**WETLAND CROSS SECTION
SITE 24**

PERMIT DRAWING
SHEET 21 OF 27



PROJ. REFERENCE NO.	R-0623	SHEET NO.	X-190
---------------------	--------	-----------	-------

Site No.	Station (From/To)	Structure Size / Type	WETLAND IMPACTS					SURFACE WATER IMPACTS				
			Permanent Fill In Wetlands (ac)	Temp. Fill In Wetlands (ac)	Excavation in Wetlands (ac)	Mechanized Clearing in Wetlands (ac)	Hand Clearing in Wetlands (ac)	Permanent SW impacts (ac)	Temp. SW impacts (ac)	Existing Channel Impacts Permanent (ft)	Existing Channel Impacts Temp. (ft)	Natural Stream Design (ft)
1	L 26+14 to 28+48	Roadway Fill Bank Stabilization	0.13				0.02	0.01	<0.01	136	16	
2	L 30+39 to 30+81 Rt 15"				<0.01		<0.01	<0.01	<0.01	11		
3	L 53+20 to 55+42	2@8'x6' RCBC			0.01		0.01	0.03	<0.01	294	24	
4	L 70+83 to 73+70	60" RCP IV	0.02				0.06	0.01	<0.01	271	73	
5	L 75+30 to 84+50	2@10'x7' RCBC Bank Stabilization						0.05	<0.01	295	17	
5A		Roadway Fill	0.04						0.01	62		
5B		Roadway Fill	0.01					0.02		500		
5C		Pond	0.02		0.02			0.34				
6	L 120+95 to 121+90 Lt	Roadway Fill	0.08									
7	L 122+87 to 123+78	Bank Stabilization							<0.01	43		
7A	L 124+42 Lt	Bank Stabilization							<0.01	16		
7B	L 124+91 to 128+04	Roadway Fill	0.16					0.02	<0.01	355	72	
8	L 131+38 to 132+10 Lt	Roadway Fill	<0.01				<0.01		<0.01		10	
9	L 137+97 to 138+55	Roadway Fill	0.03									
10	L 150+48 to Y6 11+00 Rt	Roadway Fill	0.14		<0.01		0.13					
11	L 187+35 to 188+66	96" RCP IV Bank Stabilization						0.03	0.01	322	83	
11A	L 187+80 to 187+98	Roadway Fill						0.01	<0.01	15		
12	L 203+49 to 206+55	2@12'x8' RCBC						0.10	0.02	91	41	
13	L 228+85 to 229+98	Roadway Fill	0.05				0.04		0.01	499	38	
14	L 241+68 to 242+88	54" RCP IV Bank Stabilization						0.02	0.01	229	60	
15	L 250+61 to 251+71	66" RCP-IV Bank Stabilization						<0.01	<0.01	12		
TOTALS:			0.68		0.03		0.26	0.68	<0.01	3573	499	

Rounded totals are based on sum of actual impacts.

Stream Bank Stabilization Sites 1-15 = 172 feet

NC DEPARTMENT OF TRANSPORTATION
DIVISION OF HIGHWAYS

MONTGOMERY COUNTY
WBS - 34352.1.1 (R-0623)

Site No.	Station (From/To)	Structure Size / Type	WETLAND IMPACTS				SURFACE WATER IMPACTS								
			Permanent Fill In Wetlands (ac)	Temp. Fill In Wetlands (ac)	Excavation in Wetlands (ac)	Mechanized Clearing in Wetlands (ac)	Hand Clearing in Wetlands (ac)	Permanent SW impacts (ac)	Temp. SW impacts (ac)	Existing Channel Impacts (ft)	Existing Channel Temp. Impacts (ft)	Natural Stream Design (ft)			
16	L 262+36 to 264+32	30" RCP-III	0.14												
17	L 264+70 to 265+86	54" RCP-III	0.10		0.01		0.03	0.01	<0.01	280	57				
		Bank Stabilization							<0.01	21					
18	L269+62 to 272+04	42" RCP-III	0.11		<0.01		0.02	0.01	<0.01	297	44				
		Bank Stabilization							<0.01	22					
19	L 282+75 to 283+36	Roadway Fill	0.04												
19A	L 282+68 to 283+49	Roadway Fill	0.01				0.02								
19B	L 283+33 to 283+47	2@11'x7' RCBC							<0.01	340	17				
19C	L 283+47 to 284+20	2@11'x7' RCBC						0.05		<0.01	9				
20	L 316+99 to 317+88	Bank Stabilization							<0.01	75					
		Roadway Fill	0.05						0.01	75					
21	L 338+46 to 340+55	Bank Stabilization							0.01	75					
22	L 350+09 to 352+49 Lt	Causeways							0.08		112				
		Pond							0.55						
23	L 362+75 to 364+14 Rt	Pond						0.48							
24	Y7 15+26 to 15+49 Lt	Roadway Fill	<0.01				<0.01			<0.01					
24A	Y7 15+63 to 16+31	48" RCP	0.04				0.02	0.01	<0.01	240	18				
		Bank Stabilization							<0.01	10					
SHEET TOTALS (SITES 16-24A):			0.49		0.02		0.11	1.12	0.09	1294	248				
SHEET TOTALS (SITES 1-15):			0.68		0.03		0.26	0.68	0.07	3573	499				
TOTALS:			1.17		0.05		0.38	1.80	0.17	4867	747				

Rounded totals are based upon sum of actual impacts.

Stream Bank Stabilization Sites 16-24A = 137 feet

An additional 0.03 acres of temporary wetland impacts in Hand Clearing areas is due to placement of Erosion Control measures.

NC DEPARTMENT OF TRANSPORTATION
DIVISION OF HIGHWAYS

MONTGOMERY COUNTY
WBS - 34352.1.1 (R-0623)