

PROJECT REFERENCE NO. R-2413A		SHEET NO. 73	
RDW SHEET NO.		HYDRAULICS ENGINEER	
ROADWAY DESIGN ENGINEER		HYDRAULICS ENGINEER	
PRELIMINARY PLANS DO NOT USE FOR CONSTRUCTION			

NAD 83/NRS 2007

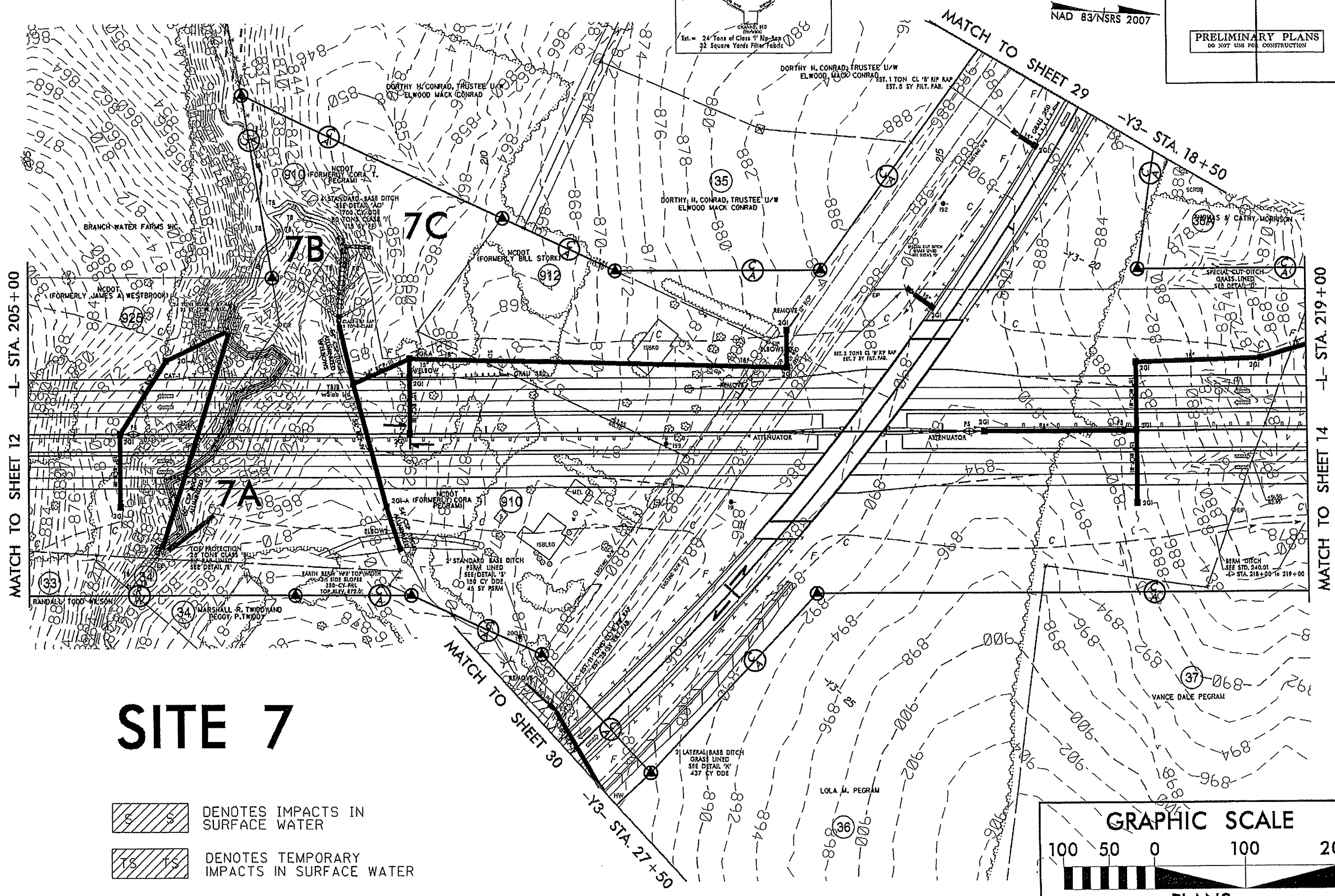
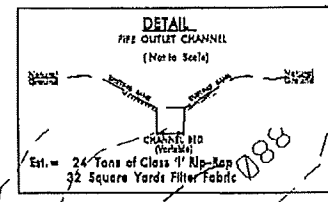

MATCH TO SHEET 12 -L- STA. 205+00

MATCH TO SHEET 14 -L- STA. 219+00

SITE 7

- DENOTES IMPACTS IN SURFACE WATER
- DENOTES TEMPORARY IMPACTS IN SURFACE WATER

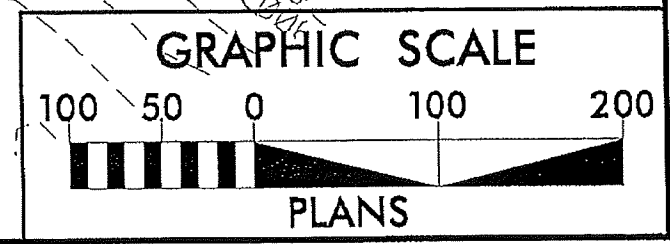

REVISIONS
 R/W REVISION: A PROPERTY LINE HAS BEEN ADDED TO PARCEL 36 WHICH RESULTED IN A NEW PARCEL DESIGNATED AS PARCEL 36A. PARCEL 36A IS OWNED BY THOMAS AND CATHY MORRISON. CEH 1/23/2013
 R/W REVISION: PARCEL NUMBER 80 HAS BEEN DELETED. NO CLAIM ON BRANCH WATER FARMS, INC. CEH 2/27/13
 8/17/99

8/17/99

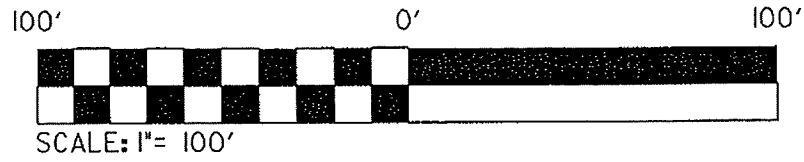

Permit Drawing
Sheet 23 of 81

NAD 83/NRS 2007

PROJECT REFERENCE NO. R-2413A		SHEET NO. 13	
RDW SHEET NO.		HYDRAULICS ENGINEER	
ROADWAY DESIGN ENGINEER		HYDRAULICS ENGINEER	
PRELIMINARY PLANS DO NOT USE FOR CONSTRUCTION			

BRANCH WATER FARMS INC.

7B 7C

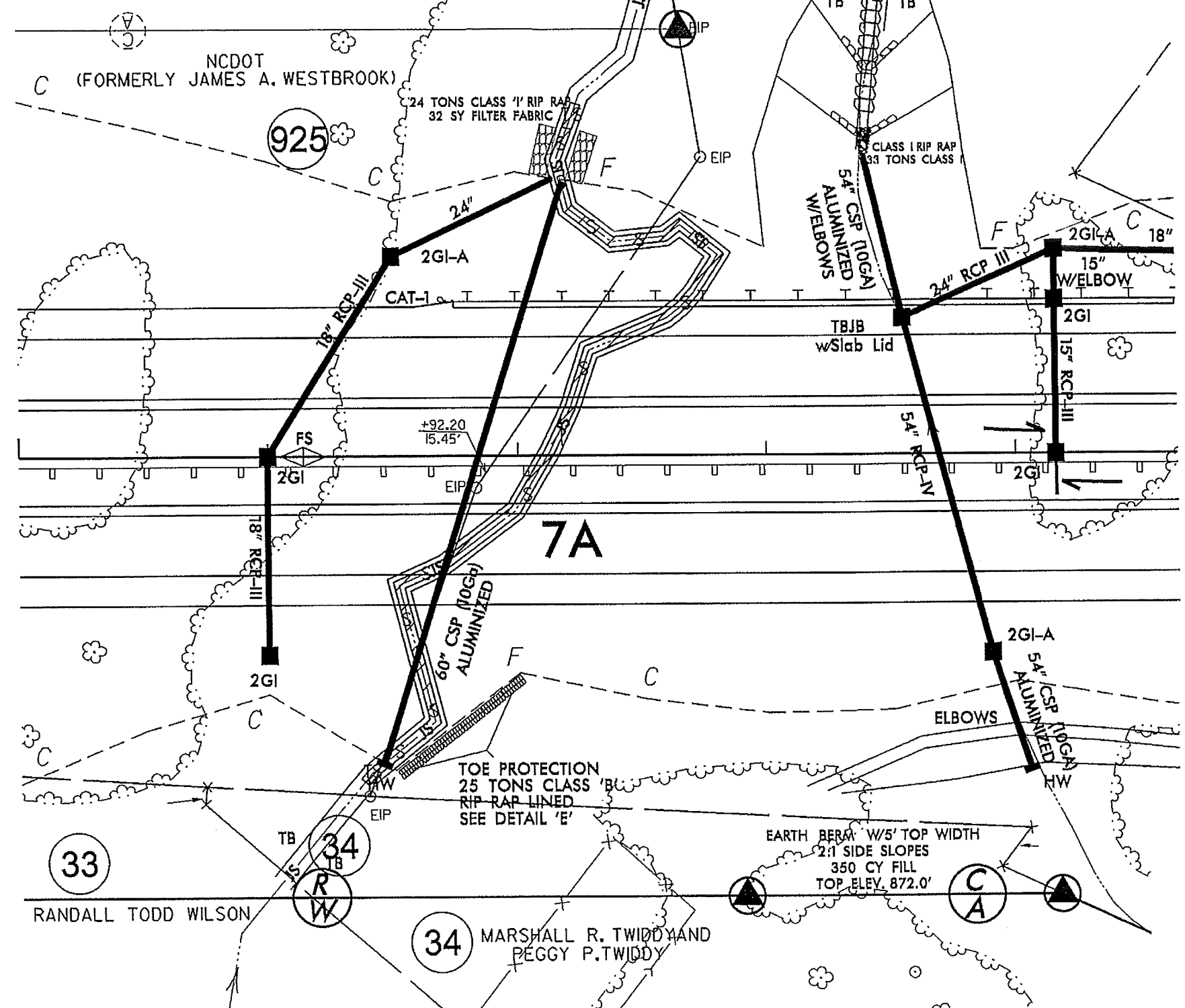

SITE 7

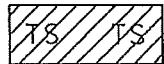
-  DENOTES IMPACTS IN SURFACE WATER
-  DENOTES TEMPORARY IMPACTS IN SURFACE WATER

REVISIONS

*****SYSTEM*****
*****DATE*****
*****BY*****

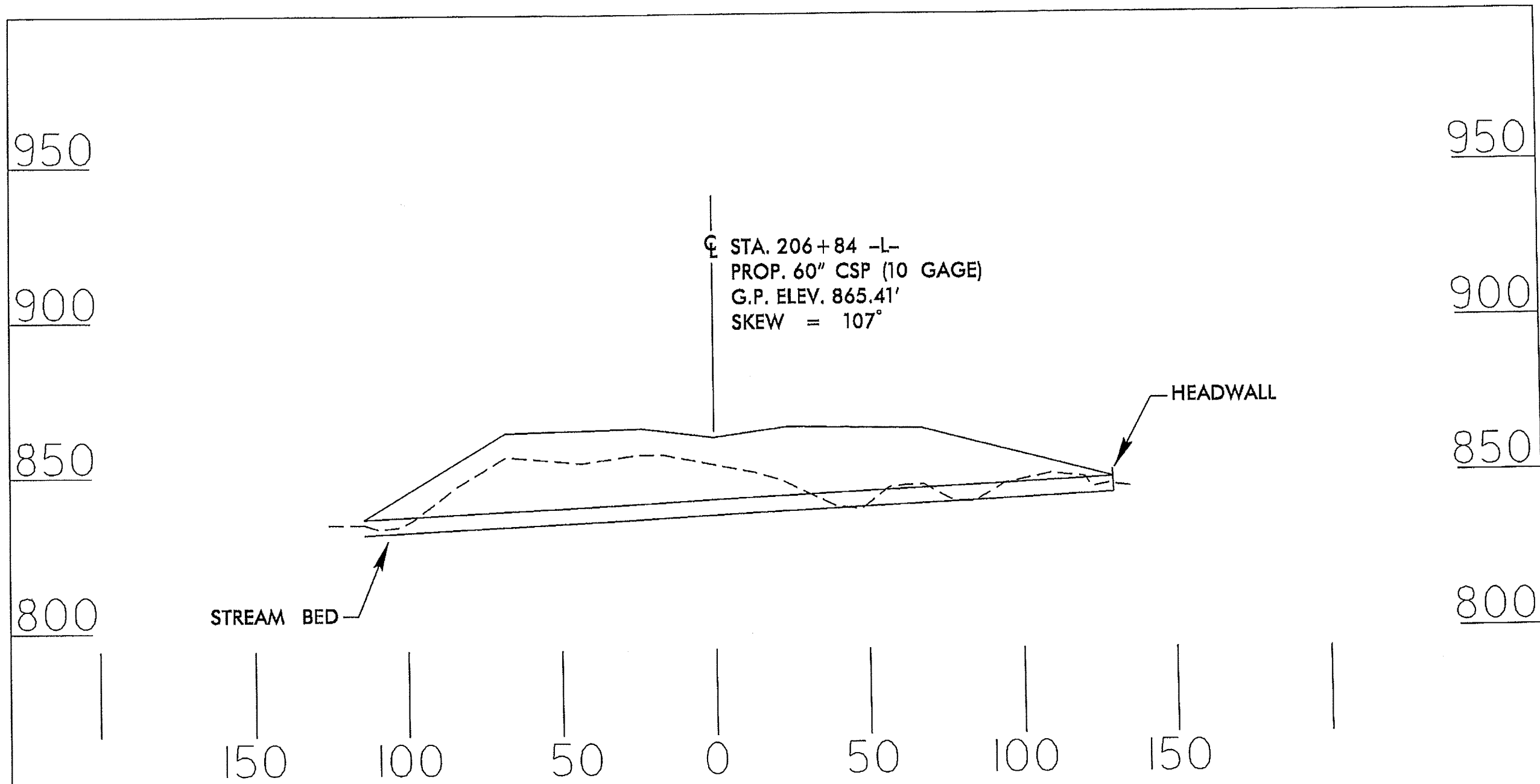

PROFILE

NCDOT
 DIVISION OF HIGHWAYS
 GUILFORD COUNTY
 PROJECT: 34429.1.1 (R-2413A)
 NC 68 CONNECTOR
 FROM FOUR LANES AT
 SR 2011 TO SR 2127

SHEET 24 OF 81

2/13/13

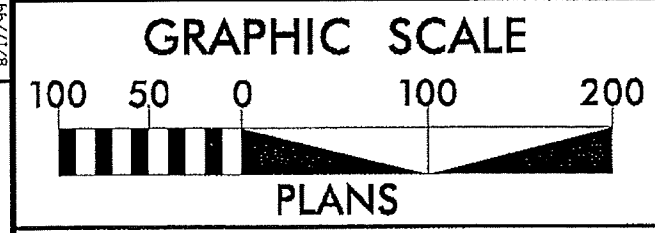



Permit Drawing
 Sheet 25 of 81
 NAD 83/NRS 2007

PROJECT REFERENCE NO. R-2413A	SHEET NO. 14
RDW SHEET NO.	
ROADWAY DESIGN ENGINEER	HYDRAULICS ENGINEER
PRELIMINARY PLANS DO NOT USE FOR CONSTRUCTION	

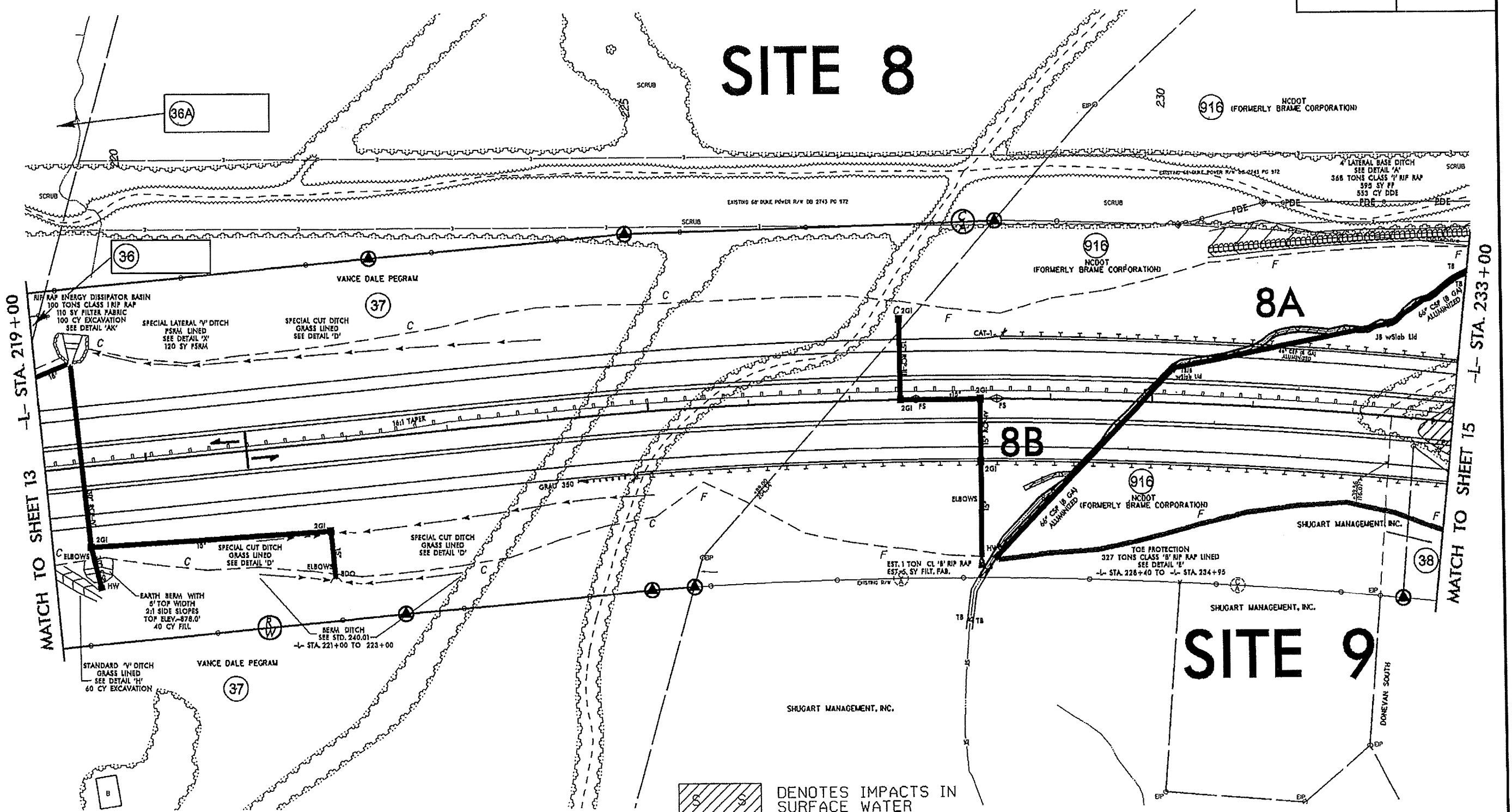
REVISIONS
 R/W REVISION: PARCEL 38 HAS BEEN SPLIT INTO THREE SEPARATE PARCELS. THE PROP. R/W LINE LOCATED RIGHT OF "L" BETWEEN STA. 232+65.88 AND STA. 235+30.83 HAS BEEN CHANGED TO AN EXIST. R/W LINE. CEH 11/21/2012
 R/W REVISION: A PROPERTY LINE HAS BEEN ADDED TO PARCEL 36 WHICH RESULTED IN NEW PARCEL DESIGNATED AS PARCEL 36A. PARCEL 36A IS OWNED BY THOMAS AND CATHY MORRISON. CEH 1/23/2013



-  DENOTES IMPACTS IN SURFACE WATER
-  DENOTES TEMPORARY IMPACTS IN SURFACE WATER
-  DENOTES IMPACTS IN SURFACE WATER (POND)

 SYSTEMS

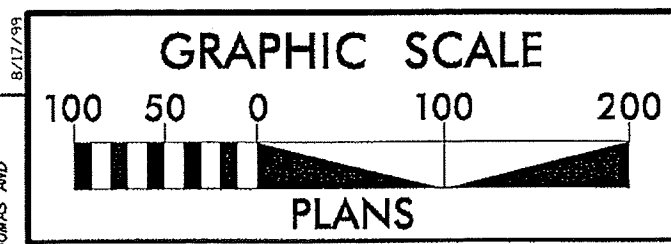

Permit Drawing
Sheet 26 of 81
NAD 83/NRS 2007

PROJECT REFERENCE NO. R-2413A	SHEET NO. 14
RW SHEET NO.	
ROADWAY DESIGN ENGINEER	HYDRAULICS ENGINEER
PRELIMINARY PLANS DO NOT USE FOR CONSTRUCTION	

REVISIONS
 R/W REVISION: PARCEL 38 HAS BEEN SPLIT INTO THREE SEPARATE PARCELS. THE PROP. R/W LINE LOCATED RIGHT OF "L" BETWEEN STA. 232+65.68 AND STA. 235+30.83 HAS BEEN CHANGED TO AN EXIST. R/W LINE. CEH 11/21/2012
 R/W REVISION: A PROPERTY LINE HAS BEEN ADDED TO PARCEL 36 WHICH RESULTED IN NEW PARCEL DESIGNATED AS PARCEL 36A. PARCEL 36A IS OWNED BY THOMAS AND CATHY MORRISON. CEH 1/23/2015

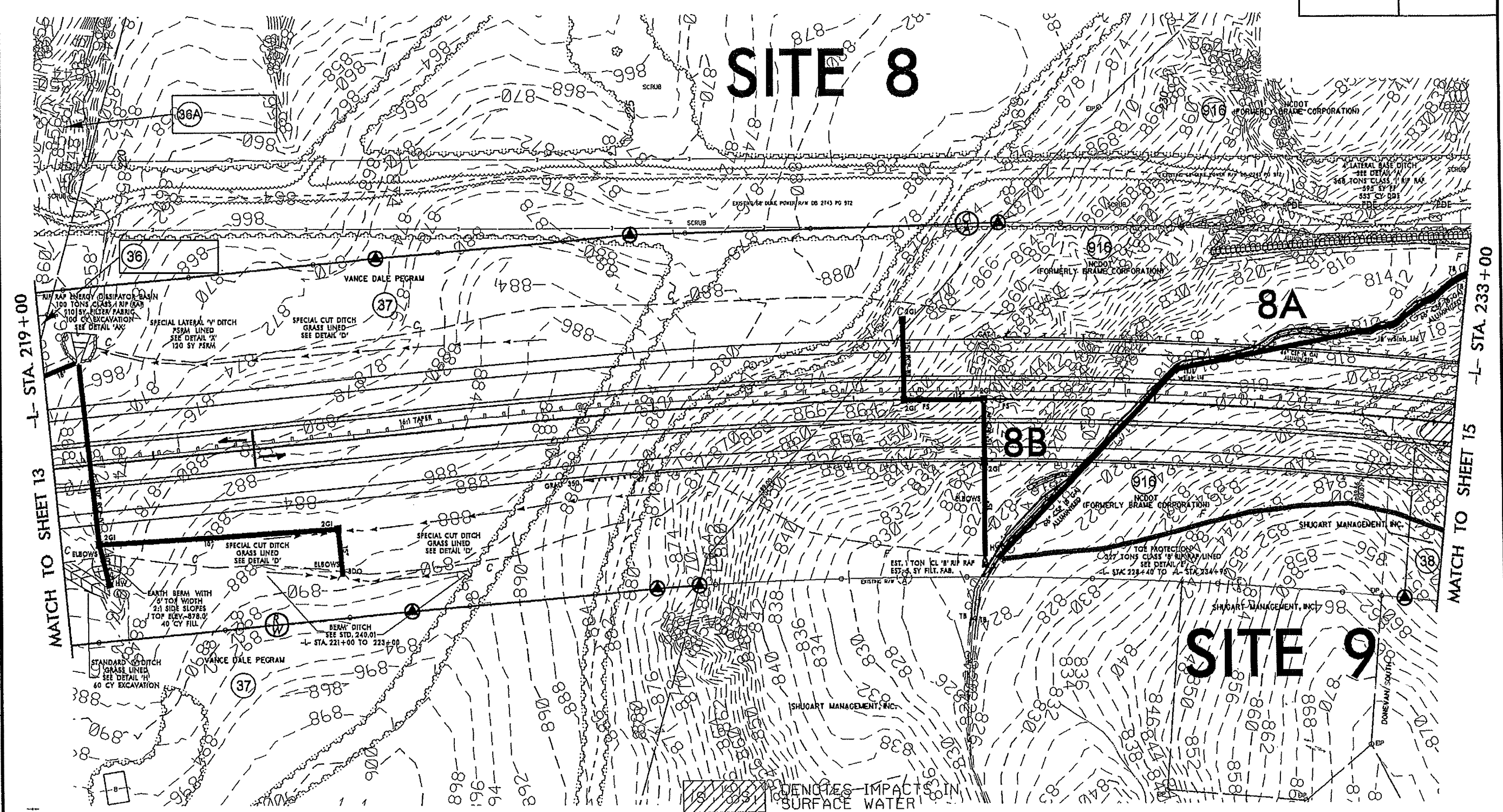

- DENOTES IMPACTS IN SURFACE WATER
- DENOTES TEMPORARY IMPACTS IN SURFACE WATER
- DENOTES IMPACTS IN SURFACE WATER (POND)

 SYSTEMS TIME *****

8/17/99

Permit Drawing
Sheet 27 of 81

PROJECT REFERENCE NO. R-2413A	SHEET NO. 14
MW SHEET NO.	
ROADWAY DESIGN ENGINEER	HYDRAULICS ENGINEER
PRELIMINARY PLANS DO NOT USE FOR CONSTRUCTION	

NAD 83/NSRS 2007

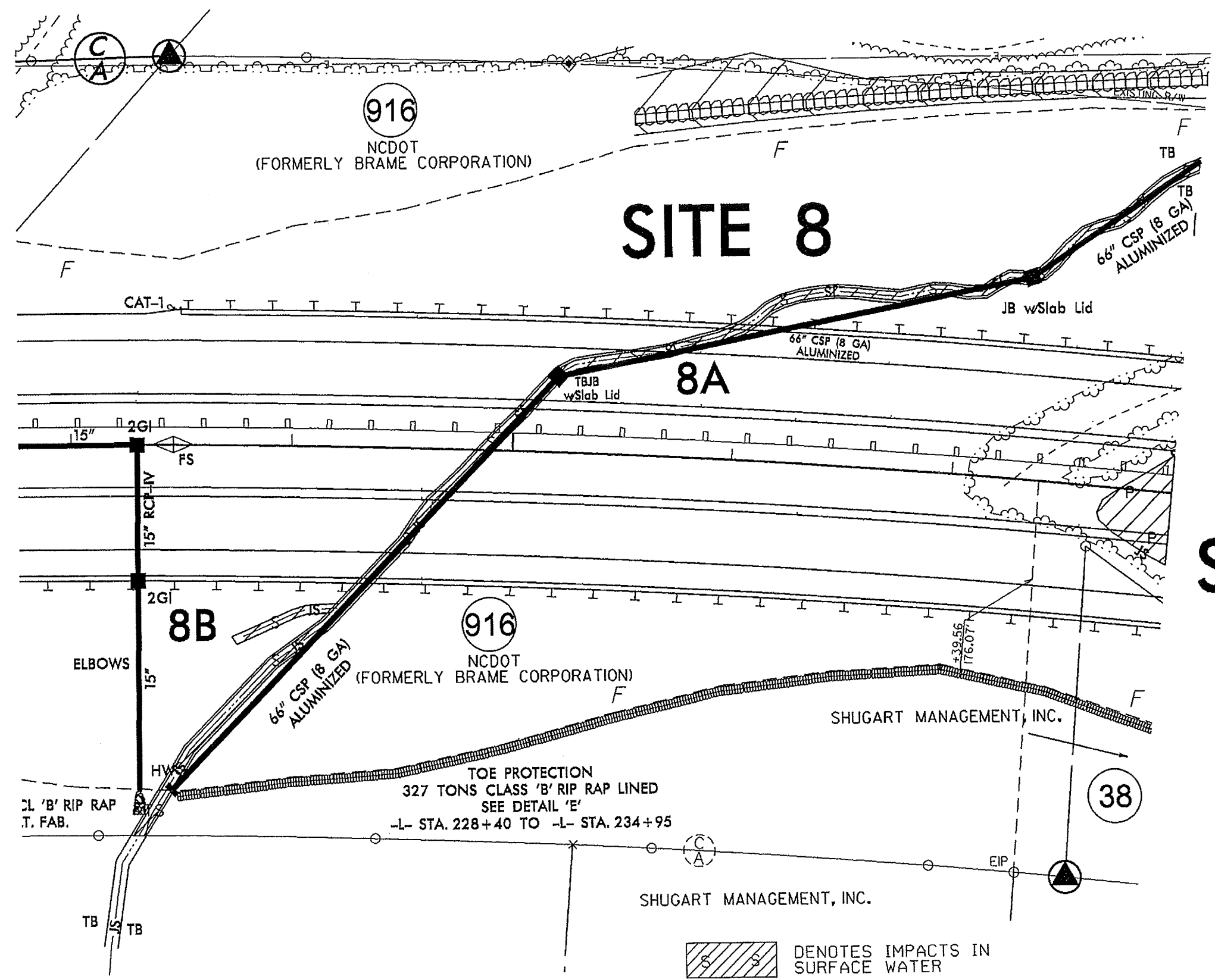

REVISIONS

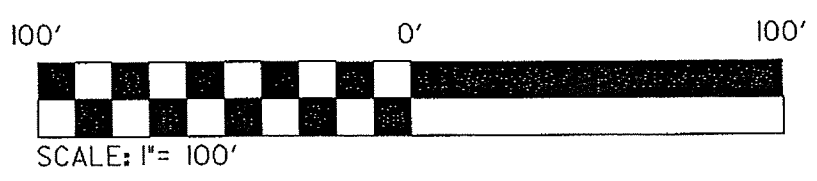

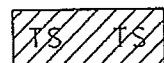
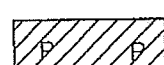
-  DENOTES IMPACTS IN SURFACE WATER
-  DENOTES TEMPORARY IMPACTS IN SURFACE WATER
-  DENOTES IMPACTS IN SURFACE WATER (POND)

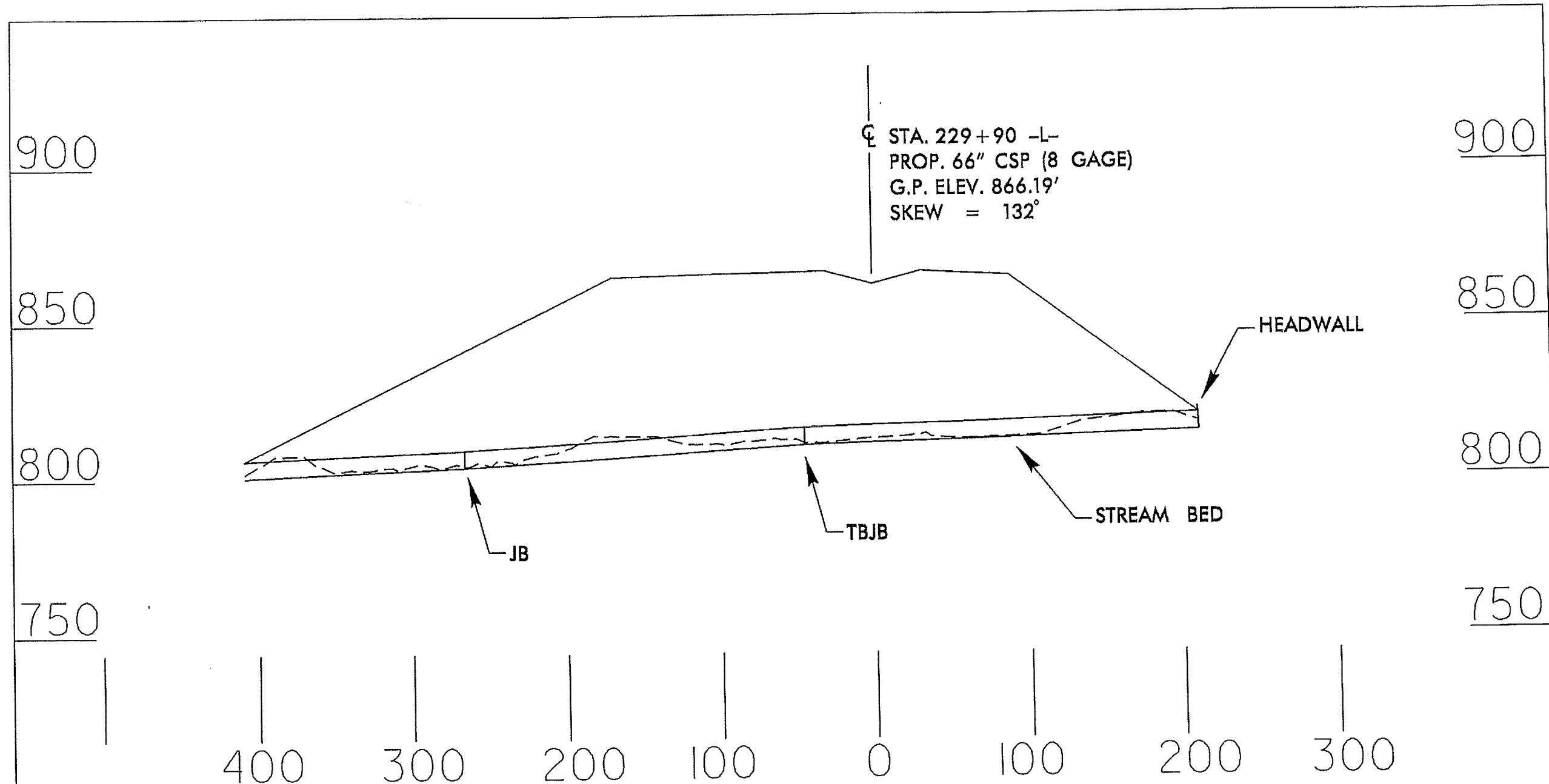

STA. 229+90 -L-
 PROP. 66" CSP (8 GAGE)
 G.P. ELEV. 866.19'
 SKEW = 132°

PROFILE

NCDOT
 DIVISION OF HIGHWAYS
 GUILFORD COUNTY
 PROJECT: 34429.1.1 (R-2413A)
 NC 68 CONNECTOR
 FROM FOUR LANES AT
 SR 2011 TO SR 2127
 SHEET 28 OF 81 2/13/13

SITE 8

Permit Drawing
Sheet 29 of 31

PROJECT REFERENCE NO. R-243A	SHEET NO. 15
R/W SHEET NO.	
ROADWAY DESIGN ENGINEER	HYDRAULICS ENGINEER
PRELIMINARY PLANS DO NOT USE FOR CONSTRUCTION	

NAD 83/NRS 2007

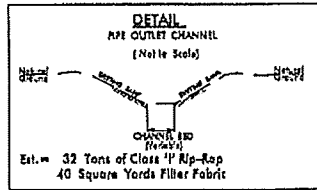

- DENOTES IMPACTS IN SURFACE WATER
- DENOTES IMPACTS IN SURFACE WATER (POND)
- DENOTES TEMPORARY IMPACTS IN SURFACE WATER

REVISIONS
 R/W REVISION, PARCEL 38 HAS BEEN SPLIT INTO THREE SEPARATE PARCELS, THE PROP. R/W LINE LOCATED RIGHT OF -L- BETWEEN STA. 232+65.68 AND STA. 235+30.83 HAS BEEN CHANGED TO AN EXIST. R/W LINE. CEH 11/21/2012

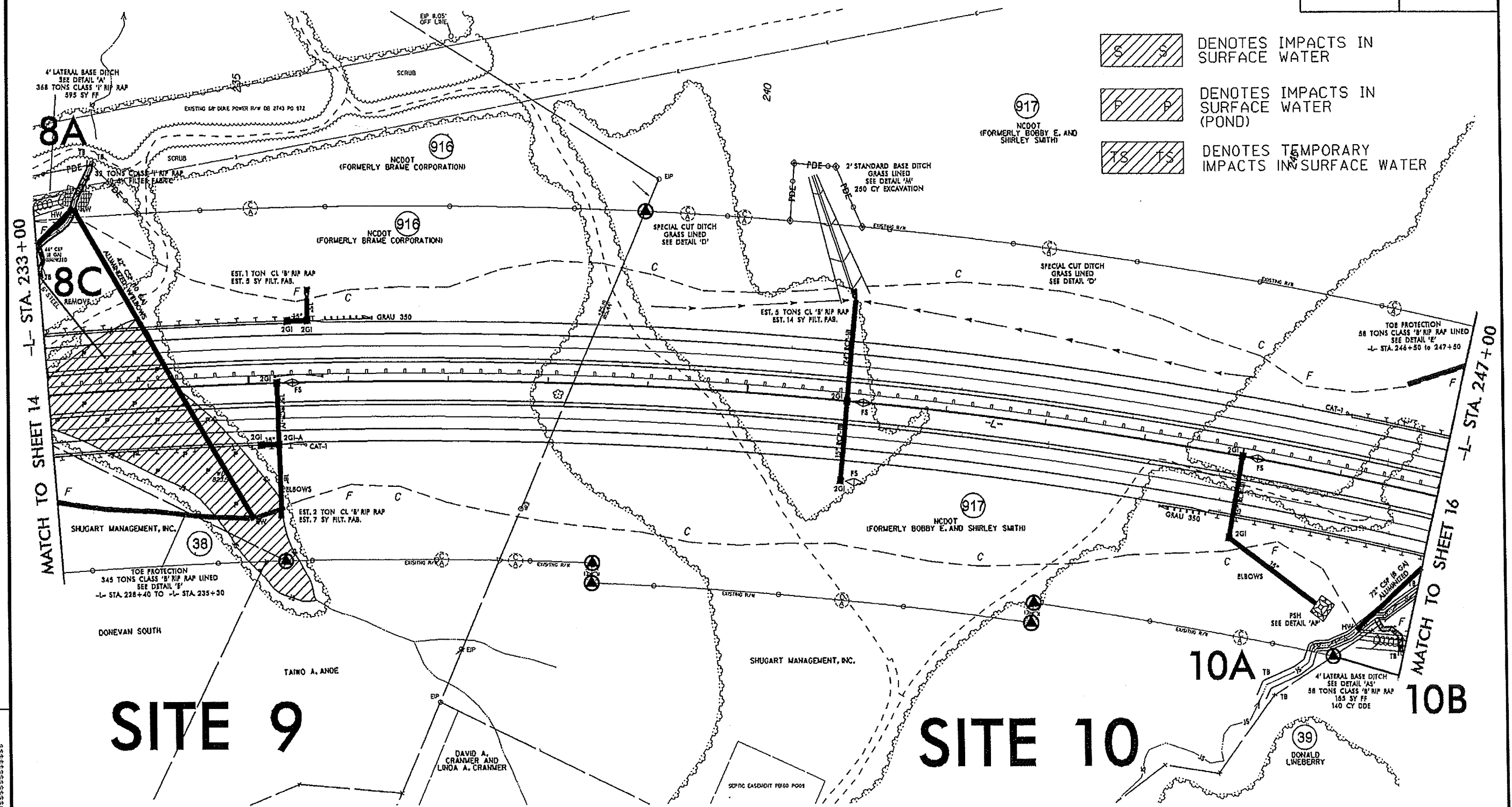

SITE 9

SITE 10

FOR -L- PROFILE, SEE SHEET NO. 41
FOR DITCH DETAILS, SEE SHEET NOS. 2-W & 2-X

SYSTEMS
 CONSTRUCTION

Permit Drawing
Sheet 30 of 81

NAD 83/NSRS 2007

PROJECT REFERENCE NO. R-2413A		SHEET NO. 15	
RAW SHEET NO.			
ROADWAY DESIGN ENGINEER	HYDRAULICS ENGINEER		
PRELIMINARY PLANS			
DO NOT USE FOR CONSTRUCTION			

SITE 8

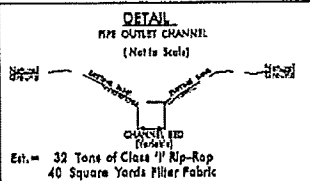

REVISIONS
 RAW REVISION: PARCEL 38 HAS BEEN SPLIT INTO THREE SEPARATE PARCELS. THE PROP. RAW LINE LOCATED RIGHT OF -L- BETWEEN STA. 232+165.68 AND STA. 235+308.3 HAS BEEN CHANGED TO AN EXIST. RAW LINE. CEH. 11/20/2012

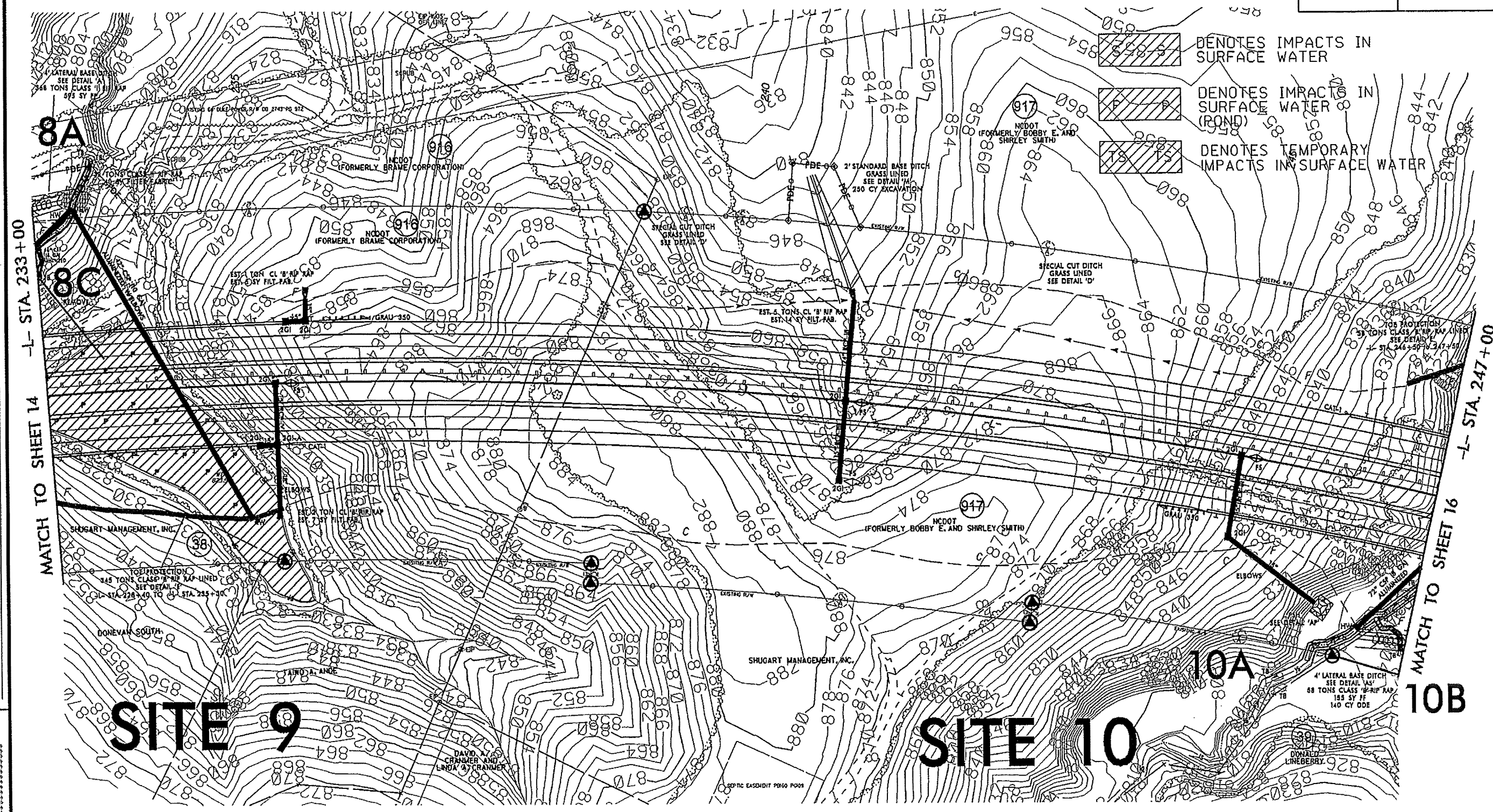

FOR -L- PROFILE, SEE SHEET NO. 41
FOR DITCH DETAILS, SEE SHEET NOS. 2-W & 2-X

PROJECT REFERENCE NO. R-2413A		SHEET NO. 15	
RAW SHEET NO.		HYDRAULICS ENGINEER	
ROADWAY DESIGN ENGINEER		HYDRAULICS ENGINEER	
PRELIMINARY PLANS DO NOT USE FOR CONSTRUCTION			

SITE 8

SITE 9

- DENOTES IMPACTS IN SURFACE WATER
- DENOTES IMPACTS IN SURFACE WATER (POND)
- DENOTES TEMPORARY IMPACTS IN SURFACE WATER

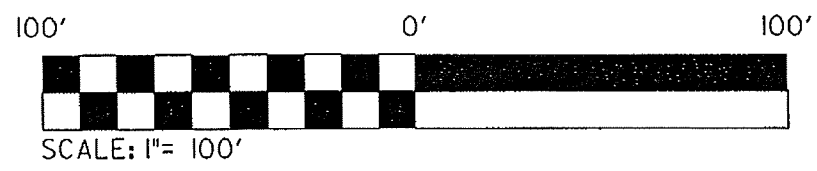
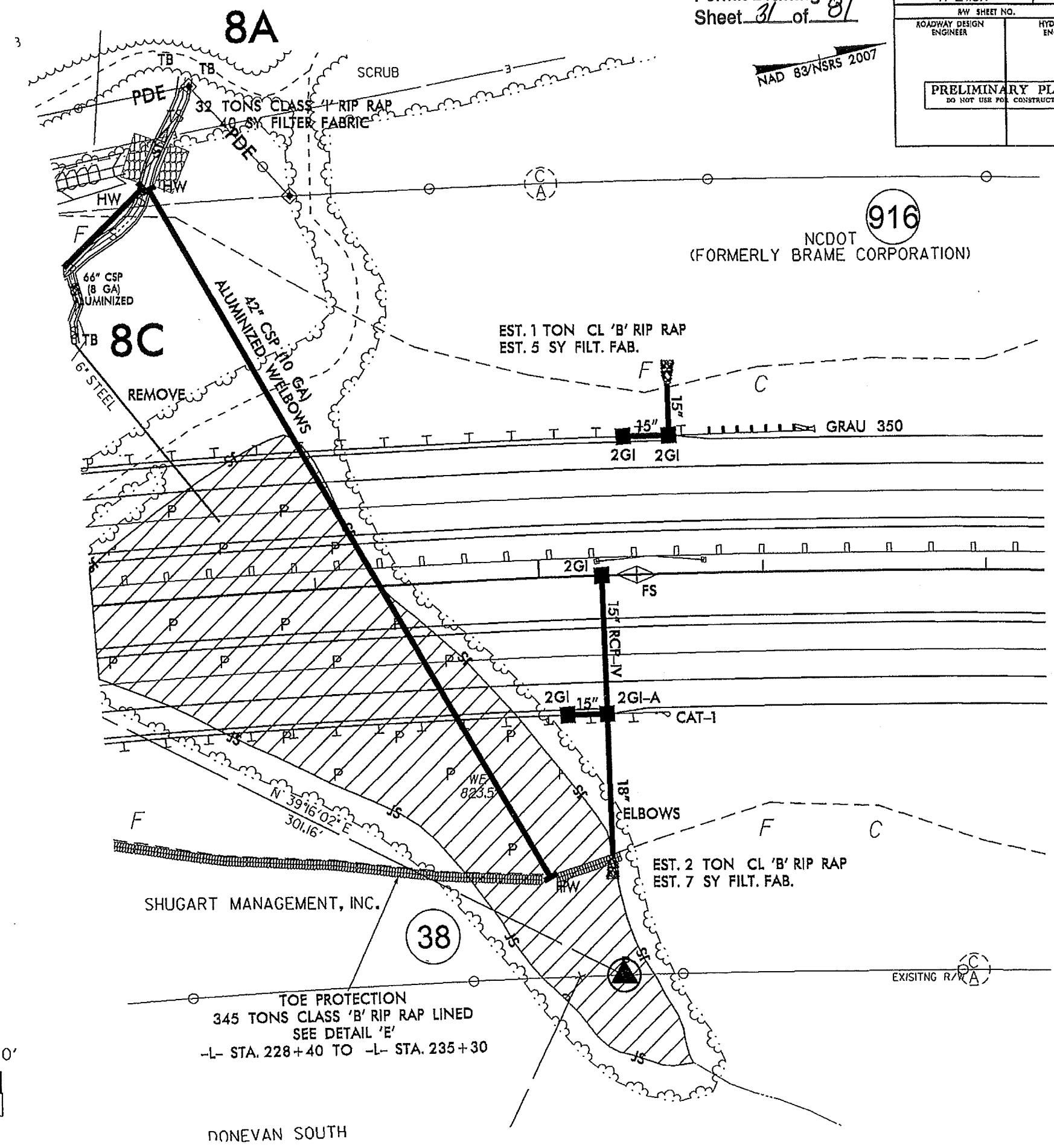

REVISIONS

9/17/99
SYSTEMS
DESIGN
INC.

8/17/99

Permit Drawing
Sheet 32 of 81

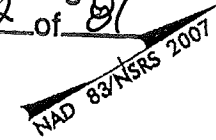

PROJECT REFERENCE NO. R-2413A	SHEET NO. 16
NW SHEET NO.	
ROADWAY DESIGN ENGINEER	HYDRAULICS ENGINEER
PRELIMINARY PLANS DO NOT USE FOR CONSTRUCTION	

SITE 10

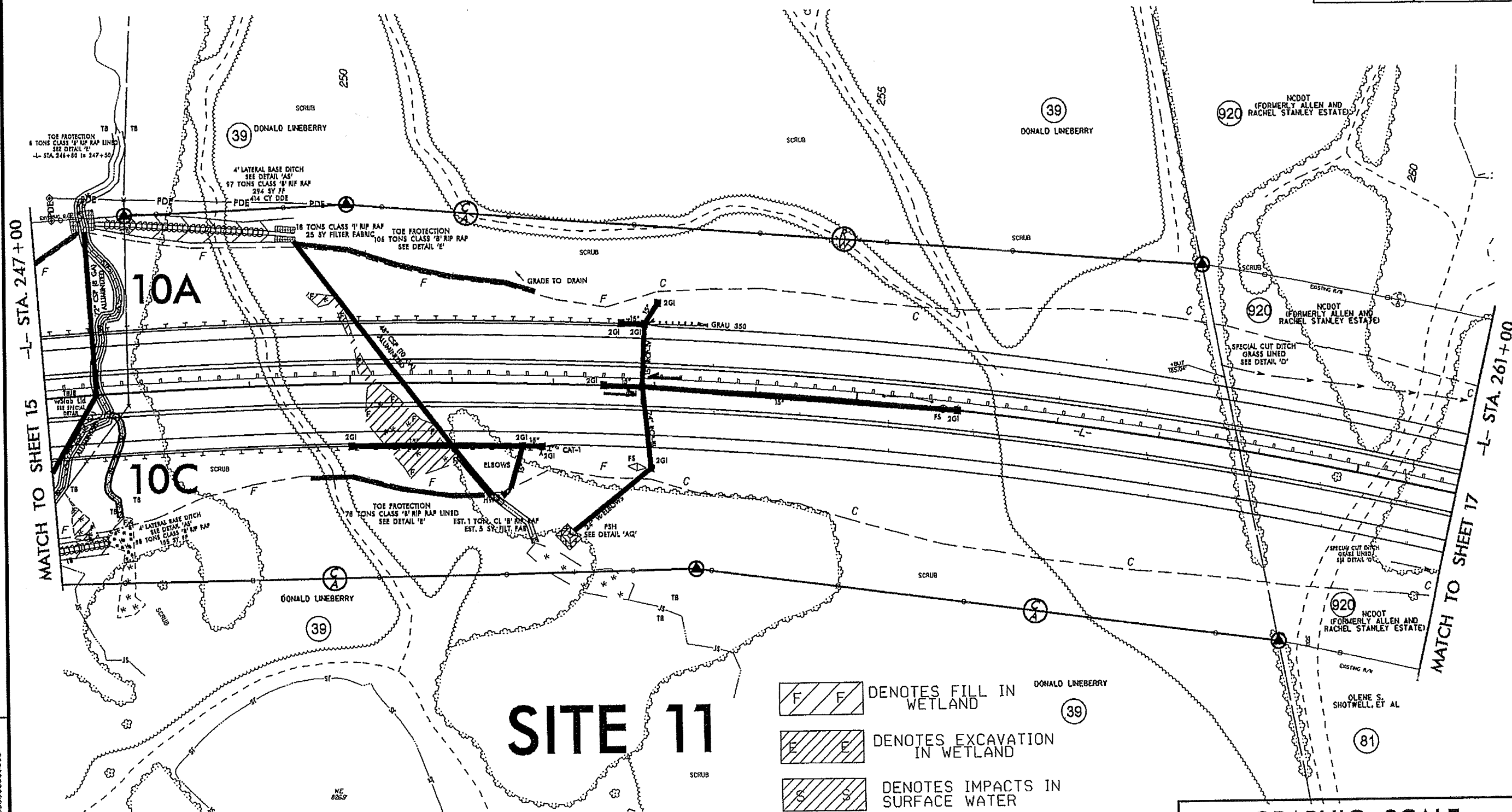

MATCH TO SHEET 15
-L- STA. 247+00

MATCH TO SHEET 17
-L- STA. 261+00

- DENOTES FILL IN WETLAND
- DENOTES EXCAVATION IN WETLAND
- DENOTES IMPACTS IN SURFACE WATER
- DENOTES TEMPORARY IMPACTS IN SURFACE WATER
- DENOTES MECHANIZED CLEARING

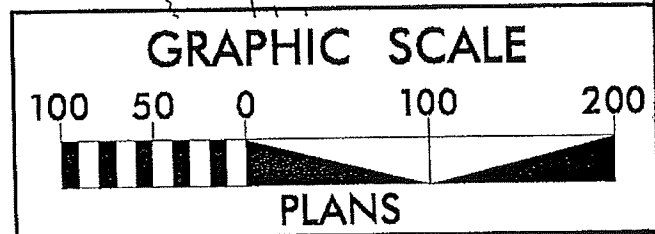
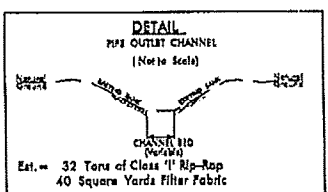

REVISIONS

DATE: 8/17/99
BY: [illegible]
CHECKED: [illegible]
APPROVED: [illegible]

8/17/99

SITE 10

Permit Drawing
Sheet 33 of 81

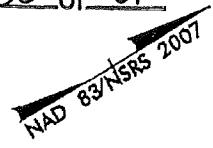

PROJECT REFERENCE NO. R-2413A	SHEET NO. 16
RW SHEET NO.	
ROADWAY DESIGN ENGINEER	HYDRAULICS ENGINEER
PRELIMINARY PLANS DO NOT USE FOR CONSTRUCTION	

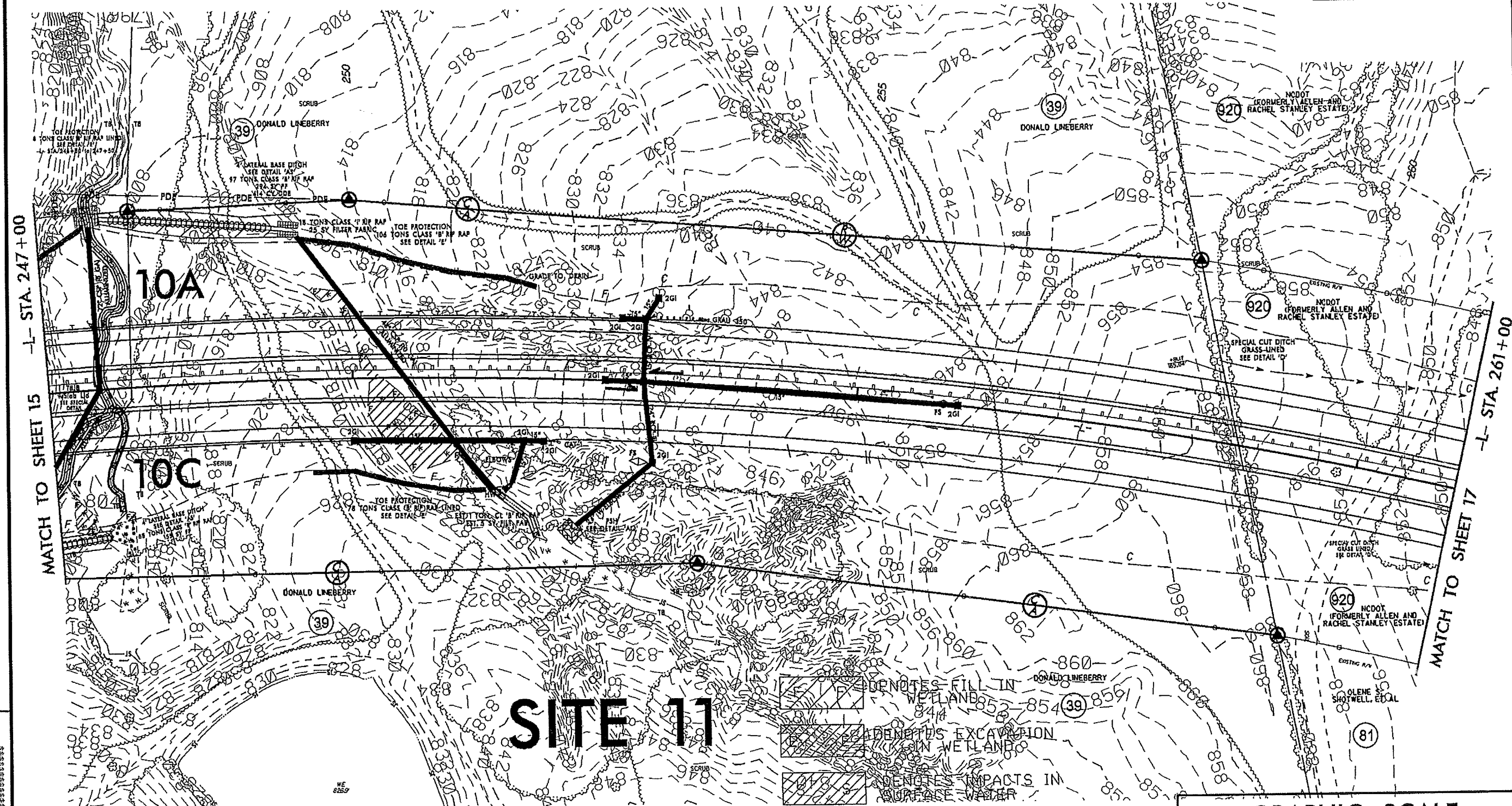

10A

10C

SITE 11

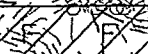
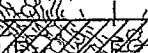
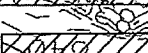
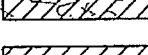
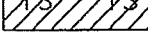
-  DENOTES FILL IN WETLAND
-  DENOTES EXCAVATION IN WETLAND
-  DENOTES IMPACTS IN SURFACE WATER
-  DENOTES TEMPORARY IMPACTS IN SURFACE WATER
-  DENOTES MECHANIZED CLEARING

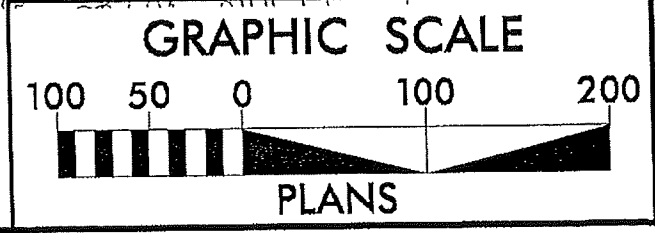
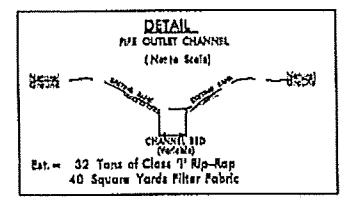

REVISIONS

SYSTEMS
REVISIONS

B/17/99

REVISIONS

PROJECT REFERENCE NO. R-2413A	SHEET NO. 16
RW SHEET NO.	
ROADWAY DESIGN ENGINEER	HYDRAULICS ENGINEER
PRELIMINARY PLANS DO NOT USE FOR CONSTRUCTION	

Permit Drawing
Sheet 34 of 81
NAD 83/NRS 2007

39 DONALD LINEBERRY

TOE PROTECTION
58 TONS CLASS 'B' RIP RAP LINED
SEE DETAIL 'E'
-L- STA. 246+50 to 247+50

4' LATERAL BASE DITCH
SEE DETAIL 'AS'
97 TONS CLASS 'B' RIP RAP
294 SY FF
414 CY DDE

18 TONS CLASS '1' RIP RAP
25 SY FILTER FABRIC
TOE PROTECTION
106 TONS CLASS 'B' RIP RAP
SEE DETAIL 'E'

SITE 10

SITE 11

- DENOTES FILL IN WETLAND
- DENOTES EXCAVATION IN WETLAND
- DENOTES IMPACTS IN SURFACE WATER
- DENOTES TEMPORARY IMPACTS IN SURFACE WATER
- DENOTES MECHANIZED CLEARING

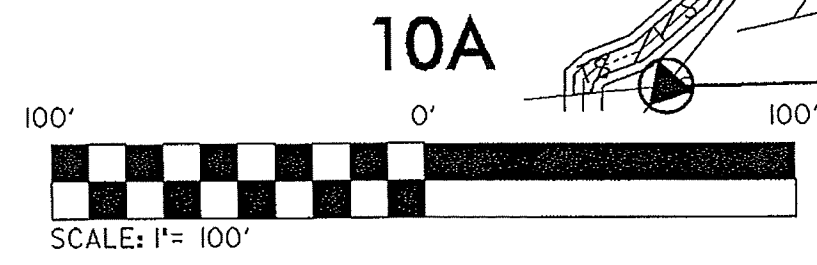

10A

10B

10C

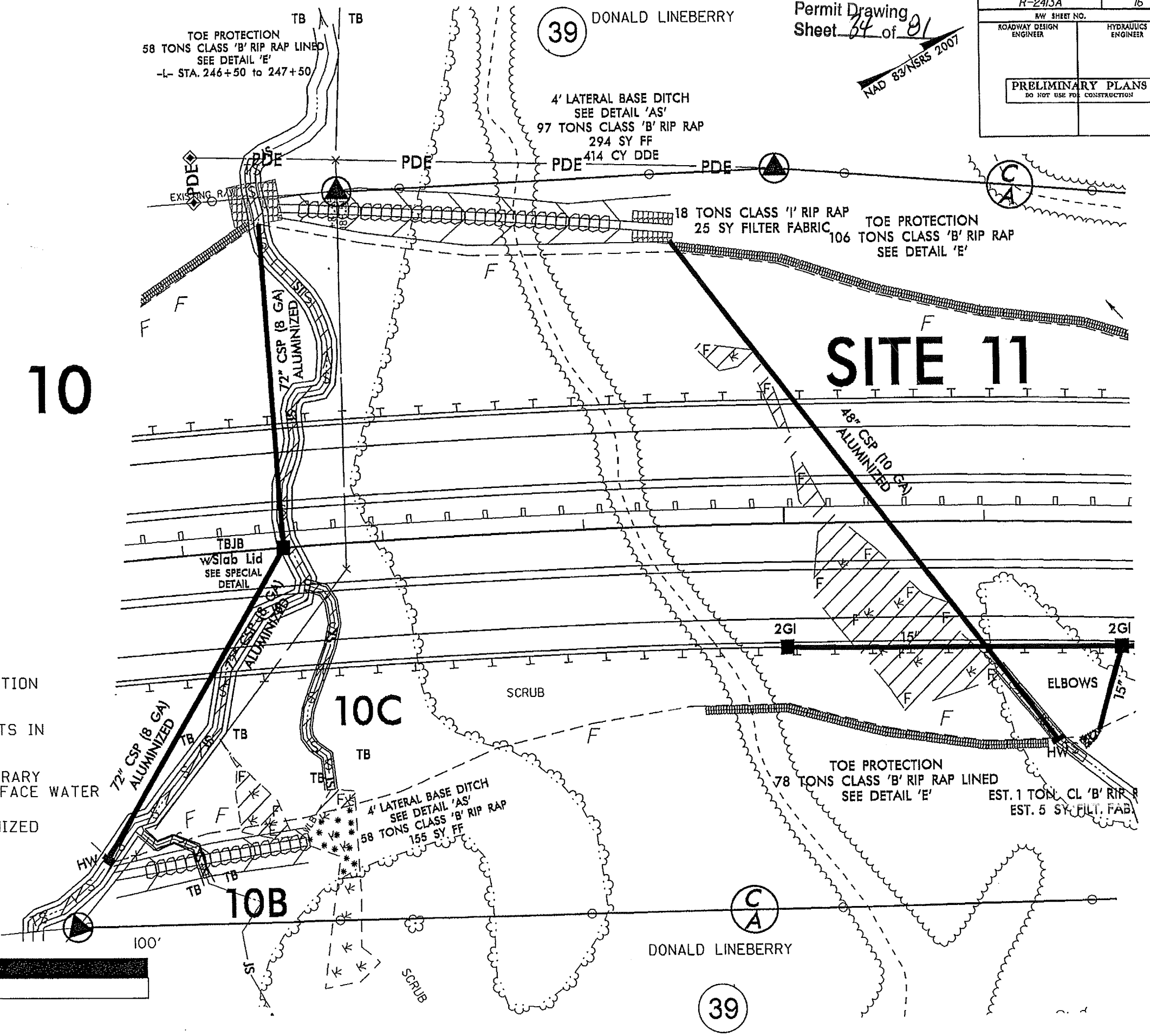

DONALD LINEBERRY

39

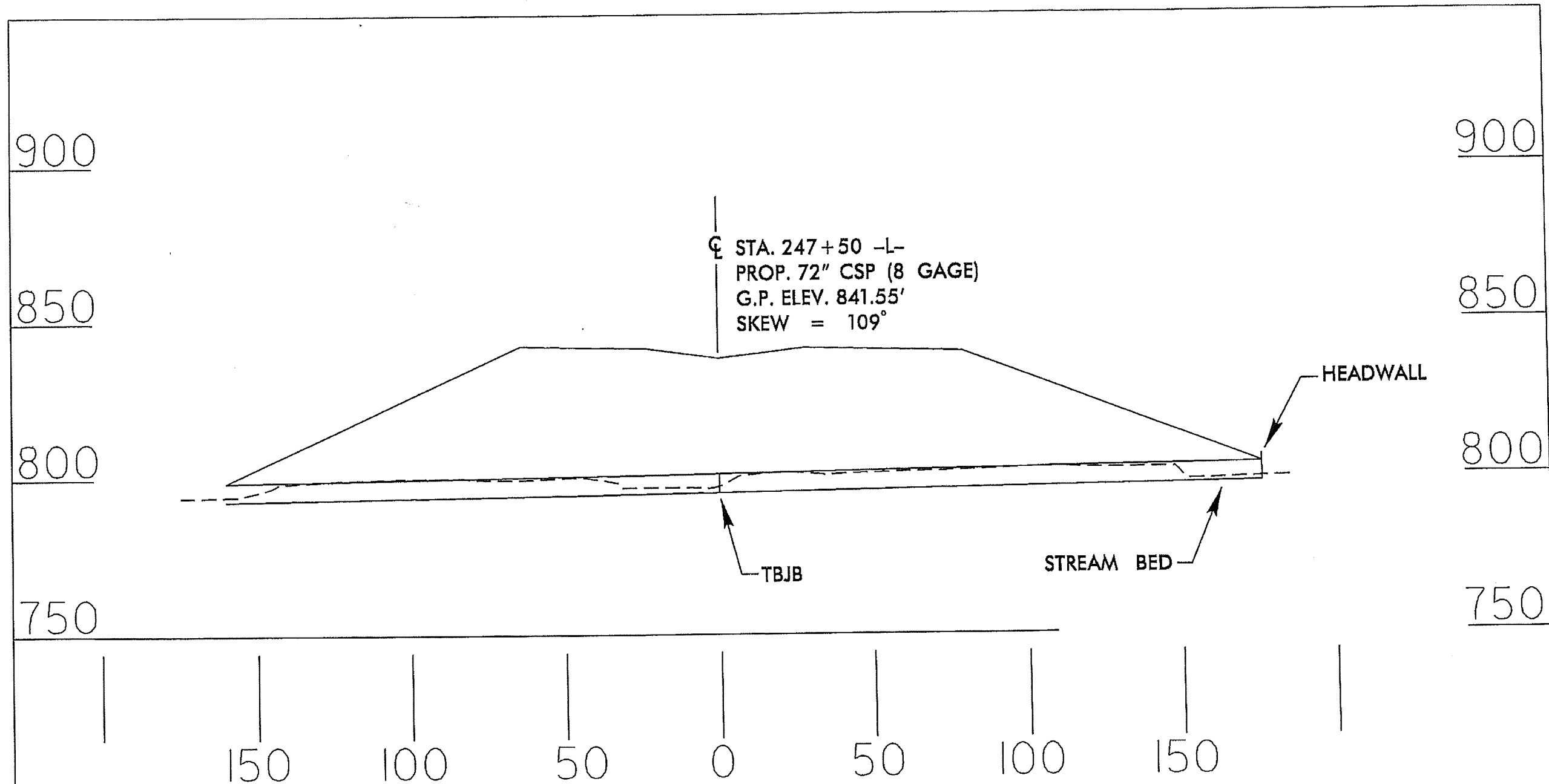

PROFILE

NCDOT
 DIVISION OF HIGHWAYS
 GUILFORD COUNTY
 PROJECT: 34429.1.1 (R-2413A)
 NC 68 CONNECTOR
 FROM FOUR LANES AT
 SR 2011 TO SR 2127

SHEET 35 OF 81 2 / 13 / 13

8/23/99

Permit Drawing
Sheet 32 of 81

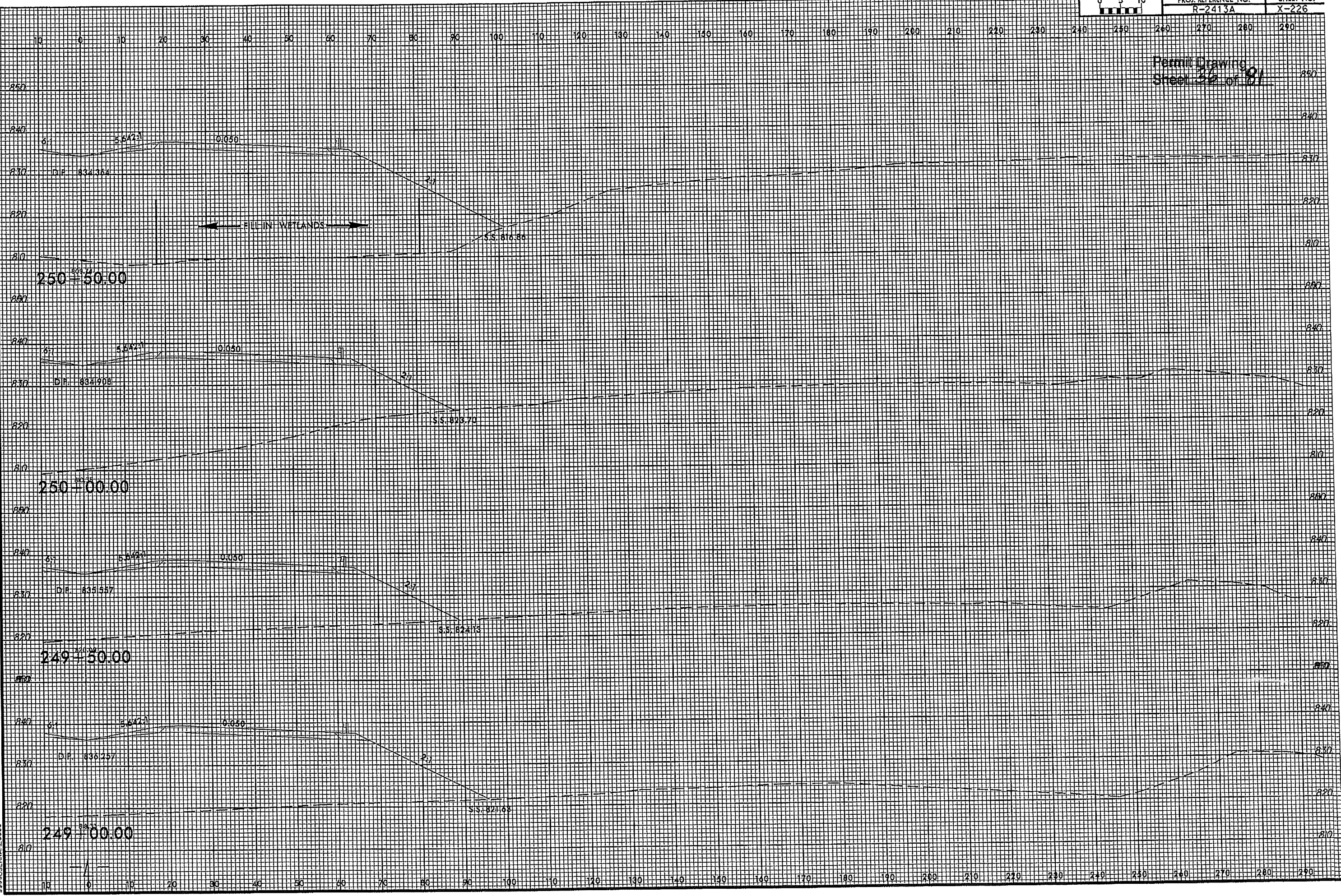

8/23/99

8/17/98

Permit Drawing
Sheet 27 of 81

PROJECT REFERENCE NO. R-2413A	SHEET NO. 17
R/W SHEET NO.	
ROADWAY DESIGN ENGINEER	HYDRAULICS ENGINEER
PRELIMINARY PLANS DO NOT USE FOR CONSTRUCTION	

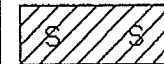
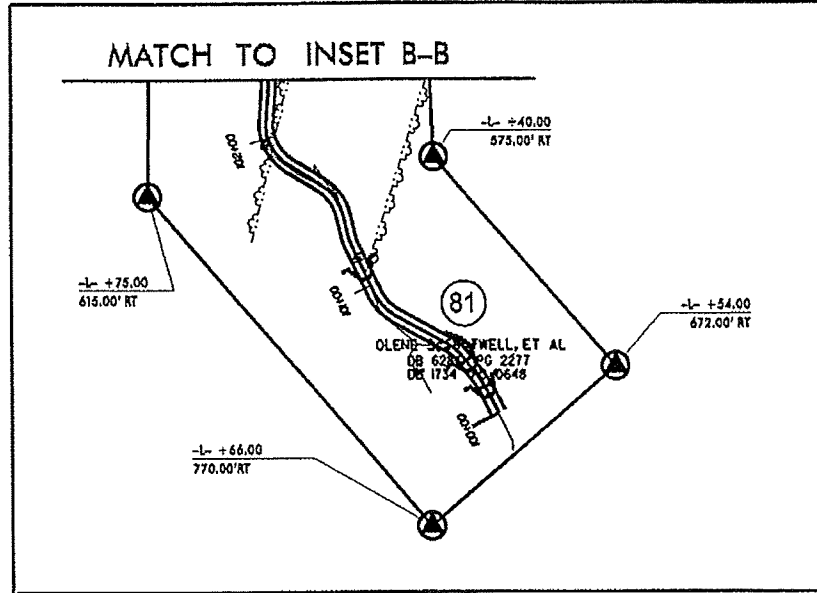
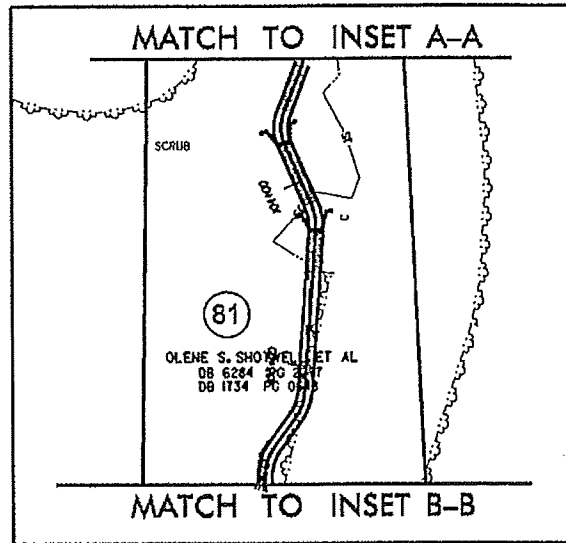

DENOTES IMPACTS IN SURFACE WATER

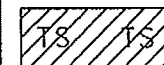

DENOTES TEMPORARY IMPACTS IN SURFACE WATER

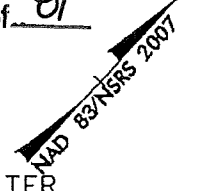

SITE 12

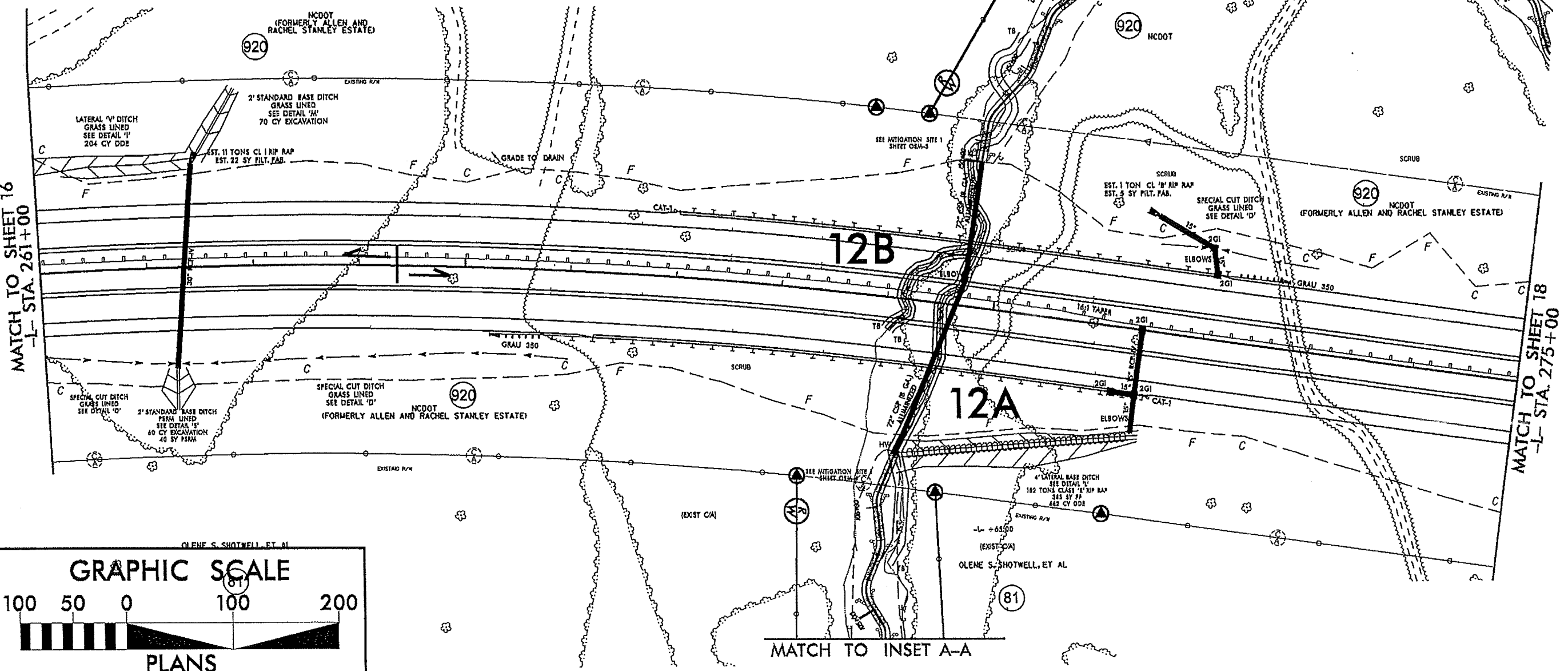

MATCH TO SHEET 16
-L- STA. 261+00

MATCH TO SHEET 18
-L- STA. 275+00

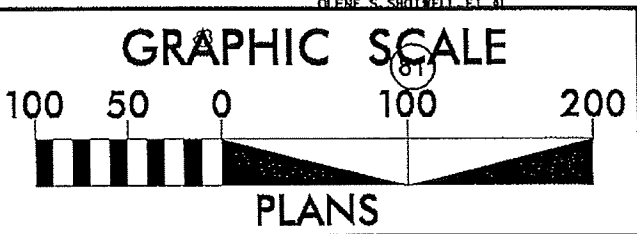

REVISIONS

SYSTEMS

PROJECT REFERENCE NO. R-2413A	SHEET NO. 17
RW SHEET NO.	
ROADWAY DESIGN ENGINEER	HYDRAULICS ENGINEER
PRELIMINARY PLANS DO NOT USE FOR CONSTRUCTION	

Permit Drawing
Sheet 38 of 81

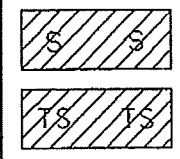
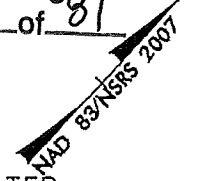

DENOTES IMPACTS IN
SURFACE WATER

DENOTES TEMPORARY
IMPACTS IN SURFACE WATER

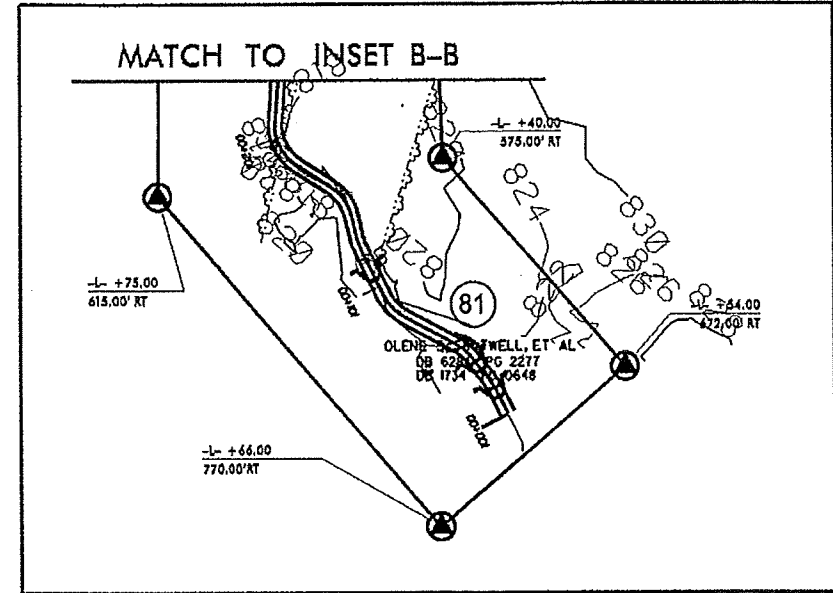
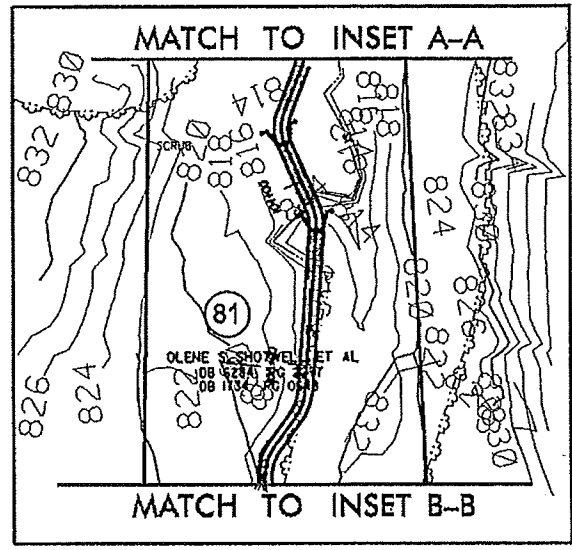

SITE 12

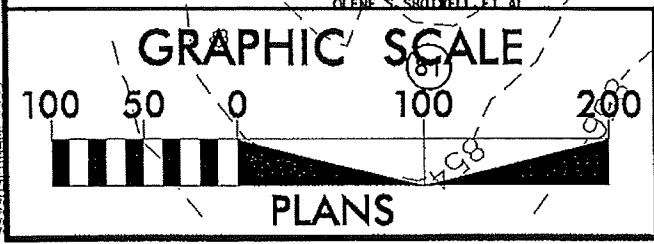
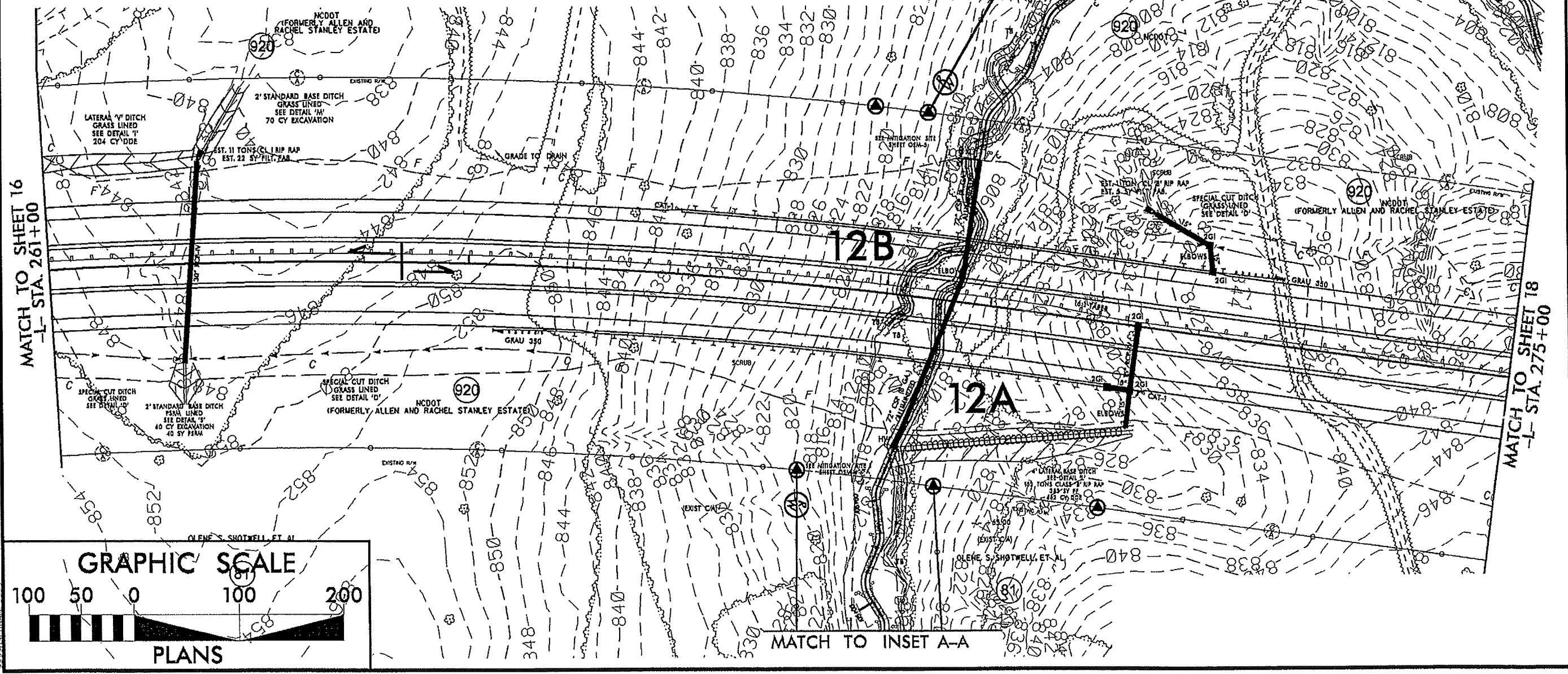

MATCH TO SHEET 16
-L- STA. 261+00

MATCH TO SHEET 18
-L- STA. 275+00

B/17/98

 REVISIONS

 SYSTEMS TIME *****

8/17/99

Permit Drawing
Sheet 39 of 81

PROJECT REFERENCE NO. R-2413A	SHEET NO. 17
R/W SHEET NO.	
ROADWAY DESIGN ENGINEER	HYDRAULICS ENGINEER
PRELIMINARY PLANS DO NOT USE FOR CONSTRUCTION	

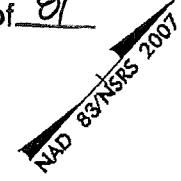

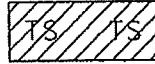
-  DENOTES IMPACTS IN SURFACE WATER
-  DENOTES TEMPORARY IMPACTS IN SURFACE WATER

SITE 12

REVISIONS

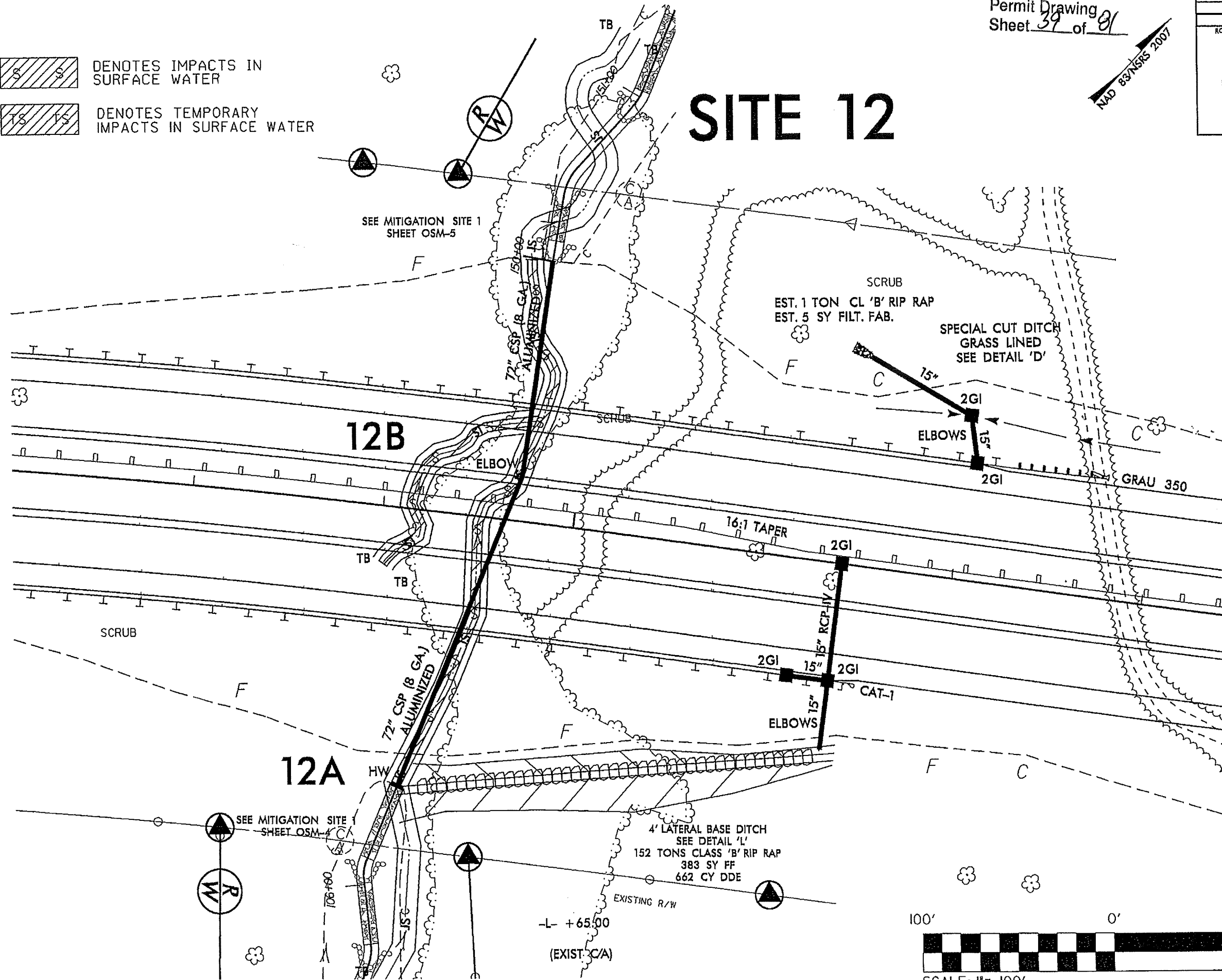

1
 2
 3
 4
 5
 6
 7
 8
 9
 10
 11
 12
 13
 14
 15
 16
 17
 18
 19
 20
 21
 22
 23
 24
 25
 26
 27
 28
 29
 30
 31
 32
 33
 34
 35
 36
 37
 38
 39
 40
 41
 42
 43
 44
 45
 46
 47
 48
 49
 50
 51
 52
 53
 54
 55
 56
 57
 58
 59
 60
 61
 62
 63
 64
 65
 66
 67
 68
 69
 70
 71
 72
 73
 74
 75
 76
 77
 78
 79
 80
 81
 82
 83
 84
 85
 86
 87
 88
 89
 90
 91
 92
 93
 94
 95
 96
 97
 98
 99
 100

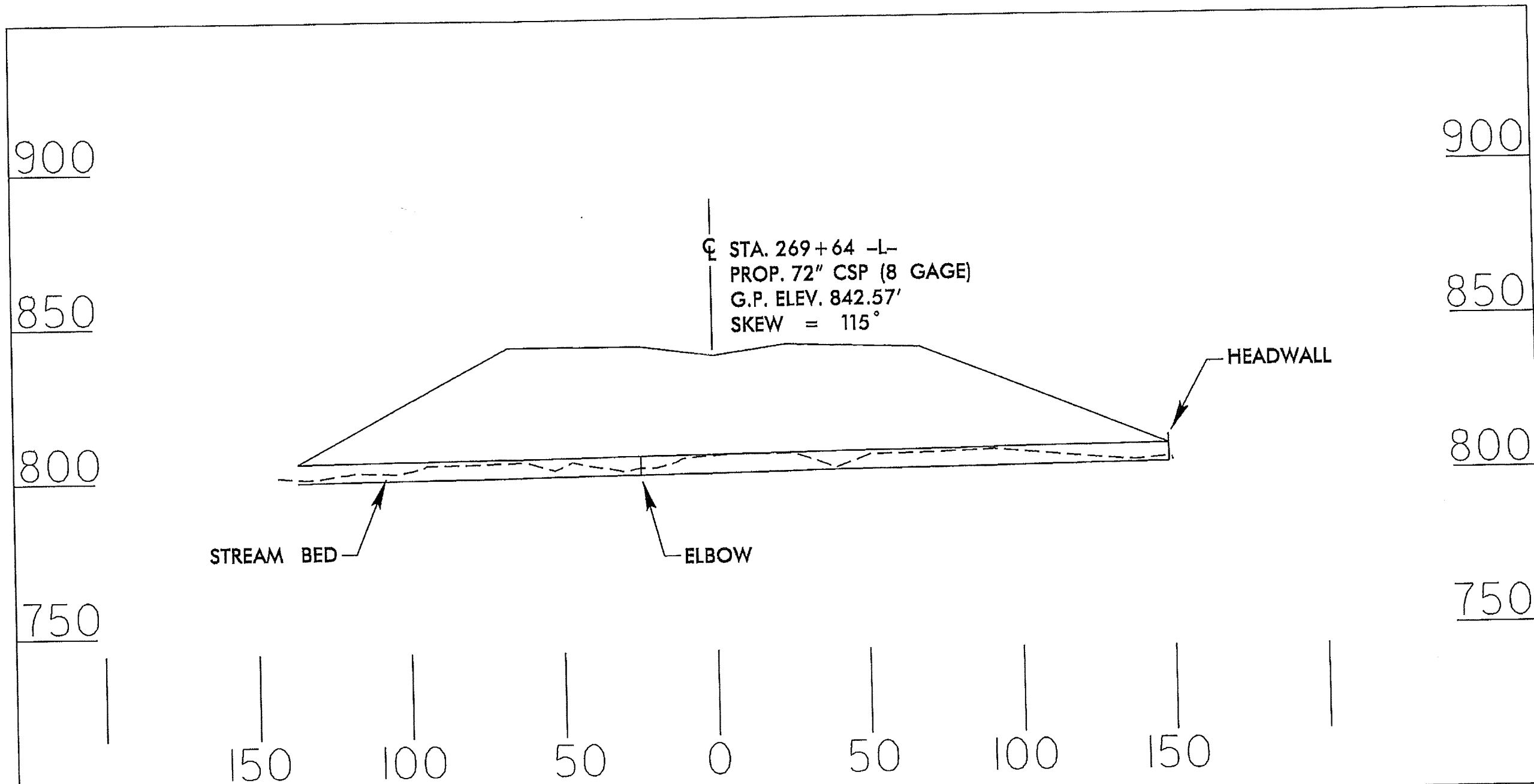

PROFILE

NCDOT
 DIVISION OF HIGHWAYS
 GUILFORD COUNTY
 PROJECT: 34429.1.1 (R-2413A)
 NC 68 CONNECTOR
 FROM FOUR LANES AT
 SR 2011 TO SR 2127

SHEET 40 OF 81

2/13/13