

See Sheet 1-A For Index of Sheets
See Sheet 1-B For Conventional Symbols

TIP PROJECT: U-3615B

CONTRACT:

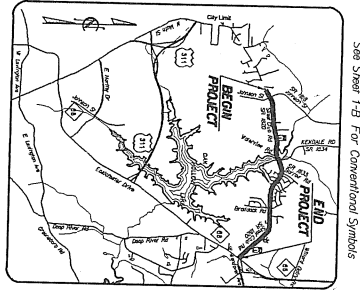

VICINITY MAP

STATE OF NORTH CAROLINA
DIVISION OF HIGHWAYS
GULLFORD COUNTY

LOCATION: SR 1820 (SKEET CLUB ROAD) FROM WEST OF SR 1818 (JOHNSON STREET) TO NC 68 (EASTCHESTER DRIVE).

TYPE OF WORK: PAVING, GRADING, DRAINAGE, CURB & GUTTER, STRUCTURE, CULVERT, SIGNING AND SIGNALS

WETLAND AND SURFACE WATER IMPACTS PERMIT

APR 30 2013
RALEIGH REGULATORY FIELD OFFICE

STATE	NC	PROJECT NUMBER	U-3615B	SHEET	1	TOTAL	1
DATE	3/29/2013	PROJECT TITLE	SR 1820 (SKEET CLUB ROAD) FROM WEST OF SR 1818 (JOHNSON STREET) TO NC 68 (EASTCHESTER DRIVE)	DESIGNER	F. K. BARNETT	DATE	3/29/2013
PROJECT NUMBER	U-3615B	PROJECT TITLE	SR 1820 (SKEET CLUB ROAD) FROM WEST OF SR 1818 (JOHNSON STREET) TO NC 68 (EASTCHESTER DRIVE)	DATE	3/29/2013	PROJECT NUMBER	U-3615B
DATE	3/29/2013	PROJECT TITLE	SR 1820 (SKEET CLUB ROAD) FROM WEST OF SR 1818 (JOHNSON STREET) TO NC 68 (EASTCHESTER DRIVE)	DATE	3/29/2013	PROJECT NUMBER	U-3615B

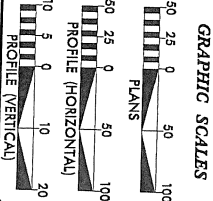
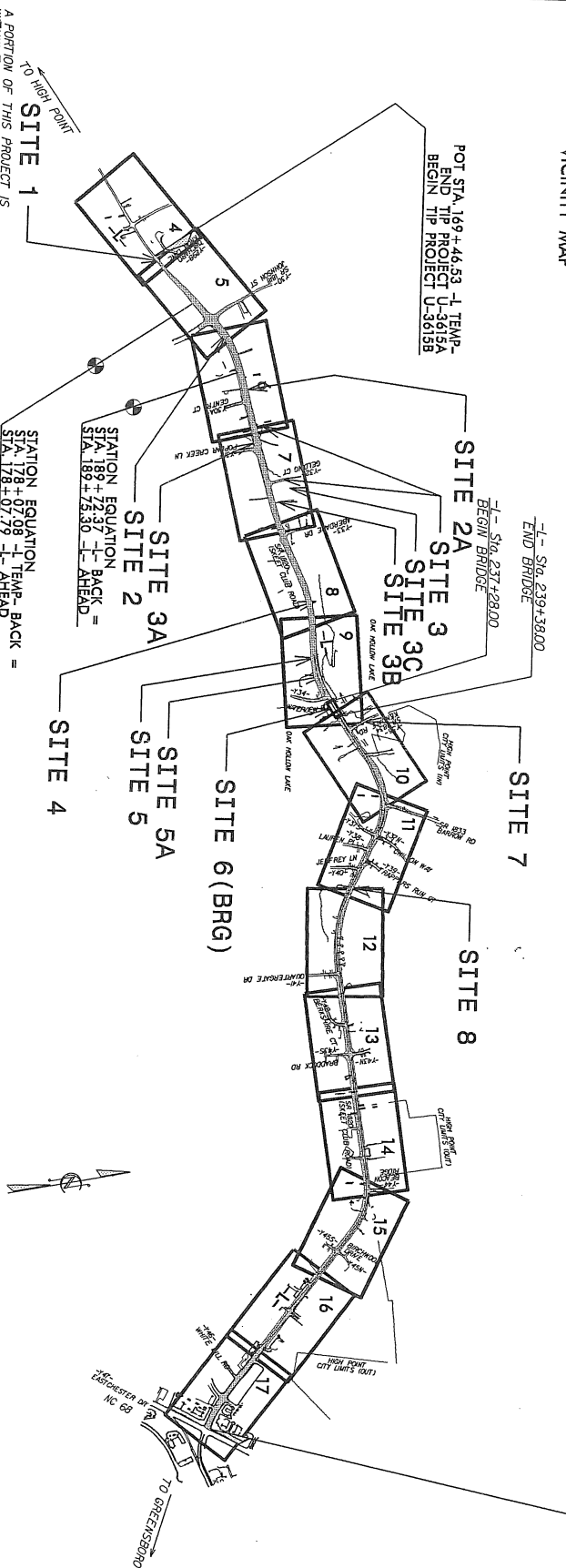

DESIGN DATA
ADT 2013 = 10840-23924
ADT 2035 = 17900-34700
DHV = 10 %
D = 60 %
T = 5 %
* TTST = 2% DUAL 3%
* FUNC CLASS =
URBAN MINOR ARTERIAL
SUBREGIONAL TIER

PROJECT LENGTH
LENGTH ROADWAY TIP PROJECT U-3615B = 3.349 MI
LENGTH STRUCTURE TIP PROJECT U-3615B = 0.040 MI
TOTAL LENGTH OF TIP PROJECT U-3615B = 3.389 MI

2013 STANDARD SPECIFICATIONS
RIGHT OF WAY DATE: APRIL 27, 2009
LETTING DATE: OCTOBER 15, 2013
MCDOT CONTACT: BRENDA L. MOORE PE

HYDRAULICS ENGINEER
EDWARD G. WETHERILL, PE
PROJECT ENGINEER

ROADWAY DESIGN ENGINEER
GREG S. RUVINS, PE
PROJECT ENGINEER



PRELIMINARY PLANS
DO NOT USE FOR CONSTRUCTION

TIP: U-3615A

CONTRACT:

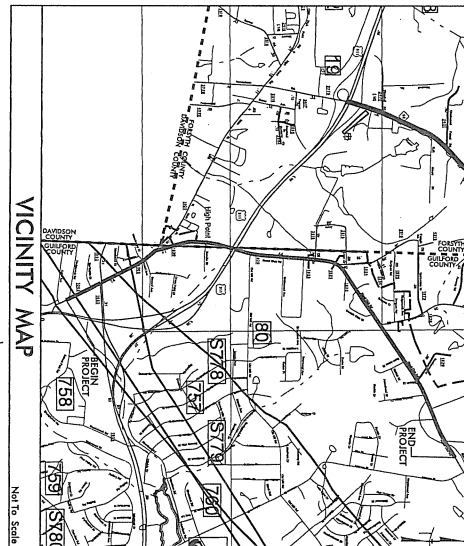

RW PLANS

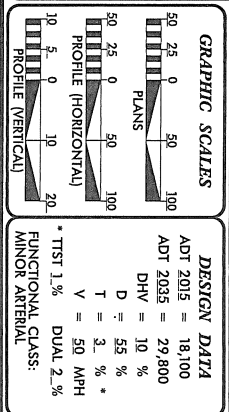
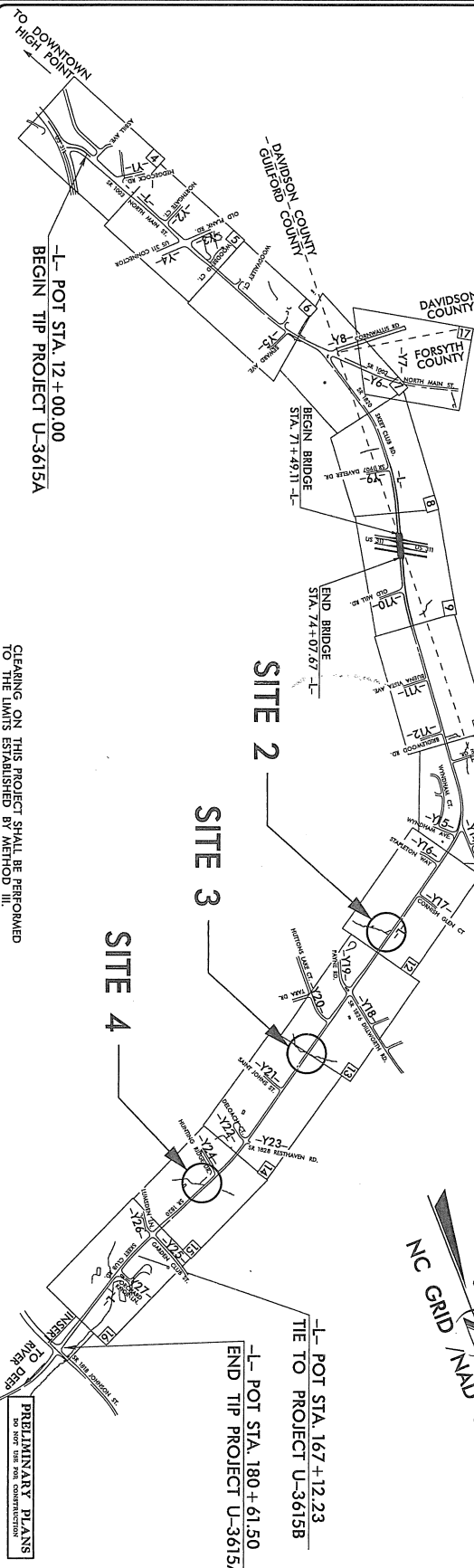

DESIGN DATA

ADT 2015 = 18,100
 ADT 2035 = 29,800
 DHV = 10 %
 D = 55 %
 T = 3. %
 V = 50 MPH
 TTST 1. %
 DUAL 2. %
 FUNCTIONAL CLASS:
 MINOR ARTERIAL

PROJECT LENGTH

LENGTH ROADWAY TIP PROJECT U-3615A = 3.144mi.
 LENGTH STRUCTURE TIP PROJECT U-3615A = 0.049mi.
 TOTAL LENGTH TIP PROJECT U-3615A = 3.193mi.

NDOT CONTACT: CATHY HOUSER, PE
 PROJECT ENGINEER, ROADWAY DESIGN UNIT

Prepared in the office of STEWART ENGINEERING, INC.
 STEWART ENGINEERING
 1000 NORTH CAROLINA
 DEPARTMENT OF TRANSPORTATION

RIGHT OF WAY DATE: OCT 18, 2013
LETTING DATE: OCT 20, 2015

DAVID RUGGLES, PE
 PROJECT ENGINEER

DREW BARD, PE
 PROJECT DESIGN ENGINEER

HYDRAULICS ENGINEER

ROADWAY DESIGN ENGINEER

STATE DESIGN ENGINEER
 DEPARTMENT OF TRANSPORTATION
 FEDERAL HIGHWAY ADMINISTRATION

STATE OF NORTH CAROLINA
 DIVISION OF HIGHWAYS
GUILFORD COUNTY

LOCATION: SR 1003 (NORTH MAIN STREET) AND SR 1818 (JOHNSON STREET), (SKEET CLUB ROAD) BETWEEN US 311 AND SR 1818 (JOHNSON STREET).

TYPE OF WORK: GRADING, PAVING, DRAINAGE, GUARDRAIL, STRUCTURE, SIGNING AND SIGNALS
WETLANDSURFACE WATER PERMIT DRAWING

APR 3 0 2013

PLAN NO.	U-3615A	SHEET NO.	1
DATE	3/28/2013	SCALE	AS SHOWN
PROJECT NO.	34302.22	PROJECT NAME	SR 1003 AND SR 1818
DESIGNER	STEWART ENGINEERING	DATE	3/28/2013
CHECKER	DAVID RUGGLES	DATE	3/28/2013
APPROVED	DAVID RUGGLES	DATE	3/28/2013

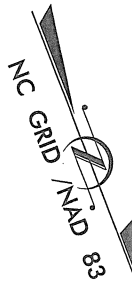

PRELIMINARY PLANS
 DO NOT USE FOR CONSTRUCTION

9/29/95